PROBABILISTIC DOSE ASSESSMENT FOR THE FORMER
BROOKS AND PERKINS SITE

PREPARED FOR AAR CORP.

LISA STETAR, C.H.P.
PERFORMANCE TECHNOLOGY GROUP, INC.

BARRY KOH, PH.D.
PARTNERS ENVIRONMENTAL CONSULTANTS, INC.

PROBABILISTIC DOSE ASSESSMENT FOR THE FORMER
BROOKS AND PERKINS SITE

- EASTERN PROPERTY
 - INCLUDES FACTORY BUILDINGS
 - PARKING LOT
 - APPROXIMATELY 9 ACRES
- WESTERN PROPERTY
 - DENSELY VEGETATED
 - APPROXIMATELY 1.5 ACRES

0.4 METER INCREMENT SOIL SAMPLE RESULTS - TOTAL THOR UM (pCi/g)
 GRID/SQUADRANTS (S 13 pCi/g)

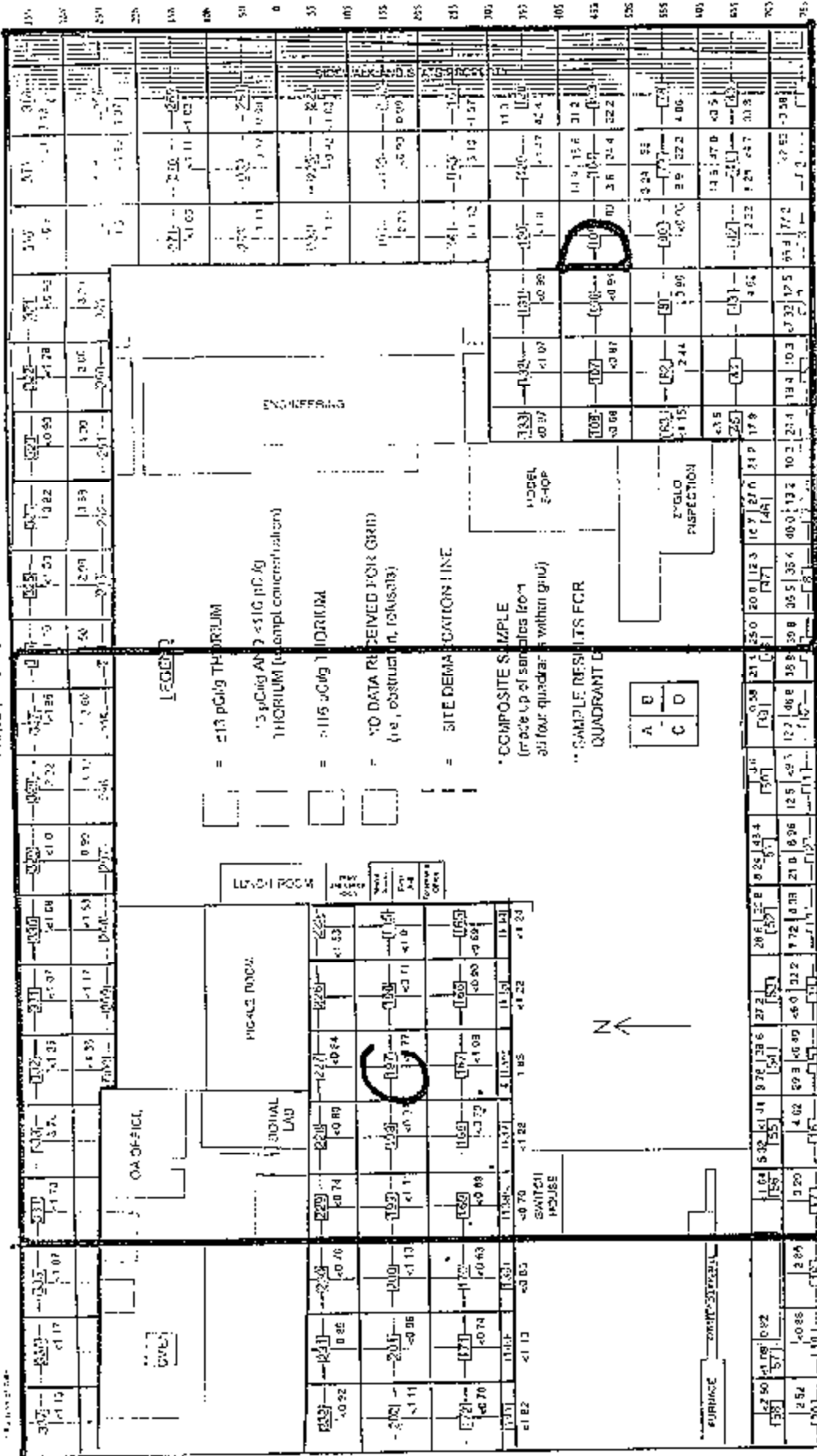

105
100
95
90
85
80
75
70
65
60
55
50
45
40
35
30
25
20
15
10
5
0
55
60
65
70
75
80
85
90
95
100
105

105
100
95
90
85
80
75
70
65
60
55
50
45
40
35
30
25
20
15
10
5
0
55
60
65
70
75
80
85
90
95
100
105

105
100
95
90
85
80
75
70
65
60
55
50
45
40
35
30
25
20
15
10
5
0
55
60
65
70
75
80
85
90
95
100
105

105
100
95
90
85
80
75
70
65
60
55
50
45
40
35
30
25
20
15
10
5
0
55
60
65
70
75
80
85
90
95
100
105

PROBABILISTIC DOSE ASSESSMENT FOR THE FORMER
BROOKS AND PERKINS SITE

AREAS OF CONSIDERATION

- EASTERN PROPERTY
 - AREA A 9350 M²
 - AREA B 9350 M²
 - AREA C 9350 M²
 - AREA D 8800 M²

- WESTERN PROPERTY
 - SINGLE AREA 6175 M²

PROBABILISTIC DOSE ASSESSMENT FOR THE FORMER
BROOKS AND PERKINS SITE

SCENARIOS & ASSUMPTIONS

Comparison of Resident Farmer and Industrial Use Scenarios			
Pathway/Parameter	Unit	Resident Farmer¹	Industrial Worker²
External gamma		Yes	Yes
Inhalation		Yes	Yes
Plant Ingestion		Yes	No
Milk and Meat Ingestion		Yes	No
Fish Ingestion		Yes	No
Drinking Water		No ³	No
Inadvertent Soil Ingestion		Yes	Yes
Inhalation Rate	m ³ /year	8400 ⁴	12,264 ⁵
Indoor Time Fraction		0.66 ⁵	0.17 ⁶
Outdoor Time Fraction		0.12 ⁵	0.06 ⁶

¹All default distributions provided by RESRAD 6.0 were used except indoor time fraction value of 0.66 which is the default value from NUREG-5512, Volume 3.

²All default distributions provided by RESRAD 6.0 were used except the inhalation rate of 12,264m³/yr, the NUREG-5512, Volume 3 default, and the indoor and outdoor time fractions of 0.17 and 0.06, respectively which are the RESRAD defaults for the industrial worker scenario.

³This pathway was excluded from our analysis based on the site hydrogeology, but is normally included in the resident farmer scenario.

⁴ This value is the mode of Default Distribution (triangular with min and max of 4380 and 13,100, respectively) from RESRAD 6.0

⁵Default value from NUREG-5512, Volume 3

⁶Default deterministic value from RESRAD 6.0 for the industrial worker scenario.

Note: The time fractions for the industrial scenario equate to approximately 2015 hours/year on site.

PROBABILISTIC DOSE ASSESSMENT FOR THE FORMER
BROOKS AND PERKINS SITE

MEAN TOTAL THORIUM CONCENTRATION
(EXCLUDING ^{232}Th AND ^{228}Th BACKGROUND)

- AREA A 2.7 PICOCURIES PER GRAM (AREA A
SELECTED BECAUSE IT HAS THE HIGHEST MEAN
THORIUM CONCENTRATION)
- WESTERN AREA 12.4 PICOCURIES PER GRAM

PROBABILISTIC DOSE ASSESSMENT FOR THE FORMER
BROOKS AND PERKINS SITE
RESRAD RESULTS

EASTERN PROPERTY – RESIDENT FARMER

- MEAN PEAK DOSE, ALL PATHWAYS 7.47 MREM/YR
- STANDARD DEVIATION 2.77 MREM/YR
- 95TH PERCENTILE PEAK DOSE 12.4 MREM/YR

WESTERN PROPERTY · INDUSTRIAL WORKER

- MEAN PEAK DOSE, ALL PATHWAYS 8.62 MREM/YR
- STANDARD DEVIATION 6.98 MREM/YR
- 95TH PERCENTILE PEAK DOSE 23.5 MREM/YR

PROBABILISTIC DOSE ASSESSMENT FOR THE FORMER
BROOKS AND PERKINS SITE

RESRAD RESULTS

WESTERN PROPERTY – RESIDENT FARMER

- MEAN PEAK DOSE, ALL PATHWAYS 34.1 MREM/YR
- STANDARD DEVIATION 12.7 MREM/YR
- 95TH PERCENTILE PEAK DOSE 56.7 MREM/YR

PROBABILISTIC DOSE ASSESSMENT FOR THE FORMER
BROOKS AND PERKINS SITE

CONCLUSIONS

- EASTERN PROPERTY
 - FULFILLS CONDITIONS FOR UNRESTRICTED RELEASE

- WESTERN PROPERTY
 - FULFILLS CONDITIONS FOR RESTRICTED RELEASE