



**Ascension  
Providence Hospital**

August 31, 2022

UNITES STATES NUCLEAR REGULATORY COMMISSION  
Region III, Materials Licensing Section  
2443 Warrenville Road, Suite 210  
Lisle, IL 60532-4352

Re: Amendment for License No. 21-02802-03

1. Please find the close out survey of the injection room. The results of the close-out surveys are enclosed for your review.

Thank you for your cooperation with this matter. If you have any question please contact our physicist, Michelle Kritzman, at (734) 662-3197 or by email at [mkritzman@mpcphysics.com](mailto:mkritzman@mpcphysics.com)

Sincerely,

Vicki Nedeljkovic  
Director, Diagnostic Imaging  
Ascension Providence Hospital, Southfield Campus  
Southfield, Michigan

## Close-out Survey Information

**Close-out Location:**

**Ascension Providence Hospital, Southfield Campus**  
16001 West Nine Mile Rd  
Southfield, MI 48017-2043

**Date performed:** August 26, 2022

**Performed by:** Kristen Balinski, BS, CNMT, RT(N)

**Radionuclides Used:**

This location was used for 35.200 and 35.300 activities.

**Unsealed**

Tc-99m  
I-123 (Capsule form)  
I-131 (Capsule form)  
Ra-223

**Sealed**

This was an injection room. No sealed sources were stored in the location.

The last day of use for was:

Tc-99m: August 22, 2022  
I-123: August 22, 2022  
I-131: August 15, 2022  
Ra-223: August 12, 2022

**Instruments:**

Wipe tests analyzed with ATOMLAB 950 sodium iodide well counter with a 20-1500 keV window. Efficiency for this energy range is 10% and MDA is less than 200 dpm for this range. The conversion factor used is 10 dpm/cpm.

Survey performed with a Ludlum 14C GM survey meter S/N 350055 calibrated on 04/26/22. Range used was 0-0.2 mR/hr.

**Visual Check:**

The area was checked to ensure that all radioactive waste had been removed. No evidence of radioactive material was noted.

**Radiation Level Survey:**

No area within the injection room demonstrated radiation levels in excess of the background reading of 0.02 mR/hr.

**Removable Contamination:**

No area within the injection room demonstrated removable contamination in excess of 20 net dpm's.

**Surveys, Wipes, and Diagrams are enclosed for review.**

**Conclusion:** No radioactive materials remain in this area. No removable contamination is present.

### Ascension Providence Hospital, Southfield Campus

16001 West Nine Mile Rd

Southfield, MI 48017-2043

Closed Injection Room

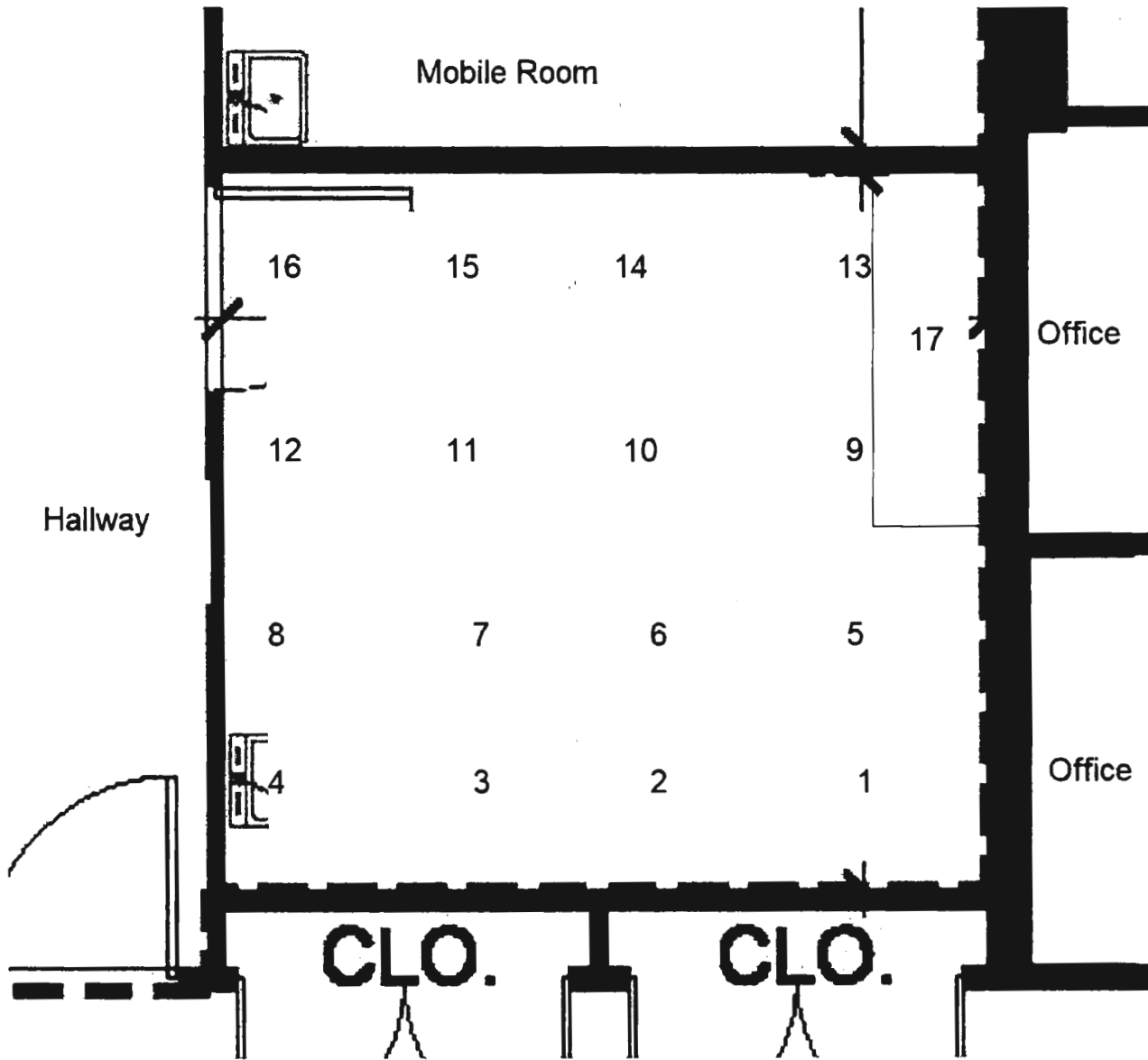

Ascension Providence, Southfield Campus					
16001 West Nine Mile Rd, MI 48017					
License # 21-02802-03					
Date:		8/26/2022	Performed By:		Kristen Balinski
Survey Meter:		Ludlum 14c	Check Value:		20 mR/hr
		cpm	net dpm	mR/h	
1	Desk	371	0	0.02	
2	Floor	382	0	0.02	
3	Floor	384	0	0.02	
4	Floor	343	0	0.02	
5	Floor	373	0	0.02	
6	Floor	364	0	0.02	
7	Floor	345	0	0.02	
8	Floor	393	0	0.02	
9	Floor	377	0	0.02	
10	Floor	367	0	0.02	
11	Floor	343	0	0.02	
12	Floor	394	20	0.02	
13	Floor	351	0	0.02	
14	Floor	361	0	0.02	
15	Floor	380	0	0.02	
16	Floor	366	0	0.02	
17	Counter	349	0	0.02	
Background (1-10)		402		0.02	
Background (11-17)		392		0.02	
<p><b>ACTION LEVELS: 200 dpm</b>                      Conversion factor 10 dpm/cpm</p> <p><b>COMMENTS: No evidence of removable contamination.</b></p>					