

Location: 4<sup>th</sup> Floor Mens Bathroom  
 Site: DHS-EML  
 RWP#: EML#02  
 Survey #: DHS EML 2009-002  
 Survey Type: Release  
 pg. 1 of 1

Smear (CPM/100 cm <sup>2</sup> )					
Direct Count (CPM/Direct Frisk)					
No.	α	β	No.	α	β
1			26		
2			27		
3			28		
4			29		
5			30		
6			31		
7			32		
8			33		
9			34		
10			35		
11			36		
12			37		
13			38		
14			39		
15			40		
16			41		
17			42		
18			43		
19			44		
20			45		
21			46		
22			47		
23			48		
24			49		
25			50		

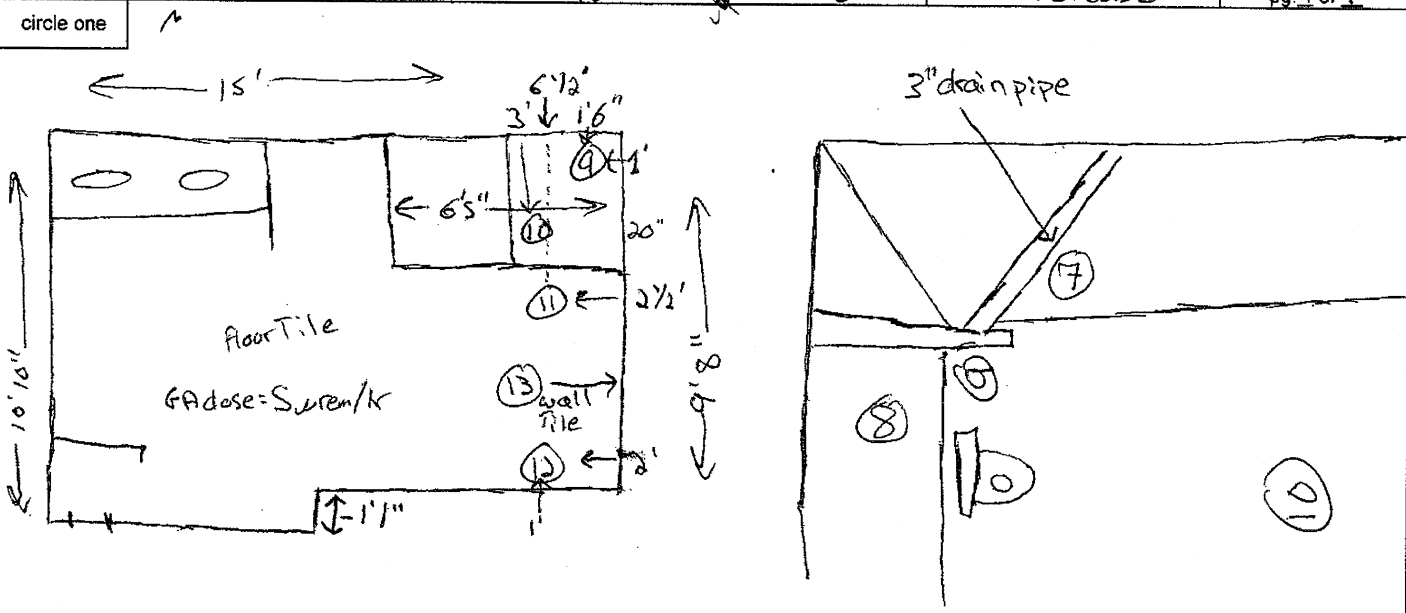

29-29      statics

① 0/51	⑦ 0/171
② 0/50	⑧ 1/197
④ 0/37	⑨ 2/206
⑩ 0/38	⑩ 2/189
⑪ 0/49	⑪ 3/206
⑫ 0/37	⑫ 3/202
⑬ 0/49	⑬ 7/265

Comparative ceramic tile static values

Floor { ① 2/209 - unglazed tile  
 ② 5/238

wall { ③ 14/291 - glazed tile

Comments	Surveyed By:	Date:	Instrument	Serial #	α Eff.	β Eff.	α Bkg.	β Bkg.	γ Bkg.	Cal. Due	Key	
	David Cote	2/26/09	22-29	180830	0.387	0.224	0.2	41.5	n/a	2/3/10		
			43-10-1								■ A/S Location	
			23-60	145481	0.17	0.061	0	108	n/a	11/12/09	*- Boundary	
			43-89	DR154732							○ Smear	
			Bicron	C854F	n/a	n/a	n/a	n/a	6		□ Dose Rate <u>u</u> /hr	
	Reviewed By:	Date:									* Direct Reading CPM/direct frisk	
	Nicholas M. Berliner	12/28/11	Original survey misplaced									△ Grab Sample