

Location: 4th Floor Womens Bathroom
 Site: DHS-EML

RWP# EML#02

Survey # DHS EML 2009-001

Survey Type: release

Smear (CPM/100 cm²)
 Direct Count (CPM/Direct Frisk)

circle one

No.	α	β	No.	α	β
1			26		
2			27		
3			28		
4			29		
5			30		
6			31		
7			32		
8			33		
9			34		
10			35		
11			36		
12			37		
13			38		
14			39		
15			40		
16			41		
17			42		
18			43		
19			44		
20			45		
21			46		
22			47		
23			48		
24			49		
25			50		

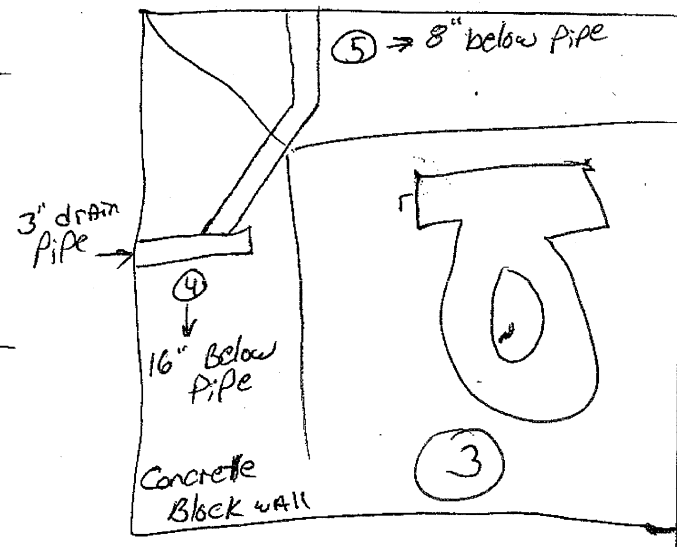
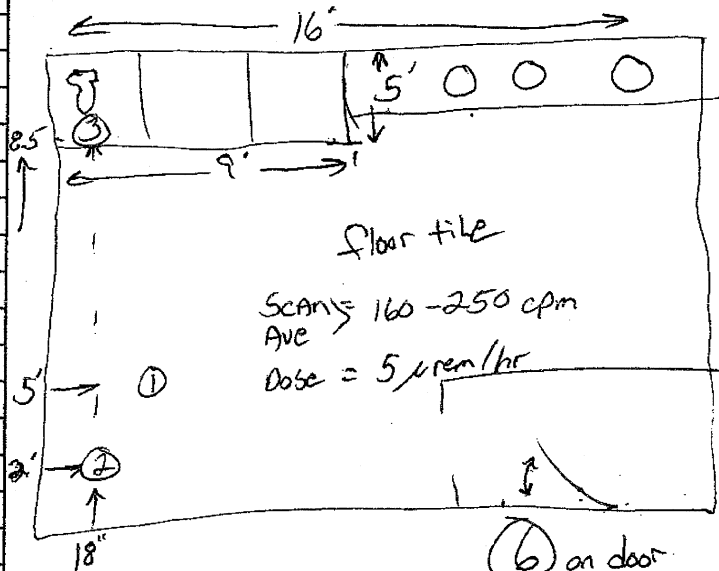

- 2729 ↓
 ① - 0/42
 ② - 0/35
 ③ - 0/32
 ④ - 0/37
 ⑤ - 0/49
 ⑥ - 0/51

- statics
 ① - 0/224
 ② - 0/176
 ③ - 0/204
 ④ - 2/169
 ⑤ - 0/134
 ⑥

Comparative ceramic tile static values
 Floor { ① 4/244 - unglazed tile
 ② 2/241
 Wall { ③ 8/252
 ④ 6/343 - glazed tile

womens Bathroom

Comments	Surveyed By:	Date:	Instrument	Serial #	α Eff.	β Eff.	α Bkg.	β Bkg.	γ Bkg.	Cal. Due	Key
	David Cote	2/26/09	27-29	180830	0.387	0.224	0.2	41.5	n/a	2/3/10	
			43-10-1						n/a		■ A/S Location
			28-30	145481	0.17	0.061	0	108		11/12/09	•• Boundary
			43-89	PR154732	0.061						○ Smear
			Bicron	C854F	n/a	n/a	n/a	n/a	6		□ Dose Rate <u>1</u> /hr.
	Reviewed By:	Date:									* Direct Reading CPM/direct frisk
	Nicholas M. Bertinger	12/18/11		Original survey misplaced							△ Grab Sample