

Location: D-29 4th Fl. News Rm.  
 Site: DHS-EML

RWP# EMC #002

Survey # 037

Survey Type: D-29 F.S.S.

1 pg. of 4

Smear (CPM/100 cm<sup>2</sup>)

circle one

Release of Equipment / Materials

Class 1 FSS State/Smear results

No.	α	β	No.	α	β
1	0	82	26		
2	0	72	27		
3	2	85	28		
4	0	50	29		
5	1	76	30		
6	0	66	31		
7	0	65	32		
8	1	72	33		
9	0	64	34		
10	1	76	35		
11	0	65	36		
12	1	67	37		
13	0	68	38		
14	2	60	39		
15	1	48	40		
16	0	52	41		
17	0	67	42		
18	1	65	43		
19	2	61	44		
20	0	59	45		
21			46		
22			47		
23			48		
24			49		
25			50		

Items	Average (cpm)	Max (cpm)
1) D-29-F-1	0, 260	
2) D-29-F-2	0, 263	
3) D-29-F-3	1, 286	
4) D-29-F-4	3, 264	
5) D-29-C-5	2, 269	
6) D-29-C-6	0, 265	
7) D-29-C-7	6, 323	
8) D-29-C-8	1, 263	
9) D-29-C-9	2, 314	
10) D-29-W-10	3, 403	
11) D-29-W-11	4, 373	
12) D-29-W-12	4, 388	
13) D-29-W-13	2, 381	
14) D-29-W-14	1, 267	
15) D-29-W-15	2, 340	
16) D-29-W-16	0, 240	
17) D-29-W-17	3, 376	
18) D-29-F/B-18	6, 287	
19) D-29 B/B-19	1, 225	
20)		
21)		
22)		
23)		
24)		

Items	Average (cpm)	Max (cpm)
25)		
26)		
27)		
28)		
29)		
30)		
31)		
32)		
33)		
34)		
35)		
36)		
37)		
38)		
39)		
40)		
41)		
42)		
43)		
44)		
45)		
46)		
47)		
48)		

Comments	Surveyed By:	Date:	Instrument	Serial #	α Eff.	β Eff.	α Bkg.	β Bkg	γ Bkg	Cal. Due	Key	
	K. ANDREWS	3/24/08	2300 w/ 43-68	193667 PR-120548	.058	.183	0	133	N/A	11/11/08		
	K. ANDREWS	3/24/08	2929 w/ 43-10-1	129566 w/ 8R132720	.333	.204	0.5	70.1	N/A	01/05/09	■ A/S Location	
											*_* Boundary	
											○ Smear	
											□ Dose Rate _____ /hr	
	Reviewed By:	Date:									* Direct Reading CPM/direct frisk	
	Nicholas M. Berlin	12/28/11	Original survey misplaced									△ Grab Sample

Scan Information Sheet

SU/Room: D-29 Men's bathroom

Class: I

Tech Init.: GB/KA

- Note:
1. On map: draw dimensions and characters
  2. Record scan data for different surfaces
  3. Mark all areas > Action Level (include sample ID)
  4. Record avg and max observed cpm

Directs (cpm) w/43-68

- (18) 6/287
- (19) 1/225
- ↳ on ceiling
- (20)
- (1) 4/338
- (2) 2/384
- (3) 6/493
- (24) 6/382
- ↳ w/43-93
- Background about drop ceiling
- 1/219

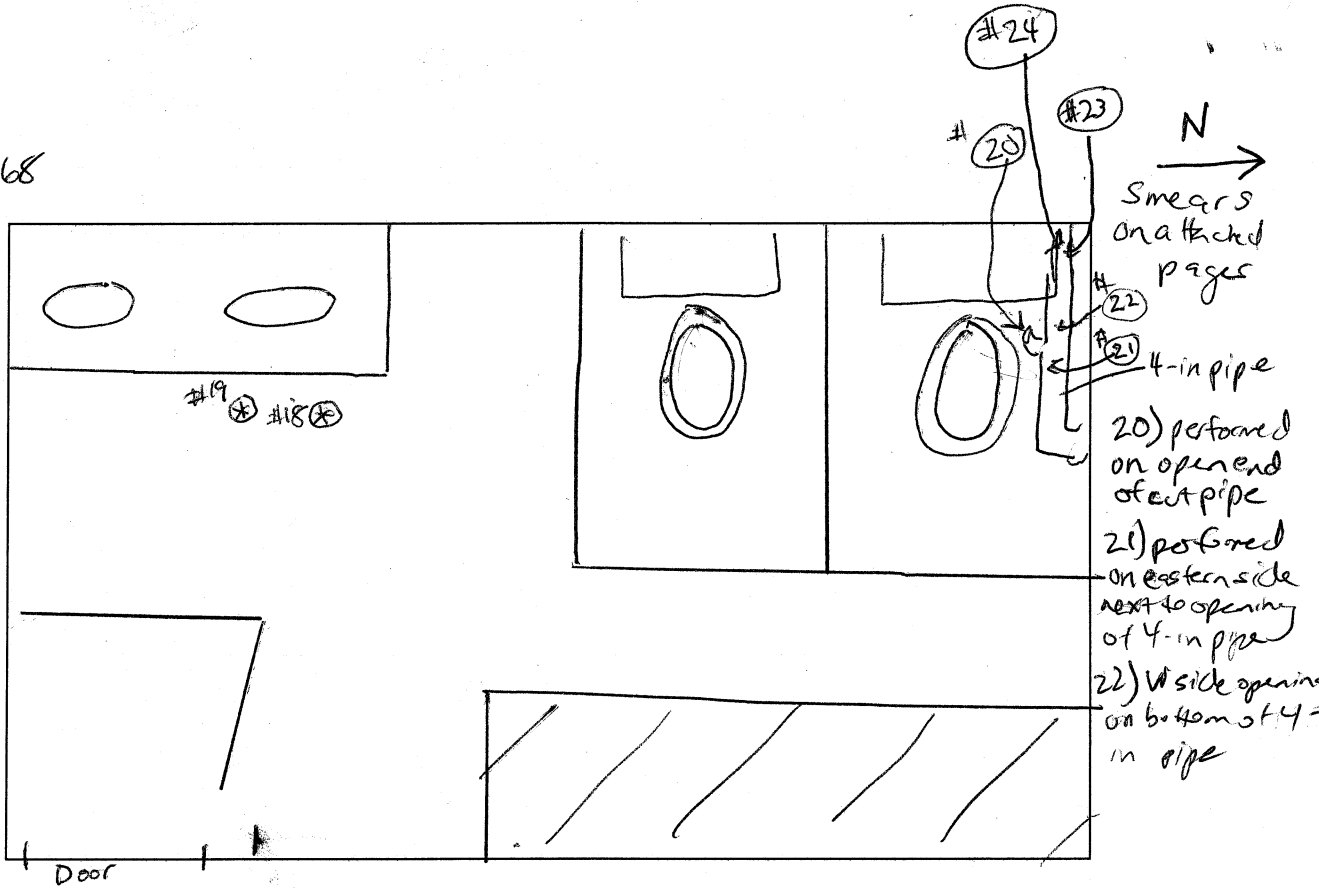

Notes: 100% scan of <sup>of ceiling tiles</sup> topsides performed w/2360/4368 #193667/PR120548

100% scan of <sup>floors</sup> walls + ceiling performed w/2360/4337 #184938/PR178371

Floors: Average: 500cpm, Max: 1000cpm beta - d range - 0-36 cpm

Walls + Ceiling: Average 800cpm, Max: 1200cpm beta - d range - 10-40cpm

GB 3/24/08 Fliling tiles scanned Average: 700cpm, Max 1000cpm

Tech Signature: 3/24/08

Date: 3/24/08

Room D-29

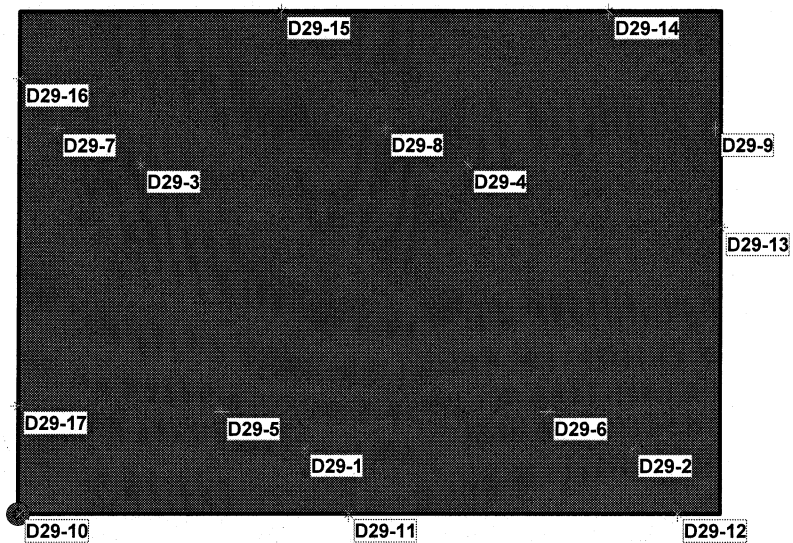

Class 1 Floors, Walls, and Ceiling

4 of 4

Area: Room D-29

<u>X Coord</u>	<u>Y Coord</u>	<u>Z Coord</u>	<u>Label</u>	<u>Value</u>	<u>Type</u>	<u>Historical</u>	<u>Surface</u>	<u>LX</u>	<u>LY</u>
6.2421	1.4174	0.0000	D29-1		Systematic		Floor	6.2421	1.4174
13.4147	1.4174	0.0000	D29-2		Systematic		Floor	13.4147	1.4174
2.6559	7.6290	0.0000	D29-3		Systematic		Floor	2.6559	7.6290
9.8284	7.6290	0.0000	D29-4		Systematic		Floor	9.8284	7.6290
4.4191	2.2248	8.0000	D29-5		Systematic		Ceiling	4.4191	2.2248
11.5916	2.2248	8.0000	D29-6		Systematic		Ceiling	11.5916	2.2248
0.8328	8.4364	8.0000	D29-7		Systematic		Ceiling	0.8328	8.4364
8.0053	8.4364	8.0000	D29-8		Systematic		Ceiling	8.0053	8.4364
15.1779	8.4364	8.0000	D29-9		Systematic		Ceiling	15.1779	8.4364
0.0352	0.0000	2.7990	D29-10		Systematic		Wall 4	15.2648	2.7990
7.2077	0.0000	2.7990	D29-11		Systematic		Wall 4	8.0923	2.7990
14.3802	0.0000	2.7990	D29-12		Systematic		Wall 4	0.9198	2.7990
15.3000	6.2528	2.7990	D29-13		Systematic		Wall 3	4.7472	2.7990
12.8747	11.0000	2.7990	D29-14		Systematic		Wall 2	12.8747	2.7990
5.7021	11.0000	2.7990	D29-15		Systematic		Wall 2	5.7021	2.7990
0.0000	9.5296	2.7990	D29-16		Systematic		Wall 1	9.5296	2.7990
0.0000	2.3571	2.7990	D29-17		Systematic		Wall 1	2.3571	2.7990