

38
22
17
11
8.5
11
17
22

38
22
17
11
8.5
11
17
22

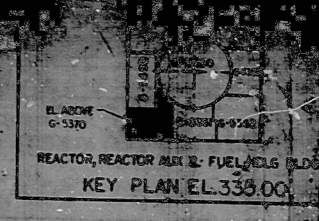
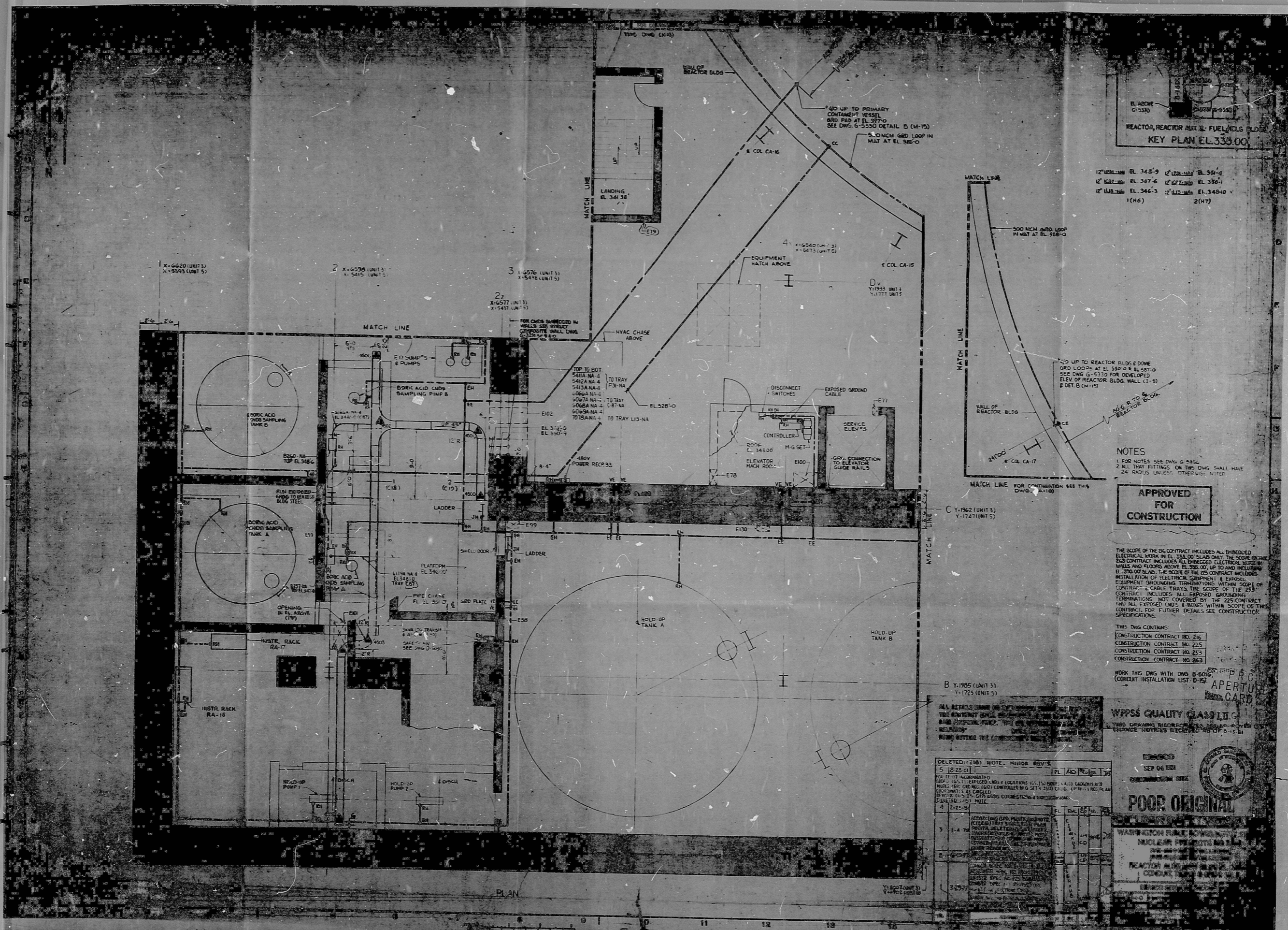

REACTOR, REACTOR AUXILIARY FUEL OILS BLDG
KEY PLAN EL. 333.00

12" (M-15) EL. 348.9 12" (M-15) EL. 349.4
12" (M-15) EL. 347.4 12" (M-15) EL. 350.4
12" (M-15) EL. 346.3 12" (M-15) EL. 345.0
1 (M-15) 2 (M-15)

NOTES
1 FOR NOTES SEE DWG G-5330
2 ALL THAT FITTINGS ON THIS DWG SHALL HAVE 24 HOUR UNLESS OTHERWISE NOTED

APPROVED FOR CONSTRUCTION

THE SCOPE OF THE CONTRACT INCLUDES ALL ENDED ELECTRICAL WORK IN EL. 330.00 SLAB ONLY. THE SCOPE OF THE CONTRACT INCLUDES ALL ENDED ELECTRICAL WORK IN WALLS AND FLOORS ABOVE EL. 330.00 UP TO AND INCLUDING EL. 350.00 SLAB. THE SCOPE OF THE CONTRACT INCLUDES INSTALLATION OF ELECTRICAL EQUIPMENT & EXPOSED EQUIPMENT GROUNDING TERMINATIONS WITHIN SCOPE OF CONTRACT. CABLE TRAYS, THE SCOPE OF THE CONTRACT INCLUDES ALL EXPOSED GROUNDING TERMINATIONS NOT COVERED BY THE 225 CONTRACT AND ALL EXPOSED WIRE BUNDLES WITHIN SCOPE OF THE CONTRACT. FOR FURTHER DETAILS SEE CONSTRUCTION SPECIFICATIONS.

THIS DWG CONTAINS:
CONSTRUCTION CONTRACT NO. 216
CONSTRUCTION CONTRACT NO. 215
CONSTRUCTION CONTRACT NO. 253
CONSTRUCTION CONTRACT NO. 263

WORK THIS DWG WITH DWG G-5016 (CONDUIT INSTALLATION LIST - D-15)

WPPSS QUALITY CLASS LOG
THIS DRAWING INCORPORATES REVISIONS AND CHANGE NOTICES RECEIVED AS OF 8-15-81

SEP 06 1981
CONSTRUCTION SITE

POOR ORIGINAL

WASHINGTON PUBLIC POWER & LIGHTING CO.
NUCLEAR REGULATORY DIVISION
REACTOR AUXILIARY BUILDING
CONDUIT INSTALLATION LIST

B Y-1905 (UNIT 3)
Y-1725 (UNIT 5)

NO.	DATE	DESCRIPTION
1	8-22-81	DELETED (140) NOTE, MINOR REV'S
2	8-22-81	REVISION TO INCORPORATE REVISIONS TO THE DWG AS SHOWN IN THE REVISION LIST.
3	8-22-81	REVISION TO INCORPORATE REVISIONS TO THE DWG AS SHOWN IN THE REVISION LIST.
4	8-22-81	REVISION TO INCORPORATE REVISIONS TO THE DWG AS SHOWN IN THE REVISION LIST.

3-25-77

PLAN

11 12 13 14

RIDS

8303300583

