

J-3116 (Q)

SIZE E

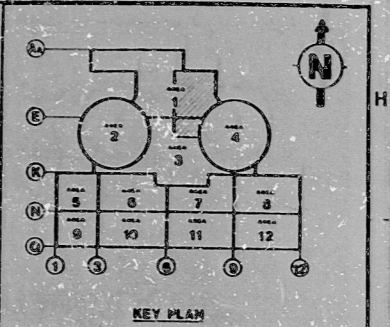
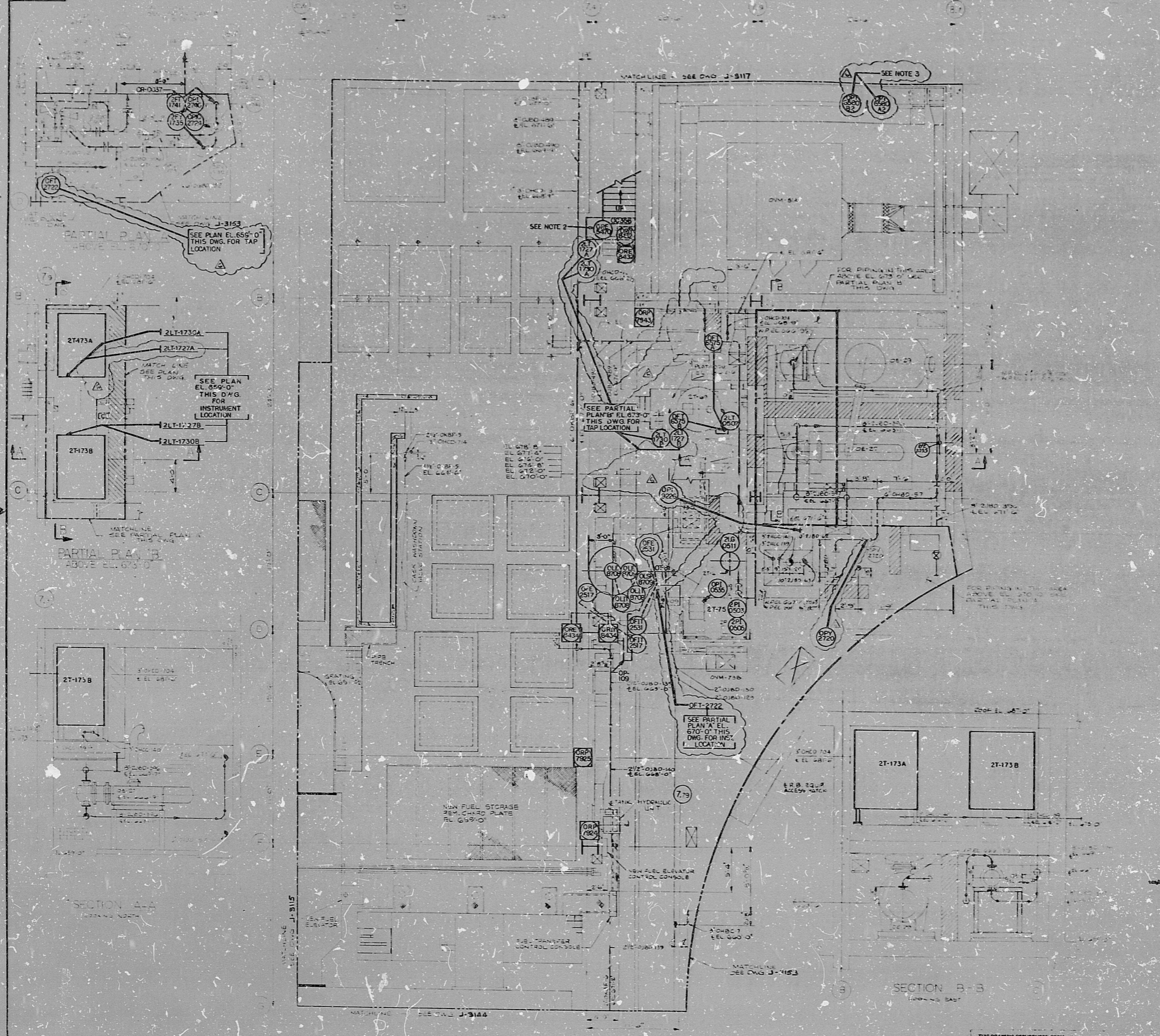

**SYSTEM STATUS LEDGER**

SYSTEM	REV.	DATE	ISSUED BY
FIRE PROTECTION SYSTEM	01/20/02	12-27-02	
COMPONENT COOLING WATER	01/20/02	12-27-02	
SERVICE WATER SYSTEM	01/20/02	12-27-02	
DEMINERALIZED WATER SYSTEM	01/20/02	12-27-02	
AIR STEAM	01/20/02	12-27-02	
CHILLED WATER SYS	01/20/02	12-27-02	
PRIMARY WATER SYS	01/20/02	12-27-02	

CONTRACTOR'S RESPONSIBILITY  
 I certify that the work shown on this drawing was done in accordance with the contract and specifications, and that the work was done in accordance with the contract and specifications, and that the work was done in accordance with the contract and specifications.

DATE: 01/20/02  
 SIGNATURE: [Signature]  
 TITLE: CONTRACT SUPERVISOR

**REVISIONS**

NO.	DESCRIPTION	DATE	BY	CHKD.
1	REVISED AS INDICATED	01/20/02	[Signature]	[Signature]
2	REVISED AS INDICATED	01/20/02	[Signature]	[Signature]
3	REVISED AS INDICATED	01/20/02	[Signature]	[Signature]
4	REVISED AS INDICATED	01/20/02	[Signature]	[Signature]
5	REVISED AS INDICATED	01/20/02	[Signature]	[Signature]
6	ISSUED FOR CONSTRUCTION	01/20/02	[Signature]	[Signature]

- INSTRUMENT LOCATION DRAWING NOTES**
- SEE DWG 7220-J-3101(Q) FOR ALL GENERAL NOTES.
  - INSTRUMENT LOCATION ONLY. REFER TO DWG 7220-J-3140 FOR SAMPLE TAP LOCATION WHICH WILL BE APPROXIMATELY 5'-0" ABOVE PLATFORM ELEVATION 155'.
  - INSTRUMENT LOCATIONS ONLY. SEE DWG 7220-J-3102(Q) FOR TAP LOCATIONS.

**REVISIONS**

NO.	DESCRIPTION	DATE	BY	CHKD.
1	REVISED AS INDICATED	01/20/02	[Signature]	[Signature]
2	REVISED AS INDICATED	01/20/02	[Signature]	[Signature]
3	REVISED AS INDICATED	01/20/02	[Signature]	[Signature]
4	REVISED AS INDICATED	01/20/02	[Signature]	[Signature]
5	REVISED AS INDICATED	01/20/02	[Signature]	[Signature]
6	ISSUED FOR CONSTRUCTION	01/20/02	[Signature]	[Signature]

**RECNTEL**  
 480 4828 W. 110th St.  
 MIDLAND PLANT UNITS 1 & 2  
 CONSUMERS POWER COMPANY

**INSTRUMENT LOCATION DRAWING**  
 AREA 1  
 PLAN OF EL. 659'-0"

JOB NO.	DRAWING NO.	REV.
7220	J-3116 (Q)	6

PRO3  
 APERTURE  
 CARD

8.5"  
 11"  
 17"

8.5"  
 11"  
 17"



RIDS

8302040427

