

J-3105(Q)

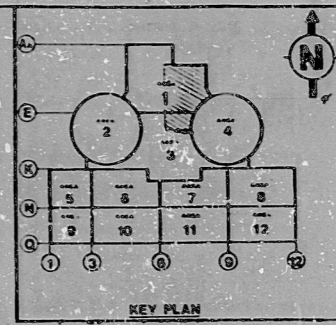
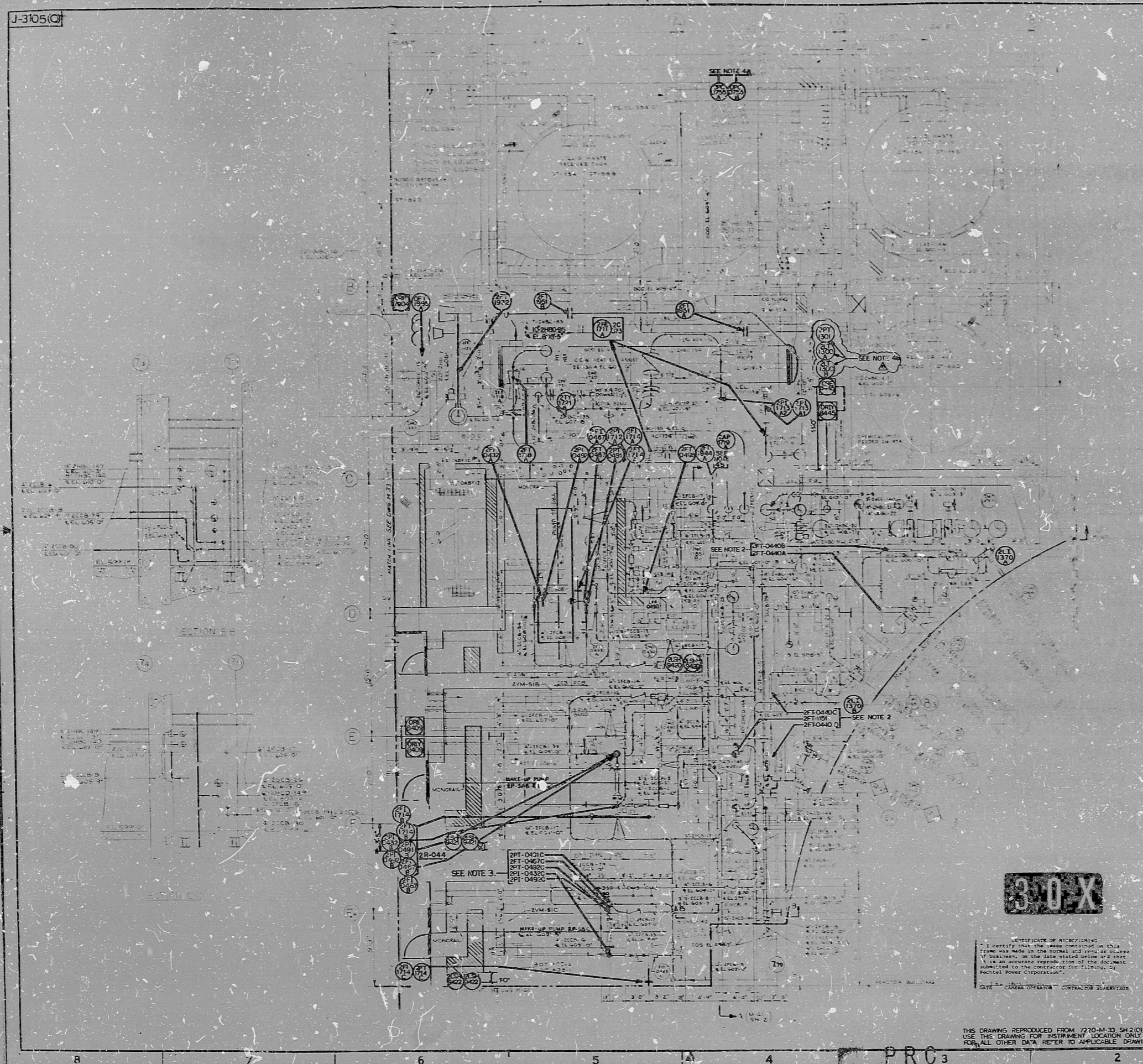

SYSTEM STATUS LEDGER			
SYSTEM	ISS	ISSUED	CONST
RECTOR BUILDING SPRAY SYSTEM	7-13-59	4-10-74	5-23-76
COOLANT HEAT REMOVAL AND CORE FLOODING SYSTEM	7-13-59	6-28-74	2-21-76
SERVICE WATER SYSTEM	7-13-59	6-25-74	2-27-76
WINDUP FEEDWATER SYSTEM	7-13-59	7-6-74	2-13-76
COMPONENT COOLING WATER SYSTEM	7-13-59	5-21-74	2-21-76
MAKE UP & PURIFICATION	7-13-59	1-14-74	
BORON RECOVERY SYSTEM	7-13-59	4-10-74	2-13-76
LIQUID WASTE SYSTEM	7-13-59	1-14-74	
FIRE PROTECTION SYSTEM	7-13-59	4-10-74	2-13-76
CHILLED WATER SYS. SAFETY GUARDS EQUIPMENT	7-13-59	3-30-74	
DEMINERALIZED WATER SYS.	7-13-59	3-30-74	
STEAM CONDENSATE SYSTEM	7-13-59	3-30-74	
COOLANT HEAT SUPPLY NET.	7-13-59	3-30-74	

PIPING SYSTEM INSTRUMENT LOCATIONS HAVE BEEN PREPARED TO SHOW ALL IN-SERVICE PIPING SYSTEMS IN EACH AREA. INSTRUMENTS NOT SHOWN OR HAVING THEIR INSTRUMENT LOCATIONS ARE NOT TO BE USED AS REFERENCE TO PERFORM OTHER ENGINEERING AND CONSTRUCTION TASKS.

REVISION	DATE	BY	CHKD	DESCRIPTION
1	12-11-73	J.E.L.	NO	ISSUED FOR CONSTRUCTION

- INSTRUMENT LOCATION DRAWING NOTES:**
- SEE DWG 7220-J-3105(Q) FOR ALL GENERAL NOTES.
  - THESE ARE I/P LOCATIONS ONLY. REFER TO DWG J-3105(Q) FOR INSTRUMENT LOCATION.
  - THESE ARE TAP LOCATIONS ONLY. REFER TO DWG J-3105(Q) FOR INSTRUMENT LOCATION.
  - FOR TAP LOCATIONS, REFER TO DWG J-3105(Q) (J-3107(Q)).

NO.	DESCRIPTION	DATE	BY	CHKD
1	REVISED AND INCORPORATED FCN 1-14-74	1-14-74	J.E.L.	NO
2	REVISED TO INCORPORATE FCN 2-27-76	2-27-76	J.E.L.	NO
3	REVISED AS INDICATED		J.E.L.	NO
4	REVISED TO INCORPORATE FCN 3-30-74	3-30-74	J.E.L.	NO
5	REVISED TO INCORPORATE FCN 4-10-74	4-10-74	J.E.L.	NO
6	REVISED TO INCORPORATE FCN 5-23-76	5-23-76	J.E.L.	NO
7	REVISED TO INCORPORATE FCN 6-25-74	6-25-74	J.E.L.	NO
8	REVISED TO INCORPORATE FCN 7-6-74	7-6-74	J.E.L.	NO
9	REVISED TO INCORPORATE FCN 8-21-74	8-21-74	J.E.L.	NO
10	REVISED TO INCORPORATE FCN 9-14-74	9-14-74	J.E.L.	NO
11	REVISED TO INCORPORATE FCN 10-14-74	10-14-74	J.E.L.	NO
12	REVISED TO INCORPORATE FCN 11-14-74	11-14-74	J.E.L.	NO
13	REVISED TO INCORPORATE FCN 12-11-73	12-11-73	J.E.L.	NO

**30X**

**BECHTEL**  
 182 14529 BILKLEAN  
 MIDLAND PLANT UNITS 1 & 2  
 CONSUMERS POWER COMPANY

INSTRUMENT LOCATION DRAWING		
AREA 1		
PLAN OF EL 599' 0"		
JOB NO.	DRAWING NO.	REV.
7220	J-3105 (Q)	10

THIS DRAWING REPRODUCED FROM 7220-M-33 SH 2 (Q) REV. 1. USE THIS DRAWING FOR INSTRUMENT LOCATION ONLY. FOR ALL OTHER DATA REFER TO APPLICABLE DRAWINGS.

PRO3  
 APERTURE  
 CARD

RIDS

8302040410

