

MATCH LINE SEE DWG. D-215-131
 TELEPHONE TERM. CAB.

SECTION I-I
 NO SCALE

SECTION II-II
 NO SCALE

SECTION A
 ENLARGED PLAN 'A'

NOTES:
 1. FOR LEGEND, NOTES, REFERENCES, AND STANDARD DETAILS, SEE DWG. D-215-801.
 2. CONDUITS CONTINUED UP, SEE DWG. D-215-442; CONDUITS CONTINUED DOWN, SEE DWG. D-215-422.
 3. THIS DRAWING TO BE USED IN CONJUNCTION WITH THE FOLLOWING ELECTRICAL CONDUIT SUPPORT DRAWINGS:
 SS-215-432, SHEET C5
 SS-215-432, SHEET C6
 SS-215-432, SHEET C8

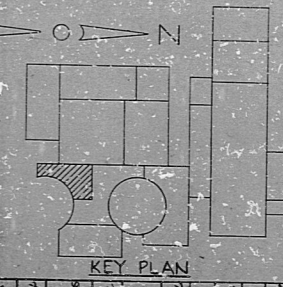

NUCLEAR SAFETY RELATED

REVISIONS	
NO.	DESCRIPTION
1	CONSTRUCTION OF EL.
2	LIMITED CONSTRUCTION: AS NOTED
3	PHLEMINARY NOT FOR CONSTRUCTION
4	BIDDING PURPOSES

DATE	RELEASED FOR ENGR.
THE CLEVELAND ELECTRIC ILLUMINATING COMPANY	
PERRY NUCLEAR POWER PLANT UNITS 1 & 2	
ELECTRICAL CONDUIT LAYOUT	
INTERMEDIATE BUILDING - SOUTH - EL. 620'-6"	
DRAWING NO. GILBERT ASSOCIATES, INC.	
ENGINEERS AND CONSULTANTS	
DATE	APPROVED
DESIGNED	CHECKED
DRAWN	APPROVED
SCALE	DATE
OR 1049	D-215-432 K
DATE	DRAWING NUMBER

14
13
12
11
10
9
8
7
6
5
4
3
2
1

A
B
C
D
E
F
G
H
J
K

14
13
12
11
10
9
8
7
6
5
4
3
2
1

A
B
C
D
E
F
G
H
J
K

RIDS

82.2100182

