

MATCH LINE SEE DWG. D-215-222

MATCH LINE SEE DWG. D-215-121

MATCH LINE SEE DWG. D-215-421

SECTION 2-2
SCALE 1/4"=1'-0"

TOP TO BOTTOM
2R33R490C-2.5
2R33R512C-4.0
2R33C903C-2.0

SECTION 4-4
SCALE 1/4"=1'-0"

SECTION 5-5
SCALE 1/4"=1'-0"

SECTION 6-6
SCALE 1/4"=1'-0"

SECTION 1-1
SCALE 1/4"=1'-0"

- NOTES:
1. FOR LEGEND, NOTES, REFERENCES, AND STANDARD DETAILS, SEE DWG. D-215-001.
 2. CONDUITS TURNING UP, CONTAINED ON DWG. D-215-422.
 3. CONDUITS TURNING DOWN, CONTAINED ON DWG. D-215-412.
 4. THIS DRAWING TO BE WORKED IN CONJUNCTION WITH THE FOLLOWING ELECTRICAL CONDUIT SUPPORT DWG. 35-215-422, SHEET C3, C12, AND C13.
 5. ALL THESE NON-NSR CONDUITS TO BE SEISMICALLY SUPPORTED. THREADED ROD CRITERIA MAY NOT BE USED.

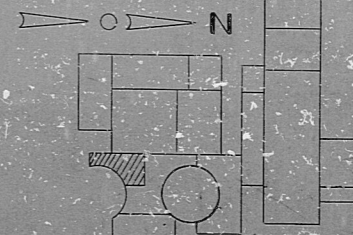

NUCLEAR SAFETY RELATED		
DATE	RELEASED FOR	
04/29/68	CONSTRUCTION SET	
	LIMITED CONSTRUCTION: AS NOTED	
	PRELIMINARY NOT FOR CONSTRUCTION BIDDING PURPOSES	
DATE	RELEASED FOR	ENGR.
THE CLEVELAND ELECTRIC ILLUMINATING COMPANY		
PERRY NUCLEAR POWER PLANT		
ELECTRICAL CONDUIT LAYOUT		
INTERMEDIATE BUILDING - SOUTH - EL. 200'-0"		
DESIGNED BY: COLONY ASSOCIATES, INC.		
CHECKED BY: [Signature]		
APPROVED BY: [Signature]		
DRAWING NO. 04-215-422 H		
DATE: 04-29-68		
DRAWING NUMBER: 04-215-422 H		

NO.	DATE	DESCRIPTION
1	04-29-68	ISSUED FOR CONSTRUCTION SET
2		
3		
4		
5		
6		
7		
8		
9		
10		
11		
12		
13		
14		
15		
16		
17		
18		
19		
20		
21		
22		
23		
24		
25		
26		
27		
28		
29		
30		
31		
32		
33		
34		
35		
36		
37		
38		
39		
40		
41		
42		
43		
44		
45		
46		
47		
48		
49		
50		

RIDS

8212100169

