

① TYPICAL CONDUIT INSTALLATION FOR VALVE SOLENOID & LIMIT SWITCHES

VALVE MPL No.	BOX No.	SOLENOID CND. No.	LIM. SW. CND. No. (OPEN)	LIM. SW. CND. No. (CLOSED)
IM14-F06S	TB-1-60	IM14-F06B	IM14-N066	IM14-C104B
IM14-F070	TB-1-C3	IM14-C103B	IM14-N071	IM14-C116A

- NOTES:
- FOR LEGEND, NOTES, REFERENCES, AND STANDARD DETAILS, SEE DWG. D-215-801.
 - CONDUIT CONTINUED UP - SEE DWG. D-215-382.
CONDUIT CONTINUED DOWN - SEE DWG. D-215-342.
 - THIS DRAWING TO BE WORKED IN CONJUNCTION WITH THE FOLLOWING ELECTRICAL SUPPORT DRAWINGS:
SS-215-382, SHEET C1
SS-215-382, SHEET C2
SS-215-382, SHEET C3
SS-215-382, SHEET C4
SS-215-382, SHEET C5
SS-215-382, SHEET C6

PRC APERTURE CARD

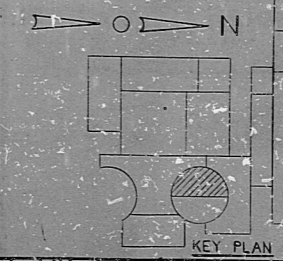

NUCLEAR SAFETY RELATED

REVISIONS	
4-2-68	CONSTRUCTION SP-23
	LIMITED CONSTRUCTION: AS NOTED
	PRELIMINARY NOT FOR CONSTRUCTION BIDDING PURPOSES
DATE	RELEASED FOR ENGR.
THE CLEVELAND ELECTRIC ILLUMINATING COMPANY	
PERNY NUCLEAR POWER PLANT UNIT 1	
ELECTRICAL UNIT 1	
CONDUIT LAYOUT	
REACTOR BUILDING - WEST - EL. 652'-2"	
DRAWING NO.	4549-D-215-352
DATE	04-25-68
SCALE	AS SHOWN
DESIGNED BY	EL
CHECKED BY	EL
APPROVED BY	EL

NO.	DATE	BY	CHKD.	APP.	REVISION
1	04-25-68	EL	EL	EL	ISSUED FOR CONSTRUCTION

45

8212100137

Rids

