

- NOTES:
- FOR LEGEND, NOTES, REFERENCES, AND STANDARD DETAILS, SEE DWG. D-215-001.
 - CONDUITS CONTINUED DOWN, SEE DWG. D-215-046.
 - THIS DRAWING TO BE WORKED IN CONJUNCTION WITH THE FOLLOWING ELECTRICAL CONDUIT SUPPORT DRAWINGS: D-215-007, SHEET C1

REVISED AS INDICATED	4 PLACES
J	REVISED PER ELEC. TEST 35-1024 AT COORDS BE 891.8'S
H	REVISED AS INDICATED
G	REVISED AS PER ELEC. TEST 35-1024 AT COORD A10
F	REVISED AS INDICATED
E	REVISED AS INDICATED
D	REVISED AS INDICATED
C	REVISED AS INDICATED
B	REVISED AS INDICATED
A	REVISED AS INDICATED

PRC APERTURE CARD

NUCLEAR SAFETY RELATED

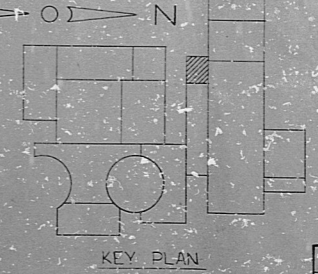

CONSTRUCTION	2/22/53
LIMITED CONSTRUCTION AS NOTED	
PRELIMINARY NOT FOR CONSTRUCTION	
BIIDDING PURPOSES	
DATE	RELEASED FOR ENGR.
THE CLEVELAND ELECTRIC ILLUMINATING COMPANY	
PERRY NUCLEAR POWER PLANT	
ELECTRICAL	UNIT 1
CONDUIT LAYOUT	
OFF-GAS BLDG. EL. 650'-0" MACHINERY RM. EL. 650'-0" AND 668'-3"	

DRAWING NO. 04 4549 D-215-087 J	
DRAWING NUMBER	
REV	

CNF LYN 04/8 EL 635-0 160-0 62-2

Rids

82-2080606

