

34"

34"

22"

22"

17"

17"

11"

11"

8.5"

8.5"

8.5"

8.5"

11"

11"

17"

17"

22"

22"

34"

34"

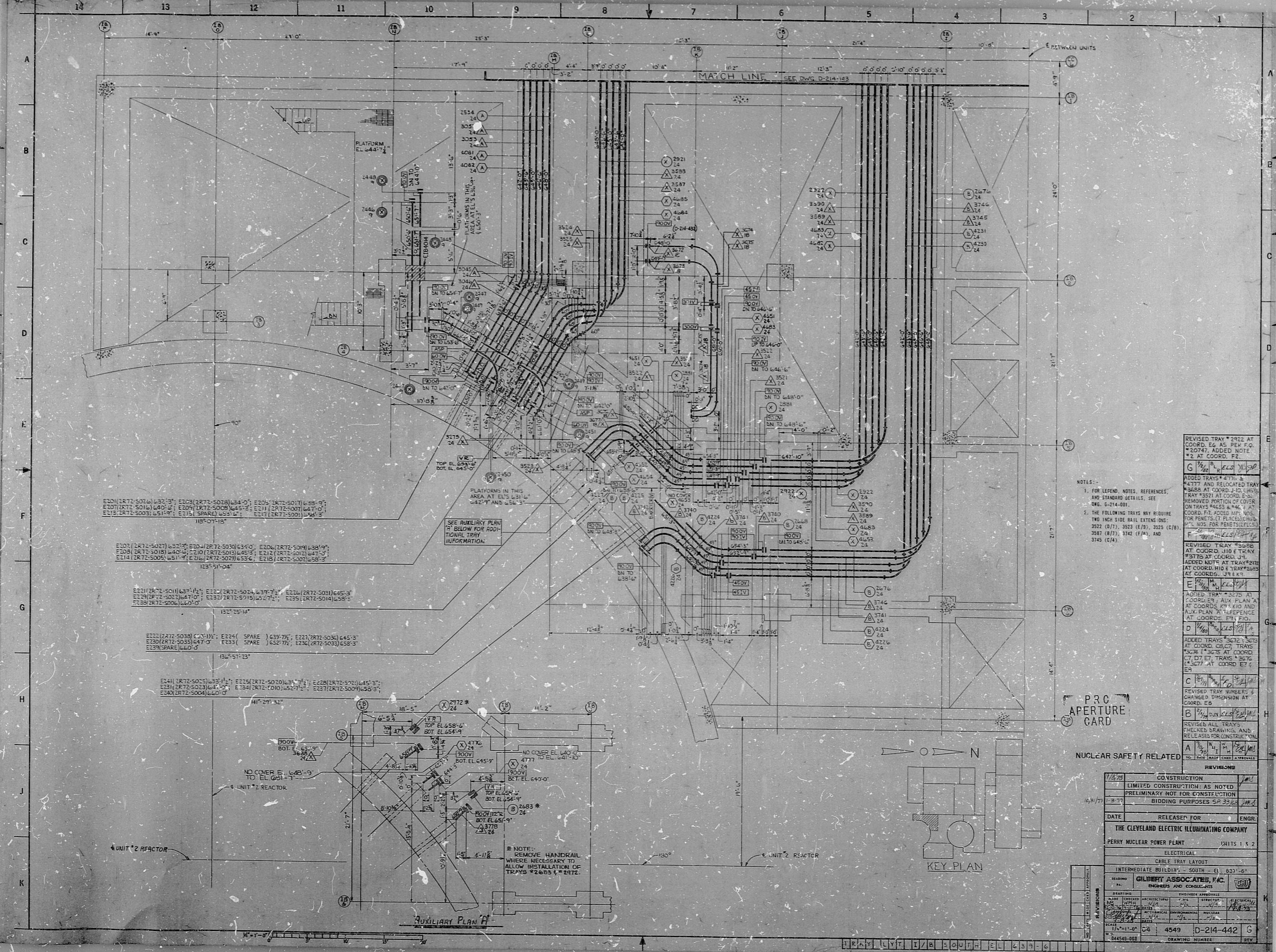

E201(2R72-5024) 632'-3"; E202(2R72-5028) 634'-0"; E203(2R72-5017) 638'-9";
 E204(2R72-5016) 640'-6"; E205(2R72-5008) 645'-3"; E211(2R72-5007) 647'-0";
 E215(2R72-5003) 651'-9"; E216(S) SPARE 655'-4"; E217(2R72-5001) 658'-3";
 185'-0" x 115"

E207(2R72-5027) 632'-3"; E208(2R72-5030) 634'-0"; E209(2R72-5019) 638'-9";
 E210(2R72-5018) 640'-6"; E212(2R72-5013) 645'-3"; E213(2R72-5012) 647'-0";
 E214(2R72-5005) 651'-9"; E218(2R72-5029) 653'-6"; E219(2R72-5002) 658'-3";
 123'-5" x 104"

E221(2R72-5011) 635'-1"; E222(2R72-5024) 639'-7"; E224(2R72-5031) 645'-3";
 E229(2R72-5023) 644'-0"; E231(2R72-5015) 652'-7"; E235(2R72-5014) 658'-3";
 E239(S) SPARE 660'-0";
 132'-25" x 14"

E222(2R72-5038) 633'-1"; E224(S) SPARE 639'-7"; E225(2R72-5036) 645'-3";
 E229(2R72-5023) 644'-0"; E231(S) SPARE 652'-7"; E234(2R72-5009) 658'-3";
 E239(S) SPARE 660'-0";
 136'-5" x 23"

E241(2R72-5025) 635'-1"; E225(2R72-5020) 637'-1"; E228(2R72-5021) 645'-3";
 E231(2R72-5023) 644'-0"; E234(2R72-5010) 652'-7"; E237(2R72-5009) 658'-3";
 E240(2R72-5004) 660'-0";
 141'-29" x 32"

E241(2R72-5025) 635'-1"; E225(2R72-5020) 637'-1"; E228(2R72-5021) 645'-3";
 E231(2R72-5023) 644'-0"; E234(2R72-5010) 652'-7"; E237(2R72-5009) 658'-3";
 E240(2R72-5004) 660'-0";
 141'-29" x 32"

E241(2R72-5025) 635'-1"; E225(2R72-5020) 637'-1"; E228(2R72-5021) 645'-3";
 E231(2R72-5023) 644'-0"; E234(2R72-5010) 652'-7"; E237(2R72-5009) 658'-3";
 E240(2R72-5004) 660'-0";
 141'-29" x 32"

E241(2R72-5025) 635'-1"; E225(2R72-5020) 637'-1"; E228(2R72-5021) 645'-3";
 E231(2R72-5023) 644'-0"; E234(2R72-5010) 652'-7"; E237(2R72-5009) 658'-3";
 E240(2R72-5004) 660'-0";
 141'-29" x 32"

E241(2R72-5025) 635'-1"; E225(2R72-5020) 637'-1"; E228(2R72-5021) 645'-3";
 E231(2R72-5023) 644'-0"; E234(2R72-5010) 652'-7"; E237(2R72-5009) 658'-3";
 E240(2R72-5004) 660'-0";
 141'-29" x 32"

E241(2R72-5025) 635'-1"; E225(2R72-5020) 637'-1"; E228(2R72-5021) 645'-3";
 E231(2R72-5023) 644'-0"; E234(2R72-5010) 652'-7"; E237(2R72-5009) 658'-3";
 E240(2R72-5004) 660'-0";
 141'-29" x 32"

E241(2R72-5025) 635'-1"; E225(2R72-5020) 637'-1"; E228(2R72-5021) 645'-3";
 E231(2R72-5023) 644'-0"; E234(2R72-5010) 652'-7"; E237(2R72-5009) 658'-3";
 E240(2R72-5004) 660'-0";
 141'-29" x 32"

- NOTES:
- FOR LEGEND, NOTES, REFERENCES, AND STANDARD DETAILS, SEE ENG. D-214-481E.
 - THE FOLLOWING TRAYS MAY REQUIRE TWO INCH SIDE RAIL EXTENS: 3522 (D/7), 3523 (E/8), 3525 (C/8), 3587 (B/7), 3742 (F/A), AND 3745 (C/A).

REVISED TRAY #2922 AT COORD. E6 AS PER F.O. #20747, ADDED NOTE #2 AT COORD. E2.

ADDED TRAYS #477, #477T AND RELOCATED TRAY #3888 AT COORD. J10. (REVISED TRAY #3571 AT COORD. J5. REMOVED PORTION OF COVER ON TRAYS #4653 & #4671 AT COORD. F7. ADDED IMP. NOS. FOR PENETS. (T PLACES) (C/L/S). NOS FOR PENETS (C/L/S).

REVISED TRAY #3588 AT COORD. J10 & TRAY #3710 AT COORD. J5. ADDED NOTE AT TRAY #2922 AT COORD. MID E TRAYS #2925 AT COORD. J4 & K9.

ADDED TRAY #3575 AT COORD. E5; AUX. PLAN A AT COORD. J9 & J10 AND AUX. PLAN A REFERENCE AT COORD. F11 F10.

ADDED TRAYS #3672 & #3673 AT COORD. C8, C7, TRAYS #3674 & #3675 AT COORD. C7, D7. TRAYS #3676 & #3677 AT COORD. E7 & E9.

REVISED TRAY NUMBERS & CHANGED DIMENSION AT COORD. E8.

REVISED ALL TRAYS. CHECKED DRAWING AND RELEASED FOR CONSTRUCTION.

NO. DATE REASON FOR APPROVAL

PRC APERTURE CARD

NUCLEAR SAFETY RELATED

REVISIONS	
1/16/79	CONSTRUCTION
	LIMITED CONSTRUCTION: AS NOTED
	PRELIMINARY NOT FOR CONSTRUCTION
	BIDDING PURPOSES SP 33/35 JML
1/31/77	DATE RELEASED FOR ENGR.
THE CLEVELAND ELECTRIC ILLUMINATING COMPANY	
PERRY NUCLEAR POWER PLANT UNITS 1 & 2	
ELECTRICAL	
CABLE TRAY LAYOUT	
INTERMEDIATE BUILDING - SOUTH - 61, 633'-6"	
DESIGNED BY	GILBERT ASSOCIATES, P.C.
ENGINEERS AND CONSULTANTS	
DRAWING NO.	D-214-442
SCALE	1/8"=1'-0"
DATE	1/16/79
W.D.	84548-000
DRAWING NUMBER	4549
REV	6

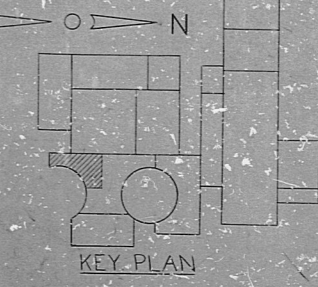

AUXILIARY PLAN A

KEY PLAN

RIDS

8212080367

