

6118 E-133

SIZE E

34
22
17
11
8.5
11
8.5
11
17
22
A

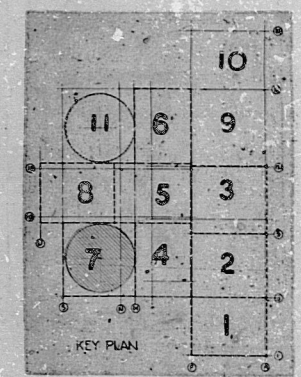
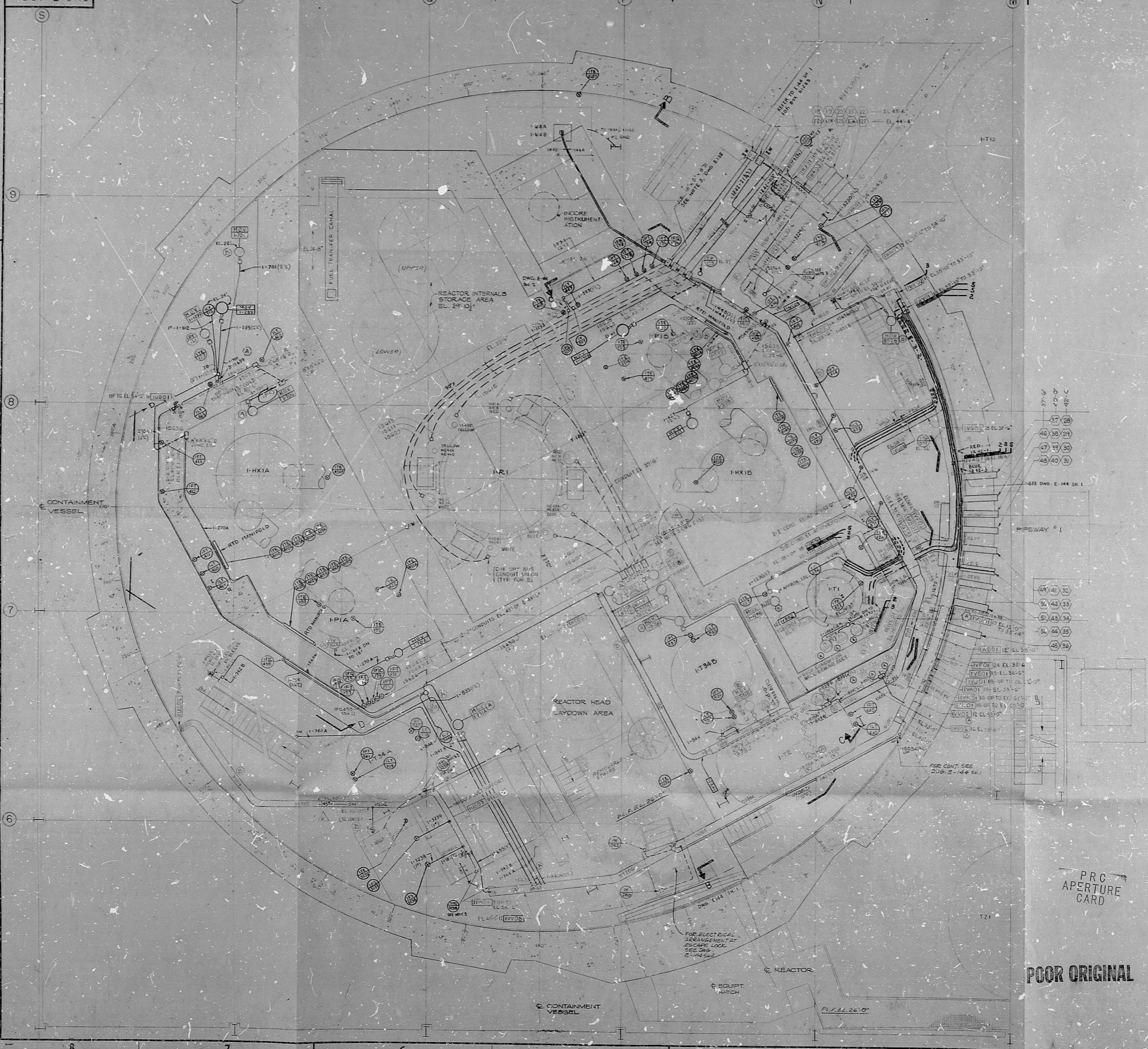

NOTES

- 1. FOR GENERAL NOTES AND REFERENCE DWGS. SEE DWG. 6118 E-134 (E-134)
- 2. FOR INSTRUMENTATION IN THIS AREA SEE DWG. E-165.
- 3. VIBRATION SWITCHES ARE MOUNTED AT THE PAN HOUSING
- DIV. A PP 1301-1305
- DIV. B PP 1401-1405
- DIV. D PP 1201-1205

NO.	DATE	REVISIONS	BY	CHK	APP	GROUP
1	11/30/66	FINAL ISSUE TO CLIENT				
2	12/2/66	ADDED RE BUS, INSTR 3, AND COND'S 1-459, 3546	PC			
3	5/17/67	ADDED COND'S 1-459, 3546				
4	11/30/66	ADDED INSTRUMENTS CONDUIT AS SHOWN				
5	12/2/66	ADDED INSTRUMENTS CONDUIT AS SHOWN				
6	12/2/66	ADDED INSTRUMENTS CONDUIT AS SHOWN				
7	12/2/66	ADDED INSTRUMENTS CONDUIT AS SHOWN				
8	12/2/66	ADDED INSTRUMENTS CONDUIT AS SHOWN				
9	12/2/66	ADDED INSTRUMENTS CONDUIT AS SHOWN				
10	12/2/66	ADDED INSTRUMENTS CONDUIT AS SHOWN				

BECHTEL
SAN FRANCISCO

WESTINGHOUSE ELECTRIC CORPORATION
ATOMIC POWER DIVISION

POINT BEACH NUCLEAR PLANT
WISCONSIN MICHIGAN POWER CO. UNIT 1
WISCONSIN ELECTRIC POWER CO. UNIT 2

ELECTRICAL LAYOUT CONTAINMENT VESSEL
AREA NO 7
ELEVATION 21'-0"

JOB NO. **6118** DRAWING NO. **E-133**

PRC APERTURE CARD

POOR ORIGINAL

6118 E-133

RIDS

8210050280

