

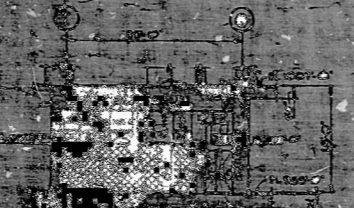

SECTION 5-6



THIS SECTION IS TO BE CONSIDERED AS A GENERAL REFERENCE ONLY. FOR COMPLETE DETAILS, SEE DRAWING NO. 10000 AND DRAWING NO. 10001. THE DRAWING NO. 10000 IS THE MAIN DRAWING AND DRAWING NO. 10001 IS THE DETAIL DRAWING. ALL DIMENSIONS ARE IN INCHES UNLESS OTHERWISE SPECIFIED. THE DRAWING NO. 10000 IS THE MAIN DRAWING AND DRAWING NO. 10001 IS THE DETAIL DRAWING. ALL DIMENSIONS ARE IN INCHES UNLESS OTHERWISE SPECIFIED.

POOR ORIGINAL

PRC  
APERTURE  
CARD

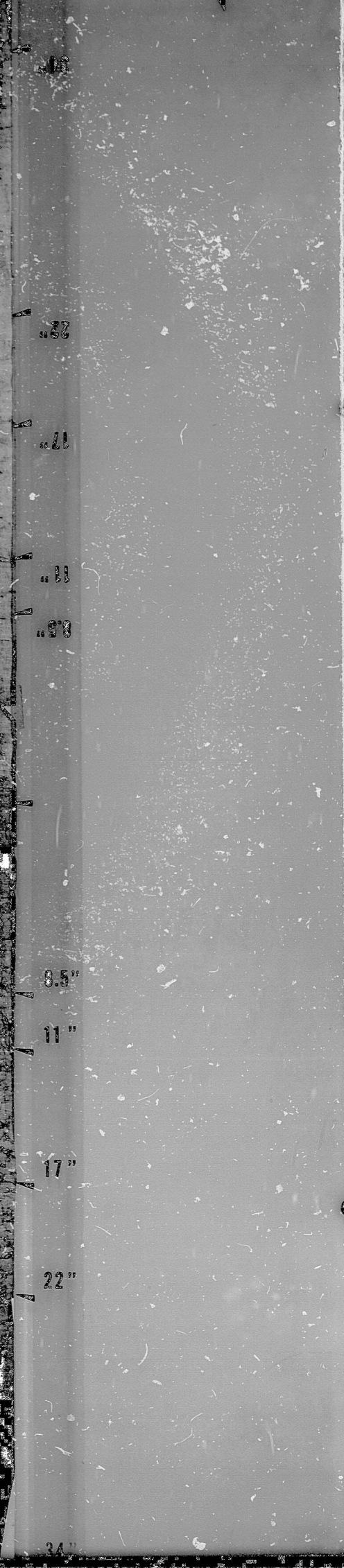
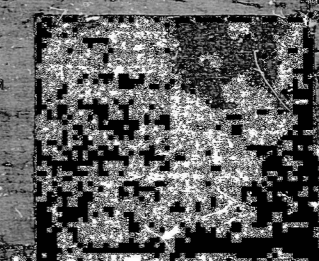

27

28

29

30

8.5"

11"

17"

22"

24"

10000

RDS

8208310179

