

SPACE NO	SPACE DESCRIPTION	FIRE AREA CLASS	FLOOR CLASS
200	CLARK LABORATORY RESEARCH	0-1	NO
201	CLARK LABORATORY RESEARCH	0-1	NO
202	PERFUME AREA	0-1	NO
203	PERFUME AREA	0-1	NO
204	PERFUME AREA	0-1	NO
205	PERFUME AREA	0-1	NO
206	PERFUME AREA	0-1	NO
207	PERFUME AREA	0-1	NO
208	PERFUME AREA	0-1	NO
209	PERFUME AREA	0-1	NO
210	PERFUME AREA	0-1	NO
211	PERFUME AREA	0-1	NO
212	PERFUME AREA	0-1	NO
213	PERFUME AREA	0-1	NO
214	PERFUME AREA	0-1	NO
215	PERFUME AREA	0-1	NO
216	PERFUME AREA	0-1	NO
217	PERFUME AREA	0-1	NO
218	PERFUME AREA	0-1	NO
219	PERFUME AREA	0-1	NO
220	PERFUME AREA	0-1	NO
221	PERFUME AREA	0-1	NO
222	PERFUME AREA	0-1	NO
223	PERFUME AREA	0-1	NO
224	PERFUME AREA	0-1	NO
225	PERFUME AREA	0-1	NO
226	PERFUME AREA	0-1	NO
227	PERFUME AREA	0-1	NO
228	PERFUME AREA	0-1	NO
229	PERFUME AREA	0-1	NO
230	PERFUME AREA	0-1	NO
231	PERFUME AREA	0-1	NO
232	PERFUME AREA	0-1	NO
233	PERFUME AREA	0-1	NO
234	PERFUME AREA	0-1	NO
235	PERFUME AREA	0-1	NO
236	PERFUME AREA	0-1	NO
237	PERFUME AREA	0-1	NO
238	PERFUME AREA	0-1	NO
239	PERFUME AREA	0-1	NO
240	PERFUME AREA	0-1	NO
241	PERFUME AREA	0-1	NO
242	PERFUME AREA	0-1	NO
243	PERFUME AREA	0-1	NO
244	PERFUME AREA	0-1	NO
245	PERFUME AREA	0-1	NO
246	PERFUME AREA	0-1	NO
247	PERFUME AREA	0-1	NO
248	PERFUME AREA	0-1	NO
249	PERFUME AREA	0-1	NO
250	PERFUME AREA	0-1	NO
251	PERFUME AREA	0-1	NO
252	PERFUME AREA	0-1	NO
253	PERFUME AREA	0-1	NO
254	PERFUME AREA	0-1	NO
255	PERFUME AREA	0-1	NO
256	PERFUME AREA	0-1	NO
257	PERFUME AREA	0-1	NO
258	PERFUME AREA	0-1	NO
259	PERFUME AREA	0-1	NO
260	PERFUME AREA	0-1	NO
261	PERFUME AREA	0-1	NO
262	PERFUME AREA	0-1	NO
263	PERFUME AREA	0-1	NO
264	PERFUME AREA	0-1	NO
265	PERFUME AREA	0-1	NO
266	PERFUME AREA	0-1	NO
267	PERFUME AREA	0-1	NO
268	PERFUME AREA	0-1	NO
269	PERFUME AREA	0-1	NO
270	PERFUME AREA	0-1	NO
271	PERFUME AREA	0-1	NO
272	PERFUME AREA	0-1	NO
273	PERFUME AREA	0-1	NO
274	PERFUME AREA	0-1	NO
275	PERFUME AREA	0-1	NO
276	PERFUME AREA	0-1	NO
277	PERFUME AREA	0-1	NO
278	PERFUME AREA	0-1	NO
279	PERFUME AREA	0-1	NO
280	PERFUME AREA	0-1	NO
281	PERFUME AREA	0-1	NO
282	PERFUME AREA	0-1	NO
283	PERFUME AREA	0-1	NO
284	PERFUME AREA	0-1	NO
285	PERFUME AREA	0-1	NO
286	PERFUME AREA	0-1	NO
287	PERFUME AREA	0-1	NO
288	PERFUME AREA	0-1	NO
289	PERFUME AREA	0-1	NO
290	PERFUME AREA	0-1	NO
291	PERFUME AREA	0-1	NO
292	PERFUME AREA	0-1	NO
293	PERFUME AREA	0-1	NO
294	PERFUME AREA	0-1	NO
295	PERFUME AREA	0-1	NO
296	PERFUME AREA	0-1	NO
297	PERFUME AREA	0-1	NO
298	PERFUME AREA	0-1	NO
299	PERFUME AREA	0-1	NO
300	PERFUME AREA	0-1	NO

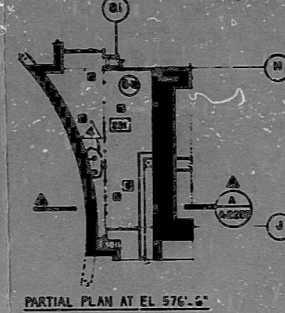
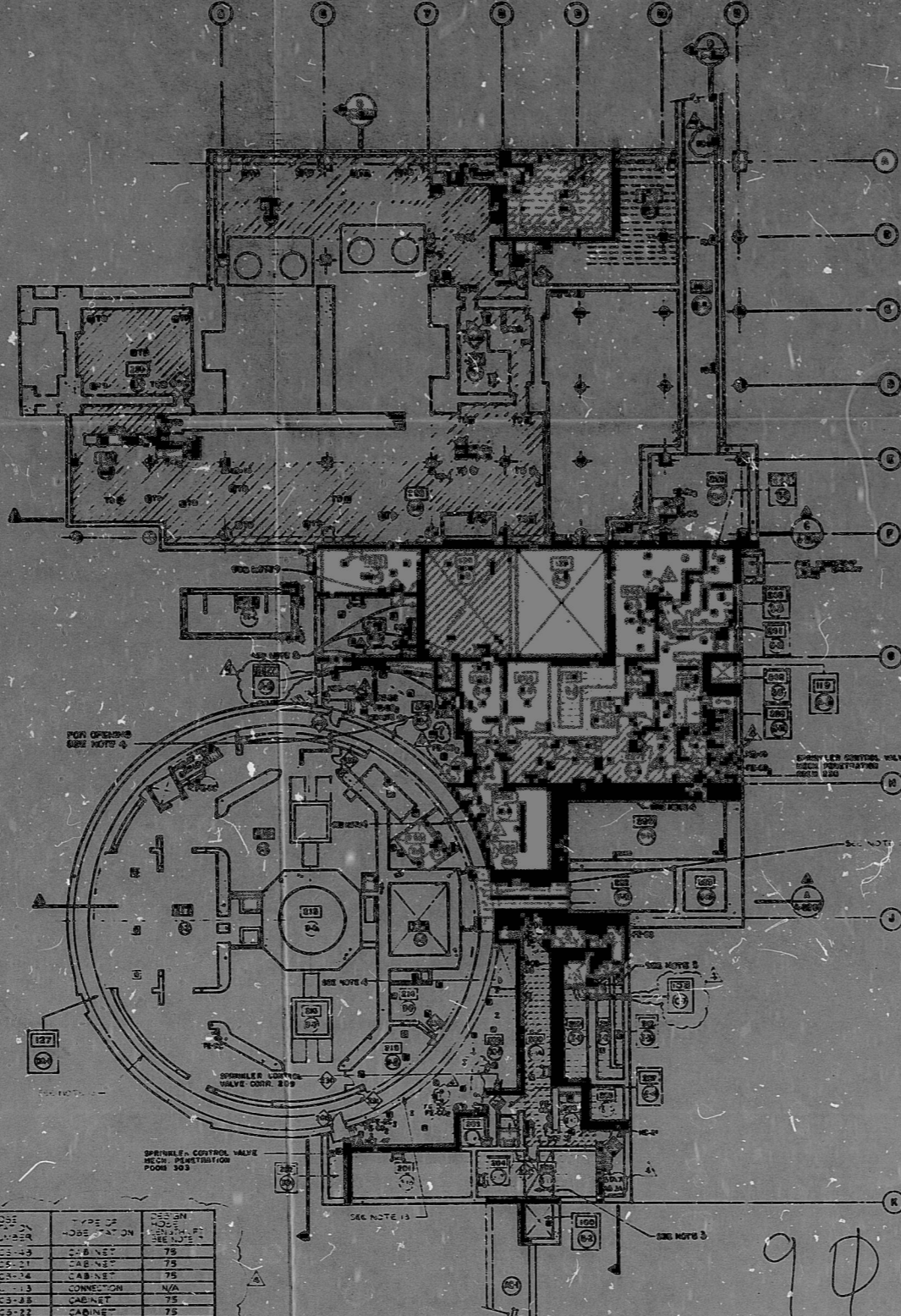

**SI APERTURE CARD**

9 0 0 1 0 3 0 3 0 3

NOTE:  
THE FIRE EXTINGUISHER SYMBOLS REFLECT THE AS-INSTALLED CONDITION WHICH HAS BEEN DOCUMENTED AS DEFICIENT WITH RESPECT TO NFPA 10 REQUIREMENTS BY PCAQ 89-0015.

1. CONSTRUCTION OF THIS DRAWING IS BASED UPON THE INFORMATION PROVIDED BY THE ARCHITECT AND ENGINEER.
2. THE ARCHITECT AND ENGINEER ARE NOT RESPONSIBLE FOR THE ACCURACY OF THE INFORMATION PROVIDED BY THE ARCHITECT AND ENGINEER.
3. THE ARCHITECT AND ENGINEER ARE NOT RESPONSIBLE FOR THE ACCURACY OF THE INFORMATION PROVIDED BY THE ARCHITECT AND ENGINEER.
4. THE ARCHITECT AND ENGINEER ARE NOT RESPONSIBLE FOR THE ACCURACY OF THE INFORMATION PROVIDED BY THE ARCHITECT AND ENGINEER.
5. THE ARCHITECT AND ENGINEER ARE NOT RESPONSIBLE FOR THE ACCURACY OF THE INFORMATION PROVIDED BY THE ARCHITECT AND ENGINEER.
6. THE ARCHITECT AND ENGINEER ARE NOT RESPONSIBLE FOR THE ACCURACY OF THE INFORMATION PROVIDED BY THE ARCHITECT AND ENGINEER.
7. THE ARCHITECT AND ENGINEER ARE NOT RESPONSIBLE FOR THE ACCURACY OF THE INFORMATION PROVIDED BY THE ARCHITECT AND ENGINEER.
8. THE ARCHITECT AND ENGINEER ARE NOT RESPONSIBLE FOR THE ACCURACY OF THE INFORMATION PROVIDED BY THE ARCHITECT AND ENGINEER.
9. THE ARCHITECT AND ENGINEER ARE NOT RESPONSIBLE FOR THE ACCURACY OF THE INFORMATION PROVIDED BY THE ARCHITECT AND ENGINEER.
10. THE ARCHITECT AND ENGINEER ARE NOT RESPONSIBLE FOR THE ACCURACY OF THE INFORMATION PROVIDED BY THE ARCHITECT AND ENGINEER.
11. THE ARCHITECT AND ENGINEER ARE NOT RESPONSIBLE FOR THE ACCURACY OF THE INFORMATION PROVIDED BY THE ARCHITECT AND ENGINEER.
12. THE ARCHITECT AND ENGINEER ARE NOT RESPONSIBLE FOR THE ACCURACY OF THE INFORMATION PROVIDED BY THE ARCHITECT AND ENGINEER.
13. THE ARCHITECT AND ENGINEER ARE NOT RESPONSIBLE FOR THE ACCURACY OF THE INFORMATION PROVIDED BY THE ARCHITECT AND ENGINEER.
14. THE ARCHITECT AND ENGINEER ARE NOT RESPONSIBLE FOR THE ACCURACY OF THE INFORMATION PROVIDED BY THE ARCHITECT AND ENGINEER.
15. THE ARCHITECT AND ENGINEER ARE NOT RESPONSIBLE FOR THE ACCURACY OF THE INFORMATION PROVIDED BY THE ARCHITECT AND ENGINEER.
16. THE ARCHITECT AND ENGINEER ARE NOT RESPONSIBLE FOR THE ACCURACY OF THE INFORMATION PROVIDED BY THE ARCHITECT AND ENGINEER.
17. THE ARCHITECT AND ENGINEER ARE NOT RESPONSIBLE FOR THE ACCURACY OF THE INFORMATION PROVIDED BY THE ARCHITECT AND ENGINEER.
18. THE ARCHITECT AND ENGINEER ARE NOT RESPONSIBLE FOR THE ACCURACY OF THE INFORMATION PROVIDED BY THE ARCHITECT AND ENGINEER.
19. THE ARCHITECT AND ENGINEER ARE NOT RESPONSIBLE FOR THE ACCURACY OF THE INFORMATION PROVIDED BY THE ARCHITECT AND ENGINEER.
20. THE ARCHITECT AND ENGINEER ARE NOT RESPONSIBLE FOR THE ACCURACY OF THE INFORMATION PROVIDED BY THE ARCHITECT AND ENGINEER.

- LEGEND**
- 1. THE ARCHITECTURAL SYMBOLS INDICATED BY THE CODE ARE THE EXISTING CONDITIONS. DIMENSIONS ARE FOR THE EXISTING CONDITIONS UNLESS OTHERWISE NOTED.
  - 2. THE ARCHITECTURAL SYMBOLS INDICATED BY THE CODE ARE THE EXISTING CONDITIONS. DIMENSIONS ARE FOR THE EXISTING CONDITIONS UNLESS OTHERWISE NOTED.
  - 3. THE ARCHITECTURAL SYMBOLS INDICATED BY THE CODE ARE THE EXISTING CONDITIONS. DIMENSIONS ARE FOR THE EXISTING CONDITIONS UNLESS OTHERWISE NOTED.
  - 4. THE ARCHITECTURAL SYMBOLS INDICATED BY THE CODE ARE THE EXISTING CONDITIONS. DIMENSIONS ARE FOR THE EXISTING CONDITIONS UNLESS OTHERWISE NOTED.
  - 5. THE ARCHITECTURAL SYMBOLS INDICATED BY THE CODE ARE THE EXISTING CONDITIONS. DIMENSIONS ARE FOR THE EXISTING CONDITIONS UNLESS OTHERWISE NOTED.
  - 6. THE ARCHITECTURAL SYMBOLS INDICATED BY THE CODE ARE THE EXISTING CONDITIONS. DIMENSIONS ARE FOR THE EXISTING CONDITIONS UNLESS OTHERWISE NOTED.
  - 7. THE ARCHITECTURAL SYMBOLS INDICATED BY THE CODE ARE THE EXISTING CONDITIONS. DIMENSIONS ARE FOR THE EXISTING CONDITIONS UNLESS OTHERWISE NOTED.
  - 8. THE ARCHITECTURAL SYMBOLS INDICATED BY THE CODE ARE THE EXISTING CONDITIONS. DIMENSIONS ARE FOR THE EXISTING CONDITIONS UNLESS OTHERWISE NOTED.
  - 9. THE ARCHITECTURAL SYMBOLS INDICATED BY THE CODE ARE THE EXISTING CONDITIONS. DIMENSIONS ARE FOR THE EXISTING CONDITIONS UNLESS OTHERWISE NOTED.
  - 10. THE ARCHITECTURAL SYMBOLS INDICATED BY THE CODE ARE THE EXISTING CONDITIONS. DIMENSIONS ARE FOR THE EXISTING CONDITIONS UNLESS OTHERWISE NOTED.
  - 11. THE ARCHITECTURAL SYMBOLS INDICATED BY THE CODE ARE THE EXISTING CONDITIONS. DIMENSIONS ARE FOR THE EXISTING CONDITIONS UNLESS OTHERWISE NOTED.
  - 12. THE ARCHITECTURAL SYMBOLS INDICATED BY THE CODE ARE THE EXISTING CONDITIONS. DIMENSIONS ARE FOR THE EXISTING CONDITIONS UNLESS OTHERWISE NOTED.
  - 13. THE ARCHITECTURAL SYMBOLS INDICATED BY THE CODE ARE THE EXISTING CONDITIONS. DIMENSIONS ARE FOR THE EXISTING CONDITIONS UNLESS OTHERWISE NOTED.
  - 14. THE ARCHITECTURAL SYMBOLS INDICATED BY THE CODE ARE THE EXISTING CONDITIONS. DIMENSIONS ARE FOR THE EXISTING CONDITIONS UNLESS OTHERWISE NOTED.
  - 15. THE ARCHITECTURAL SYMBOLS INDICATED BY THE CODE ARE THE EXISTING CONDITIONS. DIMENSIONS ARE FOR THE EXISTING CONDITIONS UNLESS OTHERWISE NOTED.
  - 16. THE ARCHITECTURAL SYMBOLS INDICATED BY THE CODE ARE THE EXISTING CONDITIONS. DIMENSIONS ARE FOR THE EXISTING CONDITIONS UNLESS OTHERWISE NOTED.
  - 17. THE ARCHITECTURAL SYMBOLS INDICATED BY THE CODE ARE THE EXISTING CONDITIONS. DIMENSIONS ARE FOR THE EXISTING CONDITIONS UNLESS OTHERWISE NOTED.
  - 18. THE ARCHITECTURAL SYMBOLS INDICATED BY THE CODE ARE THE EXISTING CONDITIONS. DIMENSIONS ARE FOR THE EXISTING CONDITIONS UNLESS OTHERWISE NOTED.
  - 19. THE ARCHITECTURAL SYMBOLS INDICATED BY THE CODE ARE THE EXISTING CONDITIONS. DIMENSIONS ARE FOR THE EXISTING CONDITIONS UNLESS OTHERWISE NOTED.
  - 20. THE ARCHITECTURAL SYMBOLS INDICATED BY THE CODE ARE THE EXISTING CONDITIONS. DIMENSIONS ARE FOR THE EXISTING CONDITIONS UNLESS OTHERWISE NOTED.

DATE	BY	CHKD	APP'D
BECHTEL COMPANY SAN FRANCISCO, CALIFORNIA			
DAVIS-BESSE NUCLEAR POWER STATION THE TRILEGAN COMPANY COMPANY THE CLEVELAND ELECTRIC ILLUMINATION COMPANY			
FIRE PROTECTION GENERAL FLOOR PLAN EL 565'-0"			

THIS DWG. REPLACES DWG. A-202F REV. 2	JOB NO. 12501	DRAWING NO. A-222F	REV. 4
--	------------------	-----------------------	-----------

I CERTIFY THAT THE ENGINE COPY OF THIS DRAWING IS THE ORIGINAL AND REGULAR COPY. I HEREBY, BY THE ABOVE SIGNED FILED AND DATED: 12 28 1974, REPRESENT THE ACCURACY OF THE RECORDS KEPT BY THE ARCHITECT AND ENGINEER.

**PDR RIDS**

**9001030303**

