

PLAN AT EL 225'-0"
Pour #40 B

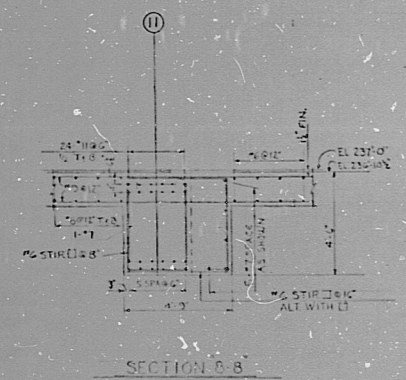

SECTION A-B

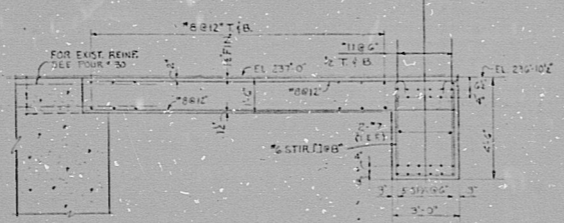

SECTION C-C

PLAN AT EL 237'-0"
Pour #40 C

REFERENCE DIMS.
FOR REINF: POUR #30 - C-15234-C, C-15234-C
POUR #31 - C-15234-C, C-15237-C
POUR #40A - C-15237-C
FOR DETAILS: C-15211-C, SH 142
FOR WATERSTOPS, CONST. JOINTS + KEYS: C-15217-C SH 314
C-15214-C SH 1 THRU 10.

NOTE:
LAP OR SPALL REINF 40 DIA UNLESS NOTED
EDGE DISTANCE TO REINFORCEMENT + DIMENSIONS
SHOWN BETWEEN LINES OF BARS ARE TO C OF BARS
BAR DETAILS + DIMENSIONS GIVEN ARE OUT TO OUT
FOR CONCRETE SP. 25, SET #1450.

SCALE 3/4" = 1'-0"

NIAGARA MOHAWK
NIAGARA MOHAWK POWER CORPORATION
NINE MILE POINT NUCLEAR STATION
REACTOR BLDG
REINFORCING DETAILS
EL 218'-0" TO EL 232'-4" - POUR #40 B
EL 232'-4" TO EL 237'-0" - POUR #40 C

15266-C
SH 109-C

TERA
APERTURE
CARD

8012300529

PDR-RID5

812300524

