

17"

17"

11"

11"

8.5"

8.5"

8.5"

8.5"

11"

11"

17"

17"

LOCATION	COORDINATES
1	N 242,002.8 E 2,000.000
2	N 242,002.8 E 2,000.000
3	N 242,002.8 E 2,000.000
4	N 242,002.8 E 2,000.000
5	N 242,002.8 E 2,000.000
6	N 242,002.8 E 2,000.000
7	N 242,002.8 E 2,000.000
8	N 242,002.8 E 2,000.000
9	N 242,002.8 E 2,000.000
10	N 242,002.8 E 2,000.000
11	N 242,002.8 E 2,000.000
12	N 242,002.8 E 2,000.000
13	N 242,002.8 E 2,000.000
14	N 242,002.8 E 2,000.000
15	N 242,002.8 E 2,000.000
16	N 242,002.8 E 2,000.000
17	N 242,002.8 E 2,000.000
18	N 242,002.8 E 2,000.000
19	N 242,002.8 E 2,000.000
20	N 242,002.8 E 2,000.000
21	N 242,002.8 E 2,000.000
22	N 242,002.8 E 2,000.000
23	N 242,002.8 E 2,000.000
24	N 242,002.8 E 2,000.000
25	N 242,002.8 E 2,000.000
26	N 242,002.8 E 2,000.000
27	N 242,002.8 E 2,000.000
28	N 242,002.8 E 2,000.000
29	N 242,002.8 E 2,000.000
30	N 242,002.8 E 2,000.000
31	N 242,002.8 E 2,000.000
32	N 242,002.8 E 2,000.000
33	N 242,002.8 E 2,000.000
34	N 242,002.8 E 2,000.000
35	N 242,002.8 E 2,000.000
36	N 242,002.8 E 2,000.000
37	N 242,002.8 E 2,000.000
38	N 242,002.8 E 2,000.000
39	N 242,002.8 E 2,000.000
40	N 242,002.8 E 2,000.000
41	N 242,002.8 E 2,000.000
42	N 242,002.8 E 2,000.000
43	N 242,002.8 E 2,000.000
44	N 242,002.8 E 2,000.000
45	N 242,002.8 E 2,000.000
46	N 242,002.8 E 2,000.000
47	N 242,002.8 E 2,000.000
48	N 242,002.8 E 2,000.000
49	N 242,002.8 E 2,000.000
50	N 242,002.8 E 2,000.000
51	N 242,002.8 E 2,000.000
52	N 242,002.8 E 2,000.000
53	N 242,002.8 E 2,000.000
54	N 242,002.8 E 2,000.000
55	N 242,002.8 E 2,000.000
56	N 242,002.8 E 2,000.000
57	N 242,002.8 E 2,000.000
58	N 242,002.8 E 2,000.000
59	N 242,002.8 E 2,000.000
60	N 242,002.8 E 2,000.000
61	N 242,002.8 E 2,000.000
62	N 242,002.8 E 2,000.000
63	N 242,002.8 E 2,000.000
64	N 242,002.8 E 2,000.000
65	N 242,002.8 E 2,000.000
66	N 242,002.8 E 2,000.000
67	N 242,002.8 E 2,000.000
68	N 242,002.8 E 2,000.000
69	N 242,002.8 E 2,000.000
70	N 242,002.8 E 2,000.000
71	N 242,002.8 E 2,000.000
72	N 242,002.8 E 2,000.000
73	N 242,002.8 E 2,000.000
74	N 242,002.8 E 2,000.000
75	N 242,002.8 E 2,000.000
76	N 242,002.8 E 2,000.000
77	N 242,002.8 E 2,000.000
78	N 242,002.8 E 2,000.000
79	N 242,002.8 E 2,000.000
80	N 242,002.8 E 2,000.000
81	N 242,002.8 E 2,000.000
82	N 242,002.8 E 2,000.000
83	N 242,002.8 E 2,000.000
84	N 242,002.8 E 2,000.000
85	N 242,002.8 E 2,000.000
86	N 242,002.8 E 2,000.000
87	N 242,002.8 E 2,000.000
88	N 242,002.8 E 2,000.000
89	N 242,002.8 E 2,000.000
90	N 242,002.8 E 2,000.000
91	N 242,002.8 E 2,000.000
92	N 242,002.8 E 2,000.000
93	N 242,002.8 E 2,000.000
94	N 242,002.8 E 2,000.000
95	N 242,002.8 E 2,000.000
96	N 242,002.8 E 2,000.000
97	N 242,002.8 E 2,000.000
98	N 242,002.8 E 2,000.000
99	N 242,002.8 E 2,000.000
100	N 242,002.8 E 2,000.000

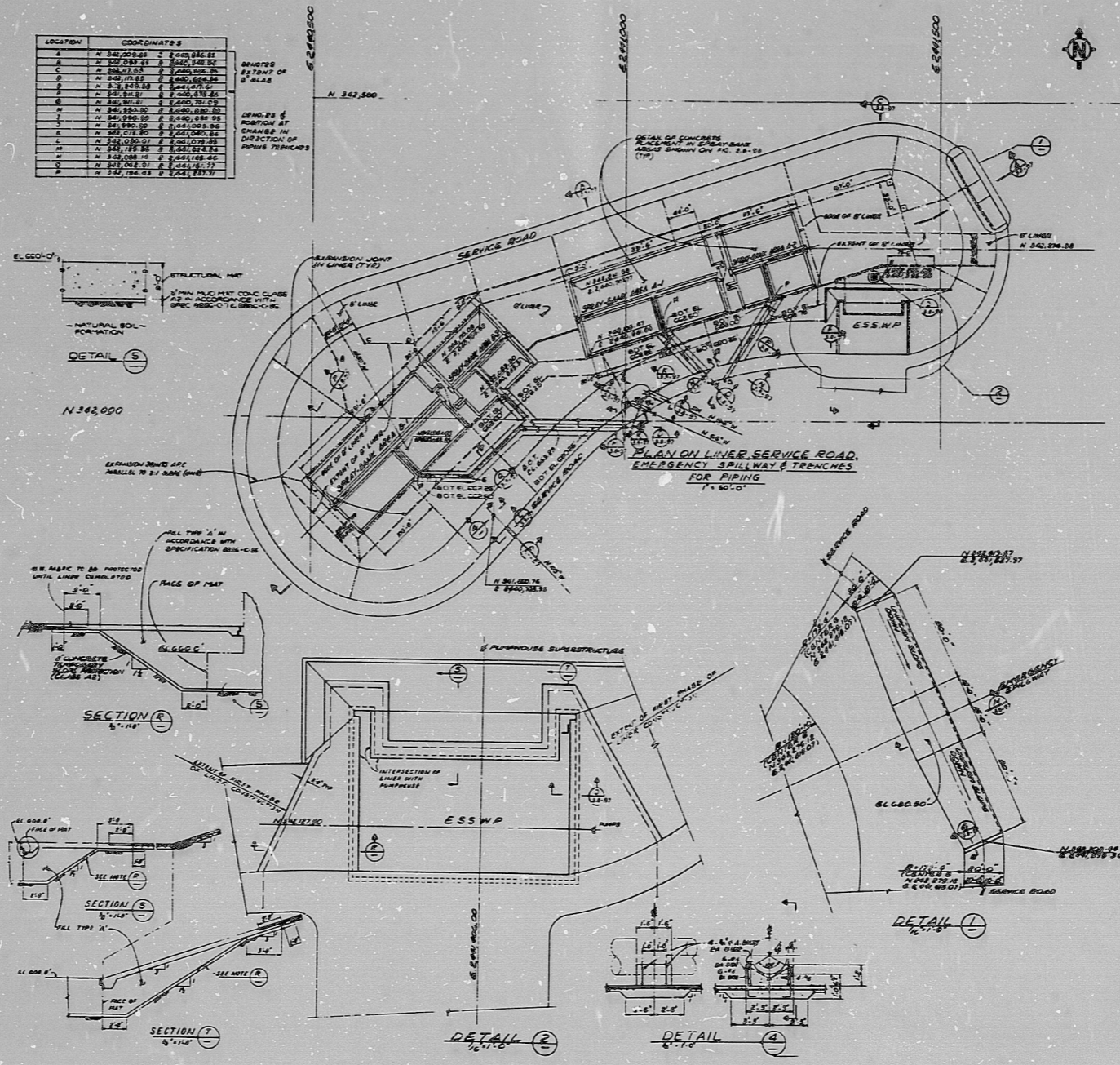

TERA
APERTURE
CARD

SUSQUEHANNA STEAM ELECTRIC STATION
UNITS 1 AND 2
FINAL SAFETY ANALYSIS REPORT

SPRAY POND
PLAN OF LINER SERVICE ROAD
AND TRENCHES FOR PIPING

8012180651
FIGURE 3.8-95

RIDS — PDR

8012180651

