

- NOTES:**
- FOR NOTES REFERENCE DRAWINGS & GENERAL NOTES SEE DWGS. C-103, C-191 & C-301
 - CONCRETE SHALL BE 4000 PSI (F_c) UNO.
 - FOR ADDITIONAL PENETRATIONS SEE PLANT DESIGN X-SERIES DRAWINGS. WHERE CONFLICTS EXIST, X-DRAWINGS SHALL GOVERN.
 - REINFORCING AROUND STEAM VENT SLEEVE MAY BE MOVED WHEN IT INTERFERES WITH IMBEDDED BEAMS.

REFERENCE DWGS.

BECHTEL NO.	PL. NO.
C-804	E-105559 SH2
C-1066	E-105899
C-304	E-105881
C-330	E-105331 SH7

REFERENCE DWGS.

BECHTEL NO.	PL. NO.
C-103	E-106198-7
C-142	E-106312-3
C-191	E-106338-3
C-801	E-106355-7
C-168	E-106361-4
C-208	E-106365-3
C-146	E-106373-3
C-326	E-106621 SH1
C-1034	E-105841

WALL ELEVATION COLUMN LINE 37.4
(LOOKING SOUTH)

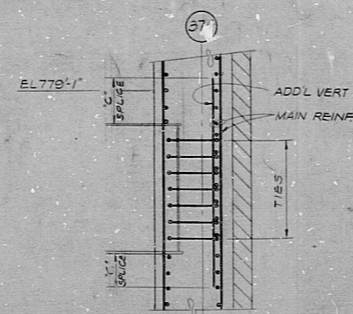

DETAIL 2
2'-1" O"

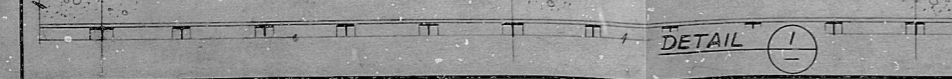

DETAIL 1
1'-0" O"

NO.	DATE	REVISIONS	BY	CHECKED	APPROVED
1		ISSUED FOR REBAR FABRICATION			
2		ISSUED FOR REINFORCING			
3		ISSUED FOR CONSTRUCTION			
4		ISSUED FOR REBAR FABRICATION			
5		ISSUED FOR REINFORCING			
6		ISSUED FOR CONSTRUCTION			

PENNSYLVANIA POWER & LIGHT COMPANY
ALLENTOWN, PENNSYLVANIA
SUDBURY MANA STEAM ELECTRIC STATION - UNIT 1, UNIT 2

BECHTEL - SAN FRANCISCO

REACTOR BUILDING UNIT 2
EXTERIOR WALL AREAS 32 & 34
EL. 749'-1" TO EL. 826'-3"

DWG. NO. 8856 DRAWING NO. C-194 REV. 12

8012161098

RIDS-PDR

8012160098

