

This drawing and the design it covers are the property of BECHTEL. They are hereby loaned and used on the borrower's contract agreement that they will not be reproduced, copied, issued, exhibited, or used except in the limited way and purpose as provided by any written contract given by the lender to the borrower.

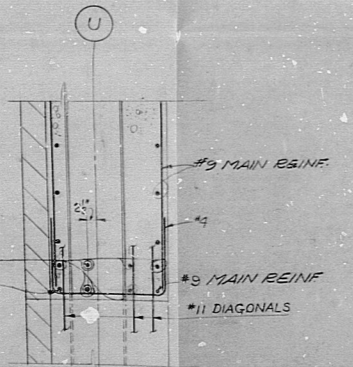

WALL ELEVATION COLUMN LINE U  
(LOOKING WEST)

- NOTES:**
1. FOR NOTES, REFERENCE DRAWINGS & GENERAL NOTES SEE DWGS. C-108, C-192 & C-201.
  2. CONCRETE SHALL BE 3000 PSI, FC UNO.
  3. FOR ADDITIONAL PENETRATIONS SEE PLANT DESIGN ASSRITS DRAWINGS. WHERE CONFLICT EXISTS, DRAWINGS SHALL GOVERN.

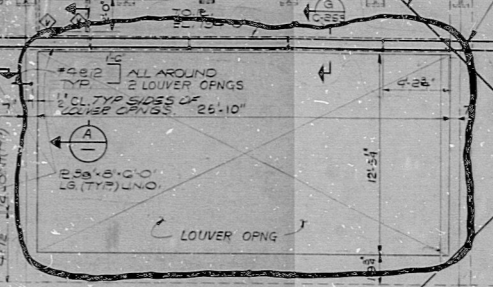
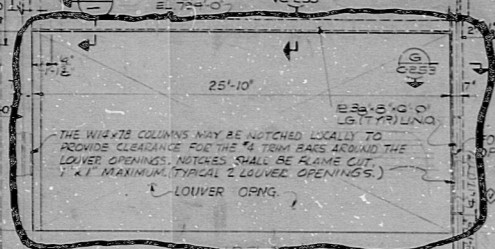
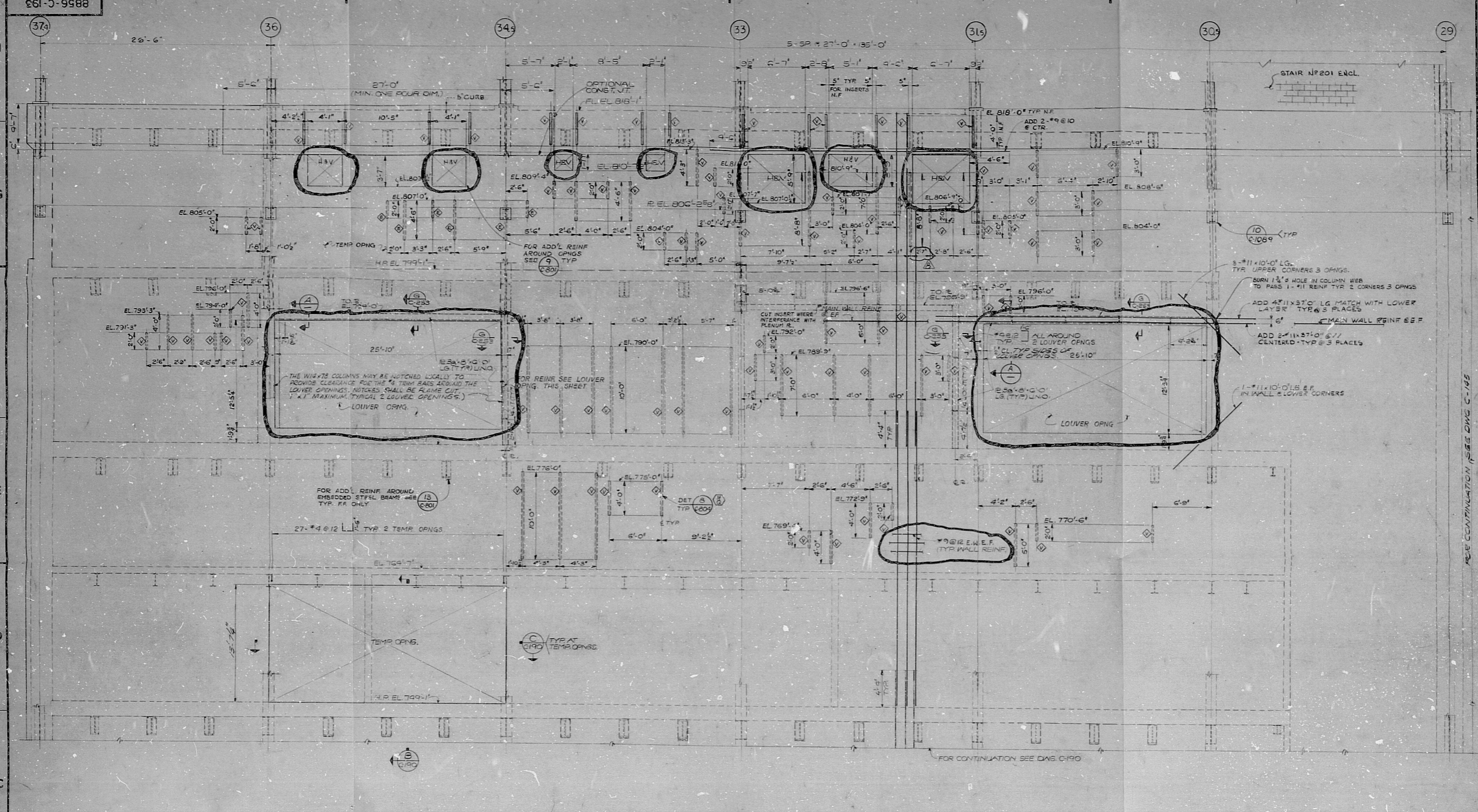
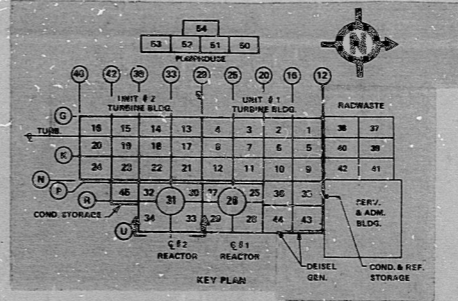

**REFERENCE DWG'S.**

BECHTEL NO.	PL. NO.
C-103	E-10599-1
C-109	E-10595-1
C-190	E-10525-2
C-501	E-105594-1
F-192	E-105235-5
C-804	E-105593-2
C-255	E-105274-5
C-105	E-105995

NO.	DATE	REVISIONS	BY	CHKD.	APP'D.
1		INCORP PER #2177			
2		INCORP PER C-1754, C-1057 & F-10104			
3		ADD INSERTS			
4		ADD INSERTS FOR HVAC			
5		ADD INSERTS, OPENINGS, & BEAMS @ EL. 764'-7"			
6		RELEASED HOLD AND LOG UP STAIR # 1350 FOR CONCRETE			
7		RELEASED HOLD AND LOG UP STAIR # 1350 FOR CONCRETE			
8		REVISION UP TO EL. 818'-1"			
9		REVISION UP TO EL. 818'-1"			

**PENNSYLVANIA POWER & LIGHT COMPANY**  
ALLENTOWN, PENNSYLVANIA  
SUROWANNA STEAM ELECTRIC STATION - UNIT 1, UNIT 2

BECHTEL - SAN FRANCISCO

**REACTOR BUILDING UNIT 2 EXTERIOR WALLS, AREAS 33 & 34 EL. 749'-1" TO EL. 826'-3"**

JOB NO. 8856 DRAWING NO. C-193 REV. 8

E 105235 SH 5





RIDS PDR

012160094

