

34"
22"
17"
11"
8.5"
11"
17"
22"
34"

34"
22"
17"
11"
8.5"
11"
17"
22"
34"

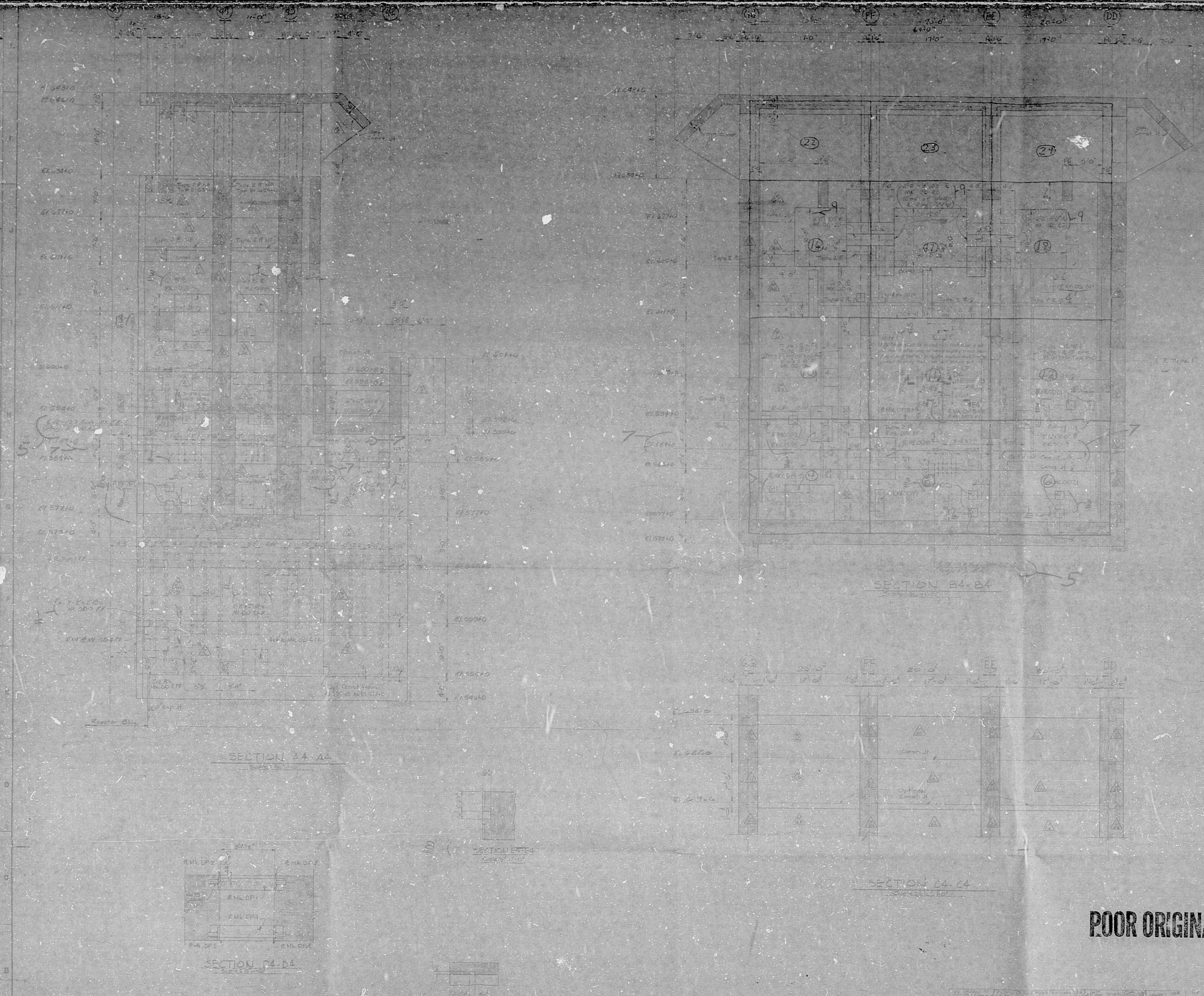

POOR ORIGINAL

PRC
APERTURE
CARD

Attachment 2
PAGE 3 OF 4
REFERENCE ONLY
CIVIL ELEC MECH

NO.	REVISIONS	DATE	BY	CHKD.	APP.	DATE
1						
2						
3						
4						
5						
6						
7						
8						
9						
10						
11						
12						

NUCLEAR SAFETY RELATED
DUREPOWER COMPANY
TAWABA NUCLEAR STATION UNITS 1&2
AUXILIARY BUILDING
UNIT TANK BLDG & OUTSIDE
DOCKHOUSE UNIT
CONCRETE SECTION

8303220450

RIDS

8203220450

