

SCALING RULER
A-UAC-02

This drawing and the design it covers is the property of the utilities which are participating in the design project. It is loaned to the contractor for his use only. It is not to be reproduced, copied, loaned, exhibited, or used in any way without the written consent of the utilities. All rights are reserved by the utilities.

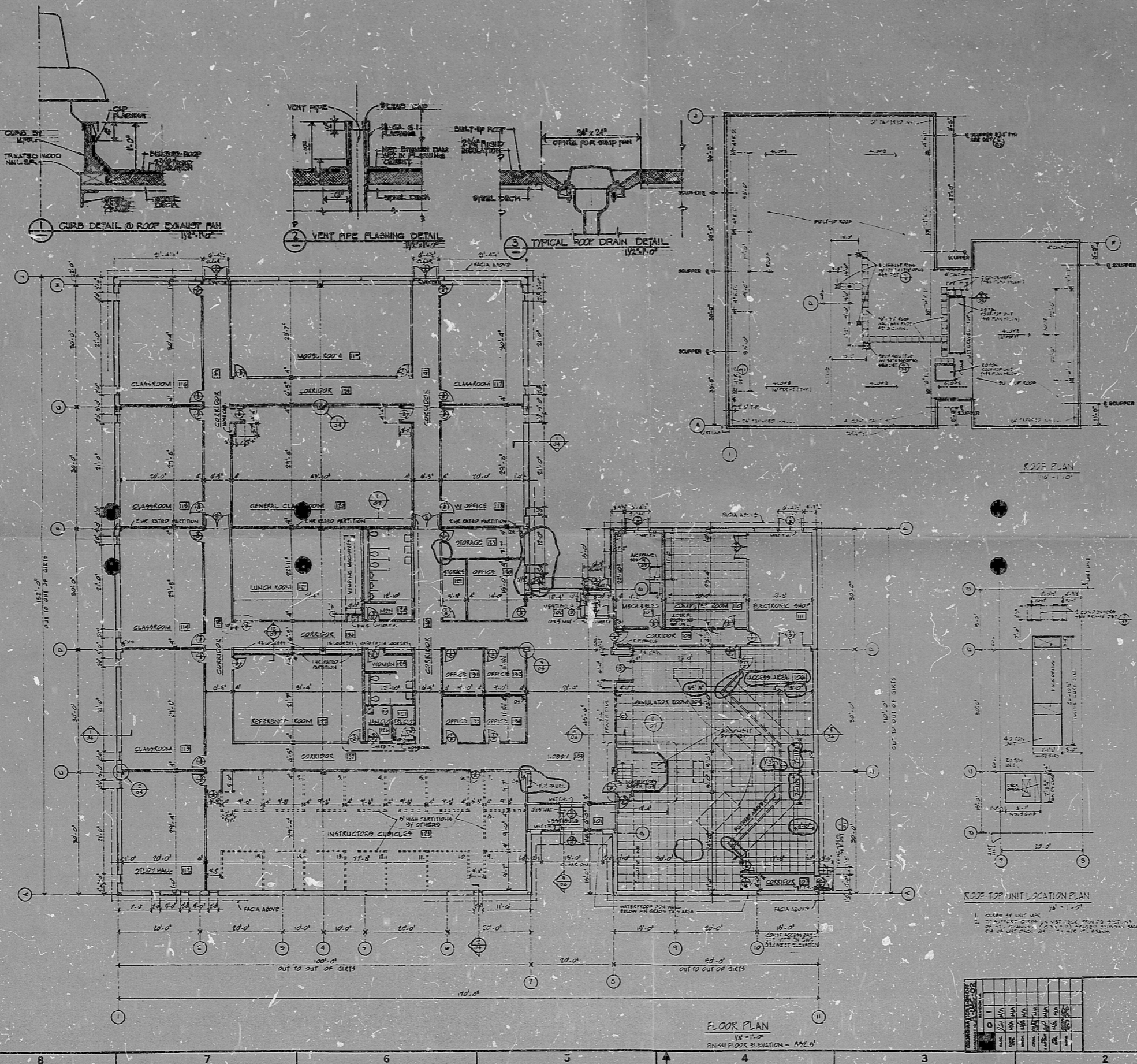

NOTES:

1. ALL PARTITION DIMENSIONS SHOWN ON FLOOR PLAN ARE NOMINAL.
2. ALL PARTITION EXCEPT 8" HIGH PARTITIONS IN ROOMS SHALL INDICATE CALING.
3. PARTITIONS AT ACCIDENTAL BATHS SHOWN IN CLASSROOMS & OFFICES SHALL BE SET TO BOTTOM OF ROOF DECK AND 2" x 4" STUDS SHALL BE SPACED @ 24" O.C. WITH GIRDERS OR OTHER SUPPORTS INDICATED.
4. ALL PARTITIONS 18" OR 24" HIGH AND ALL PARTITIONS AT ACCIDENTAL BATHS SHALL BE SET TO BOTTOM OF ROOF DECK AND 2" x 4" STUDS SHALL BE SPACED @ 24" O.C. WITH GIRDERS OR OTHER SUPPORTS INDICATED.
5. ALL CORRIDOR PARTITIONS EXCEPT CORRIDOR 10" & 12" PARTITIONS IF COLLECTOR IS 8" SHALL BE SET TO BOTTOM OF ROOF DECK AND 2" x 4" STUDS SHALL BE SPACED @ 24" O.C. WITH GIRDERS OR OTHER SUPPORTS INDICATED.
6. ALL PARTITIONS 18" OR 24" HIGH AND ALL PARTITIONS AT ACCIDENTAL BATHS SHALL BE SET TO BOTTOM OF ROOF DECK AND 2" x 4" STUDS SHALL BE SPACED @ 24" O.C. WITH GIRDERS OR OTHER SUPPORTS INDICATED.
7. ALL PARTITIONS 18" OR 24" HIGH AND ALL PARTITIONS AT ACCIDENTAL BATHS SHALL BE SET TO BOTTOM OF ROOF DECK AND 2" x 4" STUDS SHALL BE SPACED @ 24" O.C. WITH GIRDERS OR OTHER SUPPORTS INDICATED.
8. ALL PARTITIONS 18" OR 24" HIGH AND ALL PARTITIONS AT ACCIDENTAL BATHS SHALL BE SET TO BOTTOM OF ROOF DECK AND 2" x 4" STUDS SHALL BE SPACED @ 24" O.C. WITH GIRDERS OR OTHER SUPPORTS INDICATED.

**INFORMATION ONLY
UNCONTROLLED COPY**

NO.	DATE	REVISIONS	BY	CHKD.	DATE
1					
2					
3					
4					
5					
6					
7					
8					
9					
10					
11					
12					
13					
14					
15					
16					
17					
18					
19					
20					
21					
22					
23					
24					
25					
26					
27					
28					
29					
30					

I certify that the image contained on this frame was read to the normal and regular course of business, on the date stated below and that it is an accurate reproduction of the document(s) and title to which it applies.
DATE: 2-18-04 BY: RATOR SUPERVISOR



SI APERTURE CARD

8905100062

PDR RIDS

890 510 0062

