

4-04-0 201.3

FWH AIEI03
HI HI LEVEL
X LSHH-1561A
(NOTE 1)

FWH AIEI03
HI HI LEVEL
X LSHH-1564A
(NOTE 1)

RESET
NS-1523A

TRIP
LANN-1544A

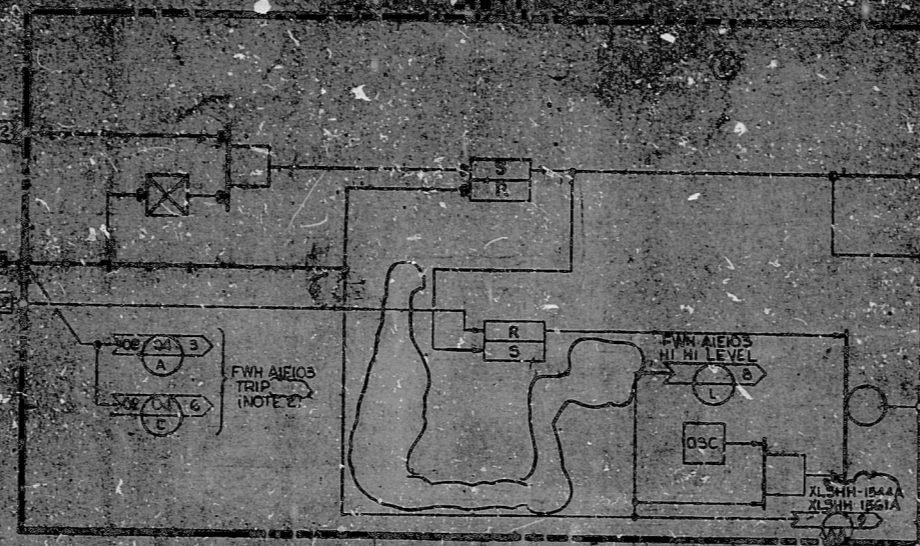

DRAIN VALVE LV-1523 A

CROSS REFERENCE TABLE

FWH	DRAIN VALVE NO.	SOLENOID VALVE	RESET SWITCH	HI-HI LEVEL SW		ALARM NO.	TC	LOGIC CONTROLLER	CIRCUIT NO.	RCP	FUSE PNL & FUSE #	HAND SWITCH LAYOUT	
				FWH	SW. NO.							MODULE	SECTION
AIEI04	LV-1523A	SV-1523A	NS-1523A	AIEI03	XLSHH-1561A XLSHH-1564A	LANN-1544A	AC638	AC653	4	AC102	YF-405 #10	B	342
BIEI04	LV-1523C	SV-1523C	NS-1523C	BIEI03	XLSHH-1561B XLSHH-1564B	LANN-1544B	AC638	AC653	5	AC102	YF-406 #10	B	344
CIEI04	LV-1523C	SV-1523C	NS-1523C	CIEI03	XLSHH-1561C XLSHH-1564C	LANN-1544C	AC638	AC653	6	AC102	YF-407 #10	B	346
AIEI05	LV-1524A	SV-1524A	NS-1524A	AIEI04	XLSHH-1561A XLSHH-1564A	LANN-1544A	AC638	AC653	7	AC102	YF-405 #11	C	143
BIEI05	LV-1524B	SV-1524B	NS-1524B	BIEI04	XLSHH-1561B XLSHH-1564B	LANN-1544B	AC638	AC653	8	AC102	YF-406 #11	C	144
CIEI05	LV-1524C	SV-1524C	NS-1524C	CIEI04	XLSHH-1561C XLSHH-1564C	LANN-1544C	AC638	AC653	9	AC102	YF-407 #10	C	146

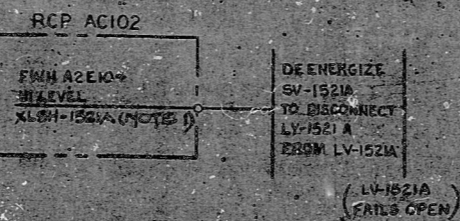

DUMP LINE TRIP OPEN

CROSS REFERENCE TABLE

FWH	SOLENOID VALVE	DUMP LINE CONTROL VALVE	RCP	POWER SUPPLY
AIEI04	SV-1523A	LV-1523A	AC102	AC102
BIEI04	SV-1523B	LV-1523B	AC102	AC102
CIEI04	SV-1523C	LV-1523C	AC102	AC102
AIEI05	SV-1524A	LV-1524A	AC102	AC102
BIEI05	SV-1524B	LV-1524B	AC102	AC102
CIEI05	SV-1524C	LV-1524C	AC102	AC102

NOTES

- CONTACTS OPEN UPON THE CONDITION STATED.
- SEE DRAIN VALVE OUTPUT AREAS ON HI-HI LEVEL SWITCH-APPLIES TO VALVES LV-1523A, B, C ONLY.



TRIP

22
17
11
8.5
11
17
22

22
17
11
8.5
11
17
22

RIDS

8307270330

