

6011-109

ITEM	EQUIPMENT	NAME
500	REACTOR VESSEL	
529	CHANNEL HANDLING BOOM	
530	FUEL PREF.	
532	JIB CRANE	
534	FUEL TRANSFER TUBE	
535	RPV HEAD SUPPORT	
539	AUXILIARY PLATFORM	
540	REFUELING PLATFORM	
541	FUEL STORAGE RACK	
542	CHANNEL RACK	
543	CONTROL ROD STORAGE RACK	
538	WINCH & CONTROLLER	
545	HYDRAULIC UNIT	
548	REACTOR BLDG. OPER. PANEL	
399	AREA COOLER	
934	REACTOR WATER CLEAN-UP SOL. PANEL	
536	HEAD STRONGBACK CAROUSEL	

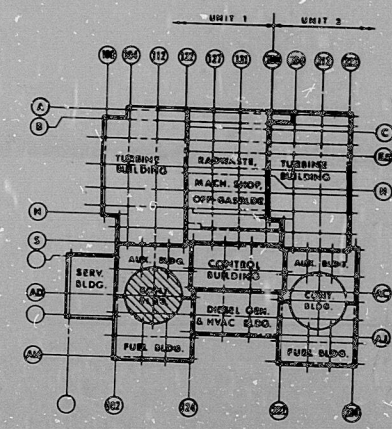
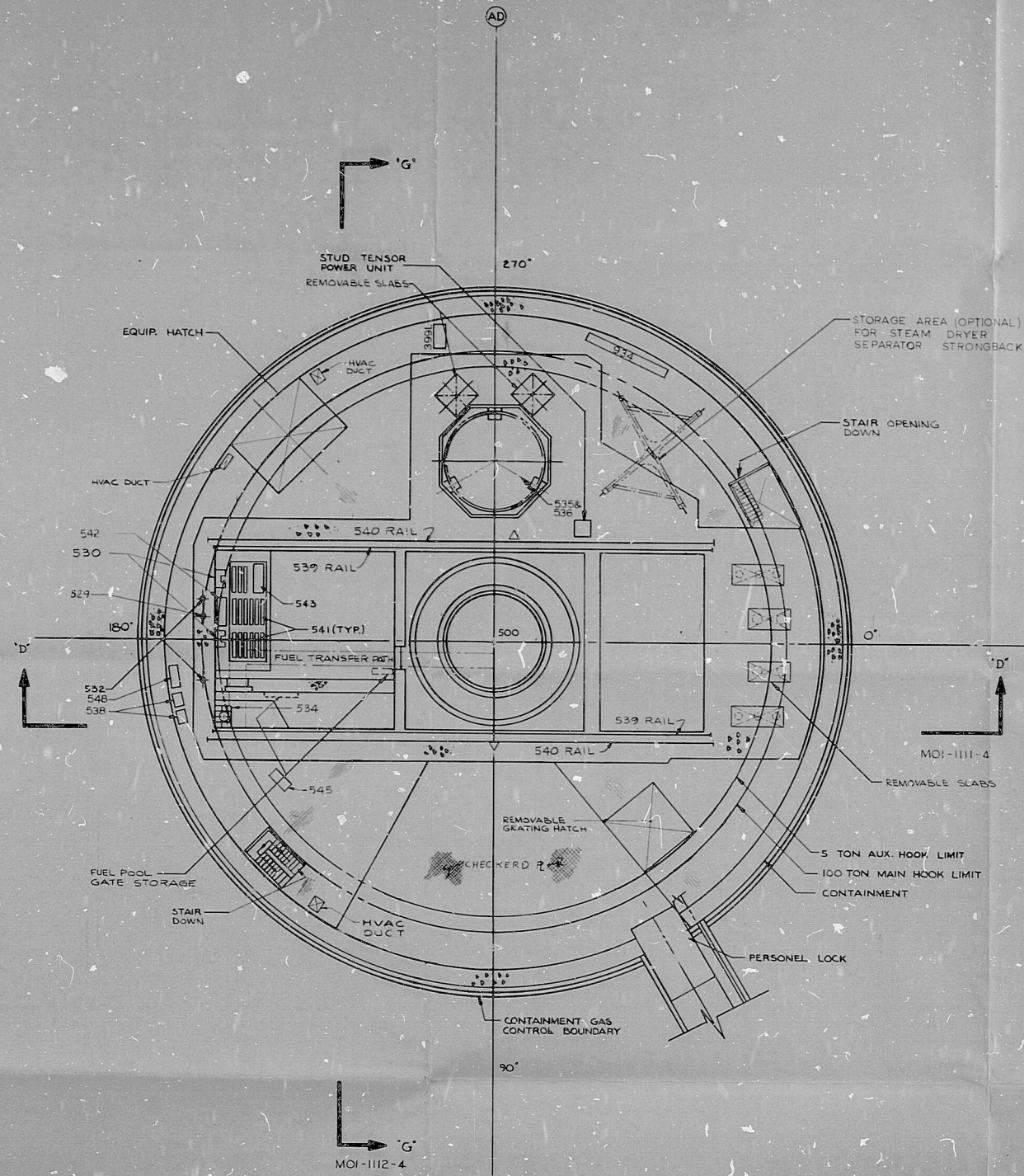

KEY PLAN  
CLINTON POWER STATION  
2  
**POOR ORIGINAL**

CONTAINMENT BLDG. EL. 828'-3"  
(REFUELING FLOOR)

**NUCLEAR SAFETY RELATED**  
ITEMS ARE SHOWN ON THIS DRAWING  
FOR SAFETY CLASSIFICATION SEE PIPING,  
EQUIPMENT, VALVE, OR INSTRUMENT LISTS.

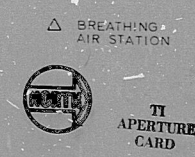

DRAWING RELEASE RECORD				DRAWING RELEASE RECORD			
REV.	DATE	PREPARED	APPROVED	REV.	DATE	PREPARED	APPROVED
A	6-9-78			A	6-9-78		
B	6-29-79			B	6-29-79		
C	5-20-81			C	5-20-81		



SCALE: 1" = 10'

PROJECT NUMBER: 1536

GENERAL ARRANGEMENT  
CONTAINMENT REFUELING FLOOR  
EL. 828'-3"

CLINTON POWER STATION  
UNIT 1  
ILLINOIS POWER COMPANY  
CLINTON, ILLINOIS

8410810526

**SARGENT & LUNDY**  
ENGINEERS  
ARCHITECTS

DRAWING NO. MO1-1109  
REV. SHEET 5 OF 9

PDR

8410910526

