

POOR ORIGINAL

UNCONTROLLED DOCUMENT FOR REFERENCE ONLY

PRC APERTURE CARD

NOTE: 1. ALL DUCTWORK CONSTRUCTION CLASS B AND HYM-39 EXCEPT AS NOTED ON THIS DRAWING.

REFERENCE DWGS.	
BECHTEL VJ	PL. NO.
V-100, S-142	E-106205-1&2
V-182	E-106687
V-182	B-106522

REVISION	DATE	BY	CHKD.	APP'D.
ISSUED FOR CLIENT REVIEW				
ISSUED FOR CONSTRUCTION				
REVISED PER CHANGE SHEET				
REVISED PER CHANGE SHEET				
REVISED PER CHANGE SHEET				
REVISED PER CHANGE SHEET				
REVISED PER CHANGE SHEET				
REVISED PER CHANGE SHEET				
REVISED PER CHANGE SHEET				
REVISED PER CHANGE SHEET				

PENNSYLVANIA POWER & LIGHT COMPANY		
ALLENTOWN, PENNSYLVANIA		
2300 MARINA STEAM ELECTRIC STATION - UNIT 1, UNIT 2		
BECHTEL - SAN FRANCISCO		
P&L TO UNITS 1&2		
DIESEL GEN & ESSW PUMPHOUSE AIR FLOW DIAGRAM		
JOB NO.	DRAWING NO.	REV.
8856	M-182	7
DATE		8-10-62
DRAWN BY		E-106287
CHECKED BY		
APPROVED BY		

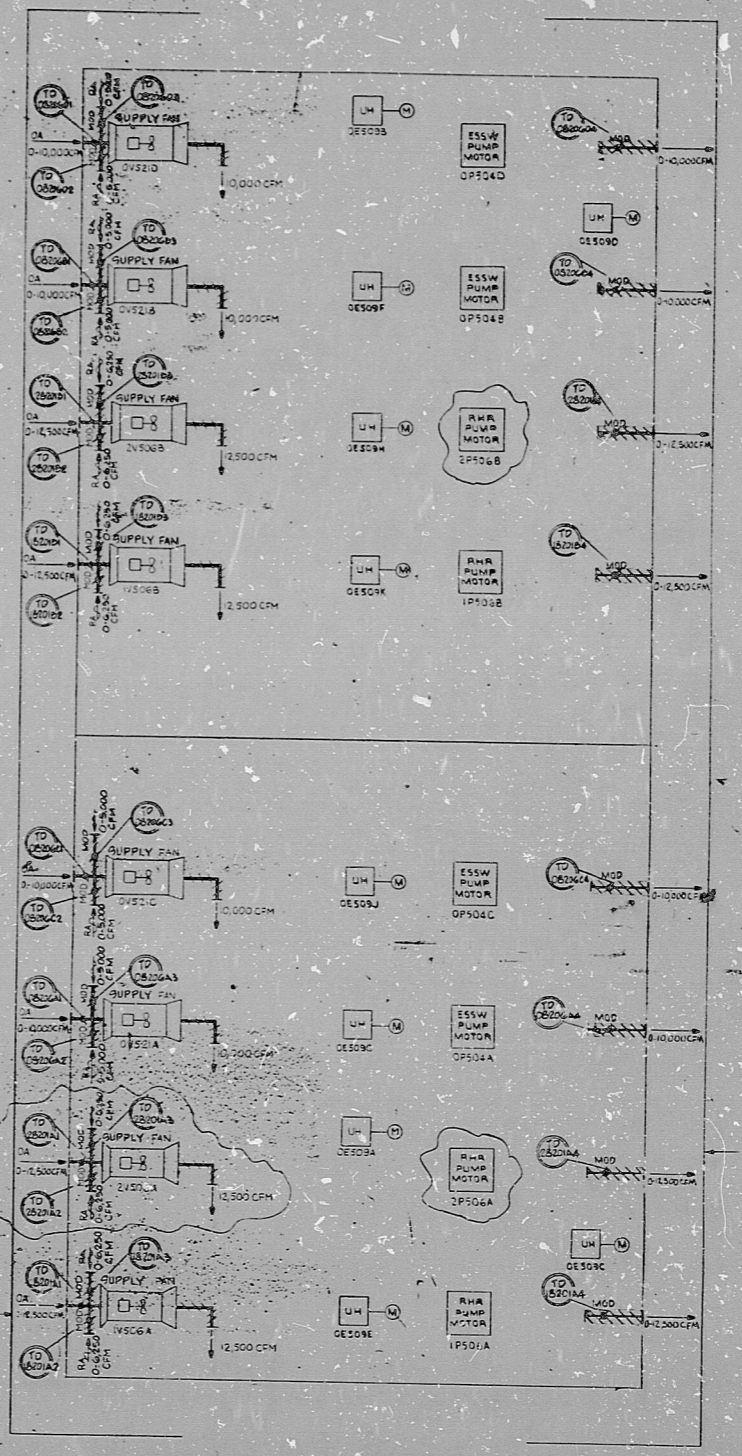
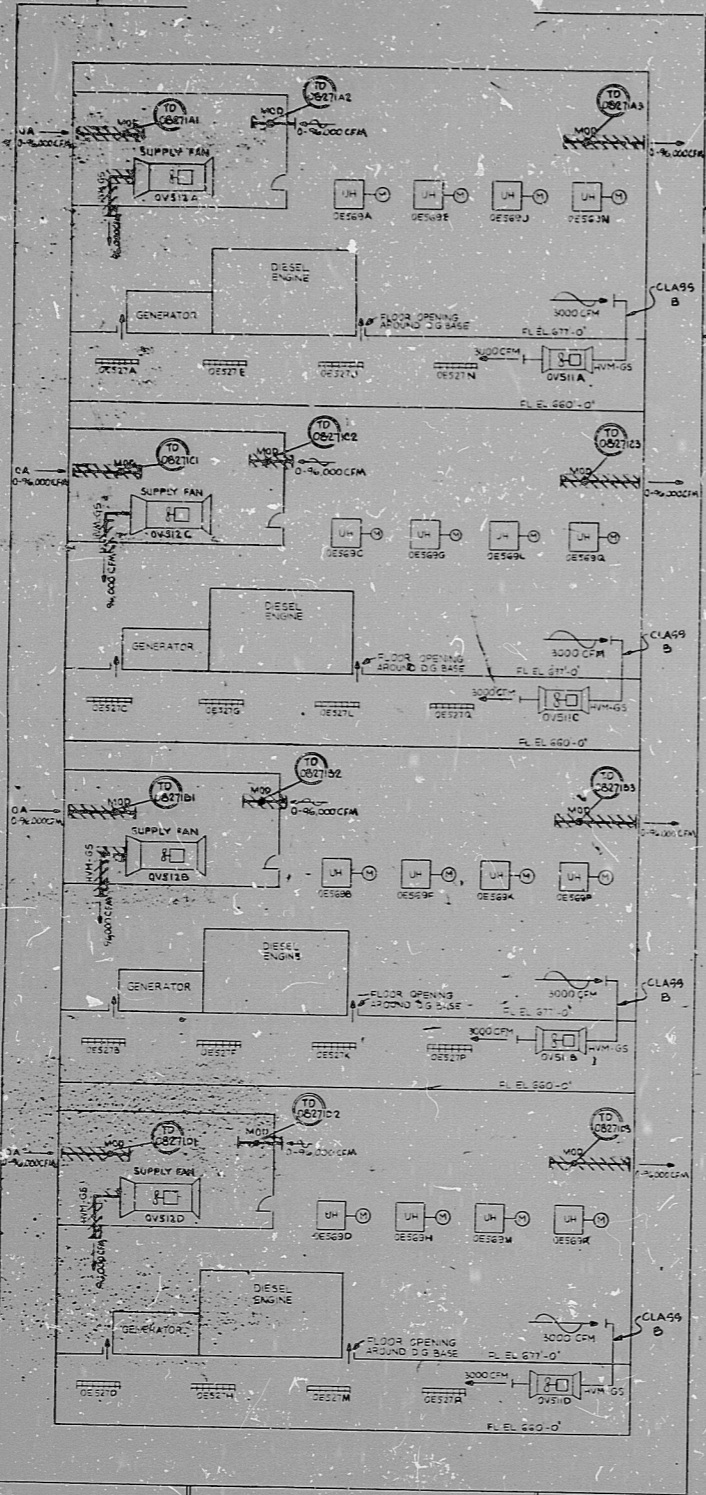

This drawing and the design it covers are the property of BECHTEL. They are not to be reproduced, copied, published, or used in any way without the written consent of BECHTEL. If any portion of this drawing is reproduced, it shall be the property of BECHTEL.

17"

11" 8.5"

8.5"

11"

17"

17"

11" 8.5"

8.5"

11"

17"

RIDS

830526 0058

