

NOTES:
 1. FOR LEGEND, NOTES, REFERENCES, AND STANDARD DETAILS, SEE DWG. D-215-001.
 2. CONDUITS CONTINUED UP, SEE DWG. D-265-011.
 CONDUITS CONTINUED DOWN, SEE DWG. D-265-021.

TERA APERTURE CARD

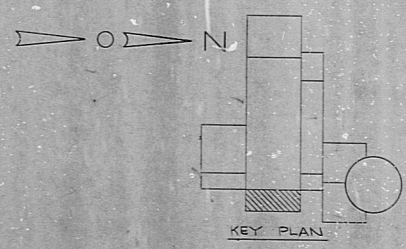

REVISED AS INDICATED	
A	10/15/78
NO. DATE REVISION APPROVAL	
REVISIONS	
DATE	CONSTRUCTION
10/17	SP-34
LIMITED CONSTRUCTION: AS NOTED	
PRELIMINARY: NOT FOR CONSTRUCTION	
BIDDING PURPOSES	
DATE	RELEASED FOR ENGR.
THE CLEVELAND ELECTRIC ILLUMINATING COMPANY	
PERRY NUCLEAR POWER PLANT UNIT 2	
ELECTRICAL	
CONDUIT LAYOUT	
TURBINE BUILDING LUBE OIL AREA - EL. 620'-6"	
DRAWING NO.	GILBERT ASSOCIATES, INC.
DATE	ENGINEERS AND CONSULTANTS
10/17/78	
DRAWING	ENGINEER'S APPROVAL
MADE	ARCHITECTURAL
BY	CIVIL
DATE	STRUCTURAL
10/17/78	ELECTRICAL
BY	METALLURGICAL
DATE	METALLURGICAL
10/17/78	METALLURGICAL
SCALE	
1/2\"/>	

CND LYT T/B LUBE OIL AREA EL 620'-6"

14
13
12
11
10
9
8
7
6
5
4
3
2
1

A
B
C
D
E
F
G
H
J
K

9.5"
11"
17"
22"
34"

14
13
12
11
10
9
8
7
6
5
4
3
2
1

A
B
C
D
E
F
G
H
J
K

9.5"
11"
17"
22"
34"

RIPS

812040243

