

34"
22"
17"
11"
8.5"
11"
17"
22"
34"

34"
22"
17"
11"
8.5"
11"
17"
22"
34"

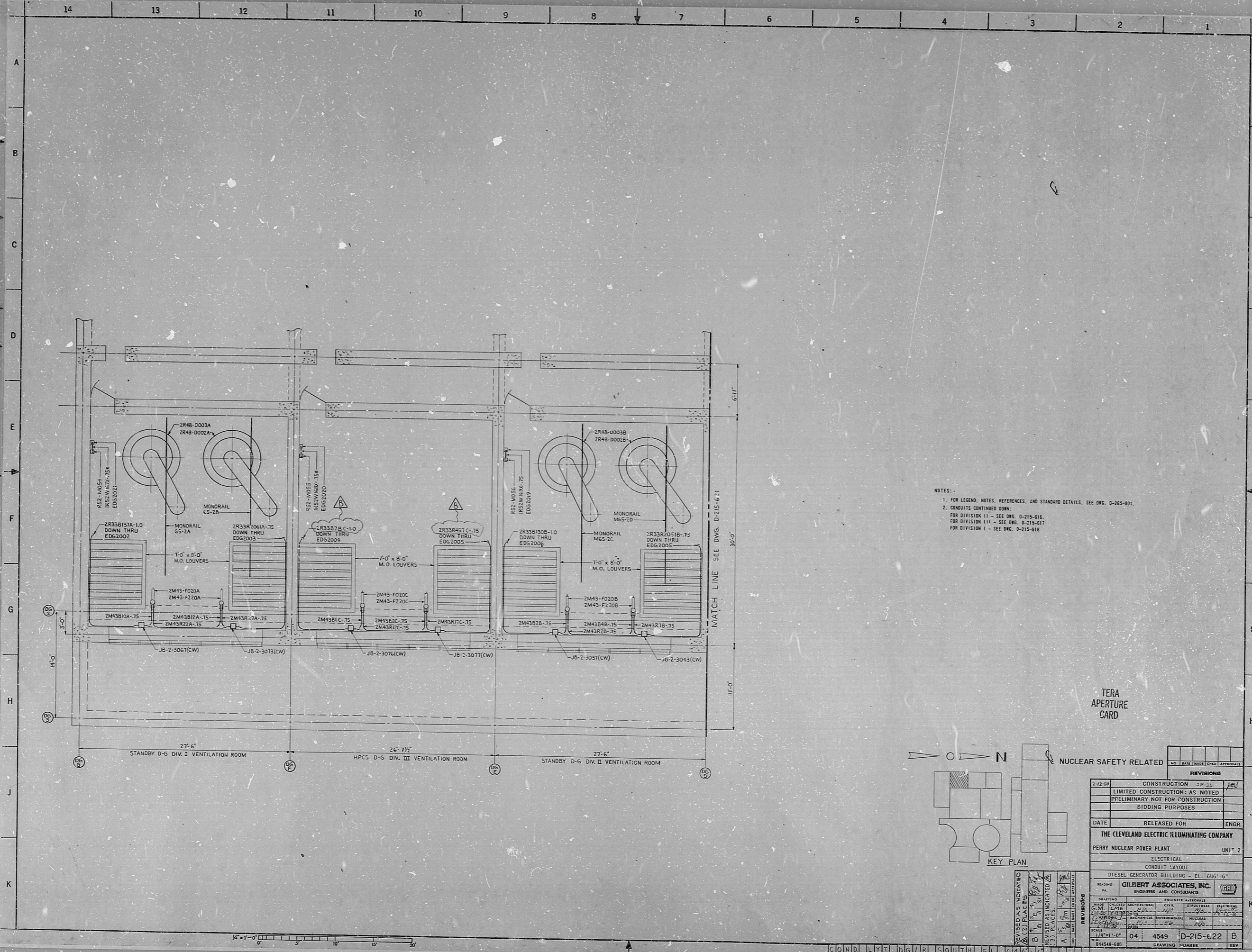

NOTES:
1. FOR LEGEND, NOTES, REFERENCES, AND STANDARD DETAILS, SEE DWG. D-265-001.
2. CONDUITS CONTINUED DOWN:
FOR DIVISION 11 - SEE DWG. D-215-616,
FOR DIVISION 111 - SEE DWG. D-215-617
FOR DIVISION I - SEE DWG. D-215-618

TERA
APERTURE
CARD

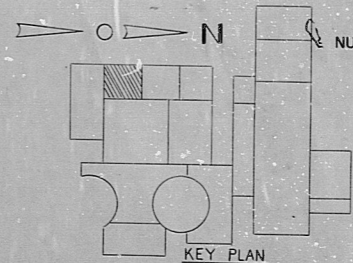

NO.		DATE	MADE	CHECK	APPROVALS
REVISIONS					
2-12-50	CONSTRUCTION	CP			
	LIMITED CONSTRUCTION	AS NOTED			
	PRELIMINARY NOT FOR CONSTRUCTION				
	BIDDING PURPOSES				
DATE	RELEASED FOR	ENGR.			
THE CLEVELAND ELECTRIC ILLUMINATING COMPANY					
PERRY NUCLEAR POWER PLANT UNIT 2					
ELECTRICAL					
CONDUIT LAYOUT					
DIESEL GENERATOR BUILDING - FI, 6HG1-6"					
READING	PA.	CILDERT ASSOCIATES, INC.			
ENGINEERS AND CONSULTANTS					
DRAWING	ARCHITECTURAL	CIVIL	STRUCTURAL	ELECTRICAL	MECHANICAL
APPROVAL	MECHANICAL	ENVIRONMENTAL	NUCLEAR		
SCALE	DATE	NO.	REV.	BY	CHKD.
1/8"=1'-0"	04	4549	D-215-622	B	
04549-000 DRAWING NUMBER					

COND L Y T D G / R SOUTH EL G

R:DS

8/12040/92

