

- NOTES:
1. FOR LEGEND, NOTES, REFERENCES, AND STANDARD DETAILS, SEE DWG. D-215-401.
  2. CONDUITS CONTINUED UP, SEE DWG. D-215-442.
  3. THIS DRAWING TO BE WORKED IN CONJUNCTION WITH THE FOLLOWING ELECTRICAL CONDUIT SUPPORT DRAWINGS:
    - SS-215-432, SHEET C8
    - SS-215-432, SHEET D8
    - SS-215-432, SHEET E8

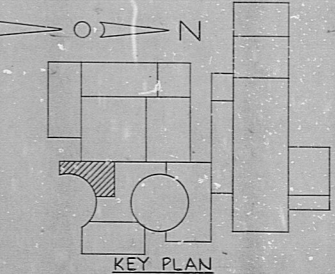

NUCLEAR SAFETY RELATED

NO.	DATE	BY	CHKD	APPROVAL

REVISIONS

NO.	DESCRIPTION	DATE

DATE: RELEASED FOR ENGR.

THE CLEVELAND ELECTRIC ILLUMINATING COMPANY

PERRY NUCLEAR POWER PLANT UNITS 1 & 2

ELECTRICAL CONDUIT LAYOUT

INTERMEDIATE BUILDING - SOUTH - EL. 620'-6"

REVISIONS INDICATED BY	DATE	BY	CHKD	APPROVAL

READING: GILBERT ASSOCIATES, INC. ENGINEERS AND CONSULTANTS

DRAWING NUMBER: 04 4549 D-215-432 E



RIDS

8112040083

