

DETAIL A  
NO SCALE

SECTION 1-1  
THIS DRAWING COORDINATED WITH D-115

SECTION 2-2  
THIS DRAWING COORDINATED WITH D-115

SECTION 3-3  
THIS DRAWING COORDINATED WITH D-115

VALVE MPL. NO.	BOX NO.	SOLENOID NO. CND. NO.	LIM. SW. NO. CND. NO. (OPEN) CND. NO. (CLOSED)
ZB17-105B	ZB17-105A	ZB17-105B	ZB17-105B
ZB17-105B	ZB17-105A	ZB17-105B	ZB17-105B
ZB17-105B	ZB17-105A	ZB17-105B	ZB17-105B

- NOTES:
1. FOR LEGEND, NOTES, REFERENCES, AND STANDARD DETAILS, SEE DWG. D-215-001.
  2. CONDUITS CONTINUED UP, SEE DWG. D-215-231.
  3. CONDUITS CONTINUED DOWN, SEE DWG. D-215-211.
  4. THIS DRAWING TO BE WORKED IN CONJUNCTION WITH THE FOLLOWING ELECTRICAL SUPPORT DRAWINGS:  
SS-265-221, SHEET C28  
SS-265-221, SHEET C29

ITERA  
APERTURE  
CARD

NUCLEAR SAFETY RELATED

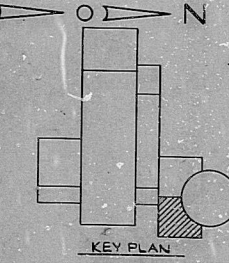

REV. NO.	DATE	BY	CHKD.	DESCRIPTION
A	1/18/68	J. P. ...	J. P. ...	ISSUED FOR CONSTRUCTION
B	2/13/68	J. P. ...	J. P. ...	REVISED AS IND. BY ...
C	3/10/68	J. P. ...	J. P. ...	REVISED AS IND. BY ...
D	4/10/68	J. P. ...	J. P. ...	REVISED AS IND. BY ...

4/11/68	CONSTRUCTION	27-33	J. P.
	LIMITED CO-CONSTRUCTION	AS NOTED	
	PRELIMINARY NOT FOR CONSTRUCTION		
	BIDDING PURPOSES		
DATE	RELEASED FOR	ENGR.	
THE CLEVELAND ELECTRIC ILLUMINATING COMPANY			
PERRY NUCLEAR POWER PLANT UNIT 2			
ELECTRICAL			
CONDUIT LAYOUT			
AUXILIARY BUILDING - EAST EL. 599'-0"			
DRAWING NO. GILBERT ASSOCIATES, INC.			
ENGINEERS AND CONSULTANTS			
DESIGNED BY	CHECKED BY	ENGINEER APPROVALS	
DRWN. BY	APP. BY	MECHANICAL	
DATE	SCALE	ELECTRICAL	
1/18/68	04	MECHANICAL	
04	4549	MECHANICAL	
D-265-221		MECHANICAL	
044549-000		MECHANICAL	
		MECHANICAL	

14 13 12 11 10 9 8 7 6 5 4 3 2 1

A B C D E F G H J K

22" 17" 11" 8.5" 22" 34"

13'-0" 26'-0" 27'-0" 30'-0"

1" = 1'-0"

CND LYT A/B EAST EL 599'-0"

RIDS

8112030633

