

34"

34"

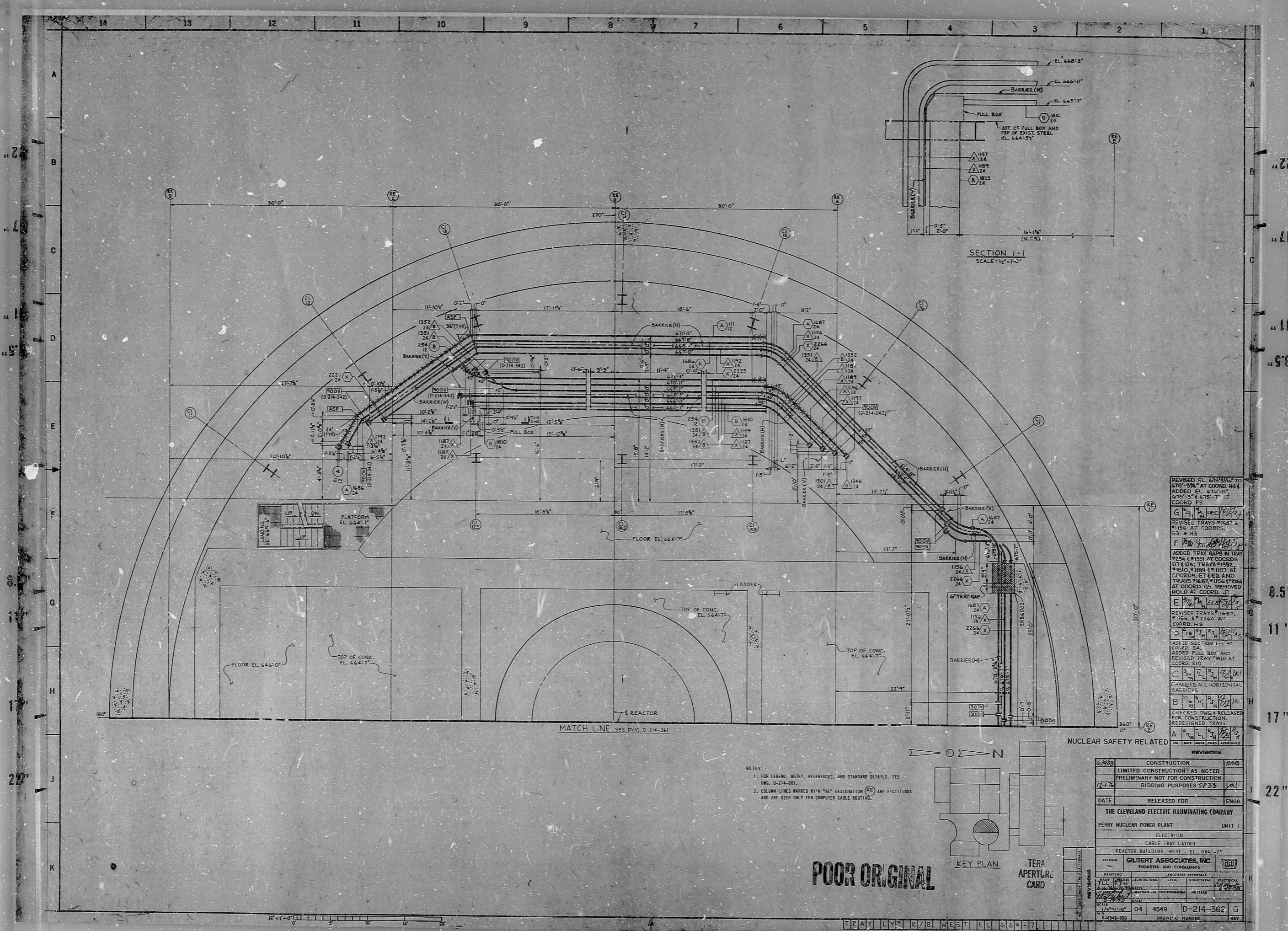

REVISED EL. 678'-5 1/2" TO 678'-5 3/4" AT COORD. H&I
 ADDED EL. 676'-11" 678'-5" & 675'-7" AT COORD. F3
 G 12/14/67
 REVISED TRAYS 1187 & 1196 AT COORDS. G3 & H3
 F 12/14/67
 ADDED TRAY GAPS IN TRAY #254 & #193 AT COORDS. D7 & D8. TRAYS #193, #1810 & #1893 & #1187 AT COORDS. E7 & E8 AND TRAYS #1687, #1156 & #1224 AT COORD. G5 REMOVED HOLD AT COORD. J7
 E 12/14/67
 REVISED TRAYS # 1687, # 1156 & # 1224 AT COORD. H3
 D 12/14/67
 ADDED SECTION 1-1 AT COORD. E5
 ADDED PULL BOX AND REVISED TRAY #1810 AT COORD. E10
 C 12/14/67
 CHANGED ALL HORIZONTAL SPACINGS
 B 12/14/67
 CHECKED DWG. & RELEASED FOR CONSTRUCTION
 REDESIGNED TRAYS
 A 12/14/67

- NOTES:-
 1. FOR LEGEND, NOTES, REFERENCES, AND STANDARD DETAILS, SEE DWG. D-214-001.
 2. COLUMN LINES MARKED WITH "RE" DESIGNATION (RE) ARE FICTITIOUS AND ARE USED ONLY FOR COMPUTER CABLE ROUTING.

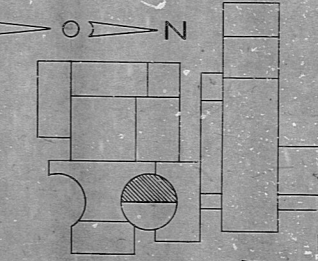

NUCLEAR SAFETY RELATED

CONSTRUCTION	1000
LIMITED CONSTRUCTION: AS NOTED	
PRELIMINARY NOT FOR CONSTRUCTION	
BIDDING PURPOSES SP33	1000
DATE	RELEASED FOR ENGR
THE CLEVELAND ELECTRIC ILLUMINATING COMPANY	
PERRY NUCLEAR POWER PLANT UNIT 1	
ELECTRICAL	
CABLE TRAY LAYOUT	
REACTOR BUILDING WEST - EL. 664'-7"	
DESIGNED BY	GILBERT ASSOCIATES, INC.
ENGINEER APPROVAL	(Signature)
ARCHITECTURAL	
CIVIL	
STRUCTURAL	
METALLURGICAL	
MECHANICAL	
ENVIRONMENTAL	
NUCLEAR	
SCALE	1/8"=1'-0"
NO. 04	4549
D-214-362	G
041548-000	DRAWING NUMBER
	REV

POOR ORIGINAL

34"

34"

RIDS

8112030630

