

- NOTES:
1. FOR LEGEND, NOTES, REFERENCES, AND STANDARD DETAILS, SEE DWG. D-215-001.
2. CONDUITS CONTINUED DOWN, SEE DWG. D-215-006.
3. THIS DRAWING TO BE WORKED IN CONJUNCTION WITH THE FOLLOWING ELECTRICAL CONDUIT SUPPORT DRAWINGS: SS-215-007, SHEET C1

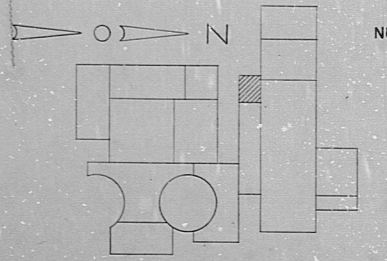

Table with 3 columns: REVISION NUMBER, DATE, and DESCRIPTION. It lists several revisions to the drawing, including changes to fan specifications and conduit details.

Approval and project information table. It includes fields for 'NUCLEAR SAFETY RELATED', 'REVISIONS', 'DATE', 'RELEASED FOR', 'ENGR.', 'THE CLEVELAND ELECTRIC ILLUMINATING COMPANY', 'PERRY NUCLEAR POWER PLANT UNIT I', 'ELECTRICAL CONDUIT LAYOUT', 'OFF-GAS BLDG. EL. 635'-0" MACHINERY RM. EL. 630'-0" AND 650'-0"', 'DRAWING NUMBER', and 'REV.'.

116

116

22

22

17

17

11

11

8.5

8.5

11

11

17

17

22

22

17

17

22

22

34

34

CND LYT DGB EL 635-0 460-0 66 8-3

RIDS

8112030336

