

34"

34"

22"

22"

17"

17"

11"

11"

8.5"

8.5"

8.5"

8.5"

11"

11"

17"

17"

22"

22"

34"

34"

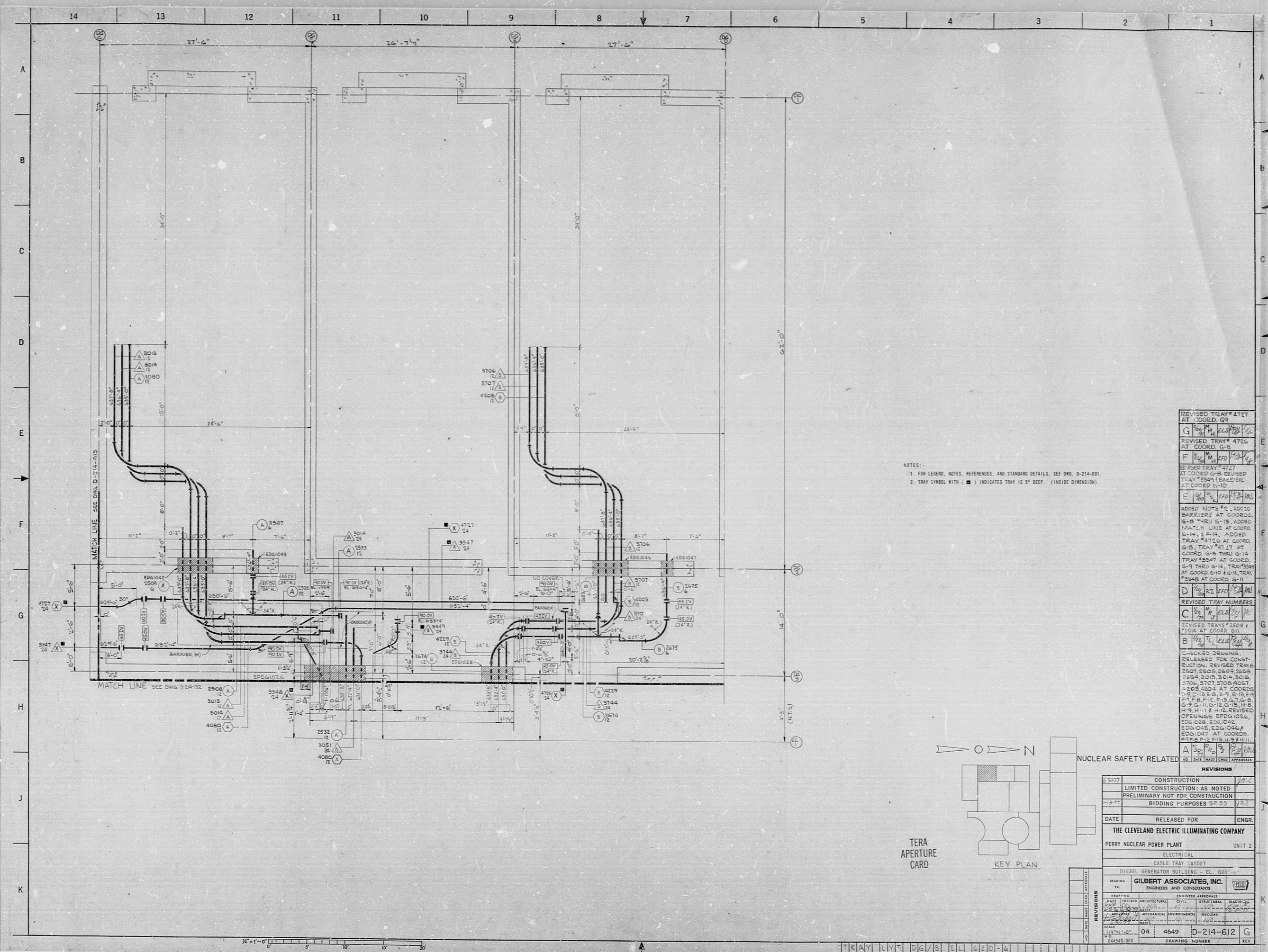

NOTES:

- FOR LEGEND, NOTES, REFERENCES, AND STANDARD DETAILS, SEE DWG. D-214-001.
- TRAY SYMBOL WITH (■) INDICATES TRAY IS 5" DEEP. (INSIDE DIMENSION).

REVISED TRAY #4727 AT COORD. G-9	G	10/11/62	ML
REVISED TRAY #4726 AT COORD. G-8	F	10/11/62	ML
REVISED TRAY #4721 AT COORD. G-8 REVISED TRAY #3841 G-8/E-8 AT COORD. G-10	E	10/11/62	ML
ADDED NOTE #2, ADD'D BARRIER AT COORDS. G-8 THRU G-18, ADD'D MATCH LINE AT COORD. G-14. ADD'D TRAY #4726 AT COORD. G-8, TRAY #4717 AT COORD. G-8 THRU G-14 TRAY #3847 AT COORD. G-9 THRU G-14, TRAY #3841 #3848 AT COORD. G-11	D	10/11/62	ML
REVISED TRAY NUMBERS	C	10/11/62	ML
REVISED TRAYS #2508 / #3014 AT COORD. G-11	B	10/11/62	ML
CHECKED DRAWING, RELEASED FOR CONSTRUCTION, REVISED TRAYS #2508, #2509, #2508, #2509, #3013, #3014, #3015, #3016, #3017, #3018, #4087, #4088, #4089 AT COORDS. G-9, G-10, G-11, G-12, G-13, G-14, G-15, G-16, G-17, G-18, H-8, H-9, H-11. REVISED OPENINGS: EDDG1026, EDDG1028, EDDG1042, EDDG1043, EDDG1044, EDDG1047 AT COORDS. G-9, G-10, G-11, G-12, G-13, G-14, G-15, G-16, G-17, G-18, H-8, H-9, H-11.	A	10/11/62	ML

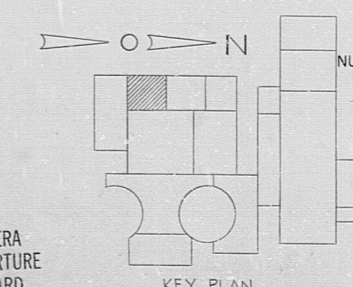

NUCLEAR SAFETY RELATED

REVISIONS	
23027	CONSTRUCTION
	LIMITED CONSTRUCTION: AS NOTED
	PRELIMINARY NOT FOR CONSTRUCTION
11-8-77	BIDDING PURPOSES SP 55
DATE	RELEASED FOR ENGR.
THE CLEVELAND ELECTRIC ILLUMINATING COMPANY	
PERRY NUCLEAR POWER PLANT UNIT 2	
ELECTRICAL	
CABLE TRAY LAYOUT	
DIESEL GENERATOR BUILDING - EL. 620'-0"	
GILBERT ASSOCIATES, INC.	
ENGINEERS AND CONSULTANTS	
DRAWING NO.	04 4549 D-214-612 G
SCALE	AS SHOWN
DATE	10/11/62
BY	ML
CHECKED	ML
APPROVED	ML
DATE	10/11/62

TERA APERTURE CARD

KEY PLAN

TRAY LAYOUT [G] [B] [E] [L] [6] [2] [0] - [6] [1] [2] [G]

RIDS

8112030187

