

## APPLICATION FOR MATERIAL LICENSE

INSTRUCTIONS: SEE THE APPROPRIATE LICENSE APPLICATION GUIDE FOR DETAILED INSTRUCTIONS FOR COMPLETING APPLICATION. SEND TWO COPIES OF THE ENTIRE COMPLETED APPLICATION TO THE NRC OFFICE SPECIFIED BELOW.

### APPLICATIONS FOR DISTRIBUTION OF EXEMPT PRODUCTS FILE APPLICATIONS WITH:

U.S. NUCLEAR REGULATORY COMMISSION  
DIVISION OF FUEL CYCLE AND MATERIAL SAFETY, NMSS  
WASHINGTON, DC 20556

### ALL OTHER PERSONS FILE APPLICATIONS AS FOLLOWS. IF YOU ARE LOCATED IN:

CONNECTICUT, DELAWARE, DISTRICT OF COLUMBIA, MAINE, MARYLAND,  
MASSACHUSETTS, NEW HAMPSHIRE, NEW JERSEY, NEW YORK, PENNSYLVANIA,  
RHODE ISLAND, OR VERMONT, SEND APPLICATIONS TO:

U.S. NUCLEAR REGULATORY COMMISSION, REGION I  
NUCLEAR MATERIALS SAFETY SECTION B  
475 ALLENDALE ROAD  
KING OF PRUSSIA, PA 19406

ALABAMA, FLORIDA, GEORGIA, KENTUCKY, MISSISSIPPI, NORTH CAROLINA,  
PUERTO RICO, SOUTH CAROLINA, TENNESSEE, VIRGINIA, VIRGIN ISLANDS, OR  
WEST VIRGINIA, SEND APPLICATIONS TO:

U.S. NUCLEAR REGULATORY COMMISSION, REGION II  
NUCLEAR MATERIALS SAFETY SECTION  
101 MARIETTA STREET, SUITE 2900  
ATLANTA, GA 30323

### IF YOU ARE LOCATED IN:

ILLINOIS, INDIANA, IOWA, MICHIGAN, MINNESOTA, MISSOURI, OHIO, OR  
WISCONSIN, SEND APPLICATIONS TO:

U.S. NUCLEAR REGULATORY COMMISSION, REGION III  
MATERIALS LICENSING SECTION  
799 ROOSEVELT ROAD  
GLEN ELLYN, IL 60137

ARKANSAS, COLORADO, IDAHO, KANSAS, LOUISIANA, MONTANA, NEBRASKA,  
NEW MEXICO, NORTH DAKOTA, OKLAHOMA, SOUTH DAKOTA, TEXAS, UTAH,  
OR WYOMING, SEND APPLICATIONS TO:

U.S. NUCLEAR REGULATORY COMMISSION, REGION IV  
MATERIAL RADIATION PROTECTION SECTION  
611 RYAN PLAZA DRIVE, SUITE 1000  
ARLINGTON, TX 76011

ALASKA, ARIZONA, CALIFORNIA, HAWAII, NEVADA, OREGON, WASHINGTON,  
AND U.S. TERRITORIES AND POSSESSIONS IN THE PACIFIC, SEND APPLICATIONS  
TO:

U.S. NUCLEAR REGULATORY COMMISSION, REGION V  
NUCLEAR MATERIALS SAFETY SECTION  
1450 MARIA LANE, SUITE 210  
WALNUT CREEK, CA 94690

PERSONS LOCATED IN AGREEMENT STATES SEND APPLICATIONS TO THE U.S. NUCLEAR REGULATORY COMMISSION ONLY IF THEY WISH TO POSSESS AND USE LICENSED MATERIAL IN STATES SUBJECT TO U.S. NUCLEAR REGULATORY COMMISSION JURISDICTION.

### 1. THIS IS AN APPLICATION FOR (Check appropriate item)

- ☐ A. NEW LICENSE  
☐ B. AMENDMENT TO LICENSE NUMBER \_\_\_\_\_  
☒ C. RENEWAL OF LICENSE NUMBER 47-18403-01

### 2. NAME AND MAILING ADDRESS OF APPLICANT (Include Zip Code)

Mountaineer, Inc.  
Rt. 2, Box 264-D  
Mt. Hope, WV 25880

### 3. ADDRESS(ES) WHERE LICENSED MATERIAL WILL BE USED OR POSSESSED.

Various construction projects throughout the state of West Virginia

### 4. NAME OF PERSON TO BE CONTACTED ABOUT THIS APPLICATION

Edward C. Treadway

### TELEPHONE NUMBER

304-877-5561

SUBMIT ITEMS 5 THROUGH 11 ON 8 1/2 x 11" PAPER. THE TYPE AND SCOPE OF INFORMATION TO BE PROVIDED IS DESCRIBED IN THE LICENSE APPLICATION GUIDE.

### 5. RADIOACTIVE MATERIAL

a. Element and mass number, b. chemical and/or physical form, and c. maximum amount  
which will be possessed at any one time.

### 6. PURPOSE(S) FOR WHICH LICENSED MATERIAL WILL BE USED.

### 7. INDIVIDUAL(S) RESPONSIBLE FOR RADIATION SAFETY PROGRAM AND THEIR TRAINING AND EXPERIENCE.

### 8. TRAINING FOR INDIVIDUALS WORKING IN OR FREQUENTING RESTRICTED AREAS

### 9. FACILITIES AND EQUIPMENT.

### 10. RADIATION SAFETY PROGRAM.

### 11. WASTE MANAGEMENT.

### 12. LICENSEE FEES (See 10 CFR 170 and Section 170.31)

### FEE CATEGORY

AMOUNT  
ENCLOSED \$110.00

### 13. CERTIFICATION. (Must be completed by applicant) THE APPLICANT UNDERSTANDS THAT ALL STATEMENTS AND REPRESENTATIONS MADE IN THIS APPLICATION ARE BINDING UPON THE APPLICANT.

THE APPLICANT AND ANY OFFICIAL EXECUTING THIS CERTIFICATION ON BEHALF OF THE APPLICANT, NAMED IN ITEM 2, CERTIFY THAT THIS APPLICATION IS  
PREPARED IN CONFORMITY WITH TITLE 10, CODE OF FEDERAL REGULATIONS, PARTS 30, 32, 33, 34, 35, AND 40 AND THAT ALL INFORMATION CONTAINED HEREIN,  
IS TRUE AND CORRECT TO THE BEST OF THEIR KNOWLEDGE AND BELIEF.

WARNING: 18 U.S.C. SECTION 1001 ACT OF JUNE 25, 1948, 62 STAT. 749 MAKES IT A CRIMINAL OFFENSE TO MAKE A WILLFULLY FALSE STATEMENT OR REPRESENTATION  
TO ANY DEPARTMENT OR AGENCY OF THE UNITED STATES AS TO ANY MATTER WITHIN ITS JURISDICTION.

### SIGNATURE—CERTIFYING OFFICER

### TYPED/PRINTED NAME

### TITLE

### DATE

*Edward C. Treadway*

Edward C. Treadway

Vice President

3/3/89

8904170435 890323  
REG2 LIC30  
47-18403-02

PNU

### FOR NRC USE ONLY

TYPE OF FEE	FEE LOG	FEE CATEGORY	COMMENTS	APPROVED BY
AMOUNT RECEIVED	CHECK NUMBER		<i>per 11/3/89 letter for fee info</i>	DATE

Number 5

- A. Cesim 137 and American 241 Beryllium.
- B. Sealed Source
- C. Max. 9MCI 10% per source - Max. 3 sources

Number 6 - For use in a Troxler 3400 series

Surface moisture - density measurement of construction materials

Number 7

Edward C. Treadway  
Everett Taylor - See Attached  
Gerald Kosnoski

Number 8

See Attached

Number 9

See Attached

Number 10

See Attached



# TROXLER ELECTRONIC LABORATORIES, INC.

HEREBY CERTIFIES THAT

EDWARD TRIADMAN  
of

MOUNTAINEER, INC.

HAS SUCCESSFULLY COMPLETED THE TROXLER ELECTRONIC LABORATORIES, INC.  
TRAINING COURSE FOR THE USE OF NUCLEAR TESTING EQUIPMENT.

SUBJECTS INCLUDED IN THIS COURSE WERE AS FOLLOWS:

## Radiological Safety

1. Principles and practices of radiation protection.
2. Leak testing procedures.
3. Mathematics and calculations basic to the use and measurement of radioactivity.
4. Biological effects of radiation.
5. Radioactivity measurement standardization and monitoring techniques and instruments.
6. Accident and incident procedures.
7. Procedures for nuclear gauge storage and transportation.
8. General safety precautions.

## Probe Operation

1. Instrument theory.
2. Operating procedures.
3. Maintenance.

4. Field application.
5. Gauge calibration.

3/15/78  
DATE

William F. Troxler  
PRESIDENT

INSTRUCTOR

Item #7

Edward Treadway

2 day seminar by Troxler Laboritories

Attended a 4 day course sponsored by the West Virginia Contractors Association  
(Troxler 3400 series gauge)

Covering subjects such as: Nuclear Safety

Handling and Storage of the Nuclear Gauge

Leak test procedures and actual operation of the gauge

West Virginia Department of Highways - Certified Compaction Technician #128

Type Used:

Cesium 137

Sealed Source per Troxler drawing #A-102112 ✓  
Maximum of 8 MCI  $\pm$  10% per source

American 241

Sealed Source per Troxler drawing ✓

Beryllium

#A-102451  
Maximum of 40  $\pm$  10% per source

Item #8

Edward Treadway - Lab Supervisor

Troxler Electronic Lab Inc. Standard two (2) day training. (Certificate Enclosed)

West Virginia Contractors Association - with supervision of the WV Department of Highways Compaction Engineer. A  $3\frac{1}{2}$  day training and actual use of the Troxler Gauge Model #2401 compac surface moisture - density gauge.  
West Virginia Compaction Certification #128

The Radiological safety responsibilities will be the responsibility of Edward Treadway.

No previous experience prior to the mentioned sessions above.

As required completion of manufacturers training and safety program by any employee using device will be required.

All required records on training will be maintained for a minimum of 2 years.



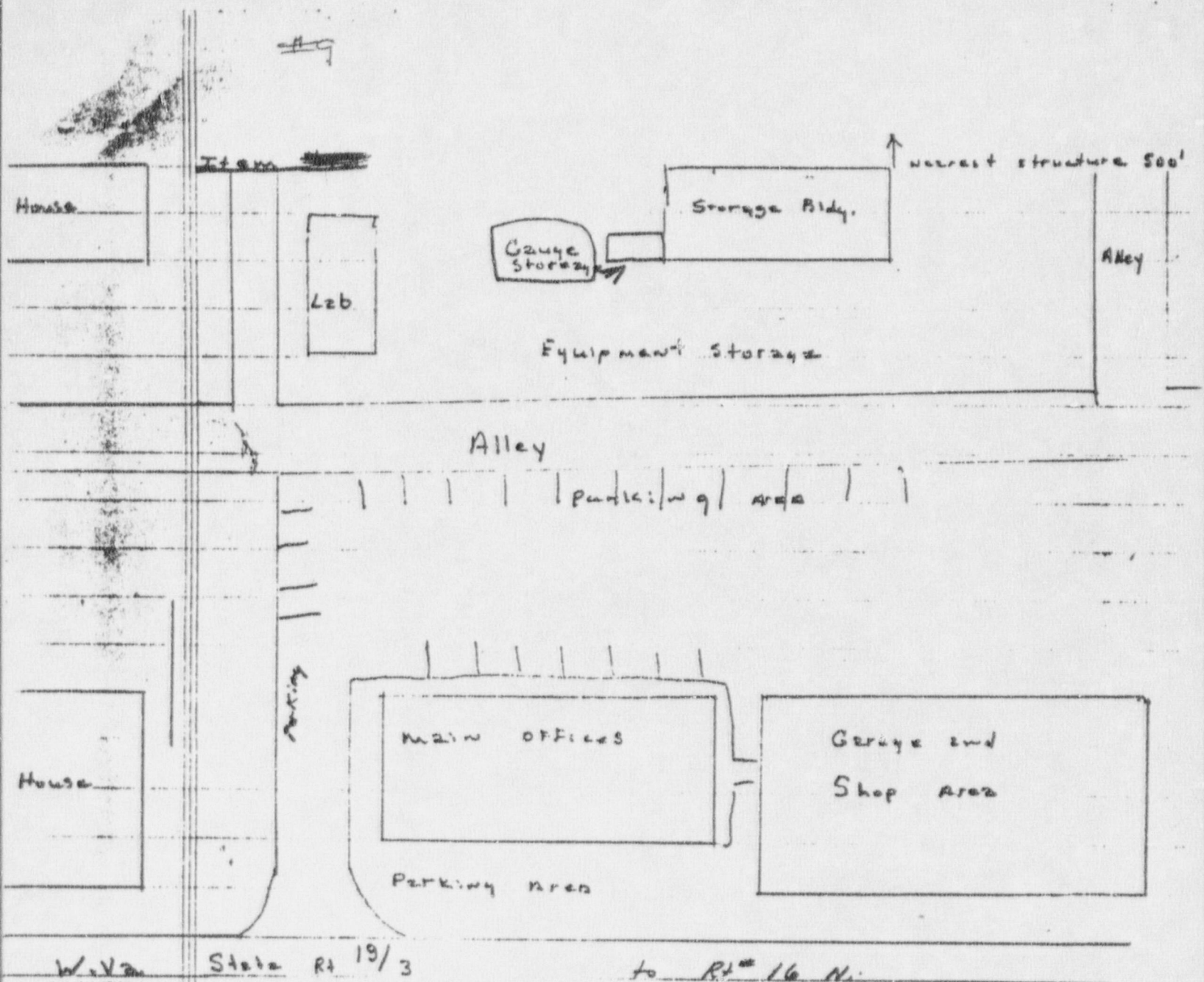

→ Location North of Beckley off of Rt # 16

\*note: Nuclear Gauge will be stored beside the back storage building. Also it will be clearly designated by Radioactive Signs.

Only Edward Treadway will maintain the Key to guard against unauthorized removal.

This area is not a working area - storage building is used for construction materials only.

Also note that entire area is secured by 10' Chain Link Fence!

Item #10.1

All gauges while on temporary job sites will be secured in such a manner as to safeguard against unauthorized access. The gauge will be stored in a structure in which will be securely locked and only Edward Treadway, Everett Taylor, and Gerald Kosnoski, Lab Supervisor will have access at this time.

When the gauge is in use and stored periodically through the day, all precautions will be formed by Edward Treadway, as to insure against unnecessary use or removal of the gauge.

Personnel monitoring will be with film badges, current supplier:

R.S. Landauer, Jr. Company  
Glenwood Science Park  
Glenwood, IL 60425

Will exchange quarterly.

Item #10.3

Troxler Model RK-1 Leak Test Kit

Duties Performed by Radiation Protection Officer:

- A. Assure that all by-product materials possessed are in accordance with licensed materials.
- B. Assure that only authorized persons in accordance with License are permitted to operate gauge.
- C. Assure that all users wear film badges.
- D. Maintain proper security in seeing that the gauge is not disturbed by unauthorized people.
- E. To contact proper authority (NRC) and local police in the case of field damage, fire or theft of gauge.
- F. To maintain proper records on leak tests - personnel exposure in accordance with the NRC and periodic leak tests are performed.
- G. To maintain storage area in order to be designated as a "Radioactive Storage Area."
- H. Maintain safe transporting methods to and from projects, also securing temporary storage areas to insure unauthorized persons gaining access to gauge.
- I. Maintaining any work sheet as to the work done on the gauge - Such work to be done only by the manufacturer.
- J. In the event of disposal, gauge will be returned to manufacturer.



# Mountaineer, Inc.

Route 1

MOUNT HOPE, WEST VIRGINIA 25880

PHONE 804-877-5561

Box 264-D

Item #10.4

Maintenance on gauges will be done by the Troxler Electronic Laboratories only absolutely no one is to perform any maintenance involving dismantling, or removal of source holder.



## DIVISIONS

### MOUNTAINEER SEEDING

Mine Reclamation Service  
Industrial Sites & Airports

### MOUNTAINEER SAFETY

Safety Instruction & Equipment

### MOUNTAINEER EQUIPMENT

Heavy Equipment  
Sales, Service & Repairs

### MOUNTAINEER BUILDERS

Mitchell Metal Buildings  
Sales and Erection

# Mountaineer, Inc.

Route 1

MOUNT HOPE, WEST VIRGINIA 25880

PHONE 304-877-5561

Box 264-D

Item #10.5

Transport by private motor vehicle only.

Gauge will be transported in its container under the "yellow II" label without placarding the vehicle as required by 49CFR 177.823.

The source rod will be placed in its locked position within its container. Also said container will be placed in a locked portion of the vehicle while in transit. While not in use the vehicle and gauge will be secured in an isolated area within the project limit. Also the gauge will not be stored while in transit or secured in an area not less than 30 centimeters as per CFR 49.

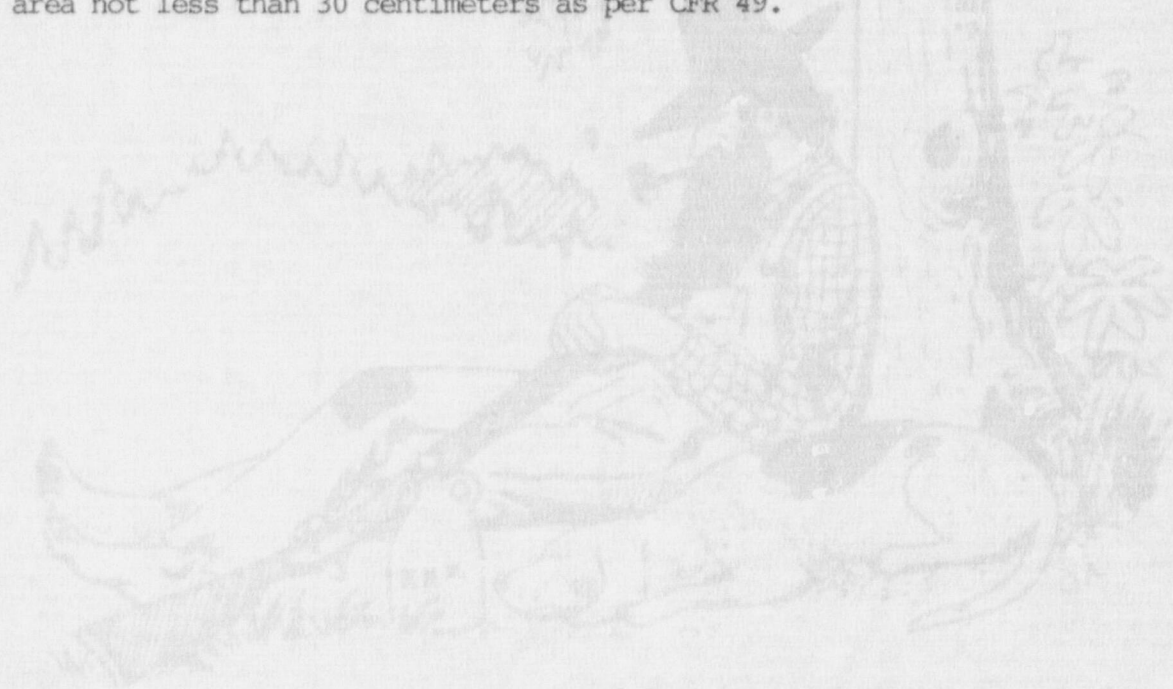

## DIVISIONS

**MOUNTAINEER SEEDING**  
Mine Reclamation Service  
Industrial Sites & Airports

**MOUNTAINEER SAFETY**  
Safety Instruction & Equipment

**MOUNTAINEER EQUIPMENT**  
Heavy Equipment  
Sales, Service & Repairs

**MOUNTAINEER BUILDERS**  
Mitchell Metal Buildings  
Sales and Erection



# Mountaineer, Inc.

Route 1

MOUNT HOPE, WEST VIRGINIA 25880

PHONE 304-877-5561

Box 264-D

## Item #10.6

In the event of an accident or the loss of a sealed source immediate telephone notification will be made to the following:

- (a) Edward Treadway - Company Safety Officer  
Office 304-877-5563 Home 304-877-5389
- (b) Nuclear Regulatory Office - Washington, D.C.  
202-427-4228
- (c) State Health Department  
304-252-8531
- (d) Law Enforcement  
304-253-8311
- (e) Troxler Electronic Laboratories  
919-549-8661

## Item #11.0

In the event of physical damage:

- (1) 6 feet radius of exclusion will be maintained until extent of source damage determined.
- (2) If in a vehicle - vehicle will be stopped and maintained to determine hazard.
- (3) If visual damage is obvious - the proper authorities as mentioned above will be notified. All personnell kept clear.
- (4) Removal of instrument from site by any method but safeguarding at least a 6 foot distance and placing the gauge in a metal drum - immediately contacting Troxler Laboritoies. For disposition.

## DIVISIONS

**MOUNTAINEER SEEDING**  
Mine Reclamation Service  
Industrial Sites & Airports

**MOUNTAINEER SAFETY**  
Safety Instruction & Equipment

**MOUNTAINEER EQUIPMENT**  
Heavy Equipment  
Sales, Service & Repairs

**MOUNTAINEER BUILDERS**  
Mitchell Metal Buildings  
Sales and Erection