



Genesis Labs, Inc.

5182 W. 76th Street
Minneapolis, MN 55435
Phone: (612) 835-3446

Fax: (612) 835-9406
Telex: 9105760077
GENESIS LABS UD

February 5, 1987

Ms. Patricia J. Whiston
Materials Licensing Section
U.S. Nuclear Regulatory Commission
Region III
799 Roosevelt Road
Glen Ellyn, IL 60137

RE: Additional information for amendment to license #22-20286-01

Dear Ms. Whiston:

Please find enclosed a copy of the close-out survey of the radioisotope area at our former facility at 5245 Edina Industrial Boulevard, Edina, MN 55435. The diagram indicates where I-125 was used and stored. Several areas were surveyed in the hood and on the work bench as well as the exterior and interior surfaces of the refrigerator. A blank swab and calibration control were included. Areas 1a and 2 were found to be above background. These areas were decontaminated with soap and water and resurveyed. The counts are included as samples 1,2, 12-14. I performed the survey and decontamination survey on August 6, 1986. The instrument used to count the survey was a Beckman Gamma 5500. This instrument is calibrated on a quarterly basis (last calibrated on December 5, 1986.) The background counts were slightly elevated due to an electronic problem which has since been repaired. An additional survey was done using a Ludlum Model 12 G/M counter. No areas showed counts above background. This instrument was last calibrated on March 25, 1986.

Sincerely,

Karen L. Richards

Karen L. Richards, Ph.D.
Radiation Safety Officer

sh

Enclosure

8707210632 870219
REG3 LIC30
22-20286-01

PDR

LOG *Feb 8*
Remitter
Check No.
APPROVED
DATE *Feb 8*
Type of Survey
Date Check
Date Completed
By *[Signature]*

RECEIVED
FEB 09 1987
REGION III

FEB 9 1987

CONTROL NO. 82909

MONTHLY RADIOISOTOPE SURVEY FORM

Close out survey for old lab.

ISOTOPE: I¹²⁵
DATE: 8/6/86

8 - under hood
9 - under bench
10 - under shelves
11 - shelves.

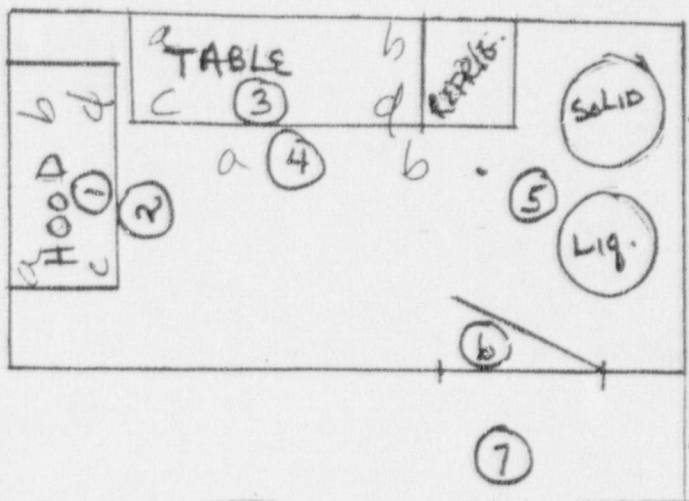

DRY SWAB

G/M COUNTER

POSITION		CPM *	RECOUNT CPM			CPM *	RECOUNT CPM
	12	1.00	173 blank	<div>Recount.</div>			
	13	1.00	182 bl				
1	114	1.00	113 bl				
	115	1.00	118 bl				
	116	1.00	115 bl				
2	117	1.00	128 1a				
	118	1.00	411 1b				
3	119	1.00	607 1c				
	120	1.00	288 1d				
4	121	1.00	138 b				
	122	1.00	1219 2				
5	123	1.00	160 3a				
	124	1.00	205 3b				
6	125	1.00	178 3c				
	126	1.00	285 3d				
7	127	1.00	388 4a				
	128	1.00	248 4b				
8	129	1.00	262 5				
	130	1.00	218 6				
9	131	1.00	413 7				
	132	1.00	180 8				
10	133	1.00	279 9				
	134	1.00	281 10				
	135	1.00	175 11				
* 2				12	1.00	163 6/1b	
I				13	1.00	181 1c	
				14	1.00	178 1d	
				15	1.00	157 bl	
				16	.05	12	

SURVEYED BY: Loren Richards

ISOTOPE: I¹²⁵
DATE: 8/8/86

Close out of small
refrigerator to be moved
out of "hot" lab.

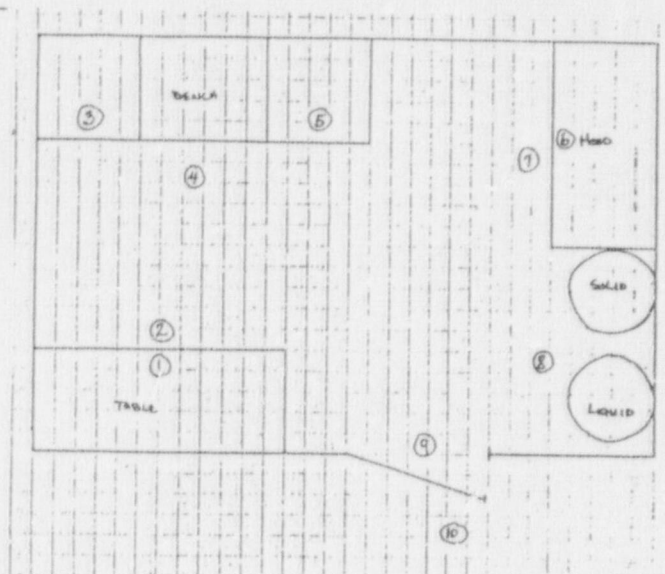

G/M COUNTER

POSITION	CPM *	RECOUNT CPM	POSITION	CPM *	RECOUNT CPM
background:			background:		
1					
2	24	1.00	135	bl	
3	25	1.00	135	bl	
4	26	1.00	122	bl	
5	27	1.00	143	bl	
6	28	1.00	153	bl	
7	29	1.00	153	bl	
8	30	1.00	153	bl	
9	31	1.00	153	bl	
10	32	1.00	153	bl	
	33	1.00	153	bl	
	34	1.00	154	bl	
	35	1.00	154	bl	
	36	1.00	174	bl	
	37	1.00	200	bl	
	38	1.00	137	bl	
	39	1.00	153	bl	
	40	1.00	153	bl	

SURVEYED BY: *Kenneth Richards*

CONTROL NO. 82909