

BEFORE THE UNITED STATES ATOMIC ENERGY COMMISSION

Record file Co. (suppl)

In the Matter of PACIFIC GAS
AND ELECTRIC COMPANY

Docket No. 50-205

Amendment No. 7

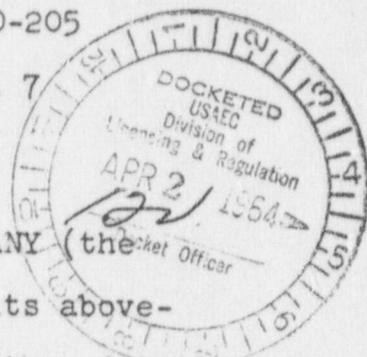

Now comes PACIFIC GAS AND ELECTRIC COMPANY (the Company) and submits herewith Amendment No. 7 to its above-numbered application. This amendment presents further details of the Company's design of Unit No. 1 (the Unit) of its Bodega Bay Atomic Park (the Plant).

Previous portions of this application have dealt with the Company's comprehensive and detailed geologic and seismologic investigation of the site of the Unit. The reports of the experts retained by the Company to conduct this investigation have been filed as a part of this application. As set forth more fully in those reports, during excavation of the reactor pit a fault was uncovered in the bedrock to which particular significance has been attached by others. This fault is shown on Figure 6 of the Tocher-Marliave Report dated January 1964, which is included as a part of Amendment No. 5 to the application. Based upon the undisturbed condition of the sediments overlying this fault it has been concluded that no movement has occurred on the fault for at least 40,000 years. and probably much longer. Since this fault has been inactive for this long period of time during which the nearby San Andreas fault is believed to have

1777

moved hundreds of times, the Company and its consultants have concluded (1) that no movement is expected to occur along this fault for a period in excess of the lifetime of the Plant, and (2) even if such a movement should occur it would not amount to more than a fraction of an inch.

Even though the possibility of such movement occurring is not considered to be credible, the Company has developed a design concept for the Unit which will accommodate movement along this bedrock fault. As illustrated in the attached drawing, the design contemplates that the reactor containment structure will rest on a layer of granular material, such as sand, on top of the bedrock, and the space between the outside wall of the reactor containment structure and the adjacent rock will be filled with a layer of compressible material, of a type yet to be selected. This design will enable the reactor containment structure to withstand a horizontal movement along the fault of two inches without sustaining any damage or impairment of function.

In the incredible event of horizontal motion of one foot along this fault the reactor containment structure may be displaced but is not expected to suffer any damage or impairment of function, and it is expected that the Unit could be brought to a safe shutdown. With a two foot horizontal movement along this fault, the Company's analysis indicates that a part of the lower portion of the reactor containment structure may be crushed inwards up to twelve inches but the steel lining of the pressure

suppression chamber, though distorted, would remain intact. Even with this amount of motion it is expected that there would be no impairment of containment and that the Unit could be brought to a safe shutdown.

Vertical movements up to two feet are not expected to damage the reactor containment structure nor impair its function but might result in the structure being tilted slightly.

Subscribed in San Francisco, California, this 31st day of March, 1964.

Respectfully submitted,
PACIFIC GAS AND ELECTRIC COMPANY

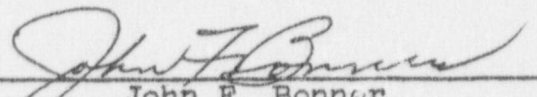
By 
John F. Bonner
Vice President and Assistant
General Manager

RICHARD H. PETERSON
PHILIP A. CRANE, JR.
Attorneys for Pacific Gas
and Electric Company

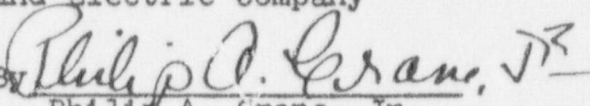
By 
Philip A. Crane, Jr.

Subscribed and sworn to before me
this 31st day of March, 1964

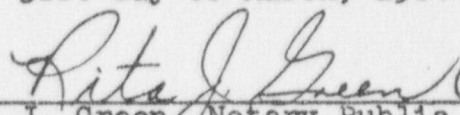
 (SEAL)
Rita J. Green, Notary Public in
and for the City and County of
San Francisco, State of California

My Commission Expires July 16, 1967.

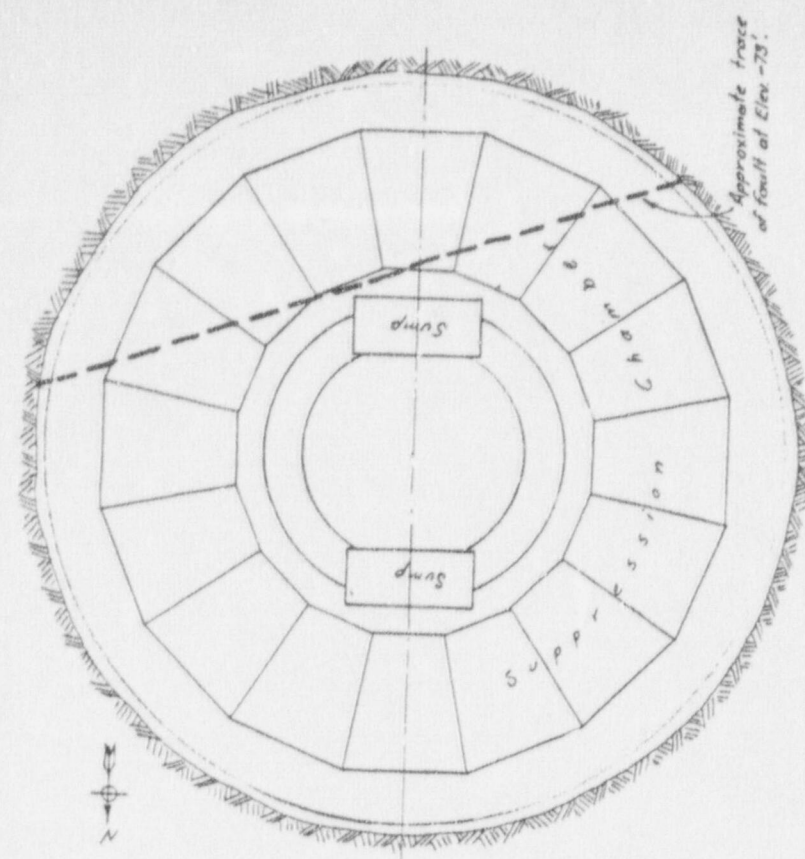

PLAN AT ELEV. -52.6'

Approximate trace of fault at Elev -73'

PROPOSED FOUNDATION PLAN
 BODEGA BAY UNIT NO. 1
 To accompany Amendment No. 7
 Bodega Bay PHSR 3-27-68

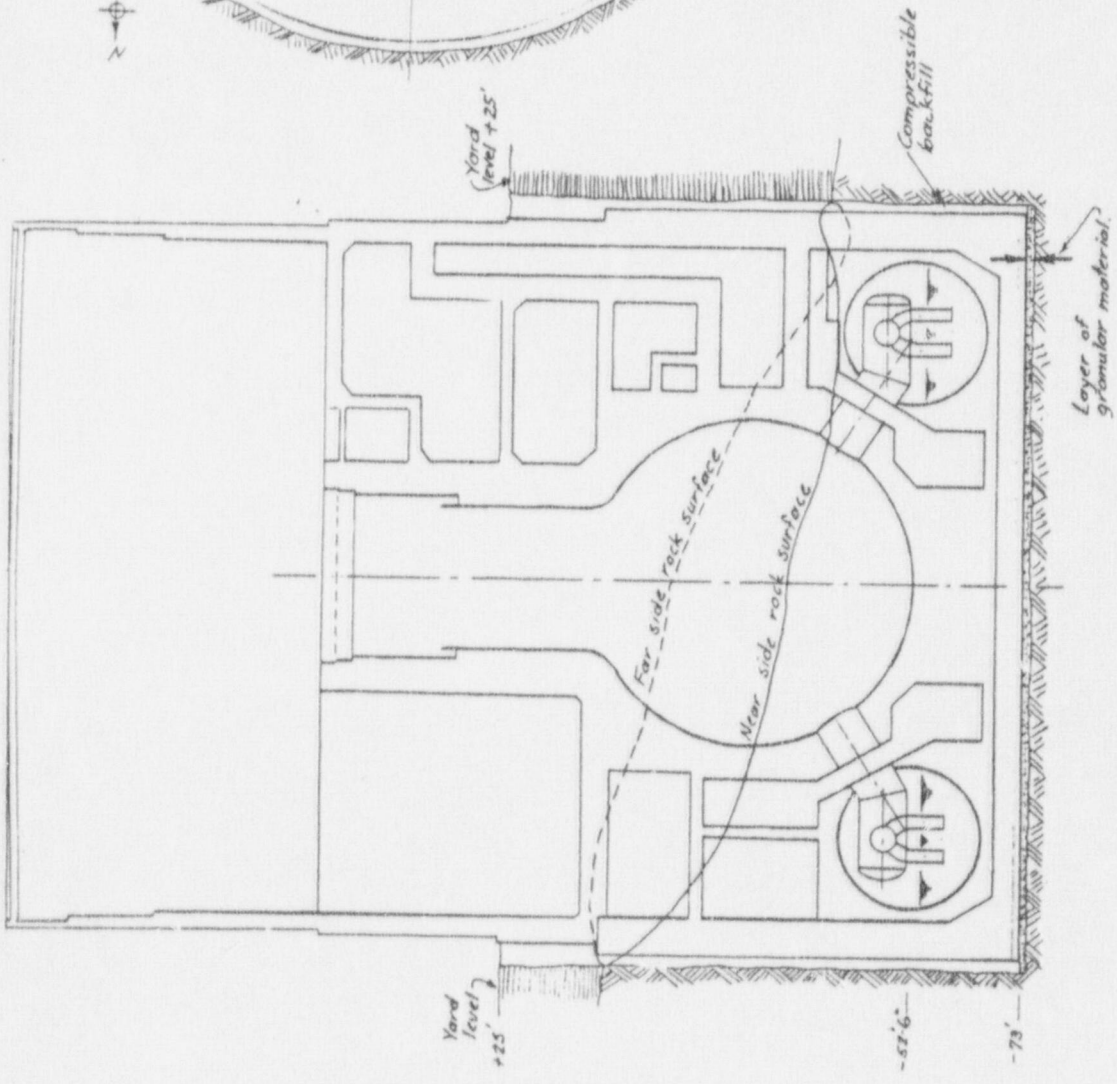

SECTION ON ϕ LOOKING EAST

FROM: PACIFIC GAS AND ELECTRIC COMPANY San Francisco, Calif. Richard H. Peterson		DATE OF DOCUMENT: 3-21-64	DATE RECEIVED: 4-2-64	NO: 1777
TO: Dir, DLAR		LTR. <input checked="" type="checkbox"/>	MEMO:	REPORT:
CLASSIF.: U		ORIG.: <input checked="" type="checkbox"/>	CC:	OTHER: 24 cys verified
POST OFFICE REG. NO:		ACTION NECESSARY <input checked="" type="checkbox"/>	CONCURRENCE COMMENT <input type="checkbox"/>	DATE ANSWERED: BY:
DESCRIPTION: (Must Be Unclassified) Ltr. trans: AMENDMENT NO. 7, entered 3-21, which is relative to a fault which was un-covered in the bedrock to which partic-ular significance has been attached by others. Attached: Sketch, "Proposed Foundation Plan Redaga Bay Unit No. 1" (59 CYS REC'D) "Certificate of Service," showing cys of the foregoing being served on Sonoma County Board of Supervisors.		FILE CODE: Docket No. 50-205		
		REFERRED TO	DATE	RECEIVED BY
		Dr. Bryan:	4-3	
		w/all extras--FOR ACTION		
		Note: Holding 6 cys for Hearing File.		
REMARKS: NR Distributions: 1 - formal file 1 - suppl file 1 - AEC PIR 1 - SAN PDR 1 - E. Steels 1 - Div. of Compliance		ACKNOWLEDGED		
		1777		

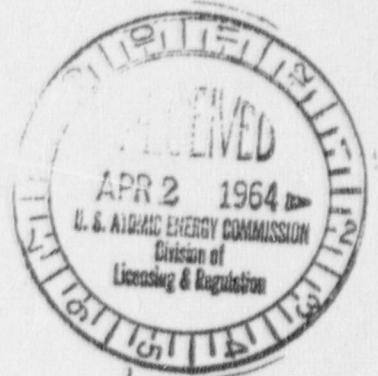

*Record file copy
(suppl)*

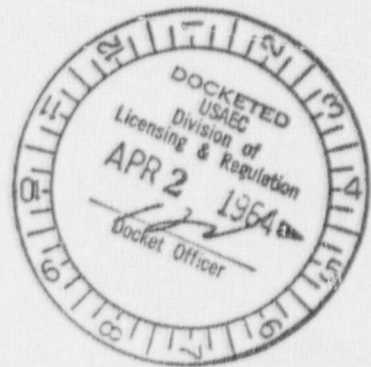

ACKNOWLEDGED

UNITED STATES OF AMERICA
FEDERAL BUREAU OF INVESTIGATION

UNITED STATES OF AMERICA
FEDERAL BUREAU OF INVESTIGATION

Record file Cy.
(Suppl)

STATEMENTS OF SERVICE

Agent: [Name] [Address] [City] [State] [Zip]

[Faded text describing service details]

Mr. [Name]
[Address]
[City] [State] [Zip]

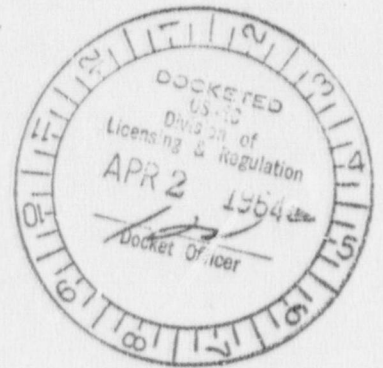

Pacific Gas and Electric Company