



Rensselaer Polytechnic Institute Troy, New York 12180-3590

June 12, 1987

Herbert N. Berkow, Director
Standardization and Non-Power Reactor Project Directorate
Division of Reactor Projects - III, IV, V
and Special Projects, NRR
US Nuclear Regulatory Commission
Washington, DC 20555

SUBJECT: RPI REACTOR CRITICAL FACILITY FENCE MODIFICATIONS,
LICENSE CX-22, DOCKET NO. 50-225.

Dear Mr. Berkow:

Fence modifications around the Civil Protection and Security Zones of the RPI Reactor Critical Facility were completed on June 11, 1987 (figure enclosed). These changes return the Facility Security to the "spirit" of the past situation (before 30 December 1986) and to that of the new Security Plan submitted to the US Nuclear Regulatory Commission.

Sincerely,

Mr. Francisco Rodriguez-Vera,
Supervisor
RPI Reactor Critical Facility

Dr. Donald R. Harris
Director
RPI Reactor Critical Facility

Enclosure

cc: R. Block
B. Drobnicki
G. Dahl
G. Judd
D. Sangrey
A. Macica

8706190233 870612
PDR ADDCK 05000225
F PDR

A020
1/1

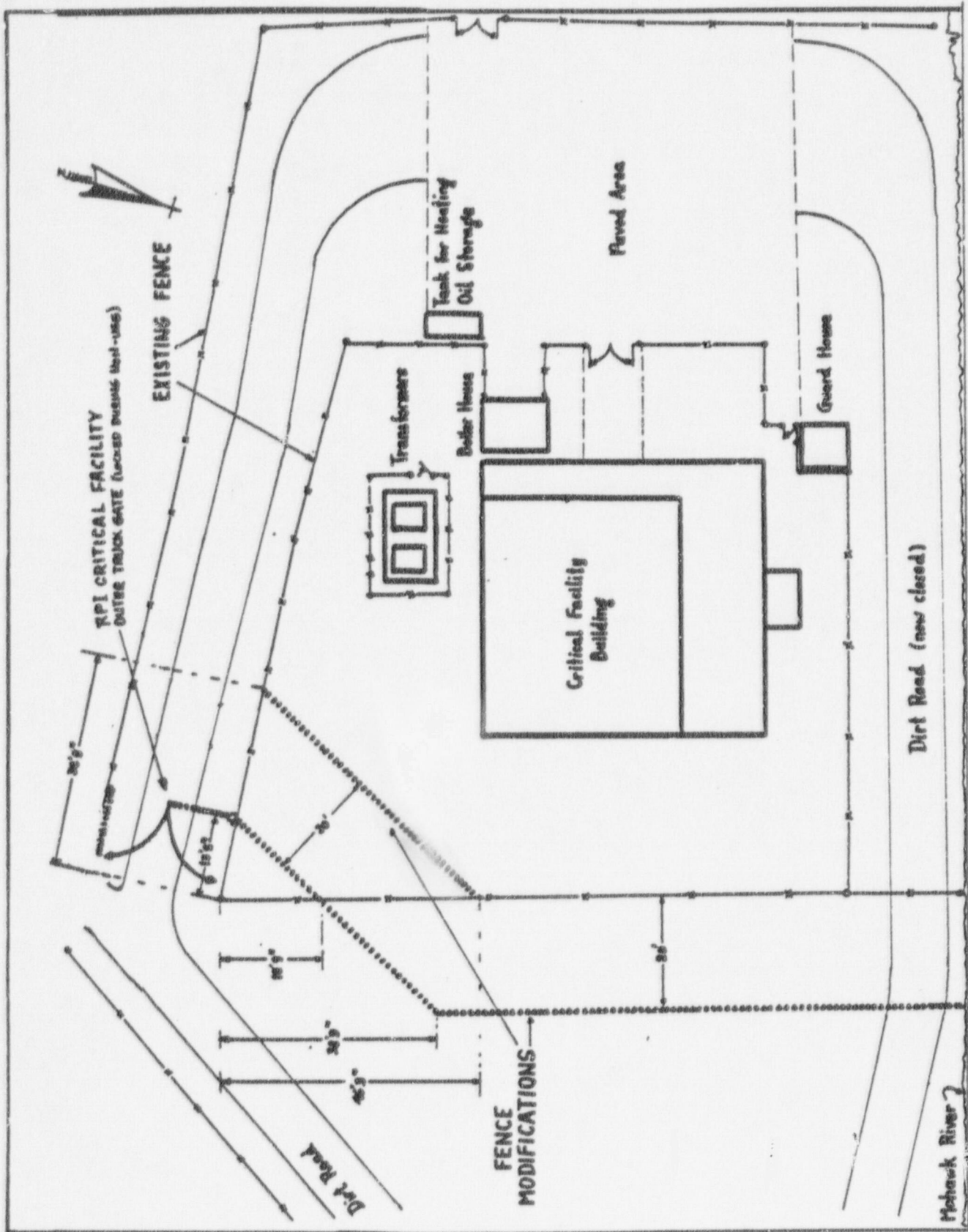

RPI CRITICAL FACILITY
OUTSIDE TRUCK GATE (located pursuant to 1041-1046)

EXISTING FENCE

Transformers

Boiler House

Truck for Hoisting
Oil Storage

Paved Area

Critical Facility
Building

Guard House

Dirt Road (new closed)

Mohawk River

Dirt Road

FENCE
MODIFICATIONS

20'-0"

10'-0"

20'-0"

20'-0"

20'-0"

20'-0"

20'-0"