



**Veterans  
Administration**

25/109

-01354

June 19, 1986

In Reply Refer To: 557/115

U.S. Nuclear Regulatory Commission  
Region II  
101 Marietta Street, N.W., Suite 2900  
Atlanta, Georgia 30323

THRU: Dr. James Fletcher  
Director, Nuclear Medicine Service (115)  
VA Central Office  
Room 927-C  
Washington, D.C. 20420

RE: Radioactive Materials License No. 10-09569-01  
Release of Area for Unrestricted Use  
VA Medical Center, Dublin, Georgia

Gentlemen:

Pursuant to license amendment No. 19 dated September 10, 1985, the Nuclear Medicine Department has been moved to a new location within the facility.

In accordance with the guidelines established by the NRC, dated December 1975, "Guidelines for Decontamination of Facilities and Equipment Prior to Release for Unrestricted Use," we submit herein our final survey of the vacated area for your approval (refer to enclosures).

Following a thorough cleaning of the hot lab and scan room, wipe testing and survey meter monitorings were performed, as indicated on the enclosed diagrams. Wipe tests were conducted on 100 cm<sup>2</sup> areas using absorbent paper moistened by alcohol. Counting of the wipes was conducted using a well counter with an efficiency of 36%. All radiation labels, symbols, etc., have been removed. Renovation of the vacated area will begin upon your approval. Due to cost constraint matters, a prompt response would be greatly appreciated.

If you have any questions regarding this close-out survey, please do not hesitate to contact the undersigned.

Sincerely yours,

FEE EXEMPT

For and in the  
absence of

WILLIAM O. EDGAR  
Medical Center Director

Enclosures 8

JAMES W. FLETCHER, M.D.  
Director, Nuclear Medicine Service (115)  
Veterans Administration  
Washington, DC 20420

8607160390 860703  
REG2 LIC30  
10-09569-01 PDR

Received 6/30/86  
PG Reg II

WIPE TEST RESULTS

Detector used to count wipes: Beckman  
Detector efficiency: 36%

<u>Location of Measurement</u>	<u>Results (DPM above background)</u>
1	0
2	8.4
3	0
4	25.2
5	0
6	16.8
7	33.6
8	2.8
9	8.4
10	39.2
11	8.4
12	0
13	0
14	11.2
15	39.2
16	0
17	8.4
18	0
19	72.8
20	103.6
21	50.4
22	16.8
23	53.2
24	106.4
25	22.4
26	36.4
27	25.2
28	36.4
29	0
30	42.0
31	14.0
32	8.4
33	2.8
34	44.8
35	19.6

Background = 24 cpm = 67.2 dpm

28

# NUCLEAR MEDICINE

HOT LAB

(VAMC -  
DUBLIN, GA.)

OUTSIDE

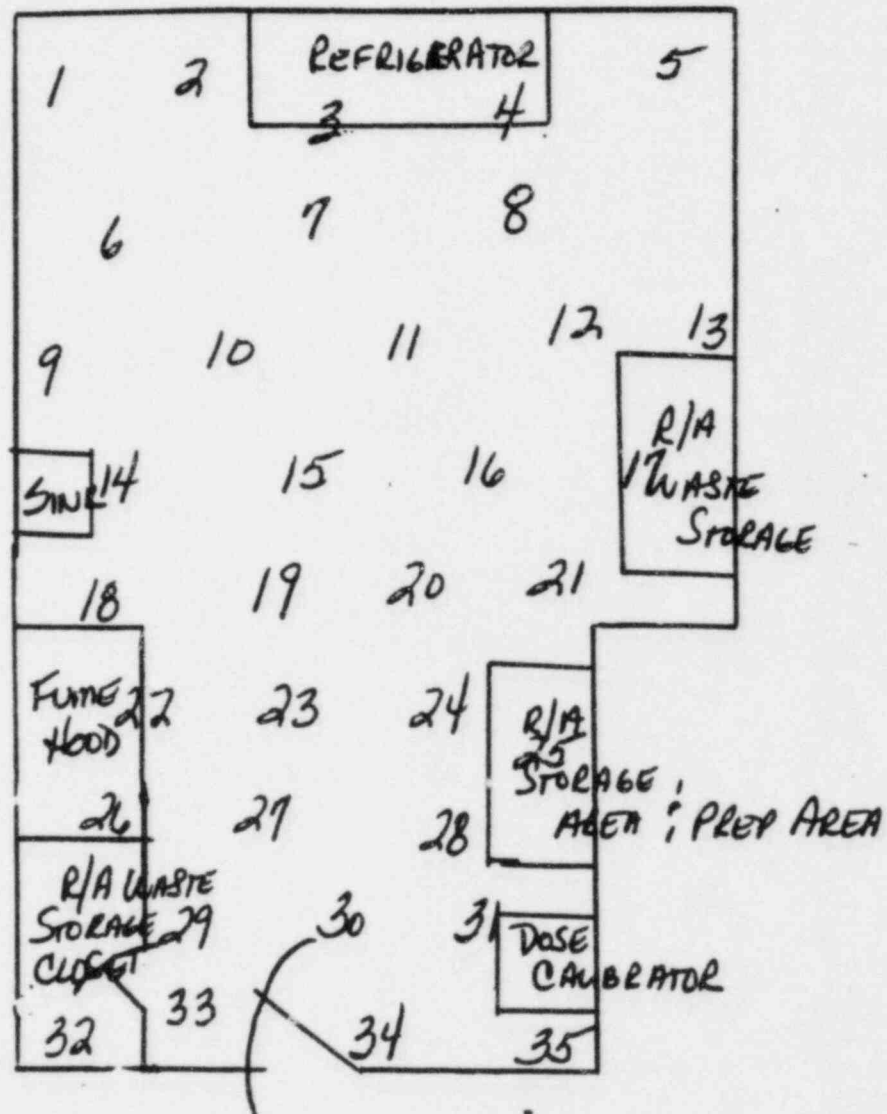

CORRIDOR

28

SURVEY METER MEASUREMENTS

Survey meter used: Eberline E-120 #9651  
Last calibration date: December, 1985

<u>Location of Measurement</u>	<u>Results (mR/hr)</u>
A	0.01
B	0.01
C	0.01
D	0.01
E	0.01
F	0.01
G	0.01
H	0.01
I	0.01
J	0.01
K	0.01
L	0.01
M	0.01
N	0.01
O	0.01
P	0.01
Q	0.01
R	0.01
S	0.01
T	0.01

Background = 0.01 mR/hr

2X

# NUCLEAR MEDICINE

## HOT LAB

(VAMC -  
DUBLIN, GA.)

OUTSIDE

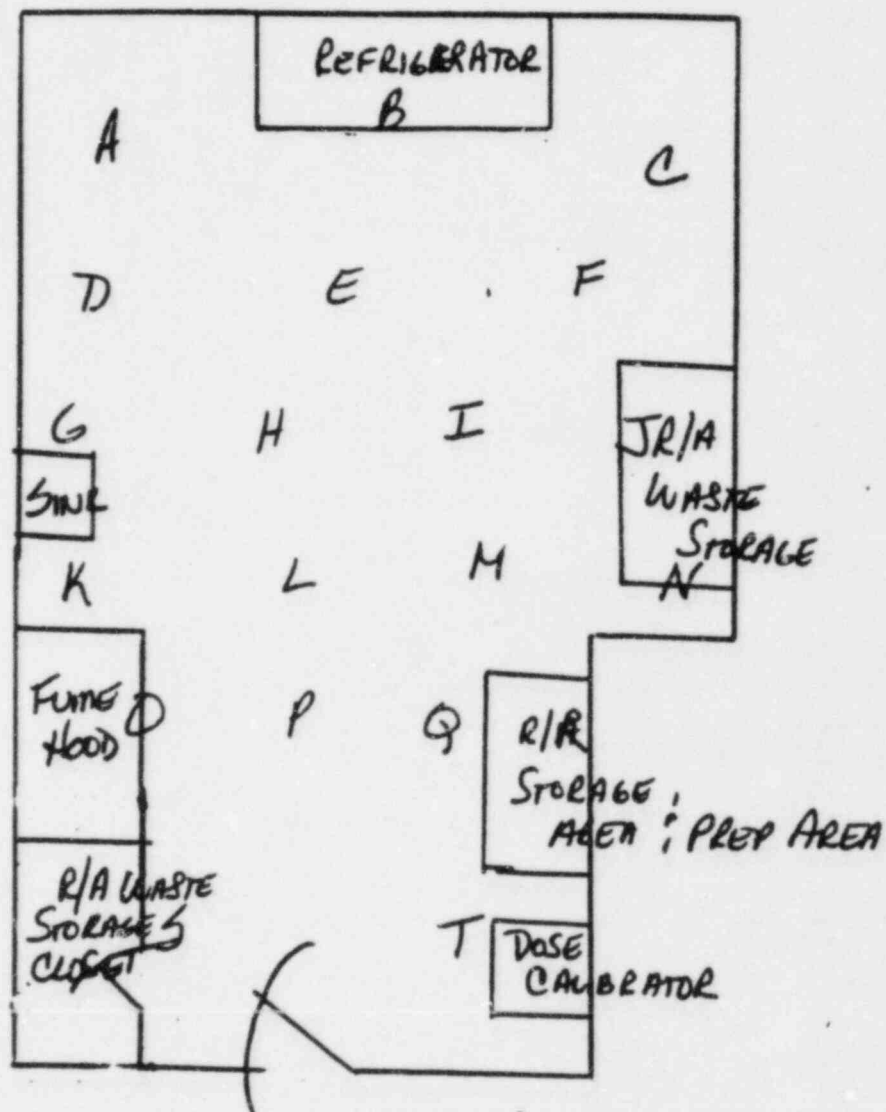

CORRIDOR

WIPE TEST RESULTS

Detector used to count wipes: Beckman  
Detector efficiency: 36%

<u>Location of Measurement</u>	<u>Results (DPM above background</u>
1	22.4
2	5.6
3	0
4	5.6
5	0
6	8.4
7	0
8	0
9	11.2
10	0
11	8.4
12	11.2
13	5.6
14	0
15	0
16	0
17	5.6
18	0
19	0
20	2.8
21	0
22	0
23	0
24	0
25	0
26	0
27	5.6
28	86.8
29	50.4
30	0
31	0
32	0
33	42.0
34	5.6
35	14.0

Background = 24 cpm = 67.2 dpm

27

NUCLEAR MEDICINE  
 (VANC-DUALIN, 6A)  
 CAMERA/SCAN  
 Room

OUTDOORS

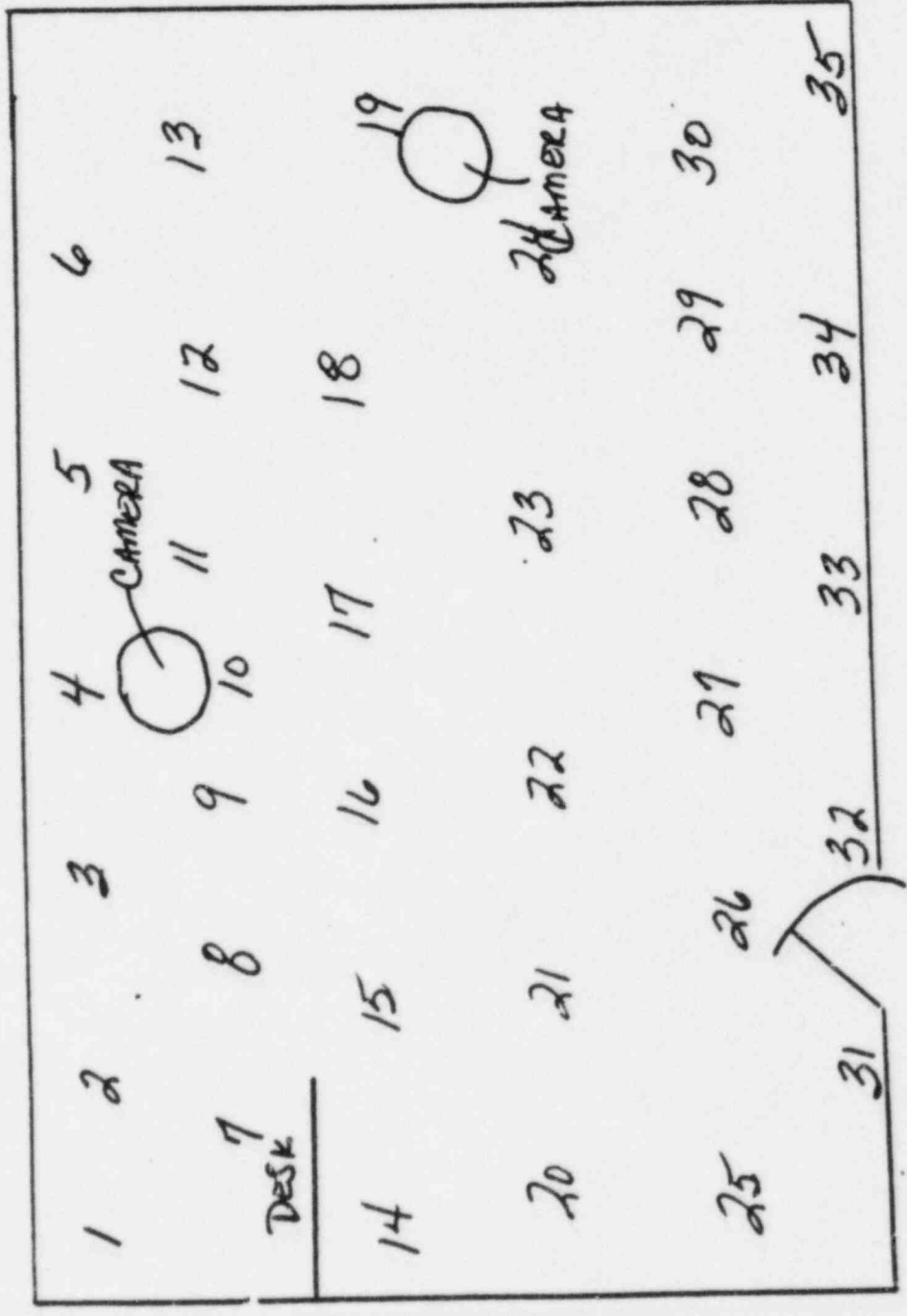

CORRIDOR

SURVEY METER MEASUREMENTS

Survey meter used: Eberline E-120 #9651  
Last calibration date: December, 1985

<u>Location of Measurement</u>	<u>Results (mR/hr)</u>
A	0.01
B	0.01
C	0.01
D	0.01
E	0.01
F	0.01
G	0.01
H	0.01
I	0.01
J	0.01
K	0.01
L	0.01
M	0.01
N	0.01
O	0.01
P	0.01
Q	0.01
R	0.01
S	0.01
T	0.01

Background = 0.01 mR/hr

24



