



**LOUISIANA**  
POWER & LIGHT

317 BARONNE STREET • P. O. BOX 60340  
NEW ORLEANS, LOUISIANA 70160 • (504) 595-3100

September 8, 1988

W3P88-1293  
A4.05  
QA

U.S. Nuclear Regulatory Commission  
ATTN: Document Control Desk  
Washington, D.C. 20555

Subject: Waterford 3 SES  
Docket No. 50-382  
License No. NPF-38  
Emergency Planning 1988 Annual Exercise

Attached is a copy of the Schedule of Activities relating to the subject annual exercise. Sketches depicting the route to Waterford 3 from New Orleans International Airport and the site layout are also attached for the convenience of your exercise evaluation team.

The schedule includes exercise related meetings and General Employee Training schedule details.

Should you have any questions concerning the attached schedule, please contact F.J. Englebracht, Waterford 3 Emergency Planning Manager, at (504) 464-3155.

Very truly yours,

R.F. Burski  
Manager  
Nuclear Safety & Regulatory Affairs

RFB:BGM:ssf

Attachments

cc: R.D. Martin, NRC Region IV  
N.E. Terc, NRC Region IV  
J.A. Calvo, NRC-NRR  
D.L. Wigginton, NRC-NRR  
NRC Resident Inspectors Office  
E.L. Blake  
W.M. Stevenson

A045  
11

8809160311 880908  
PDR ADOCK 05000382  
F PDC

\*\*\* EQUAL OPPORTUNITY EMPLOYER \*\*\*

1988 EXERCISE RELATED ACTIVITIES SCHEDULE  
WEEK OF 10/10 - 10/14

1. NRC GET-2 (For Team Members Entering the Radiation Controlled Area)  
Date: Tuesday, October 11, 1988  
Location: Waterford 3 Skills Training Center  
Time: 10 AM - 12 PM
  
2. NRC Entrance Meeting  
Date: Tuesday, October 11, 1988  
Location: Administration Building Conference Room 1  
Time: 1 PM - 1:30 PM
  
3. NRC GET-1 and Badging  
Date: Tuesday, October 11, 1988  
Location: Administration Building Conference Room 2/Security Badging Office  
Time: 1:30 PM - 3:30 PM
  
4. FEMA Pre-Exercise Briefing  
Date: Tuesday, October 11, 1988  
Location: Waterford 3 Energy Education Center  
Time: 2 PM - 4 PM
  
5. LP&L Pre-Exercise Briefing  
Date: Tuesday, October 11, 1988  
Location: Administration Building Assembly Room  
Time: 2:30 PM - 3:30 PM
  
6. NRC Pre-Exercise Briefing  
Date: Tuesday, October 11, 1988  
Location: Administration Building Conference Room 2  
Time: 3:30 PM - 5 PM
  
7. Annual Exercise, Wednesday, October 12, 1988
  
8. Controller/Monitor Debriefing  
Date: Wednesday, October 12, 1988  
Location: Administration Building Assembly Room  
Time: 6:30 PM - 10 PM

9. Controller Debriefing

Date: Thursday, October 13, 1988  
Location: Administration Building Assembly Room  
Time: 7 AM - 9 AM

10. LP&L Critique

Date: Thursday, October 13, 1988  
Location: Administration Building Assembly Room  
Time: 10 AM - 10:30 AM

11. NRC Exit

Date: Thursday, October 13, 1988  
Location: Administration Building Assembly Room  
Time: 11 AM

PLANT: WATERFORD-3

LOCATION: TAFT, LA.

LICENSEE: LOUISIANA POWER & LIGHT CO.

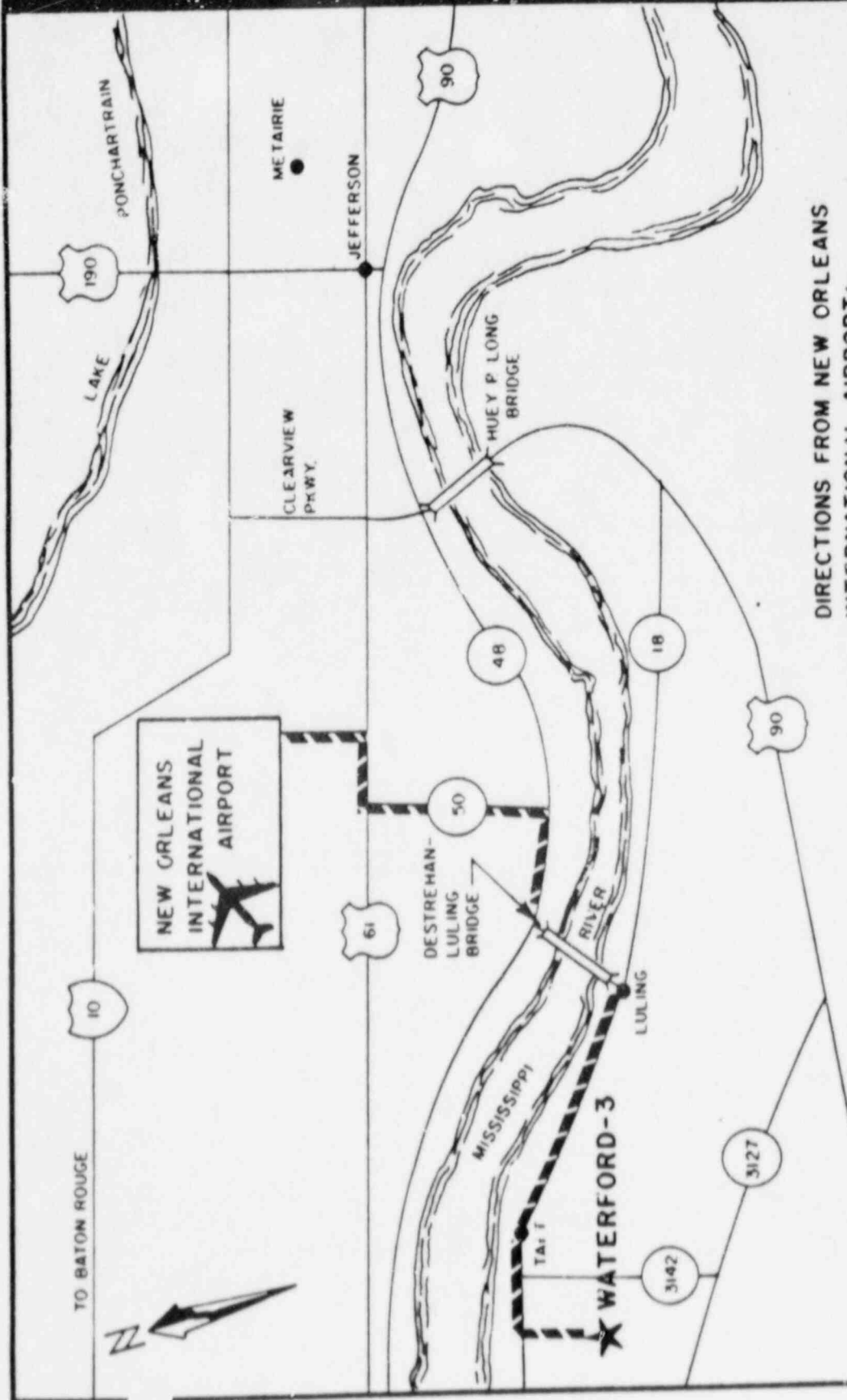

**DIRECTIONS FROM NEW ORLEANS INTERNATIONAL AIRPORT:**

From Airport, turn right onto U.S. Hwy. 61 North, and proceed to LA Hwy. 50 (Almedia Rd.). Turn left (South) and proceed to LA. Hwy. 48. Turn right (West) and proceed to the Destrehan-Luling Bridge. Proceed to cross the bridge, and exit the bridge to LA. Hwy. 18 (River Road). Turn left on LA. Hwy. 18 and proceed West approximately eight (8) miles to the plant entrance.

NOT TO SCALE  
FOLLOW DASHED ROUTE

W3 SES EMERGENCY PLAN

FIGURE 2-3

WATERFORD 3 SES SITE

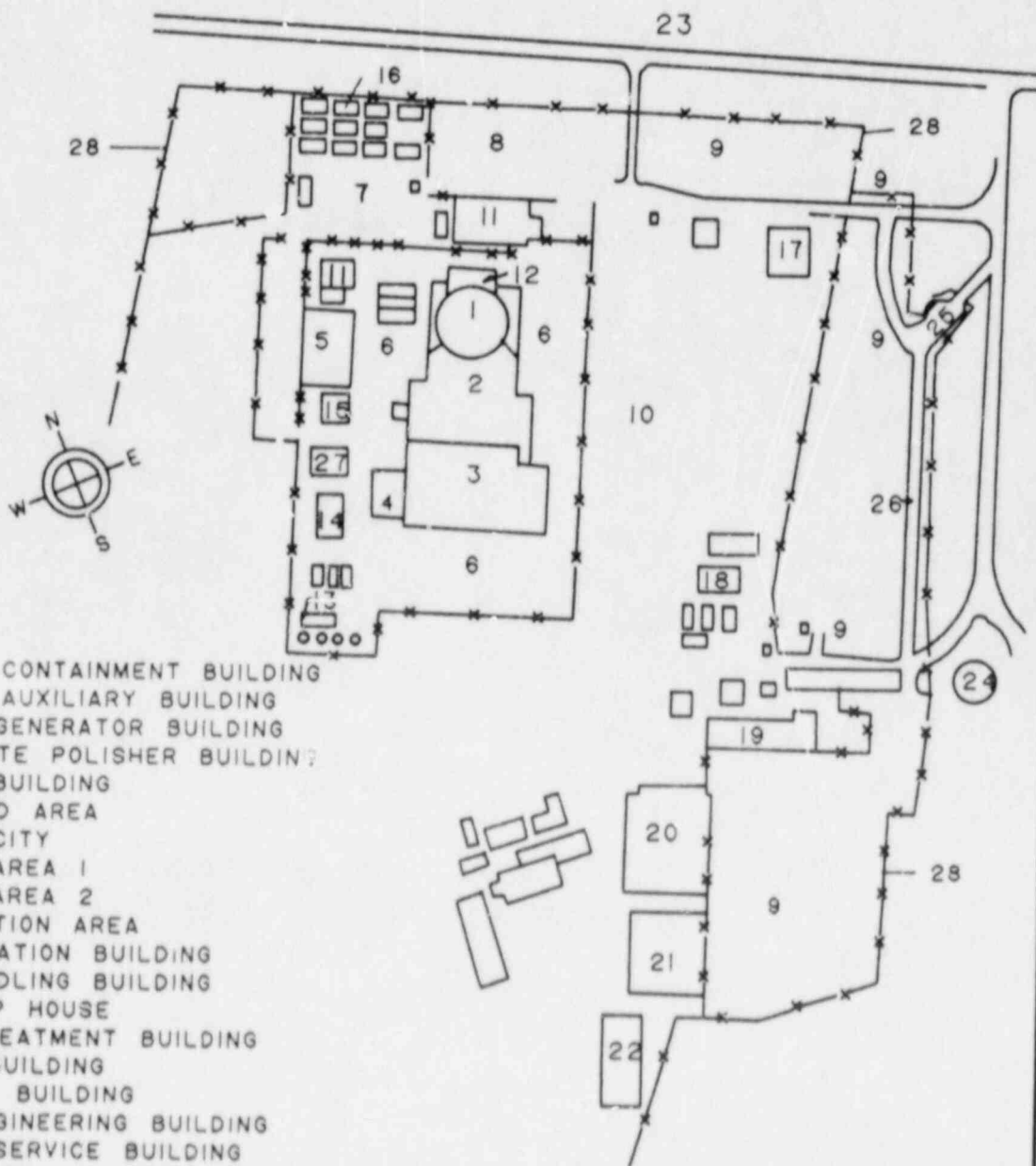

1. REACTOR CONTAINMENT BUILDING
2. REACTOR AUXILIARY BUILDING
3. TURBINE GENERATOR BUILDING
4. CONDENSATE POLISHER BUILDING
5. SERVICE BUILDING
6. PROTECTED AREA
7. TRAILER CITY
8. PARKING AREA 1
9. PARKING AREA 2
10. CONSTRUCTION AREA
11. ADMINISTRATION BUILDING
12. FUEL HANDLING BUILDING
13. FIRE PUMP HOUSE
14. WATER TREATMENT BUILDING
15. CHILLER BUILDING
16. FIRST AID BUILDING
17. PLANT ENGINEERING BUILDING
18. NUCLEAR SERVICE BUILDING
19. SITE SUPPORT BUILDING
20. WAREHOUSE 2B
21. WAREHOUSE 7B
22. SKILLS TRAINING CENTER
23. RIVER ROAD (LA.18)
24. HELICOPTER LANDING PAD
25. SECURITY CHECKPOINT
26. ACCESS ROAD
27. RADIOACTIVE WASTE STORAGE
28. PLANT PERIMETER FENCE