

September 21, 1998

TO: AP600 Docket Files 52-003

FROM: Bill Huffman 

SUBJECT: Redirection of Previously Proprietary Material into the Public

The information provided in Enclosure 1 of this memo was originally submitted with Westinghouse letter NSD-NRC-97-4970 dated February 10, 1997 and was identified as proprietary (See Accession #9702200289). Westinghouse letter NSD-NRC-5756 dated August 14, 1998, (Enclosure 2), states that the information in Enclosure 1 is no longer considered proprietary.

Therefore, I have removed the Westinghouse proprietary markings from Enclosure 1 so that it can be placed into the public files.

Enclosure 1: AP600 Drawings showing how RTNSS Systems are Protected From Floods and Missiles attached to Westinghouse Letter NSD-NRC-97-4970 dated February 10, 1997 (Proprietary markings removed)

Enclosure 2: Westinghouse letter NSD-NRC-5756 dated August 14, 1998

cc w/o enclosures: TRQuay
JSebrosky

9809300181 980921
PDR ADOCK 05200003
A PDR

- * ADDRESS:
- * INITIATING EVENT:
- * VERIFY AVAILABILITY:
- * EXTERNAL MISSILE PROTECTION:
- * PRIMARY FLOOD PROTECTION:
- * INTERNAL MISSILE PROTECTION:
- * SECONDARY FLOOD PROTECTION:
- * EXTERNAL FLOOD PROTECTION:
- * PIPE BREAKS:

POWER OPERATION
MODES 1 & 2

ATRS

PRIOR TO ENTERING MODE 2
VERIFY REQUIRED DAS CHANNELS
ARE AVAILABLE.

STRUCTURAL WALLS PROVIDE EXTERNAL MISSILE
PROTECTION.

FLOOR DRAINING FROM ABOVE BEING (E.L. 111'-4")
TO TORBINE BUILDING DRAIN TANKS.

STRUCTURAL WALLS PROVIDE INTERNAL MISSILE
PROTECTION.

STAIRWELL ELEVATION SHAFT, AND EXIT TO
TORBINE BUILDING.

MAXIMUM FLOOD LEVEL IS BELOW GRADE.
THE DAS IS LOCATED 17'-6" ABOVE GRADE.

NO HIGH ENERGY PIPING IN THIS AREA.

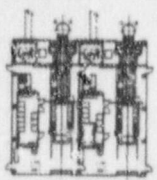
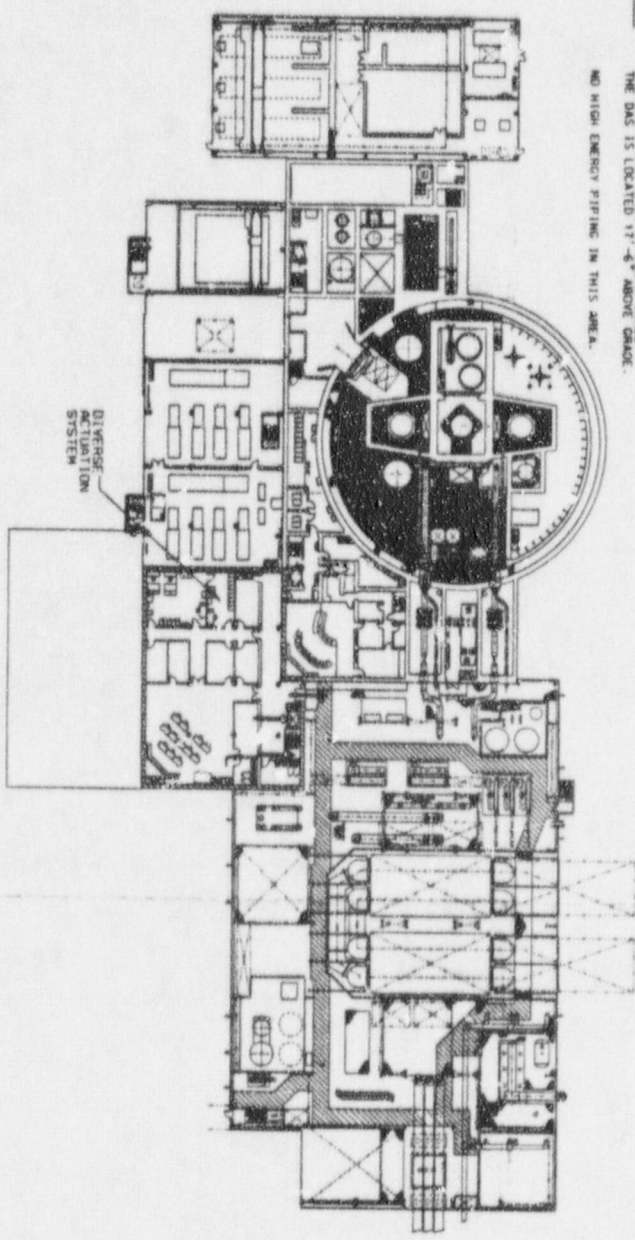

ENCLOSURE 1

Westinghouse Electric Corporation
 DIVISION OF
 WESTINGHOUSE ELECTRIC CORPORATION
 PITTSBURGH, PENNSYLVANIA 15106
 PROJECT NO. 0000-01-101

TITLE: [REDACTED]
 DRAWING NO.: [REDACTED]
 DATE: [REDACTED]

DESIGNED BY: [REDACTED]
 CHECKED BY: [REDACTED]
 APPROVED BY: [REDACTED]

- MODES:
 - INITIATING EVENT:
 - VERIFY AVAILABILITY:
 - EXTERNAL MISSILE PROTECTION:
 - PRIMARY FLOOR PROTECTION:
 - INTERNAL MISSILE PROTECTION:
 - SECONDARY INTERNAL FLOOD PROTECTION:
 - EXTERNAL FLOOD PROTECTION:
 - PIPE BREAKS:
- POWER OPERATIONS
(MODE 1&2)
AIRS
- PRIOR TO ENTERING MODE 2 VERIFY THAT BOTH GROUPS ARE AVAILABLE. STRUCTURAL WALL PROVIDE PROTECTION. FLOOR DRAIN TO ANNEX BUILDING SUMP PUMPS AND FROM ANNEX BUILDING SUMP TO TURBINE BUILDING'S DRAIN TANKS. STRUCTURAL WALL PROVIDE PROTECTION.
- ANNEX BUILDING DRAIN TO GRADE.
- MAXIMUM FLOOD LEVEL IS BELOW GRADE. ALL ANNEX BUILDING ENTRANCES ARE AT OR ABOVE GRADE. NO HIGH ENERGY PIPING IN THIS AREA.

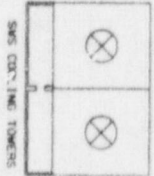
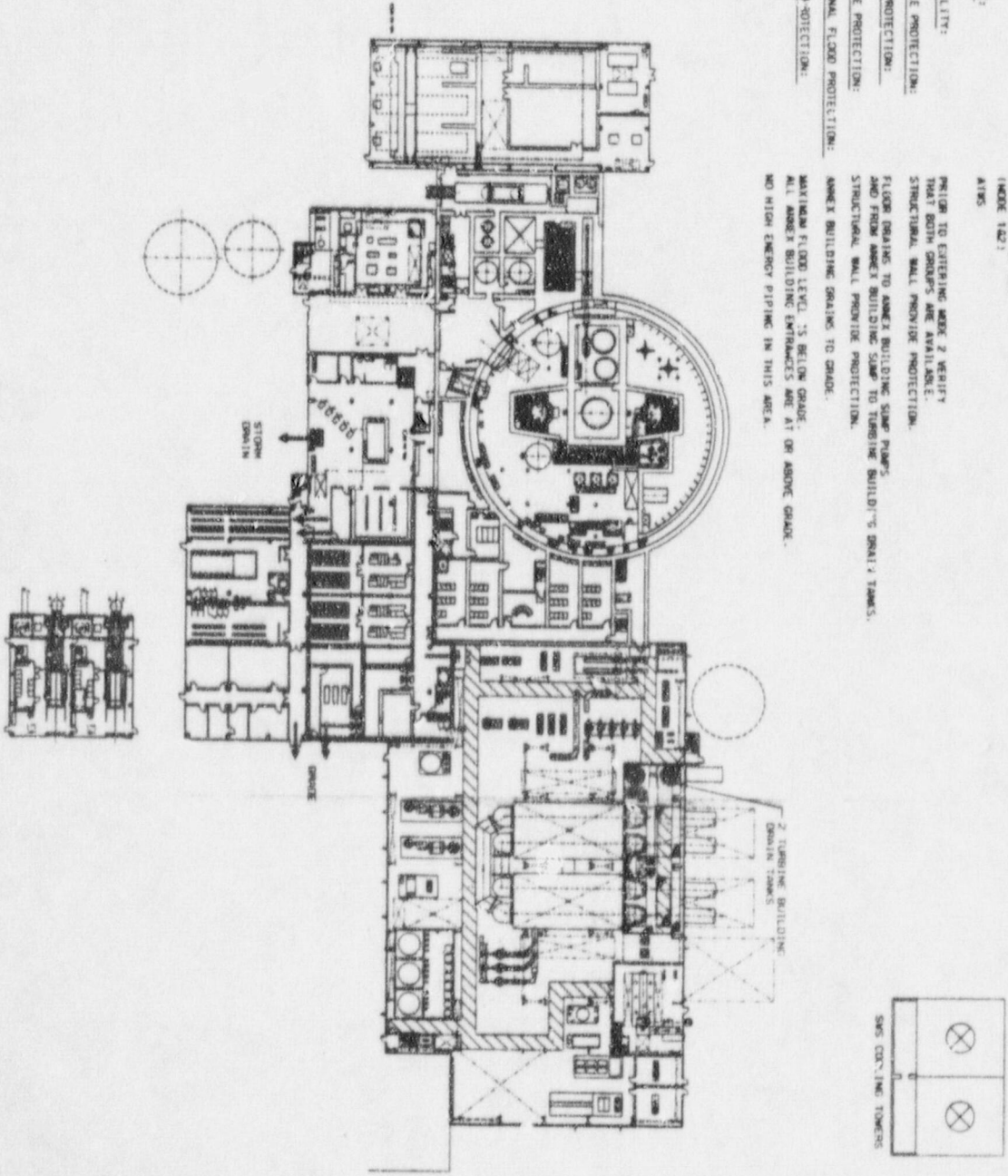

Washington Electric Corporation
 4375 G Street, N.W.
 Washington, D.C. 20007
 (202) 462-1100

DESIGNED BY: [Redacted]
 DRAWN BY: [Redacted]
 CHECKED BY: [Redacted]
 DATE: [Redacted]

PROJECT: [Redacted]
 SHEET: [Redacted]

- MODES:
 - SHUTDOWN (REDUCED RCS INVENTORY OPERATION - MODES 5 & 6)
 - REDUCED INVENTORY, LOSS OF DECAY HEAT REMOVAL.
 - MAINLINE SHIFT PRIOR TO REDUCED RCS INVENTORY OPERATION VERIFY THAT A MINIMUM OF 3 OF 4 POWER SUPPLY FLOW-PATHS ARE AVAILABLE.
- INITIATING EVENT:
 - SHUTDOWN (REDUCED RCS INVENTORY OPERATION - MODES 5 & 6)
 - REDUCED INVENTORY, LOSS OF DECAY HEAT REMOVAL.
 - MAINLINE SHIFT PRIOR TO REDUCED RCS INVENTORY OPERATION VERIFY THAT A MINIMUM OF 3 OF 4 POWER SUPPLY FLOW-PATHS ARE AVAILABLE.
- VERIFY AVAILABILITY:
 - SHUTDOWN (REDUCED RCS INVENTORY OPERATION - MODES 5 & 6)
 - REDUCED INVENTORY, LOSS OF DECAY HEAT REMOVAL.
 - MAINLINE SHIFT PRIOR TO REDUCED RCS INVENTORY OPERATION VERIFY THAT A MINIMUM OF 3 OF 4 POWER SUPPLY FLOW-PATHS ARE AVAILABLE.
- EXTERNAL MISSILE PROTECTION:
 - DISTANCE BETWEEN POWER SUPPLY SOURCES TO ASSURE ONE POWER SUPPLY SOURCE.
 - MAXIMUM FLOOD LEVEL IS BELOW GRADE.
 - ALL POWER SYSTEM EQUIPMENT IS ABOVE GRADE.
- INTERNAL MISSILE PROTECTION:
 - (APPLICABLE TO D/G BUILDING ONLY)
 - INTERNAL STRUCTURAL WALL.
- INTERNAL FLOOD PROTECTION:
 - (APPLICABLE TO D/G BUILDING ONLY)
 - SUMP PUMPS TO TORBIDE BUILDING DRAIN TANKS AND D/G BUILDING EXISTS TO GRADE.
 - NO HIGH ENERGY PIPING.
- PIPE BREAKS:

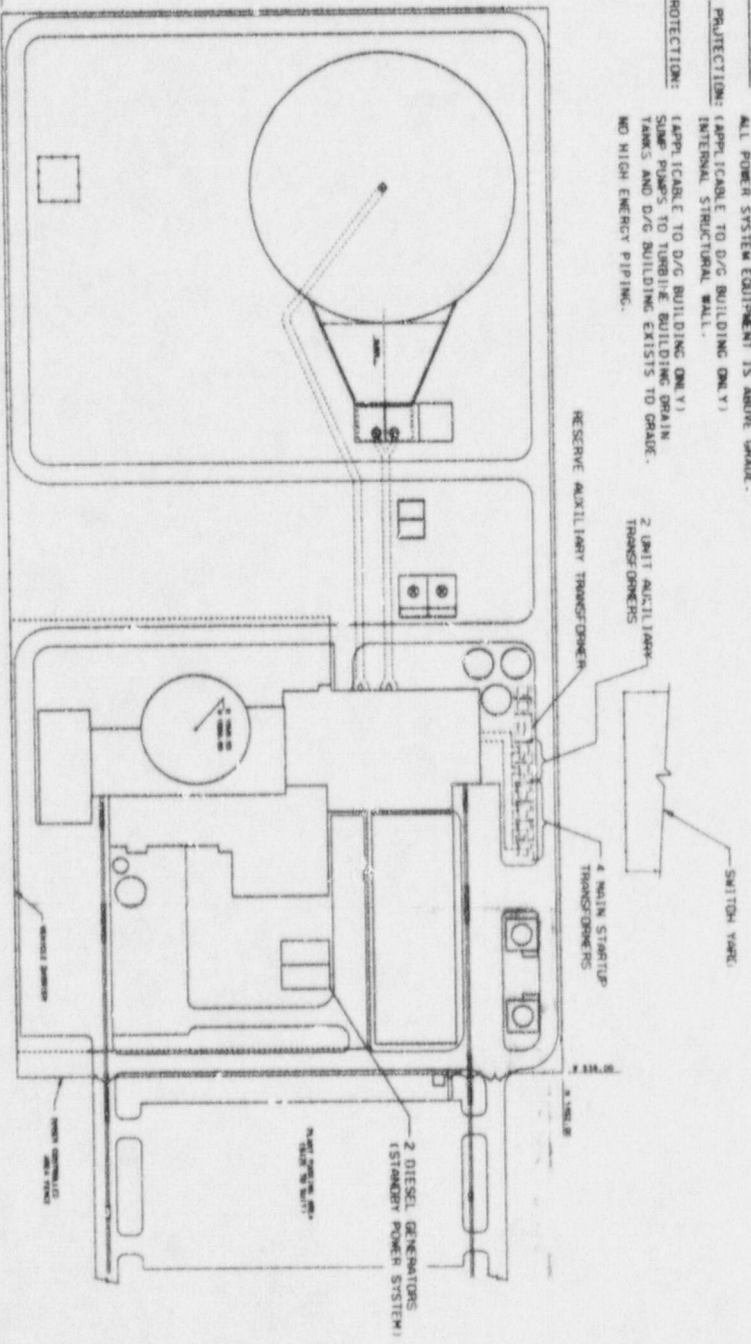

WASHINGTON POWER CORPORATION
 1400 15th Street, N.W.
 WASHINGTON, D.C. 20004-4213
 TEL: (202) 462-1313
 FAX: (202) 462-1314

PROJECT: [REDACTED]
 DRAWING NO.: [REDACTED]
 DATE: [REDACTED]

DESIGNER: [REDACTED]
 CHECKER: [REDACTED]
 APPROVED: [REDACTED]

- MODES:
- INITIATING EVENT:
- VERIFY AVAILABILITY:
- EXTERNAL MISSILE PROTECTION:
- EXTERNAL FLOOD PROTECTION:
- INTERNAL MISSILE PROTECTION:
- INTERNAL FLOOD PROTECTION:
- PIPE BREAKS:

SHUTDOWN PRODUCED RCS INVENTORY OPERATIONS - MODES 5 & 6
 REDUCED INVENTORY - LOSS OF DECAY HEAT REMOVAL.
 WITHIN ONE SHIFT PRIOR TO REDUCED INVENTORY OPERATION VERIFY THAT A MINIMUM OF 3 OF 4 POWER SUPPLY FLOW-PATHS ARE AVAILABLE.
 NONE
 MAXIMUM FLOOD LEVEL IS BELOW GRADE
 ALL POWER SYSTEM EQUIPMENT IS ABOVE GRADE.
 INTERNAL STRUCTURAL WALLS.
 FLOOR DRAINS TO ANGRX BUILDING SUMP.
 NO HIGH ENERGY PIPING IN THIS AREA.

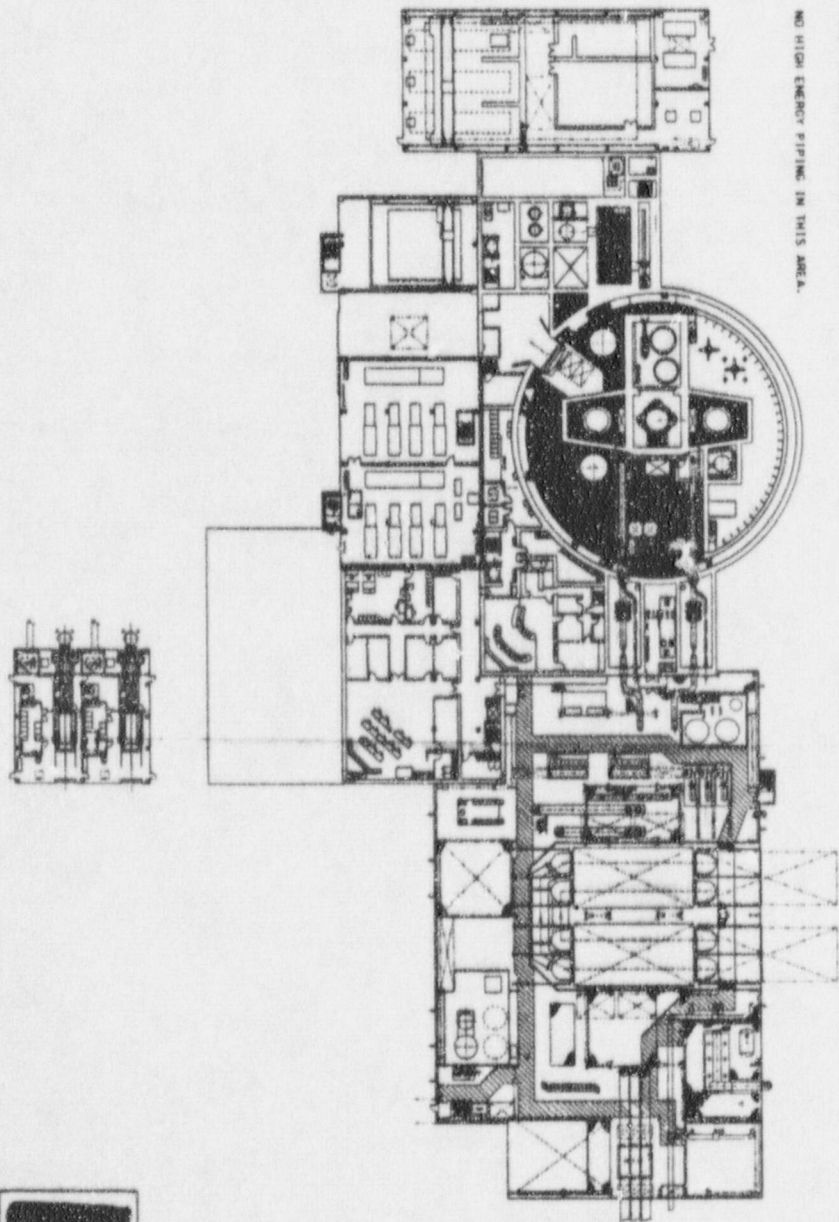

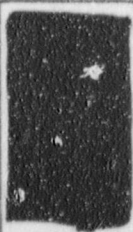

Westinghouse Electric Corporation
 ALP-20702
 ENGINEERING CENTER, ONE WESTINGHOUSE PLAZA
 PITTSBURGH, PENNSYLVANIA 15222
 SERIAL TITLE: RELAYED
 AT NUMBER: 11555
 DRAWING NUMBER: 0000-QA-104
 DATE: 11/81

- MODES:
SHUTDOWN (NODES 5/6)
REDUCED RCS INVENTORY OPERATION
REDUCED RCS/INVENTORY, LOSS OF DECAY
HEAT REMOVAL.
- INITIATING EVENT:
WITHIN ONE DAY PRIOR TO
ENTERING REDUCED RCS INVENTORY
OPERATION, VERIFY THAT BOTH NORMAL
RESIDUAL HEAT REMOVAL SYSTEMS ARE
OPERATIONAL.
- VERIFY AVAILABILITY:
AUXILIARY BUILDING STRUCTURAL WALLS.
- EXTERNAL MISSILE PROTECTION:
AUXILIARY BUILDING STRUCTURAL WALLS.
- EXTERNAL FLOOD PROTECTION:
AUXILIARY BUILDING STRUCTURAL WALLS.
MAXIMUM FLOOD LEVEL IS BELOW GRADE.
ALL AUXILIARY BUILDING ENTRANCES ARE
AT OR ABOVE GRADE.
- INTERNAL MISSILE PROTECTION:
INTERNAL STRUCTURAL WALLS.
- INTERNAL FLOOD PROTECTION:
RNS PUMP MOTORS ARE LOCATED 5'-0"
ABOVE COMPARTMENT FLOOR. FLOOR
DRAINS TO SLUMP PUMPS TO WASTE
HOLDUP TANKS.
- PIPE BREAKS:
NO HIGH ENERGY PIPING IN RNS COMPARTMENTS.

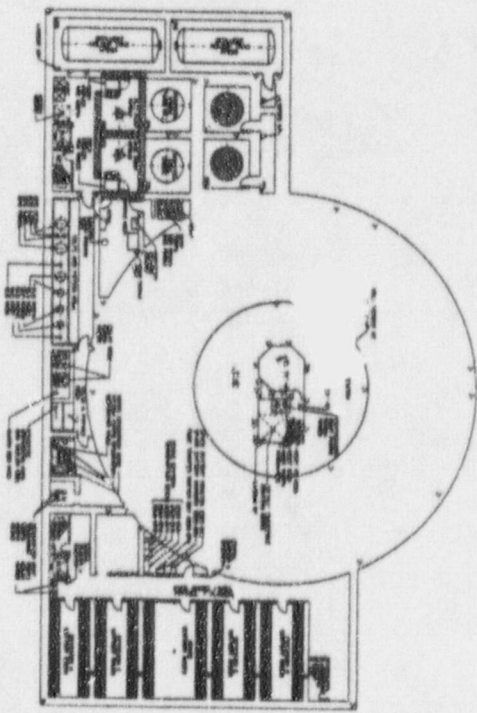

1	2	3	4	5	6	7	8	9	10
11	12	13	14	15	16	17	18	19	20

21	22	23	24	25	26	27	28	29	30
31	32	33	34	35	36	37	38	39	40

W. A. R. COMPANY
 2000 W. 10th Street
 Oklahoma City, Oklahoma 73106
 (405) 521-1100
 FAX (405) 521-1101
 WWW: WWW.WARCOMP.COM

- **NOTES:**
- **INITIATING EVENT:**
SHUTDOWN REDUCED RCS INVENTORY OPERATION (MODE S/G) REDUCED RCS INVENTORY, LOSS OF DECAY HEAT BEYOND, WITHIN ONE DAY PRIOR TO ENTERING REDUCED RCS INVENTORY OPERATION HEAT EXCHANGER COOLING WATER SUBSYSTEMS AND BOTH SERVICE WATER SUBSYSTEMS ARE OPERATIONAL.
- **VERIFY AVAILABILITY:**
- **EXTERNAL MISSILE PROTECTION:**
NONE.
- **PRIMARY FLOOD PROTECTION:**
FLOOD DRAINS TO TURBINE BUILDING DRAIN TANKS, CCS/SWS PUMP MOTORS ARE ELEVATED.
- **INTERNAL MISSILE PROTECTION:**
TURBINE/GENERATOR EQUIPMENT NOT OPERATING.
- **BACKUP FLOOD PROTECTION:**
TURBINE BUILDING DRAINS TO GRADE.
- **PIPE BREACHS:**
HIGH ENERGY SYSTEMS NOT OPERATING.

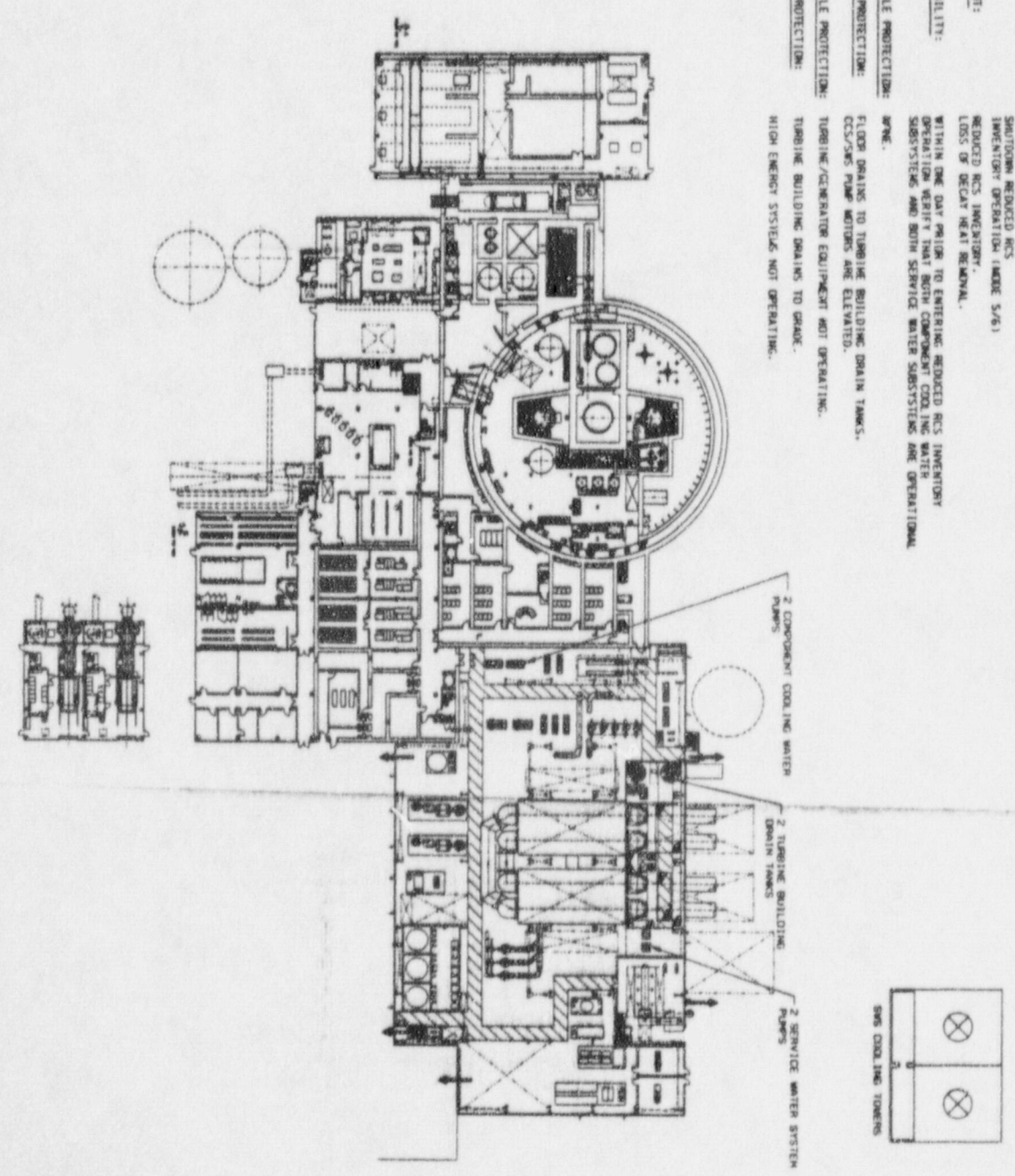

Weldingham Blaine Corporation
 4125 S. 212
 10000 10th Ave. S.E.
 Bellevue, WA 98006
 (206) 461-1111
 FAX (206) 461-1112

Project: _____
Client: _____
Contract No.: _____
Revision: _____

Scale: _____
Date: _____

Drawn by: _____
Checked by: _____
Approved by: _____



Westinghouse
Electric Corporation

Energy Systems

Box 355
Pittsburgh Pennsylvania 15230-0355

DCP/NRC1412
NSD-NRC-98-5756
Docket No.: 52-003

August 14, 1998

Document Control Desk
U. S. Nuclear Regulatory Commission
Washington, DC 20555

ATTENTION: T. R. Quay

SUBJECT: RESPONSE TO NRC LETTERS CONCERNING REQUEST FOR WITHHOLDING
INFORMATION

- Reference:
1. Letter, Sebrosky to McIntyre, "Request for withholding proprietary information for Westinghouse AP600 letters dated October 10, 1994, March 30, 1995, October 3, 1996, and December 18, 1997," dated July 21, 1998.
 2. Letter, Huffman to McIntyre, "Request for withholding information from public disclosure for Westinghouse AP600 design letters," dated July 14, 1998.

Dear Mr. Quay:

Reference 1 provided the NRC comments that the Westinghouse letter of October 10, 1994, appeared to contain proprietary information that was not clearly identified other than being marked "Westinghouse Proprietary Class 2" on the page and also that there was no affidavit included with the letter. The October 10, 1994, letter contained errata for WCAP-14135, which is a proprietary report. In accordance with Westinghouse company policy, each page of a proprietary report has "Westinghouse Proprietary Class 2" on the page header. Specific information that is proprietary is then indicated with brackets. It is possible that there will be no information on a page that is marked as being proprietary. In the case of the October 10, 1994, letter, none of the errata pages contained Westinghouse proprietary information, thus no affidavit was necessary and the letter can be placed in the NRC public document room.

Reference 1 also provided the NRC comments that the Westinghouse letter of March 30, 1995, appeared to contain proprietary information that was not clearly identified other than being marked "Westinghouse Proprietary Class 2" and also that there was no affidavit included with the letter. The March 30, 1995, letter contained AP600 main steam line isometric drawings which have the standard Westinghouse title block that contains a standard Westinghouse proprietary statement which should have been deleted in this case. The deadweight analysis results had no proprietary markings. These drawings are nonproprietary, thus no affidavit was necessary and the letter can be placed in the NRC public document room.

9808200164
BPH

ENCLOSURE 2

August 14, 1998

Reference 1 further provided the NRC comments that the Westinghouse letter of October 3, 1996, appeared to contain proprietary information that was not clearly identified other than being marked "Westinghouse Proprietary Class 2" on the page and also that there was no affidavit included with the letter. The October 3, 1996, letter contained pages that were missing from some copies of WCAP-14407, which is a proprietary report. In accordance with Westinghouse company policy, each page of a proprietary report has "Westinghouse Proprietary Class 2" on the page header. Specific information that is proprietary is then indicated with brackets. It is possible that there will be no information on a page that is marked as being proprietary. In the case of the October 3, 1996, letter, none of the missing pages contained Westinghouse proprietary information, thus no affidavit was necessary and the letter can be placed in the NRC public document room.

Reference 1 additionally provided the NRC comments that the Westinghouse letter of December 18, 1997, appeared to contain proprietary information that was not clearly identified other than being marked "Westinghouse Proprietary Class 2" on the page and also that there was no affidavit included with the letter. The December 18, 1997, letter documented NRC agreed to revisions to WCAP-14326, Revision 1, WCAP-14812, Revision 1, and WCAP-14845, Revision 2, which are Westinghouse proprietary reports. In accordance with Westinghouse company policy, each page of a proprietary report has "Westinghouse Proprietary Class 2" on the page header. Specific information that is proprietary is then indicated with brackets. It is possible that there will be no information on a page that is marked as being proprietary. In the case of the December 18, 1997, letter, none of the errata pages contained Westinghouse proprietary information, thus no affidavit was necessary and the letter can be placed in the NRC public document room.

Reference 2 provided the NRC comments that the Westinghouse letter of February 10, 1997, appeared to contain proprietary information that was not clearly identified other than being marked "Westinghouse Proprietary Class 2" and also that there was no affidavit included with the letter. The February 10, 1997, letter contained drawings which were intended to assist the staff in their understanding of the Regulatory Treatment of Nonsafety Related Systems (RTNSS) implementation for the AP600 and contained the standard Westinghouse drawing title block that includes a standard Westinghouse proprietary statement which should have been deleted in this case. These drawings are nonproprietary, thus no affidavit was necessary and the letter can be placed in the NRC public document room.

Reference 2 also provided the NRC comments that the Westinghouse letter of August 18, 1997, appeared to contain proprietary information that was not clearly identified other than being marked "Westinghouse Proprietary Class 2" on the page and also that there was no affidavit included with the letter. The August 18, 1997, letter was issued to correct a printing error in several copies of proprietary report WCAP-14727, Revision 1, that were provided to the staff in advance of the normal mailing to the NRC. WCAP-14727, Revision 1, was provided to the staff by letter DCP/NRC0979, dated August 7, 1997, which included affidavit AW-97-1150. In accordance with Westinghouse company policy, each page of a proprietary report has "Westinghouse Proprietary Class 2" on the page header. Specific information that is proprietary is then indicated with brackets. It is possible that there will be no information on a page that is marked as being proprietary. In the case of the August 18, 1997, letter, any of the pages which contained proprietary information, would have had that material bracketed and should be covered by affidavit AW-97-1150, which was dated August 11, 1997.

August 14, 1998

Revision 2 further provided the NRC comments that the Westinghouse letter of November 11, 1997, appeared to contain proprietary information that was not clearly identified other than being marked "Westinghouse Proprietary Class 2" on the page and also that there was no affidavit included with the letter. The November 11, 1997, letter contained Revision 3 to WCAP-14776, which is a Westinghouse proprietary report. In accordance with Westinghouse company policy, each page of a proprietary report has "Westinghouse Proprietary Class 2" on the page header. Specific information that is proprietary is then indicated with brackets. It is possible that there will be no information on a page that is marked as being proprietary. In the case of the November 11, 1997, letter it was indicated that "although the change pages contain no bracketed proprietary information, they are marked 'Westinghouse Proprietary'." Since none of the revision pages contained Westinghouse proprietary information, no affidavit was necessary and the letter can be placed in the NRC public document room.

Revision 2 further provided the NRC comments that the Westinghouse letter of March 13, 1998, appeared to contain proprietary information that was not clearly identified other than being marked "Westinghouse Proprietary Class 2" on the page and also that there was no affidavit included with the letter. The March 13, 1998, letter contained errata for WCAP-14807, which is a proprietary report. In accordance with Westinghouse company policy, each page of a proprietary report has "Westinghouse Proprietary Class 2" on the page header. Specific information that is proprietary is then indicated with brackets. It is possible that there will be no information on a page that is marked as being proprietary. In the case of the March 13, 1998, letter, none of the errata pages contained Westinghouse proprietary information, thus no affidavit was necessary and the letter can be placed in the NRC public document room.

A large number of proprietary evaluations covering the time period February 14, 1992 to May 5, 1998, have been received over the past several months, the most recent on July 22, 1998. These evaluations are being processed. As a result of discussions with NRC management, Westinghouse will provide proper proprietary documentation for the proprietary material supporting the AP600 design certification review by August 21, 1998. The responses will be provided as they are developed. It is our understanding that providing the nonproprietary versions of documents will not constrain issuing the AP600 FSER or FDA.

This response addresses the proprietary issues delineated in the references.

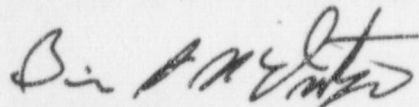

Brian A. McIntyre, Manager
Advanced Plant Safety and Licensing

jml

cc: J. W. Roe - NRC/NRR/DRPM
J. M. Sebrosky - NRC/NRR/DRPM
W. C. Huffman - NRC/NRR/DRPM
H. A. Sepp - Westinghouse