



CENTRAL MEDICAL CENTER & HOSPITAL

1200 Centre Avenue, Pittsburgh, PA 15219

(412) 562-3000

June 4, 1985

John Glenn, Ph.D., Chief  
Nuclear Materials Section B  
Division of Engineering & Technical Programs  
US Nuclear Regulatory Commission, Region I  
631 Park Avenue  
King of Prussia, PA 19406

Dear Doctor Glenn:

We are requesting amendment of our NRC License #37-16245-01 to permit the following changes in our Nuclear Medicine Program:

1. Relocation of the Nuclear Cardiographic Imaging Area from Room 202 of this address to Room 135 of this address. The floor plan of the specific layout is attached.
2. Use of a commercially available filter system such as "Lineator" or "Calichek" for performance of linearity testing of our radio-isotope calibrators.

The proposed site for the relocation of Nuclear Cardiology will be surveyed by our consultant radiation physicist prior to occupation.

The amendment fee in the amount of \$120.00 is enclosed.

Please do not hesitate to contact us if you should need any further information.

*June-13-1*

Sincerely yours,

*P. J. Dolan*

P. J. Dolan  
Sr. Vice President  
Patient Care

Applicant	.....
Check No.	18705
Amount, Fee Category	#120 70
Type of Fee	Amendment
Date Check Rec'd	6/17/85
Received By	Jacques

PJD/mkk  
Enc.

8507290291 850627  
REG1 LIC30  
37-16245-01 PDR

RECEIVED-REGION 1  
JUN 7 1985  
"OFFICIAL RECORD COPY"  
ML10 03927

JUN 07 1985

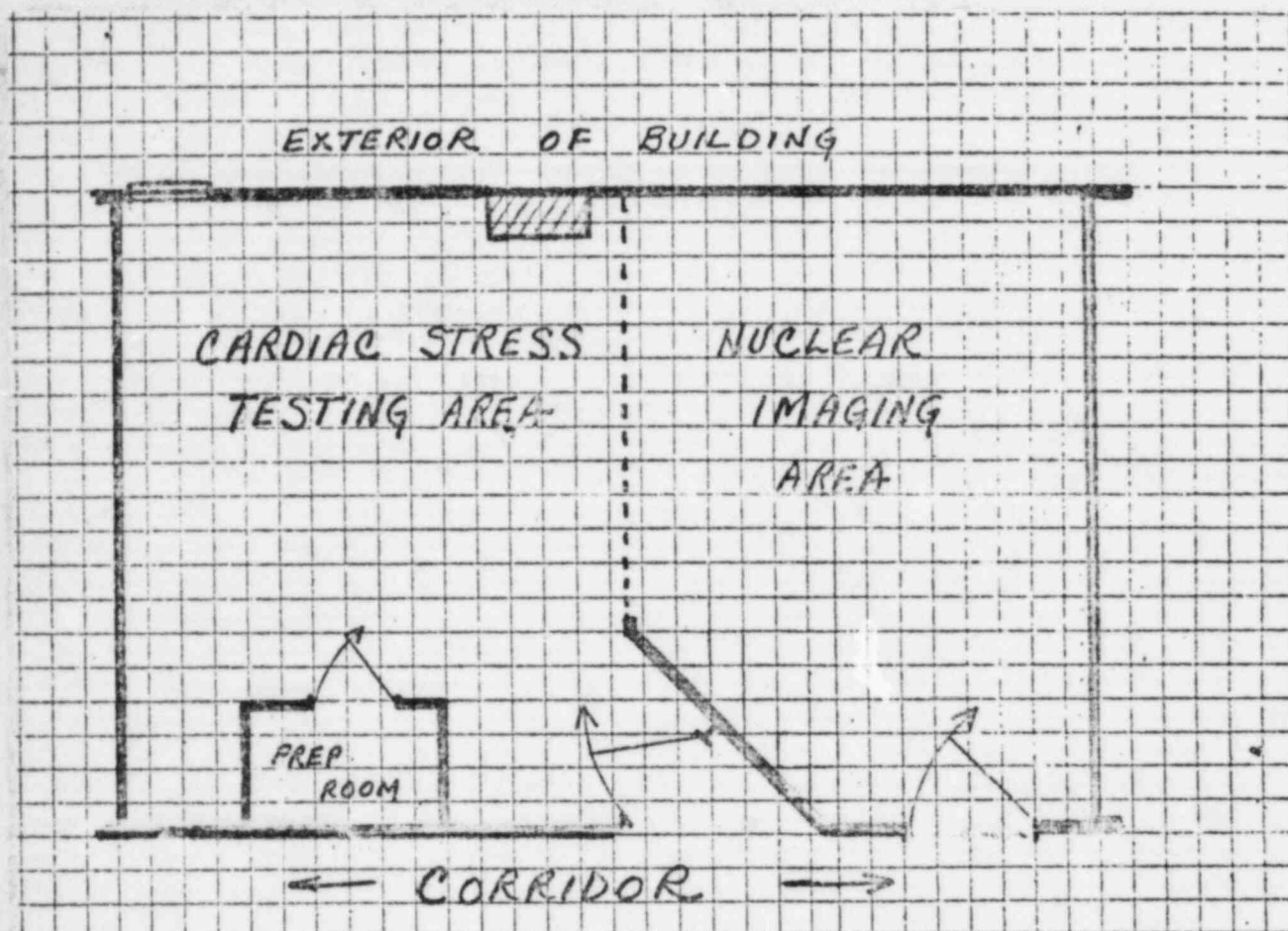

PREP ROOM is a restricted access area outfitted with the following:

- Radioisotope calibrator
- Lead and leaded glass "L" block shield
- Non-porous counter surface
- Security key locking door
- G-M survey meter
- Syringe shields
- 'Caution Radioactive Materials' sign on Nuclear Imaging Area door and Prep Room door

SCALE = 1 BLOCK = 1 FOOT

BETWEEN: William O. Miller, Chief  
License Fee Management Branch  
Office of Administration -

John E. Glenn, Chief  
Nuclear Materials Section B  
Division of Engineering and  
Technical Programs

LICENSE FEE TRANSMITTAL

A. REGION I

1. APPLICATION ATTACHED

Applicant/Licensee: Central Medical Center + Hospital

Application Dated: 6/4/85

Control No.: 03927

License No.: 37-16245-01

2. FEE ATTACHED

Amount: \$ 120.00

Check No.: 18705

3. COMMENTS

Signed Bronck P. Latchek

Date 6/10/85

02/20

B. LICENSE FEE MANAGEMENT BRANCH

1. Fee Category and Amount: 7C \$ 120 1190

2. Correct Fee Paid. Application may be processed for:

Amendment ✓

Renewal \_\_\_\_\_

License \_\_\_\_\_

Signed G Jackson

Date 6/20/85

"SECTION COPY"

№ 18705

CENTRAL MEDICAL HEALTH SERVICES, INC.

1400 CENTRE AVENUE  
PITTSBURGH, PA 15219

June 5 19 85

8-113  
430

Equibank  
Pittsburgh, Pa.

PAY \*\*\*One Hundred Twenty and 00/xx-----\$ \*\*120.00\*\*  
TO THE ORDER OF

Nuclear Regulatory Commission

CENTRAL MEDICAL HEALTH SERVICES, INC.

*James M. Sully*

*Theodore F. Dzura*

⑈018705⑈ ⑆043001134⑆

0481238923⑈

DETACH AND RETAIN THIS STATEMENT

THE ATTACHED CHECK IS IN PAYMENT OF ITEMS DESCRIBED BELOW

IF NOT CORRECT PLEASE NOTIFY US PROMPTLY. NO RECEIPT DESIRED

Amendment Fee License 37-16245-01

RECEIVED  
JUN 7 1985  
105 JUN -7 PM 3:16

CENTRAL MEDICAL HEALTH SERVICES, INC.  
PITTSBURGH, PA 15219