



VETERANS ADMINISTRATION  
HOSPITAL  
150 MUIR ROAD  
MARTINEZ, CALIFORNIA 94553

4484  
m1

December 20, 1978

IN REPLY  
REFER TO: 612/115

Radioisotopes Licensing Branch  
Division of Fuel Cycle and Material Safety  
Office of Nuclear Material Safety and Safeguards  
U. S. Nuclear Regulatory Commission  
Washington, D. C. 20555

Attn: Leo Wade, Jr., Ph.D.

Gentlemen:

Re: Control No. 93686  
License No. 04-02956-02  
Yr Ltr of 10/30/78

In response to your letter of October 30, 1978, enclosed please find additional information in support of our application for renewal of the above byproduct material license:

1. Survey Instrument Calibration

- (i) Antan Model 5, Serial #4-5483
- (iv) Victoreen Model 6B, Serial #119945
- (iii) Searle Model 9113, Serial #431

The above instruments were calibrated by Southwest Nuclear Co., Pleasanton, California on November 22, 1978. Certificates of calibration (78-1A, 1B and 1C) are enclosed herewith.

2. Description of Facilities: Enclosed please find diagrams and data-sheet detailing our facilities, as requested.

- Page D1: Floor plan of Nuclear Medicine facility (areas used for isotope preparation and storage).
- Page D2: Floor plan showing location (and flow rates) of exhaust hoods; ceiling diffusion; ceiling exhaust.
- Page D3: Total of above in D2

3. We are able to confirm that areas used for preparation of patient doses are being and will be surveyed regularly for contamination after each preparation - procedure and at the beginning and end of the day.

COPIES SENT TO OFF. OF  
INSPECTION AND ENFORCEMENT

8408160326 840803  
NMS LIC30  
04-02956-02 PDR

"To care for him who shall have borne the battle, and for his widow, and his orphan."—ABRAHAM LINCOLN

4. We are able to confirm that our personnel are and will continue monitoring of hands and clothing regularly, for contamination, before leaving restricted areas.

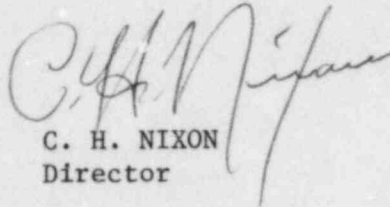
  
C. H. NIXON  
Director

Encls: Pages 78-1A  
78-1B  
78-1C  
D1  
D2  
D3

Copy to:  
Dr. James Smith  
Director  
Nuclear Medicine Service  
Veterans Administration  
Washington, D. C. 20420



SOUTH WEST NUCLEAR COMPANY

4484

7066-A COMMERCE CIRCLE • PLEASANTON, CA 94566  
(415) 462-3750

CERTIFICATE OF CALIBRATION  
OF A  
RADIATION SURVEY METER

To: VETERANS ADMINISTRATION HOSPITAL  
150 Muir Rd.  
Martinez, CA 94553

Report Number 78-1A

INSTRUMENT: Make ANTON Model 5 Serial Number #4-540

Exposure (mR/hr)	Meter Reading (mR/hr)	Scale
.15	.15	X1
.35	.35	X1
1	1	X10
2	2	X10
4	4	X10
10	10	X100
20	20	X100
35	35	X100

Notes: Replaced 1 Battery

This calibration performed under California Radioactive Materials License Number 2873-59. Full records are preserved of each instrument calibrated. Calibration made against  $^{170}\text{Tm}$  \_\_\_\_\_,  $^{226}\text{Ra}$  \_\_\_\_\_,  $^{137}\text{Cs}$  X,  $^{60}\text{Co}$  \_\_\_\_\_,  $^{90}\text{Sr}/^{90}\text{Y}$  \_\_\_\_\_, Alpha (specify) \_\_\_\_\_, Neutron (specify) \_\_\_\_\_.

Due For Calibration Next On 2/22/79

Calibrated By

*William H. Gornell*

Date 11/22/78

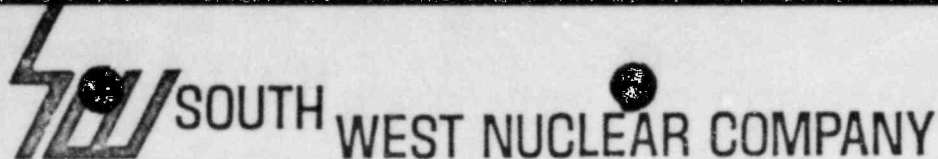

SOUTH WEST NUCLEAR COMPANY  
7066-A COMMERCE CIRCLE • PLEASANTON, CA 94566  
(415) 462-3750

CERTIFICATE OF CALIBRATION  
OF A  
RADIATION SURVEY METER

To: VETERANS ADMINISTRATION HOSPITAL  
150 Muir Rd.  
Martinez, CA 94553

Report Number 78-1B

INSTRUMENT: Make VICTOREEN Model 6B Serial Number #112247

Exposure (mR/hr)	Meter Reading (mR/hr)	Scale
.15	.15	X1
.35	.35	X1
1	1	X10
2	2	X10
4	4	X10
10	10	X100
20	20	X100
35	35	X100

Notes: Replaced two Batteries

This calibration performed under California Radioactive Materials License Number 2873-59. Full records are preserved of each instrument calibrated. Calibration made against  $^{170}\text{Tm}$  \_\_\_\_\_,  $^{226}\text{Ra}$  \_\_\_\_\_,  $^{137}\text{Cs}$  X,  $^{60}\text{Co}$  \_\_\_\_\_,  $^{90}\text{Sr}/^{90}\text{Y}$  \_\_\_\_\_, Alpha (specify) \_\_\_\_\_, Neutron (specify) \_\_\_\_\_.

Due For Calibration Next On 2/22/79

Calibrated By William H. Connelley

Date 11/22/78



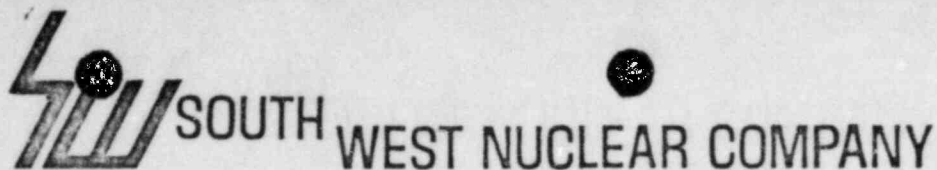

7066-A COMMERCE CIRCLE • PLEASANTON, CA 94566  
(415) 462-3750

CERTIFICATE OF CALIBRATION  
OF A  
RADIATION SURVEY METER

To: VETERANS ADMINISTRATION HOSPITAL  
150 Muir Rd.  
Martinez, CA 94553

Report Number 78-1C

INSTRUMENT: Make SEAPLE Model 9113 Serial Number #431

Exposure (mR/hr)	Meter Reading (mR/hr)	Scale
.15	.15	X1
1	1	X1
5	5	X1
10	10	X1
20	20	X1
50	50	X1
100	100	X1

Notes:

This calibration performed under California Radioactive Materials License Number 2873-59. Full records are preserved of each instrument calibrated. Calibration made against  $^{170}\text{Tm}$  \_\_\_\_\_,  $^{226}\text{Ra}$  \_\_\_\_\_,  $^{137}\text{Cs}$  X,  $^{60}\text{Co}$  \_\_\_\_\_,  $^{90}\text{Sr}/^{90}\text{Y}$  \_\_\_\_\_, Alpha (specify) \_\_\_\_\_, Neutron (specify) \_\_\_\_\_.

Due For Calibration Next On 2/22/79

Calibrated By William H. Connelley

Date 11/22/78

Building Exterior

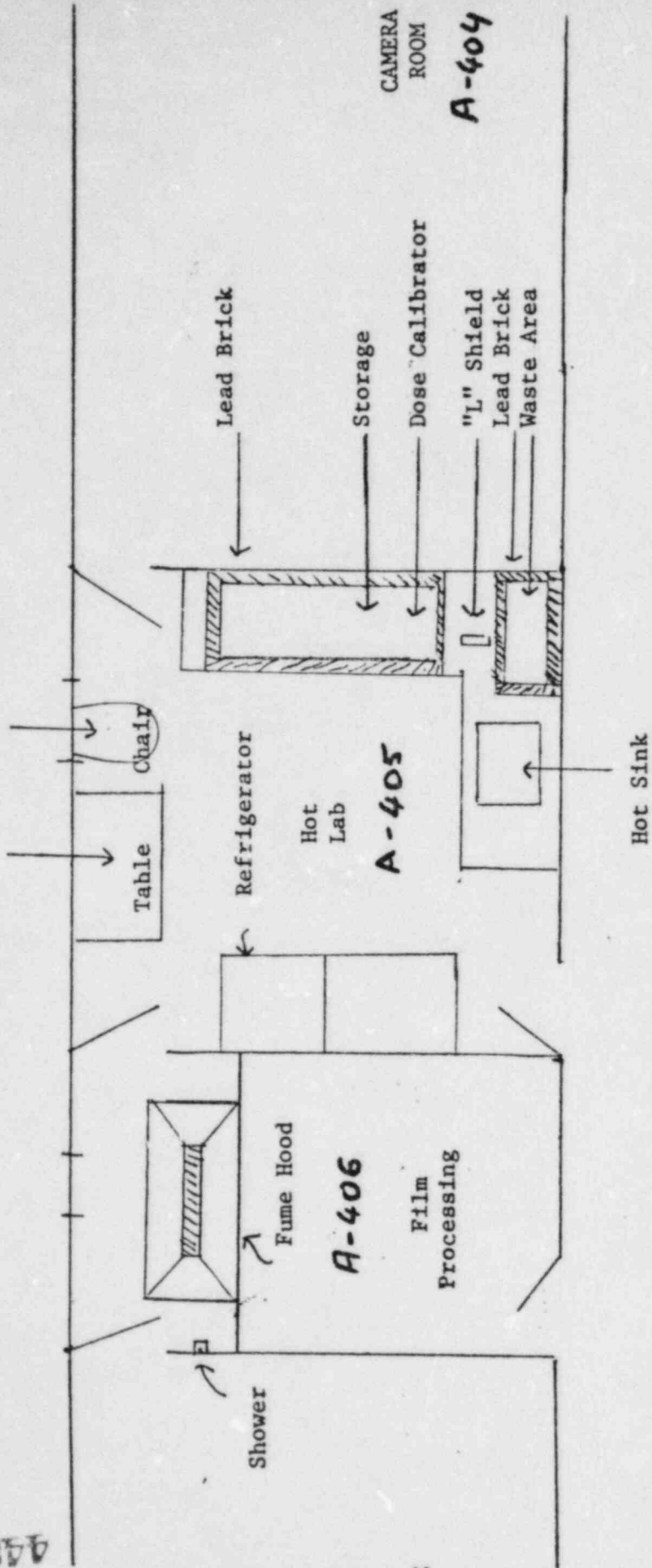

HALLWAY

SCALE 1mm = 2 ft.

OFFICE

-D2

EXHAUST HOOD  
CD - CEILING DIFFUSER  
IU - INDUCTION UNIT  
CE - CEILING EXHAUST  
Z - LESS THAN

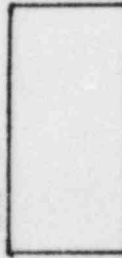
	<div data-bbox="354 1388 406 1517">IU#5</div> <div data-bbox="683 1302 736 1431">(A-406)</div>	<div data-bbox="354 1108 406 1215">IU#3</div> <div data-bbox="493 1086 614 1215">CD-3</div> <div data-bbox="354 892 406 1021">IU#4</div> <div data-bbox="493 892 614 1021">CD-4</div> <div data-bbox="683 784 736 914">(A-405)</div>	<div data-bbox="354 590 406 720">IU#1</div> <div data-bbox="493 526 614 655">CD-1</div> <div data-bbox="354 332 406 461">IU#2</div> <div data-bbox="493 332 614 461">CD-2</div> <div data-bbox="683 137 736 332">(A-404)</div>
---	--	--	--

EH#1 < 100 FPM

IU#5 296 FPM

IU#3 350 FPM

IU#1 200 FPM

IU#4 300 FPM

IU#2 400 FPM

IU#2 400 FPM

CD-3 450 FPM

CD-1 700 FPM

CD-1 700 FPM

CD-4 475 FPM

CD-2 650 FPM

CD-2 650 FPM

# SUPPLY TOTALS:

A-404

CEILING DIFFUSERS

1350 FPM

INDUCTION UNITS

700 FPM

TOTAL

→

2050

A-405

CEILING DIFFUSERS

925 FPM

INDUCTION UNITS

650 FPM

TOTAL

→

1575

A-406

INDUCTION UNIT

290 FPM

TOTAL

→

290

TOTAL SUPPLY (ALL RMS.)

→

3915 FPM

TOTAL EXHAUST

LESS THAN 100 FPM