



**LOUISIANA
POWER & LIGHT**

142 DELAHONDE STREET
P. O. BOX 6008 • NEW ORLEANS, LOUISIANA 70174 • (504) 366-2345

August 2, 1984

W3F84-0126

3-A45

3-A1.01.04

Mr. D.G. Eisenhut
Division of Licensing
Office of Nuclear Reactor Regulation
U.S. Nuclear Regulatory Commission
Washington, D.C. 20555

SUBJECT: Waterford 3 SES
Docket No. 50-382
Backup Emergency Operations Facility

Dear Mr. Eisenhut:

During the month of October, LP&L is proposing to move the Waterford 3 Backup Emergency Operations Facility (EOF) from the present location in Gretna to 317 Baronne Street in New Orleans. (The same location as the LP&L Emergency News Center.) The EOF Operations Room, Dose Projection Room, and Communications Room will be located on the fifth floor as shown on the attached sketch. Office space for the EOF Engineering Staff will be on the fourth and sixth floors.

The communications and dose projection capability for the new facility will be the same as is presently provided at the Gretna location.

The new location is approximately twenty-two (22) air miles from the Waterford 3 site as compared to approximately twenty-three (23) air miles from the site to the Gretna location. The driving distance from the site to 317 Baronne Street is approximately thirty-eight (38) miles as opposed to the thirty-three (33) miles from the site to the Gretna location. Due to the use of Highway I-10 and the new Destrehan-Luling Bridge, however, the travel time to the New Orleans location from the site is comparable to or less than to the Gretna office.

This information is being provided for your review. If you have any questions, please advise.

Very truly yours,

K. W. Cook
Nuclear Support & Licensing Manager

KWC/ASL/ch
Attachment

8408070109 840802
PDR ADOCK 05000382
F PDR

Adol
/

Mr. D.G. Eisenhut
W3F84-0126
Page 2

cc: W.M. Stevenson, E.L. Blake, B. Churchill, L. Constable, W.A. Cross,
G. Groesch, R.S. Leddick, F.J. Drummond, R.A. Savoie, Project Files,
Licensing Library, EP File, Administrative Support (3)

L O U I S I A N A

35

36

C O R R I D O R

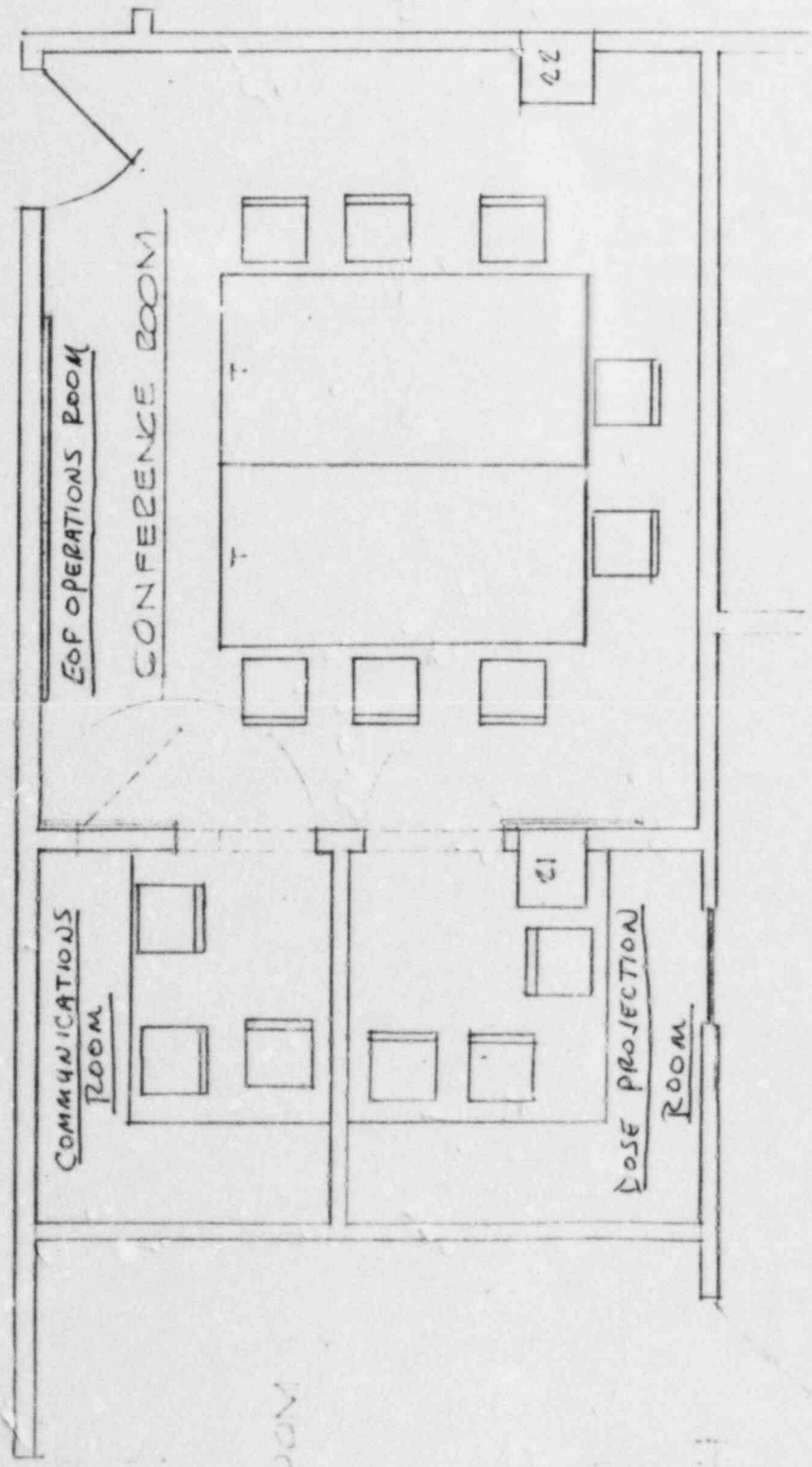

ANN. FIFTH FLOOR.

SCALE 1/4" = 1'-0"