

DMB
+3 ✓

PRINCIPAL STAFF			
A	✓	PRRP	✓
D/RA		DE	
A/RA		DRMSP	
RC		DRMA	
PAO		SCS	
SGA		ML	
ENF		File	✓

DOCUMENTATION TRANSMITTAL

To: Stone & Webster - CIO
PO Box 1963
Midland, MI 48640

Transmittal No: CIO-0047
Date: May 18, 1984

Attention: David Beauchamp

The documentation listed below X is provided herewith, was previously provided on ; as requested by David Beauchamp.

Documentation Description: Nonconformance Report - C-02299-V

CIO has X has not been placed on routine transmittal for the described documentation.

Jeanne Kinne
Signature

- CC RJCook, NRC Site (w/a, unless voluminous)
- JJHarrison, NRC Region III (w/a, unless voluminous)
- DDJohnson, SMO (w/o)
- JGKepler, NRC Region III (w/a, unless voluminous)
- BHPeck, SMO (w/o)
- NIRichel, SMO (w/o)
- RAWells, MPQAD (w/o)
- CMThompson - File 24.2 (w/a, unless voluminous)

MAY 24 1984

JE01/1

MIDLAND PROJECT
QUALITY ASSURANCE
DEPARTMENT

NONCONFORMANCE REPORT

ORIGINAL

16 NCR NO.	C-02299-V	
17 DATE ISSUED	4-3-84	18 REV 0
19	PAGE 1 OF 12 ^{HAS} 40954 _{20 SUTS-184}	

1 ITEM LOCATION S.W.P.S., EL. 592' to 609', SEE ATTACHED SKETCH ON PAGE 12.

2 ITEM DRAWING/PART NO. N/A
3 ITEM PART NAME N/A
4 ITEM SERIAL NO. N/A

5 ITEM DESCRIPTION
CONCRETE PLACEMENT SWI (609) a'

6 ITEM STARTUP SYSTEM NO. BOOE & BOOF
7 REFERENCE DOCUMENT SPEC 7220/C-231/21 PAGE C1.40 ACTIVITIES 2.3, 3.2
8 ASNE A.S.I. REQUIRED YES NO

9 INSPECTION RECORD NO. V-C1.40-30
10 RESPONSIBLE ORGANIZATION CONSTRUCTION

11 NONCONFORMANCE DISCOVERED DURING:
 POST INSPECT TURNOVER POST TURNOVER DESIGN RECEIVING CONST RELEASE FOR INSPECT
 PRE-OF TEST ITEM TURNOVER OVERSIGHT

12 REQUIREMENT SPEC C-231 ²¹ STATES IN PART,
 SEC. 5.1 "...JOINTS SHALL BE MORTAR TIGHT... LOCAL DEFECTS SUCH AS CHIPPED PLYWOOD OR KINKS IN STEEL FORMS WILL NOT BE PERMITTED ON EXPOSED SURFACES..."
 SEC. 5.2 "... (FORM) TIES SHALL BE SO ARRANGED THAT WHEN FORMS ARE REMOVED ALL METAL SHALL BE NOT LESS THAN 1/2 INCH FROM SURFACES SUBJECTED TO ORDINARY WEATHER"
 SEC. 16.1 "ALL EXPOSED WALL SURFACES DESIGNATED AS HAVING A NATURAL FINISH SHALL RECEIVE THE FOLLOWING TREATMENT

13 NONCONFORMANCE CONTRARY TO THIS, CONCRETE PLACEMENT SWI (609) a' CONTAINS THE FOLLOWING:
 A) A GROUT LEAK ALONG THE HORIZONTAL CONSTRUCTION JOINT AT EL. 609'
 B) CRACKS EXUDING WATER
 C) ~~ROSTING TIE WIRE ALL 4/14/84~~
 D) VOIDS
 E) GROUT REPAIRS - NOT TIGHTLY BONDED, HOLLOW SOUNDING OR SHOWING EVIDENCE OF MOISTURE
 F) PLYWOOD
 G) UNSOUND CONCRETE
 H) ~~CRACKS IN CONCRETE FORMS DISKS ALL 4/14/84~~

14 NCR ORIGINATED BY (PERSON)
Emily Walker 4/3/84
DATE

15 NCR ORIGINATED BY (DISCIPLINE)
Q.C.D. CIVIL

20 NUMBER OF HOLD TAGS (IF APPLIED) 32
21 LOCATION OF HOLD TAGS EL. 596' & 603.6" AT 8' CENTERS BEGINNING 3' W/WATER INTAKE PUMP # 3

22 POTENTIAL SO. 28(a) YES NO
23 ACTION ITEM NO. 506093
24 ITEM PRIORITY CODE NO. 3
25 NCR REVIEWED BY: K.L. Loath

26 REPORTED TO NCR MANAGER DATE N/A
27 DISCIPLINE: C
28 TRIM CODE CC-40077
29 DATE: 4-14-84

29 CAUSE

POOR CONCRETE FINISH WORK AFTER FORMS WERE STRIPPED.

20
5.1.84

30 PROCESS CORRECTIVE ACTION

YES NO QAR NO. _____

31 RECOMMENDED DISPOSITION

~~INVALID (L.P. 6), E (P. 0)~~ ^{CEP 9/1/84}

REMOVE ^{9/1/84} SCRAP/REJECT REPAIR USE AS IS ^{9/1/84}
DI (PAGE 8), I (PAGE 9) REMAINDER AS SHOWN ON PAGE 19 ^{BR 9/1/84}

32 CONDITIONAL RELEASE

YES NO

31A ADDITIONAL INFORMATION

SEE CONT SHEET

33 DISTRIBUTION FOR ACTION

TEAM 29

34 DISPOSITION CONCURRENCE

Boziah 5/4/84 K.L. Louth 5/4/84
PROJECT FIELD ENGINEER DATE NPOAS CONCURRENCE DATE

PFQE (ASNE) DATE

PQAE (ASNE) DATE

A.N.I. (ASNE) DATE

J.M. Carlson (E.B. Poon) 5/1/84
LEAD DESIGN ORG DATE CP Co SMO (for turned over systems) DATE

35 DISPOSITION ACTION TAKEN

36 METHOD OF DISPOSITION ACTION VERIFICATION

RESULT OF DISPOSITION ACTION VERIFICATION

ACCEPTABLE UNACCEPTABLE

IF UNACCEPTABLE, REFERENCE SUPERCEDING NCR NUMBER _____

37 NCR CLOSED BY

NPOAS DATE

A.N.I. (ASNE) DATE

ORIGINAL

NONCONFORMANCE REPORT
CONTINUATION SHEET

NCR NO.

C-02299-V

DATE ISSUED

4-3-84

REV

0

PAGE 3

OF 12

~~20~~ 20
5.1.84

(BLOCK 12 CONTINUED) AS SOON AS POSSIBLE AFTER REMOVAL OF FORMS AND THE CORRECTION OF MAJOR IMPERFECTIONS... DRY PACK FORM TIE HOLES AND CORRECT MINOR IMPERFECTIONS NOT INCLUDED UNDER ARTICLE 17.0." SEC. 17.1 "IMPERFECTIONS IN FORMED CONCRETE SHALL BE REPAIRED AS SOON AS PRACTICABLE AFTER REMOVAL OF FORMS. ... ALL FILLING SHALL BE BONDED TIGHTLY TO THE SURFACE OF THE HOLES, SHALL BE SOUND AND FREE FROM SHRINKAGE CRACKS AND HOLLOW SOUNDING AREAS." INSPECTION SHALL INCLUDE: SEC. 19.2.4 "INSPECTION OF CONCRETE AFTER FORM REMOVAL FOR ROCK POCKETS, GROUT LEAKS, IMPERFECTIONS, ETC. AND ANY REPAIR REQUIRED THEREOF."

(BLOCK 13 CONTINUED)

- I.) RUSTING DROP-IN ANCHORS
- J.) VERTICAL JOINT TO ADJACENT POUR ON SOUTH WALL - POORLY BONDED AND LEAKING WATER
- K.) IMPROPERLY BONDED VERTICAL CONSTRUCTION JOINT TO EAST/WEST WALL DIVIDING AREA 800E & 800F.

THE LOCATIONS FOR THE ITEMS NOT SPECIFICALLY LOCATED ABOVE ARE AS FOLLOWS:

NORTH WALL - SOUTH FACE

- B) CRACKS - BEGINNING AT THE FLOOR SLAB
 - 1.) NORTHWEST CORNER
 - 2.) DIRECTLY BEHIND 1ST WATER INTAKE ^{800W/2184} PUMP
 - 3.) 1' 11" WEST / Q PIER 1
 - 4.) 4' 0" EAST / Q PIER 1
 - 5.) 2' 6" W / Q PIER 2

^{ALL 4/14/84}
C) ~~RUSTING TIE WIRE~~

- ~~1.) EL. 600' 2" , 18" EAST/WEST WALL~~
- ~~2.) EL. 606' 2" , 2' 7" & 4' 6" EAST/WEST WALL~~
- ~~3.) EL. 606' 2" , BEHIND WATER INTAKE PUMP #1~~
- ~~4.) EL. 606' 0" , BEHIND PIER 1~~
- ~~5.) EL. 606' 2" , 2' 7" & 3' 1" WEST OF WATER INTAKE PUMP #2~~
- ~~6.) EL. 598' 1" & 600' 1" BEHIND WATER INTAKE PUMP #2~~
- ~~7.) EL. 606' 2" , 6' W / Q PIER 2~~
- ~~8.) EL. 606' 2" , 4' W / Q INTAKE PIPE 3~~
- ~~9.) EL. 598' 2" & EL. 600' 12 (3 LOCATIONS) BEHIND WATER INTAKE PUMP 3 E 80W 3/9/84~~

NONCONFORMANCE REPORT

CONTINUATION SHEET

~~(BLOCK 13 CONTINUED)~~

- ~~9.) EL. 606'2", 1'0" E/C WATER INTAKE PUMP #3~~
- ~~10.) EL. 606'2", 1'0" W/C PIER 2~~
- ~~11.) EL. 600'1", 4' W/C PIER 2~~
- ~~12.) EL. 600'1", 4' E/C PIER 2~~
- ~~13.) EL. 600'1", DIRECTLY BEHIND PIER 2~~
- ~~14.) EL. 600'1", DIRECTLY BEHIND WATER INTAKE PUMP #3~~

REC 4/14/84

D) VOIDS

- 1.) EL. 605'4" - UPPER RIGHT HAND CORNER OF WATER INTAKE PUMP #3 EMBED
- 2.) EL. 607'4", 4'2" W/C PIER 2
- 3.) EL. 607'3" BEHIND WATER INTAKE PUMP #2
- 4.) EL. 605'2", UPPER LEFT HAND CORNER OF WATER INTAKE PUMP #2 EMBED
- 5.) EL. 604', VOID AT LOWER LEFT HAND CORNER OF WATER INTAKE PUMP #2 EMBED
- 6.) EL. 608'-609' BEHIND PIER #1 (SEVERAL)

E) GROUT REPAIRS

- 1.) EL. 604', UNDER EMBED FOR WATER INTAKE PUMP #3
- 2.) EL. 604', 4' W/C INTAKE PUMP #3
- 3.) EL. 604'8", 1'8" W/C PIER 2
- 4.) EL. 604'10", 2' E/WEST WALL

(BLOCK 13 CONTINUED)

F.) PLYWOOD

- 1.) EL. 599.7" , 3' E / PIER 2
- 2.) EL. 595.5" , 3'6" E / PIER 2
- 3.) EL. 595.5" , BEHIND PIER 2

G.) UNSOUND CONCRETE

- 1.) EL. 603' , UNDER EMBED FOR WATER INTAKE
~~X~~ PUMP #1 AND CONTINUES TO THE WEST

WEST WALL

B.) CRACKS (BEGINNING AT THE FLOOR)

- 1.) 4'8" S / NORTH WALL
- 2.) 8' S / NORTH WALL , EL. 606
- 3.) 14'6" S / NORTH WALL , EL. 605
- 4.) 15'6" S / NORTH WALL , EL. 605
- 5.) 23'6" S / NORTH WALL
- 6.) 2'3" N / MIDDLE WALL
- 7.) 9'10" N / MIDDLE WALL
- 8.) 14' N / MIDDLE WALL
- 9.) 16'6" N / MIDDLE WALL
- 10.) 10" S / MIDDLE WALL
- 11.) 8'0" S / MIDDLE WALL
- 12.) 11'9" S / MIDDLE WALL
- 13.) 12'9" S / MIDDLE WALL
- 14.) 5' N / SOUTH WALL
- 15.) SOUTH WEST CORNER OF POUR

ORIGINAL

NONCONFORMANCE REPORT
CONTINUATION SHEET

NCR NO.

~~4-3-84~~ C-02299-V

DATE ISSUED

4-3-84

REV

0

PAGE 7

OF

17 AS
18 4/27/84
SWT
5184
20

(BLOCK 13 CONTINUED)

C. RUSTING TIE WIRE

- 1.) EL. 605', 16'6" S/N WALL
- 2.) EL. 608'6", 19'6" S/N WALL
- 3.) EL. 608'6", 21'6" S/N WALL
- 4.) EL. 606'2", 21'8" S/N WALL
- 5.) EL. 603', 4'6" S/N WALL
- 6.) EL. 598'1", 4'6" S/N WALL
- 7.) EL. 600'8", 7'6" S/N WALL
- 8.) EL. 602'2", 7'6" S/N WALL
- 9.) EL. 604'2", 11' S/N WALL
- 10.) EL. 602'2", 10'6" S/N WALL
- 11.) EL. 601', 16'6" S/N WALL
- 12.) EL. 603'2", 20'6" S/N WALL
- 13.) EL. 604'1", 23' S/N WALL
- 14.) EL. 600'0", 6' N / MIDDLE WALL
- 15.) EL. 607'2", 14'6" N / MIDDLE WALL
- 16.) EL. 598'1 1/2", 2'8" S / MIDDLE WALL
- 17.) EL. 598'1 1/2", 3'2" S / MIDDLE WALL
- 18.) EL. 596'1 1/2", 3'2" S / MIDDLE WALL
- 19.) EL. 600'1", 3'2" S / MIDDLE WALL
- 20.) EL. ~~600'~~ 604'1", 3'2" S / MIDDLE WALL
- 21.) EL. 602'2", 6'2" S / MIDDLE WALL
- 22.) EL. 602'2", 9'2" S / MIDDLE WALL
- 23.) EL. 600'1 1/2", 2'6" N / SOUTH WALL
- 24.) EL. ~~600'~~ 601'1 1/2", 2'6" N / SOUTH WALL
- 25.) EL. 606'2", 11'2" S / MIDDLE WALL
- 26.) EL. 606'2", 15'2" S / MIDDLE WALL
- 27.) EL. 606'2", 17'2" S / MIDDLE WALL

JKL
4/14/84

ORIGINAL

NONCONFORMANCE REPORT
CONTINUATION SHEET

NCR NO.

C-02299-V

DATE ISSUED

4-3-84

REV

0

PAGE 8 OF 20

REVISED 4/12/84
SMT 5.180

BLOCK 13 CONTINUED)

- 28.) EL. 608'2" , 3'6" N / SOUTH WALL
- 29.) EL. 608'2" , 7'6" N / SOUTH WALL
- 30.) EL. 604'1/2" , 3'6" N / SOUTH WALL
- 3.1) EL. 606'1/2" , 3'6" N / SOUTH WALL

REV 4/14/84

D.) VOIDS

- 1.) EL. 605' , 3' S / NORTH WALL
- 2.) EL. 596'0" , 2'6" S / MIDDLE WALL
- 3.) EL. 597'4" , 1' N / SOUTH WALL
- 4.) EL. 607'4" - 608'8" , 11'5" - 13'5" S / MIDDLE WALL

E.) GROUT REPAIRS

- 1.) EL. 604'8" , 21' S / NORTH WALL
- 2.) EL. 608'9" , DIRECTLY ABOVE EDGE OF DECK ON NORTH SIDE OF MIDDLE WALL
- 3.) EL. 603'10" , 1'4" S / NORTH WALL
- 4.) EL. 604'10" , 5'4" NORTH OF DECK EDGE OF MIDDLE WALL
- 5.) EL. 600'9" , 5'4" NORTH OF DECK EDGE OF MIDDLE WALL
- 6.) EL. 592'10" , 6'5" S / NORTH WALL
- 7.) EL. 596'8" , 12' S / NORTH WALL
- 8.) EL. 603'10" , 5'8" N / SOUTH WALL
- 9.) EL. 608'8" , 1' S / MIDDLE WALL
- 10.) EL. 608'8" , 2'8" S / MIDDLE WALL
- 11.) EL. 608'9 1/2" , 5'0" N / SOUTH WALL

(BLOCK 13 CONTINUED)

12.) EL. 608'9 1/2" , 8'0" N / SOUTH WALL

Egaw 4/2/84

F.) PLYWOOD

- 1.) EL. 603' 20'6" S/NORTH WALL
- 2.) EL. 603'7" , 3'4" N / MIDDLE WALL
- 3.) EL. 600'2" , 2'8" N / MIDDLE WALL
- 4.) EL. 594'9" , 13'9" S / NORTH WALL
- 5.) EL. 592'6" - 594'3" , 16'-18' S / NORTH WALL
- 6.) EL. 598'8" , 2'0" S / MIDDLE WALL
- 7.) EL. 596'1" , 7'2" S / MIDDLE WALL

H.) RUSTING METAL FORM DISKS

- 1.) EL. 592'6" , 16'6" S / N WALL
- 2.) EL. 605'0" , IN CONSTRUCTION JOINT ON SOUTH SIDE OF MIDDLE WALL

100 4/14/84

I.) RUSTING DROP-IN ANCHORS (ABANDONED)

- 1.) EL. 594'9" , 10'3" S / MIDDLE WALL
- 2.) EL. 597'4" , 10'3" S / MIDDLE WALL
- 3.) EL. 597'10" , 10'3" S / MIDDLE WALL

(BLOCK 13 CONTINUED)

SOUTH WALL

B.) CRACKS

1.) 12'9" E / WEST WALL - FLOOR EL. UP

~~C.) RUSTING TIE WIRE~~

~~1.) EL. 606'2", 3'6" E / WEST WALL~~

~~2.) EL. 608'2", 7'6" E / WEST WALL~~

~~3.) EL. 606'2", 7'6" E / WEST WALL~~

~~4.) EL. 605'2", 8'6" E / WEST WALL~~

~~5.) EL. 608'2", 12'6" E / WEST WALL~~

~~6.) EL. 606'6", 12'6" E / WEST WALL~~

~~7.) EL. 607'2", 14'6" E / WEST WALL~~

~~8.) EL. 600'2", 8' E / WEST WALL~~

~~9.) EL. 603'2", 6'6" E / WEST WALL~~

~~10.) EL. 599'2", 6'6" E / WEST WALL~~

~~11.) EL. 604'2", 11'6" E / WEST WALL~~

~~12.) EL. 597', 8'6" E / WEST WALL~~

~~13.) EL. 596'6", 11'10" E / WEST WALL~~

~~14.) EL. 596'6", 12' E / WEST WALL~~

~~15.) EL. 597'8", 14'10" E / WEST WALL~~

~~16.) EL. 597'8", 15' E / WEST WALL~~

~~17.) EL. 597'1'12", 16'6" E / WEST WALL~~

KLL

4/14/84

NONCONFORMANCE REPORT
CONTINUATION SHEET

(BLOCK 13 CONTINUED)

E.) GROUT REPAIRS

- 1.) EL. 608'9" , 1' E/WEST WALL (MOISTURE)
- 2.) EL. 608'9" , 4' E/WEST WALL (MOISTURE)
- 3.) EL. 608'9" , 10' E/WEST WALL (MOISTURE)
- 4.) EL. 608'9" , 13' E/WEST WALL (MOISTURE)
- 5.) EL. 608'9" , 19' E/WEST WALL (MOISTURE)
- 6.) EL. 604'10" , 1' E/WEST WALL (MOISTURE)
- 7.) EL. 604'10" , 4' E/WEST WALL (MOISTURE)
- 8.) EL. 604'10" , 7' E/WEST WALL (MOISTURE)
- 9.) EL. 604'10" , 10' E/WEST WALL (MOISTURE)
- 10.) EL. 604'10" , 13' E/WEST WALL (MOISTURE)
- 11.) EL. 604'10" , 19' E/WEST WALL (MOISTURE)
- 12.) EL. 600'9" , 7' E/WEST WALL (MOISTURE)
- 13.) EL. 600'9" , 10' E/WEST WALL (MOISTURE)
- 14.) EL. 600'9" , 19' E/WEST WALL (MOISTURE)
- 15.) EL. 592'9" , 21' E/WEST WALL (MOISTURE)
- 16.) GROUT SURROUNDING LG. PIPE RUNNING THROUGH SOUTH WALL IN SOUTH/WEST CORNER - (CRACKED, HOLLOW SOUNDING AND SHOWS SIGNS OF MOISTURE)

TRUE NORTH ↑

BUILDING NORTH ↑

NORTH WALL

SOUTH WALL

MIDDLE WALL

WEST WALL

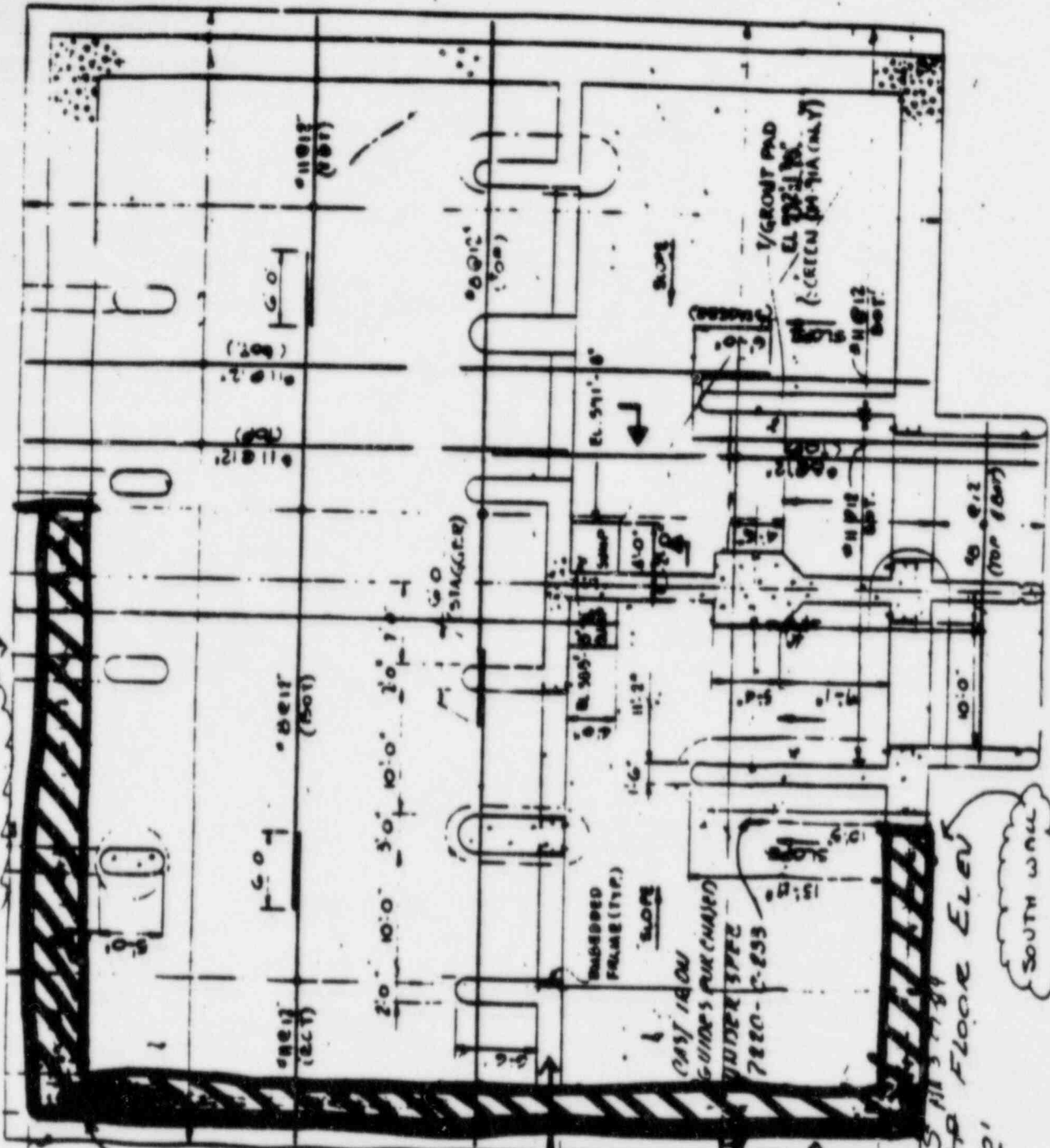

ORIGINAL

NCR# C-02299-A
REV. 0

PAGE 12 OF 12
DATE 5-1-84

CONT 31A

Pg 4 of 12 Section B. Use as is. Spec C 231 has no criteria
regarding ~~of acceptance for cracks~~.
DRW

Pg 4 of 12 Section C Void by Q C

Pg 5 of 12 Section D Use as is. Voids are minor in nature
and does not effect the structural integrity of
the concrete.

Pg 5 of 12 Section E Use as is areas are only cosmetic.

Pg 6 of 12 Section F Use as is Plywood is form lamination
stuck to concrete surface.

Pg 6 of 12 Section G Use as is No unsound concrete was
found in area.

Pg 6 of 12 Section B Use as is Spec C 231 has no ~~acceptance~~
criteria ~~for cracks~~ regarding
DRW

Pg 7 of 7 Void by Q C

Pg 8 of 12 II 20-31 Void by Q C

Pg 8 of 12 Section D Item 1 Rework in accordance with Spec.
C 231 section 17.

II 2, 3, 4. Very minor voids small as per spec Use as is

Pg 8 of 12 Section E Use as is All grout repair were found
to be sound and not in need of repair

NONCONFORMANCE REPORT
CONTINUATION SHEET

NCR NO. C 02299V

DATE ISSUED

REV

PAGE 14 OF 20 ^{5.1.04}

Cont 31 A

Pg 9 of 12 Section F. Use as is. All plywood found was at concrete surface, we took care to remove it to concrete. None affects the concrete's structural integrity.

Pg 9 of 12 Section H Void by QC

Pg 9 of 12 Section I Rework - Remove out anchors and repair in accordance with Spec C 231 Section 7

Pg 10 of 12 Section B Use as is. Spec C 231 has no new acceptance criteria for cracks.

Pg 10 of 12 Section C Void by QC

Pg 11 of 12 Section E #1-15 Use as is. All grout repairs are sound and have no effect on the structure's structural integrity.

Pg 11 of 12 Section E #16 Use as is. Grout around pipe is acceptable per N.M. Patankar (Project)

Tom Osborne

Block 31 A

Project Engineering Disposition

Items for NORTH WALL SOUTH FACE

Item B - Crack mapping will be done by remedial
soils group see EOM from B Dhar to J.
Hoekwater dated 4.26.84 Com 149308 page 28
of this NCR.

The disposition is USE AS IS

Item D page 5 of this NCR

Sh. 14-84

The voids described in this item were
physically reviewed. Most voids are air voids
caused by excessive application of form
parting agent. Some rough areas were
noticed. No voids which may impair the
structural integrity were noticed.

Project Engineering concurs with field
engineering and recommends "USE AS IS"

Item E page 5

The grout repairs on physical review were
found to be sound. Minor imperfections giving
roughness to the concrete. None of the grout repairs
were impairing structural integrity. Project

BLOCK 31 A Contd

Project Engineering Disposition (CONT'D)

The disposition should be USE AS IS.

Item I on page 9

Project engineering concurs with field engineering and recommends "REWORK" in this area.

The drop in anchors shall be removed and the area repaired according to spec C-231.

Item B. Page 10

The cracks will be monitored by Soils remedial group. See disposition of item B for west wall on page 16 of this NCR.

The disposition should be USE AS IS.

Item E on page 11

The grout repairs listed from 1 to 15 were found to be of sound nature. These repairs were repairs for dry packing tie rod holes and likely to show some sweating. However this condition does not affect structural integrity and Project Engineering recommends USE AS IS.

NONCONFORMANCE REPORT
CONTINUATION SHEET

NCR NO. C-02299 ✓

DATE ISSUED 4-3-84

REV 0

PAGE 17 OF 20

BLOCK 31A CONT'D

PROJECT ENGINEERING DISPOSITION

Item D on page 8

Project engineering concurs with field engineering and recommends "REWORK" in this area only for location (1) EL 605, 3' S/North wall

Other items 2, 3, 4 upon physical review ^{DATE 4/30/84} were found to be of very minor ^{SURFACE} imperfections of the nature of air voids. These do not impair structural integrity. Project engineering recommends "USE AS IS"

Item E on page 8

upon physical review of these areas the grout repairs were found to be of sound nature. Project engineering recommends ~~USE AS IS~~ ^{is invited.}
USE AS IS ^{SA}

Item F page 9

The plywood mentioned in the non conformance was found to be ^{WOOD} ^{DATE 4/27/84} laminations sticking to the concrete. These laminations were in very small areas and ^{DATE 4/27/84} superficial ^{DATE 4/27/84}.

Since this does not affect structural integrity

BLOCK 31 A Contd

Project Engineering Disposition (CONT'D)

Item E on page 11 (CONT'D)

The grout listed in item 16 is around the pipe running thru the wall. This area was repaired to stop water coming inside. However it has developed cracks and shows signs of moisture. This area if re-repaired will cause cracks due to vibration of the pipe. The repair will be for cosmetic purposes as it is not holding the pipe structurally. Since both sides of the wall and the pipe will be immersed in water, leakage of water will not be a problem.

Project Engineering recommends USE AS IS since this does not impair structural integrity.

No calcs reqd.

No spec or dwg change reqd

No impact on qual test

SUMMARY OF ITEMS ~~INVALID~~ G(p.6) G(p.8) SW

USE AS IS : ~~A~~ B(p.4) D(p.5) E(p.5) F(p.6) ~~G(p.6)~~ ^{4.25.84} B(p.6), ~~A(p.8) partial SW~~ E(p.8) F(p.9)

B(p.10) E(p.11), D2, D3 & D4 (P.8), G(p.6), E(p.8)

REWORK D1(p.8) partial, I (p.9) SW

Statement of ~~Handwritten Name~~ for
 4.28.84 PV Requested 5/1/84
 SW

Block 31 A (CONC)

Project Engineering Disposition

engineering recommends "USE AS IS"

Item F page 6

The plywood mentioned in the non conformance upon physical review was found to be impression of lamination on the concrete. This does not

penetrate
DAP
4/23/84

go inside the concrete ^{FR 4/23/84} ~~to greater depths~~ and does not affect the concrete. Since the structural integrity is not affected project engineering concurs with field engineering and recommends "USE AS IS"

Item G on page 6

Physical review indicated that there was no unsound concrete. There were no hollow sounding patches in this area.

The disposition is ~~USE AS IS~~ ^{INVALID},
USE AS IS gm

Items for WEST WALL

Item B page 6 - The cracks will be monitored by remedial soils group. See attached

memo from B. Dhar to J. Hockwater dated 4-26-84 Com 149308 page 20 of this NCR

The disposition is "USE AS IS"

149308

MEMORANDUM

per letter to NRC C 02294 V
page 20 of 20
RS-35

TO: JERRY HOERWATER

FROM: B. DHAR

DATE: 4-26/84

SUBJECT: NRC C-02294-V, C-01487-V, JOB NO. 7220

C-2243, C-0167-V, C-2249-V, RS-35

CIVIL STRUCTURAL ASKED FOR CIVIL SOILS PSE EVALUATION OF CRACKS THAT WERE INCLUDED IN NONCOMFORMANCE OF SUBJECT NRCs. PSE COMMENTS ARE AS FOLLOWS:

DURING A MEETING WITH THE NRC (4-4/84-4-6/84) CONSUMERS POWER COMMITTED TO PERFORM AN INVESTIGATING SURVEY OF THE SERVICE WATER PUMP STRUCTURE TO IDENTIFY SIGNIFICANT CRACKS. THE SURVEY SHALL BE PERFORMED AFTER COMPLETION OF THE UNDERPINNING AND BEFORE FUEL LOAD.

THE DATA COLLECTED FROM THAT EVALUATING SURVEY SHALL BE USED TO EVALUATE THE INTEGRITY OF THE STRUCTURE. ALSO A REPORT WILL BE SUBMITTED TO THE NRC, BASED UPON THIS COMMITMENT TO PERFORM A FINAL CRACK SURVEY. PROJECT ENGINEERING RECOMMENDS USE AS IS FOR THE CRACKS IDENTIFIED.

IF YOU HAVE ANY QUESTIONS PLEASE CONTACT JOHN DARRY AT THE MIDLAND JOBSITE, EXT. 7794

WRR: NO

for Jerry for B Dhar

com use: NA