



LOUISIANA / 142 DELARONCE STREET
POWER & LIGHT / P. O. BOX 5008 • NEW ORLEANS, LOUISIANA 70174 • (504) 386-2345

January 28, 1982

L.V. MAURIN
 Vice President Nuclear Operations

W3P82-0228
 3-A45

Mr. R.L. Tedesco
 Assistant Director of Licensing
 U.S. Nuclear Regulatory Commission
 Washington, D. C. 20555



SUBJECT: Waterford 3
 Emergency Planning
 Emergency Operations Facility (EOF)

Dear Mr. Tedesco:

Attached please find the layout of the interim EOF and backup for Waterford 3. The EOF is located in a metal building which houses part of our start-up group.

It should be noted that the NRC resident inspector's trailer will be used to house the NRC response force and will be considered part of the EOF. We have discussed this concept with our NRC resident inspector, Mr. Les Constable, and have received his approval.

The backup EOF, located approximately 25 miles from Waterford 3, will have the same capabilities as the onsite EOF with the exception of the SPDS system and emergency power supply. We have also attached the basic layout of the backup EOF for your information. The communication and dose assessment capabilities for the backup EOF is as follows:

A) Communications

- 1) General Office PBX system
- 2) Dedicated command line to the control room and Technical Support Center
- 3) Dedicated Health Physics line to the Technical Support Center
- 4) Dedicated line to St. Charles Parish, St. John the Baptist Parish, Louisiana Nuclear Energy Division, and Louisiana Office of Emergency Preparedness
- 5) Radio capability to St. Charles and St. John the Baptist Parishes

50-382

X005
 5
 1/1

XA Copy Has Been Sent to PDR

3202020366 320128
 05000382

Mr. R. L. Tedesco
W3P82-0228
Page 2

6) Radio capability to LP&L offsite monitoring team.

B) Dose Assessment

A "Computerized Emergency Planning and Data Acquisition System" (CEPADAS) terminal will be located in the backup EOF which meets the guidance in NUREG 0654 Appendix 2.

If there are any questions, please advise.

Yours very truly,

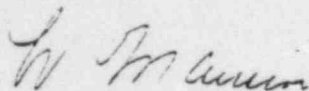

L. V. Maurin

LVM/RGA/kbm

cc: E. Blake, M. Stevenson, S. Black, D. Perrotti, L. Constable, Nuclear Records (2)

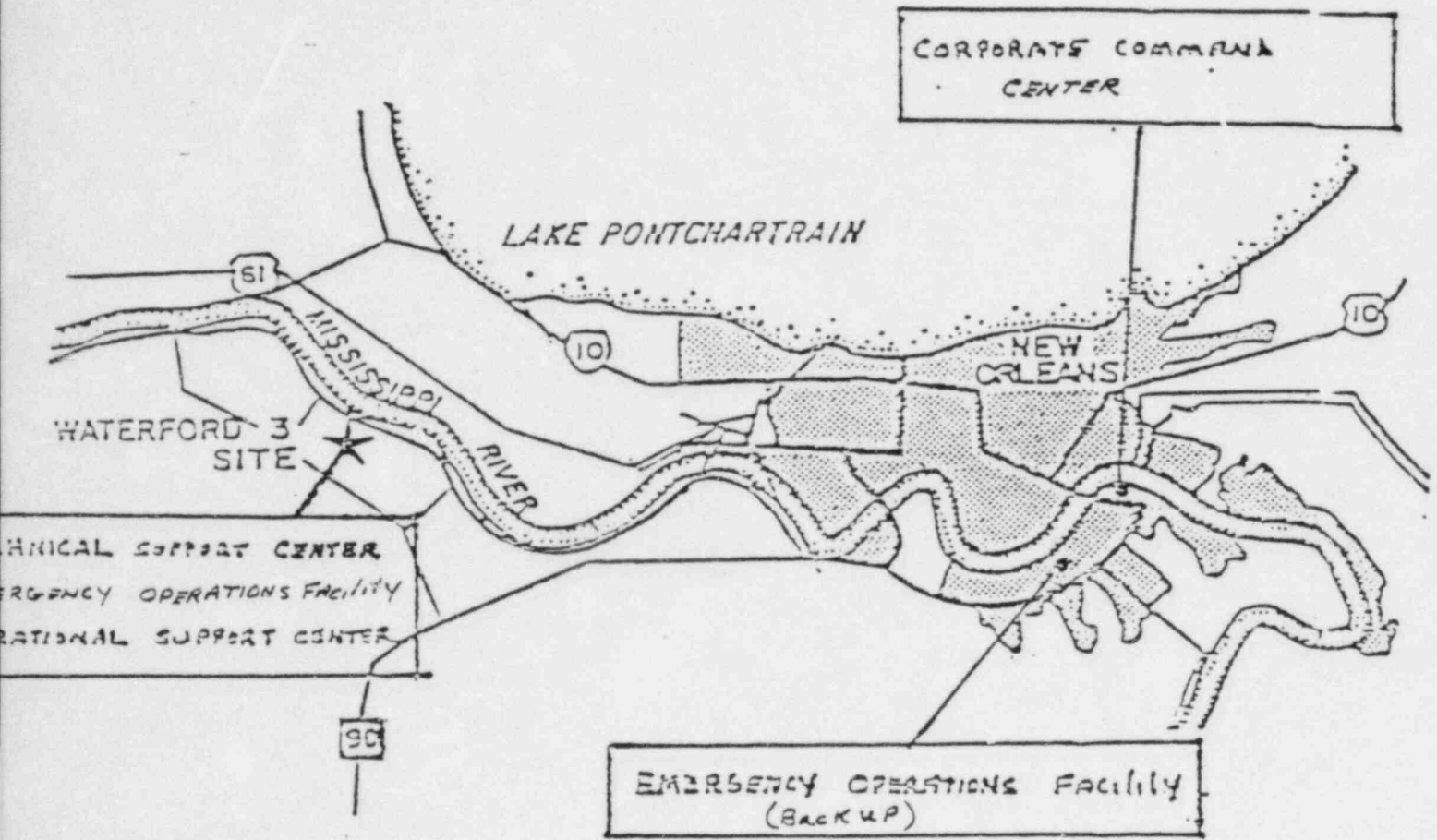

WATERFORD 3

EMERGENCY RESPONSE FACILITIES

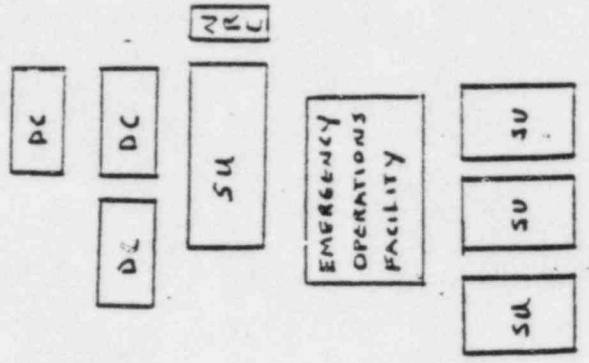
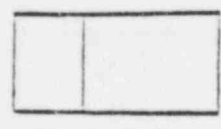
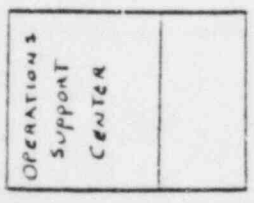
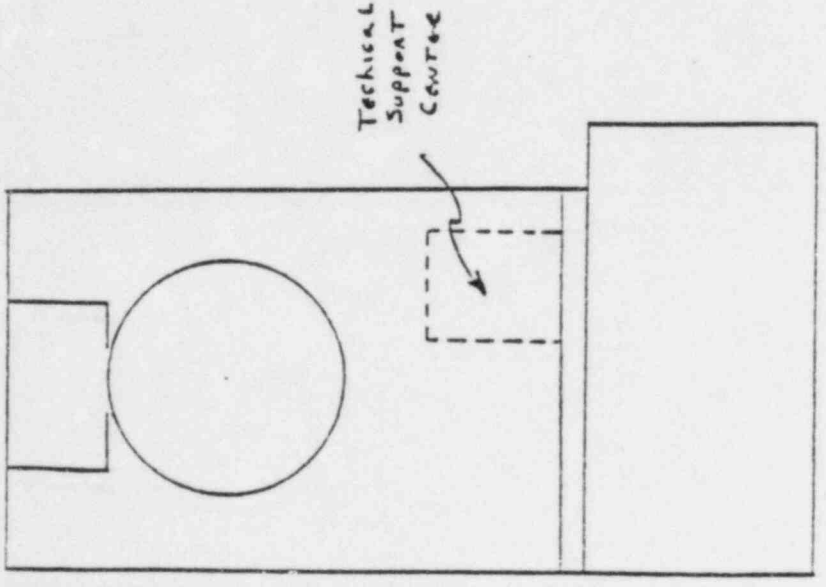
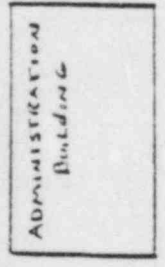

- NOTE:
- START UP
 - DOCUMENT CONTROL
 - RESIDENT INSPECTOR TRAILER

EMERGENCY OPERATIONS FACILITY

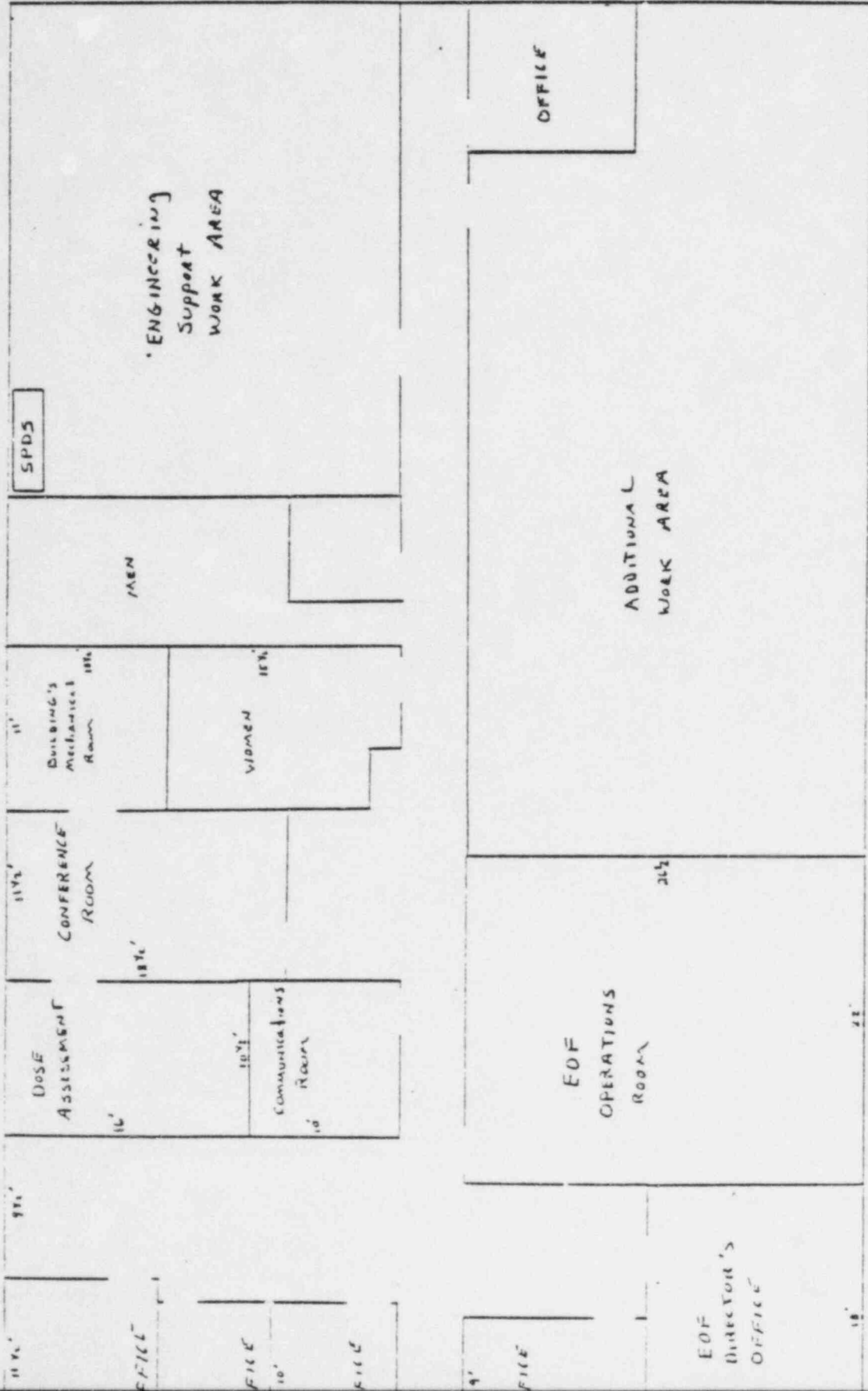

10' = 1'

STATUS BOARDS

PUBLIC RELATIONS
COORDINATOR

PABX

COMMUNICATIONS
COORDINATOR

EOF DIRECTOR

WATERBURY PABX
SEE DEDICATED LINE
GO OPX

ENGINEERING
COORDINATOR

PABX

TECHNICAL SERVICES
COORDINATOR

PABX

RAD. ASSESSMENT
COORDINATOR

HP. DEDICATED L
PABX

LICENSING
COORDINATOR

PABX

OPERATIONS
COORDINATOR

PABX

EBASCO

PABX

NRC

PABX

COMBUSTION
ENGINEERING

PABX

EOF COMMUNICATIONS ROOM

10 1/2'

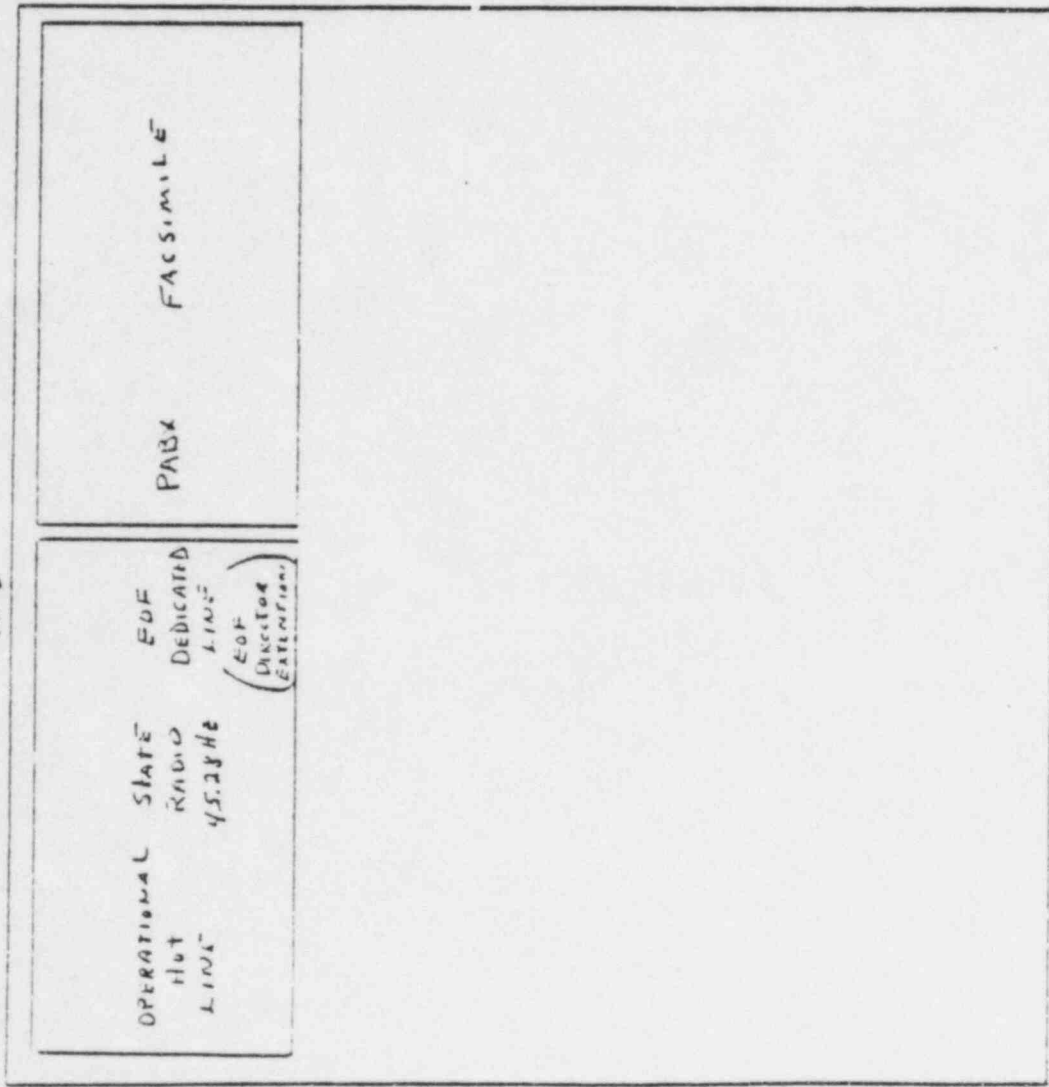

SCALE 1/2" = 1'

BACKUP EOP
204 Huey P Long
GASTON, LA

66 ft

Nuclear Records
and
ADDITIONAL WORK AREA

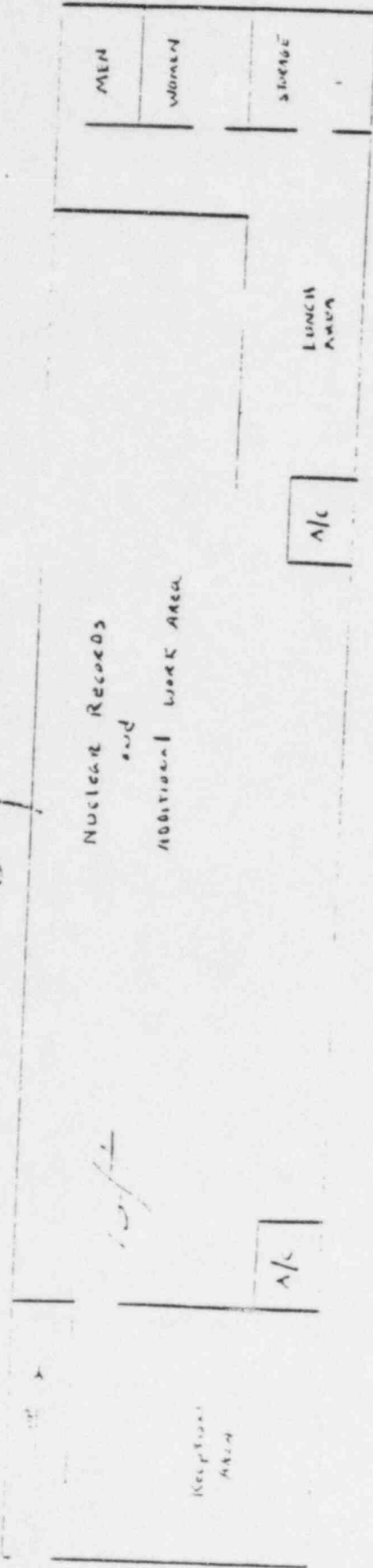

Scale 3/32" = 1'

1 ST FLOOR

BACKUP EOF
204 Husey P. Long
Gretna, LA.

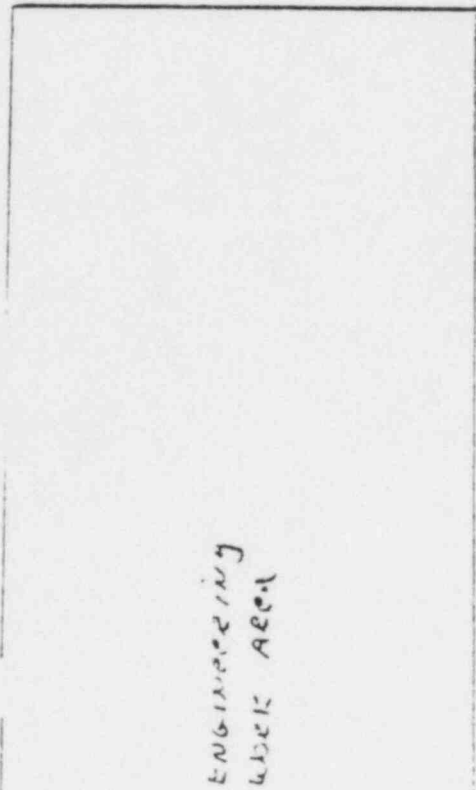
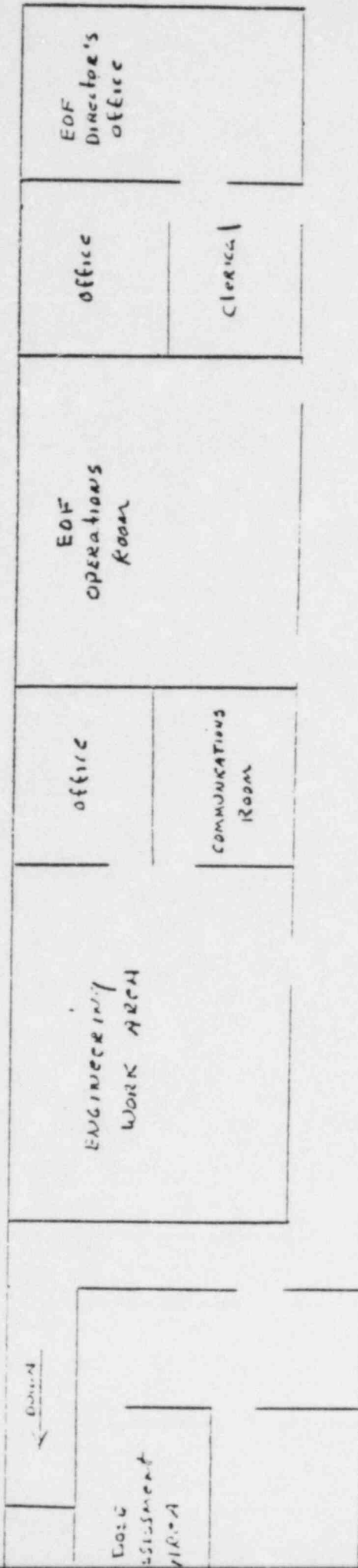

Scale 3/32" = 1'

SCALE 1/2" = 1'

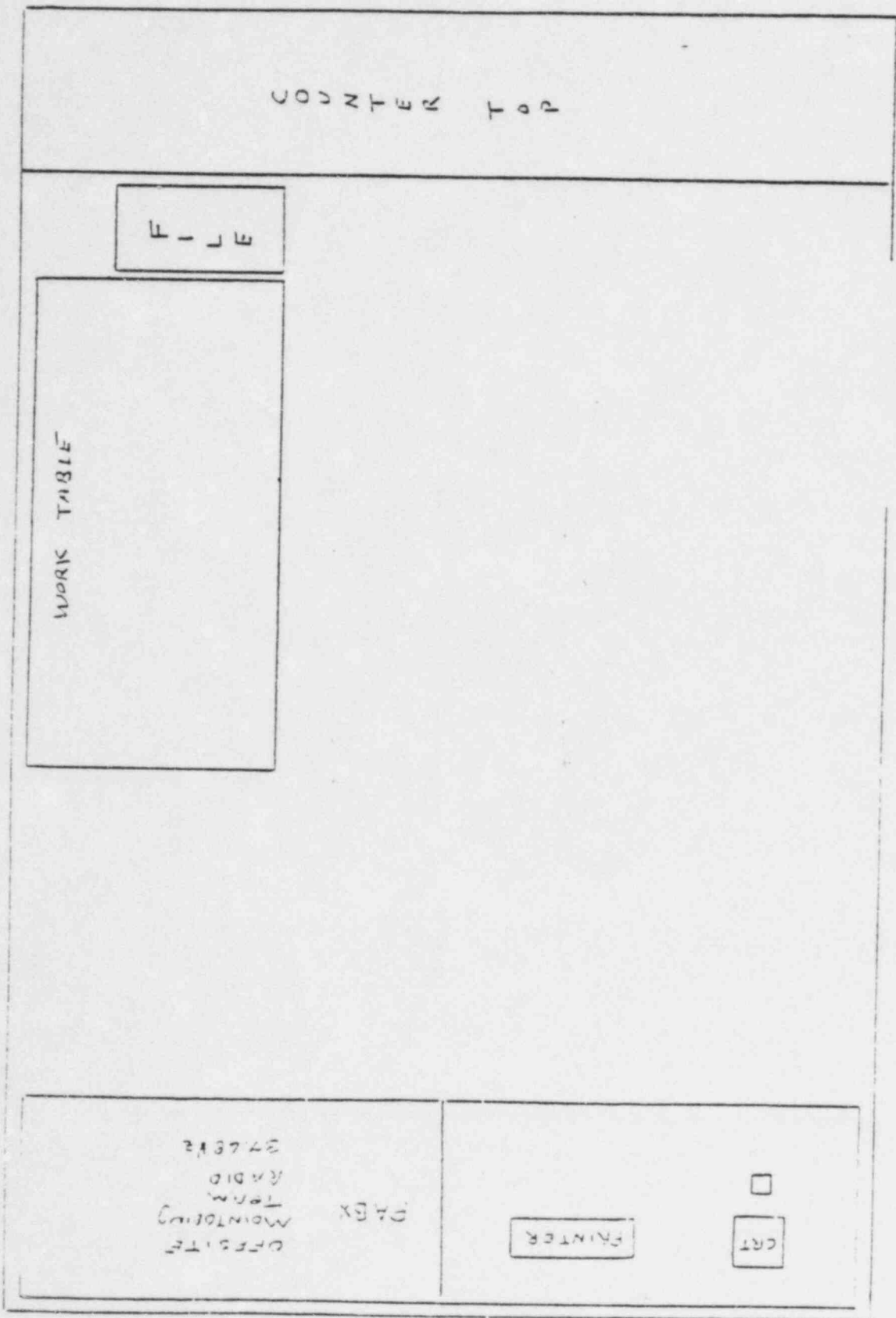

COUNTER TOP

FILE

WORK TABLE

376E12
RADIO
TERM
MOUNTING
DABX
OFFSITE

PRINTER

CRT

ENCLOSURE 2

ENCLOSURE 3