

615
dbr. 03010280
NEUTRON PRODUCTS inc

Dickerson, Maryland 20753

U.S.A.

301/349-5001

Cable: NUSWASH

~~SECRET~~
March 11, 1968

U.S. Atomic Energy Commission
Division of Materials Licensing
Isotopes Branch
Washington, D.C.

Subject: Radiation Survey

Gentlemen:

Attached hereto is a Radiation Survey report of
Neutron Products, Inc. Pilot Plant Irradiator, in ac-
cordance with Item 15 of Byproduct Material License
Number 19-12667-01.

Sincerely yours,

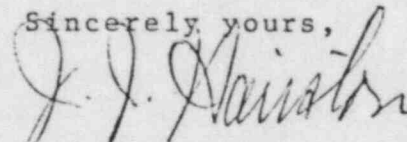

J.J. Hairston
Mgr. Operations

CC: Director Region 1
U.S. Atomic Energy Commission
Division of Compliance
376 Hudson Street
New York, N.Y.
10014

01424

01424

0734

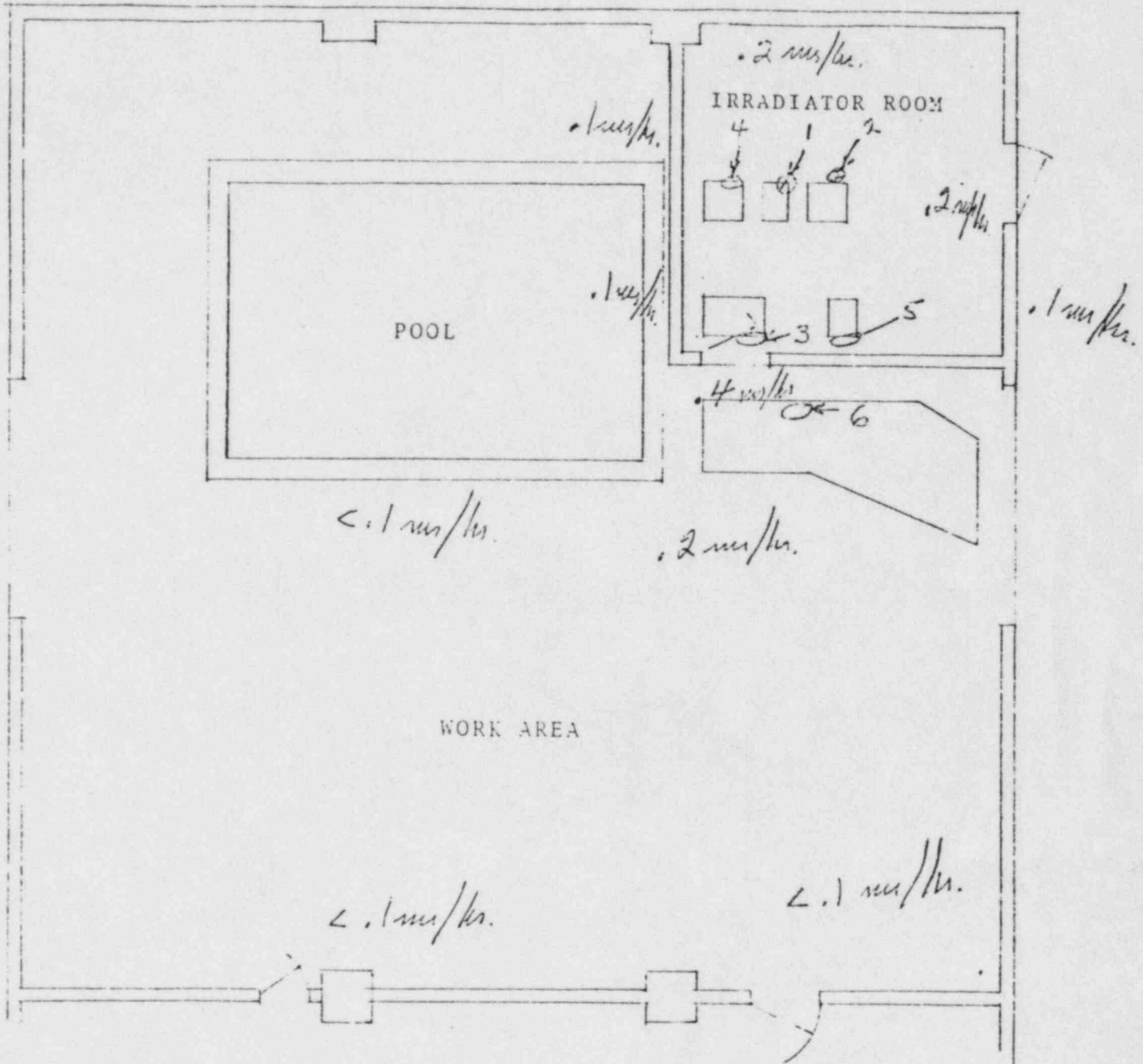

NEUTRON PRODUCTS INC. - RADIATION SURVEY PLAN

2/18/68 01421
J. J. Hariston

RADIATION SURVEY LOG SHEET

SURVEY NO:

PERIODIC

SPECIAL

SWP

PP-1

LOCATION:

NPI Pilot Plant Irradiator Room & Surrounding Area

INSTRUMENTS USED:

Eberline Model E-120 3 Y

DATE

2/18/68

TIME

8:00 AM

SWP NO.

DESCRIPTION OF SURVEY:

Special survey to determine certainty of shielding for irradiation irradiator. At time of survey source level maintained approximately 69,000 Curies of ⁶⁰Co. Entire room and surrounding areas scanned. Readings in irradiator room made from floor elevation to a height of ~ 10 feet. For results see attached plan view of area.

REMARKS:

Maximum reading of 25 mr/hr. found at gap on outside of center concrete plug. General room area read .1 to 3 1/2 mr/hr. All surrounding areas < .2 mr/hr.

SKETCH (IF APPLICABLE):

Reading #	Location & Reading mr/hr.
1	Floor elevation 2" x 12" area. 25 mr/hr. 3' elevation ~ 5 mr/hr. over spot
2	Floor elevation ~ 10 mr/hr. over 1" x 16" spot
3	Floor elevation ~ 15 mr/hr. over 1" x 12" spot
4	Floor elevation ~ 10 mr/hr. over 1" x 6" spot
5	Floor elevation ~ 5 mr/hr. over 1" x 8" spot
6	8 feet below floor in pit ~ 20 mr/hr.

C1424

J. J. Hirston