

ABWR SSAR

(Attachment to MFN No. 001-91)

INSTRUCTIONS FOR INSERTING REPRINTED FIGURES

Remove 8 1/2 x 11 page

3H.3-50,51
3H.3-52,53
3H.3-54,54a
3H.3-56

6.2-92

10.1-7,8
10.1-9

Insert reprinted page

3H.3-50,51
3H.3-52,53
3H.3-54,54a
3H.3-56

6.2-92

10.1-7^{*}
10.1-8,9

* Page 10.1-7 is a 8 1/2 x 11 figure that had an 11 x 17 figure, reduced to 8 1/2 x 11, printed on the back. This page is being replaced now that the 11 x 17 figure is on a separate page (ie., the back of page 10.1-7 will be blank).

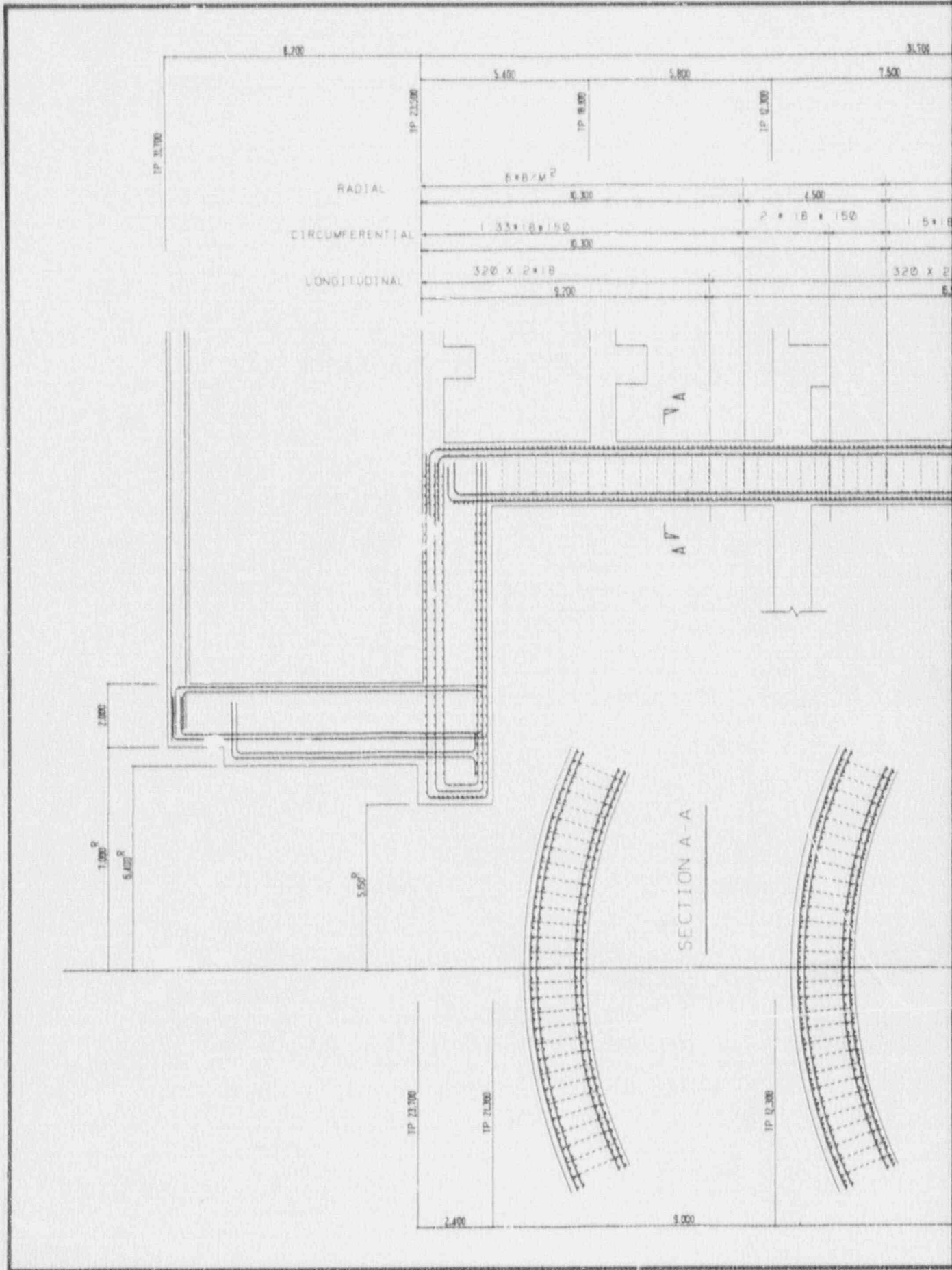

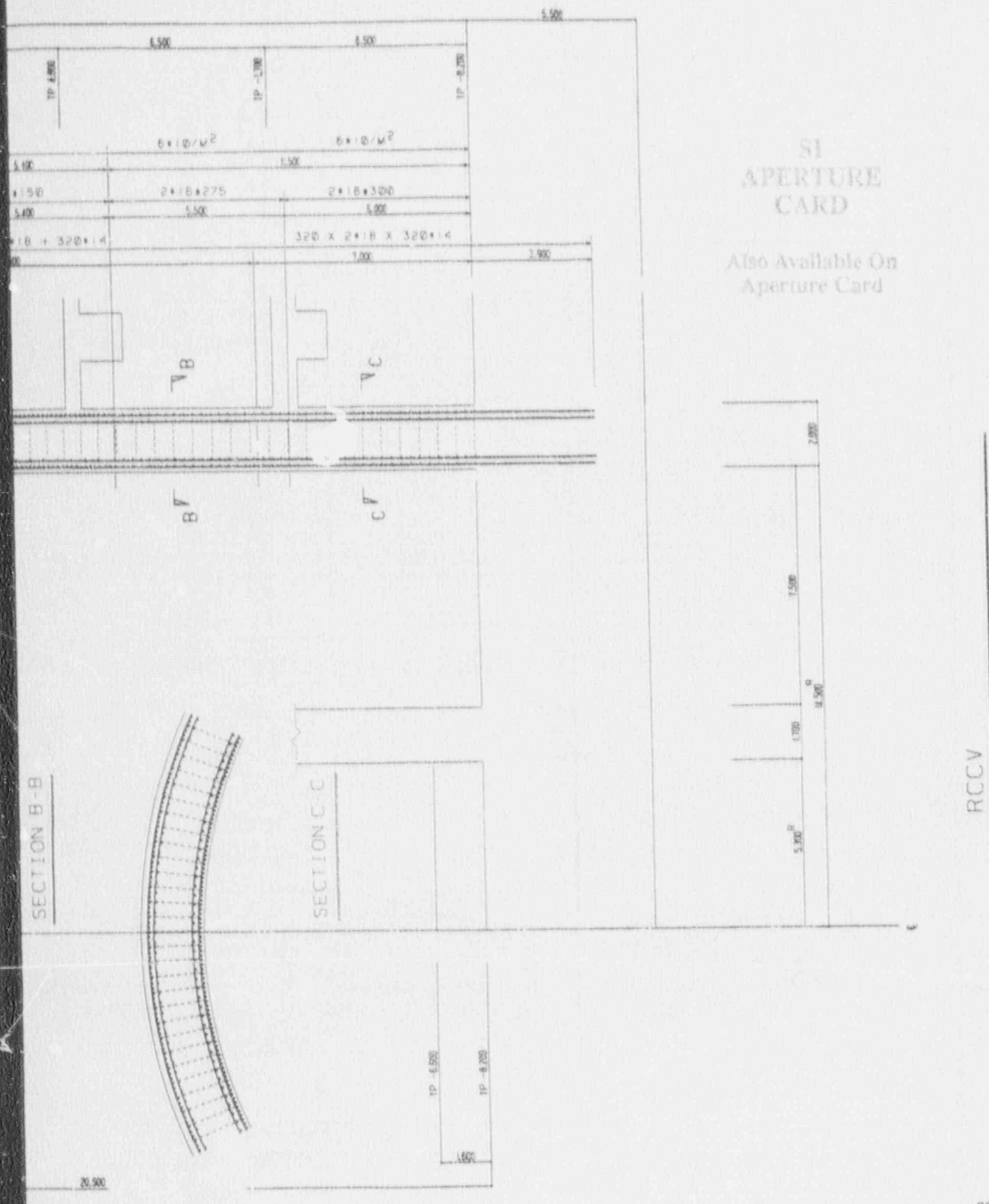
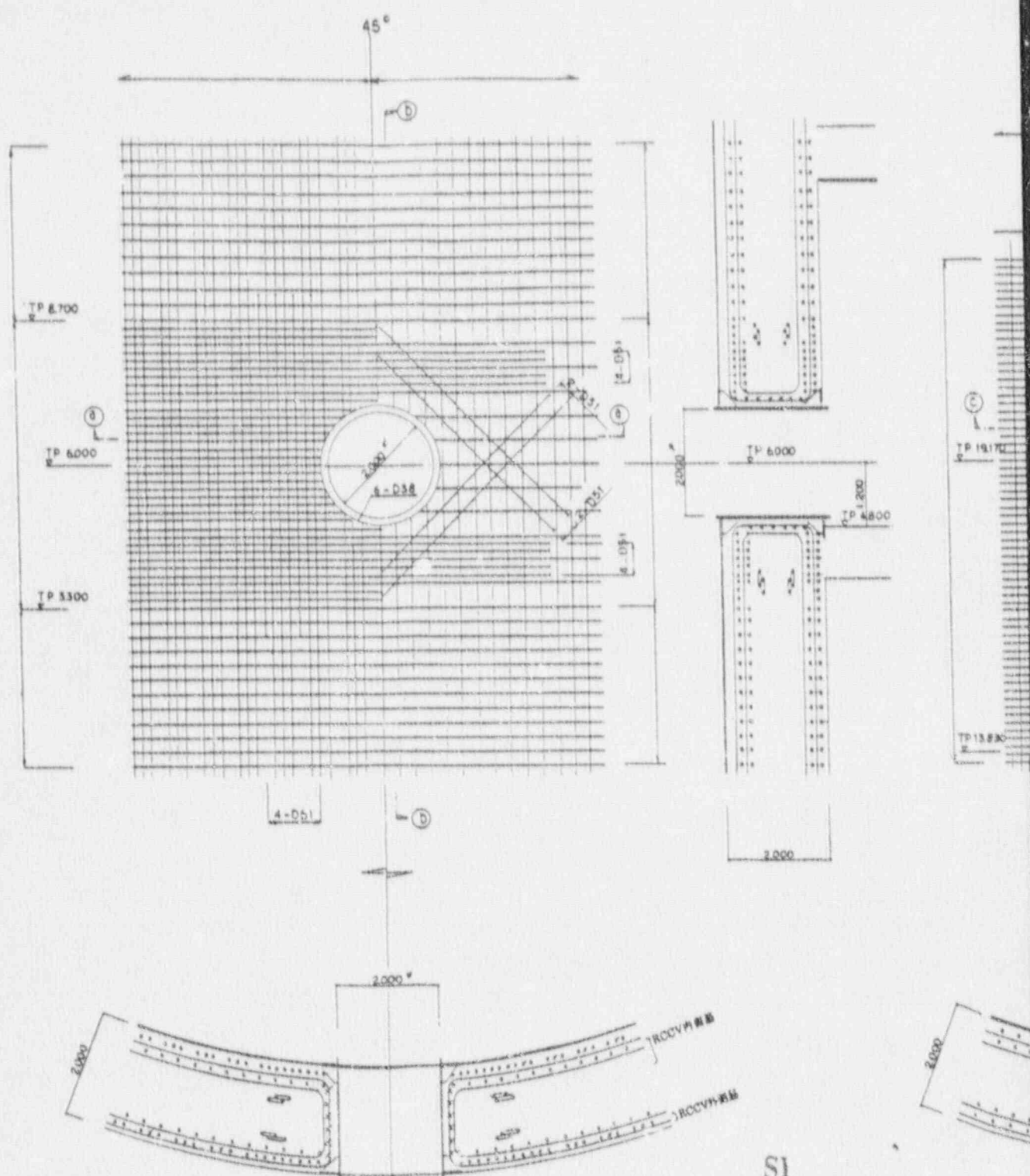
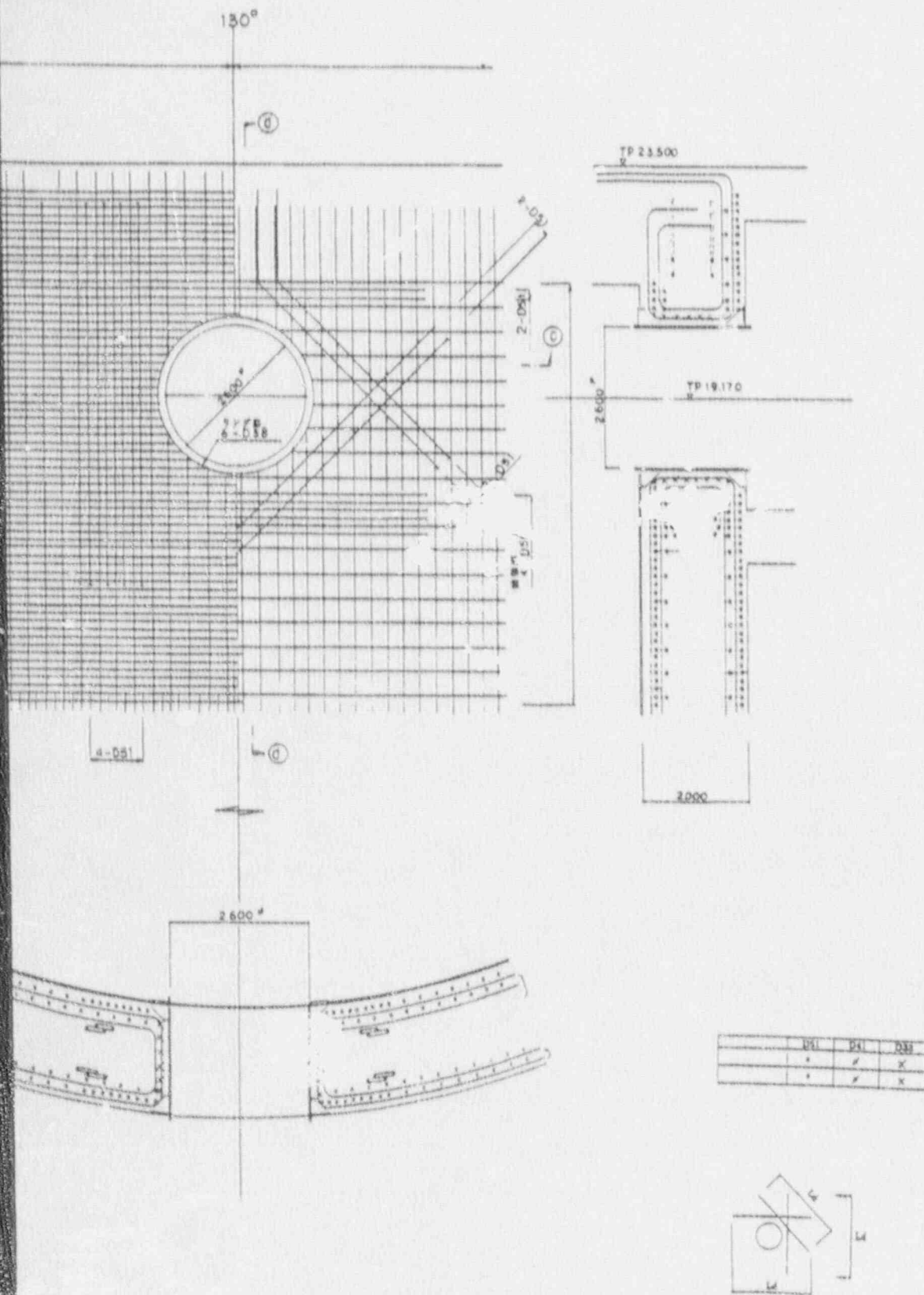

Figure 3H.3-1 CONTAINMENT STRUCTURE WALL REINFORCEMENT



SI
APERTURE
CARD

Also Available On
Aperture Card



UPL	DH	D3H
*	*	*
*	*	*

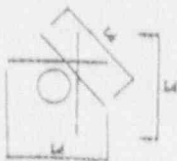

89-140-49

Figure 3H.3--2 CONTAINMENT STRUCTURE OPENING REINFORCEMENT

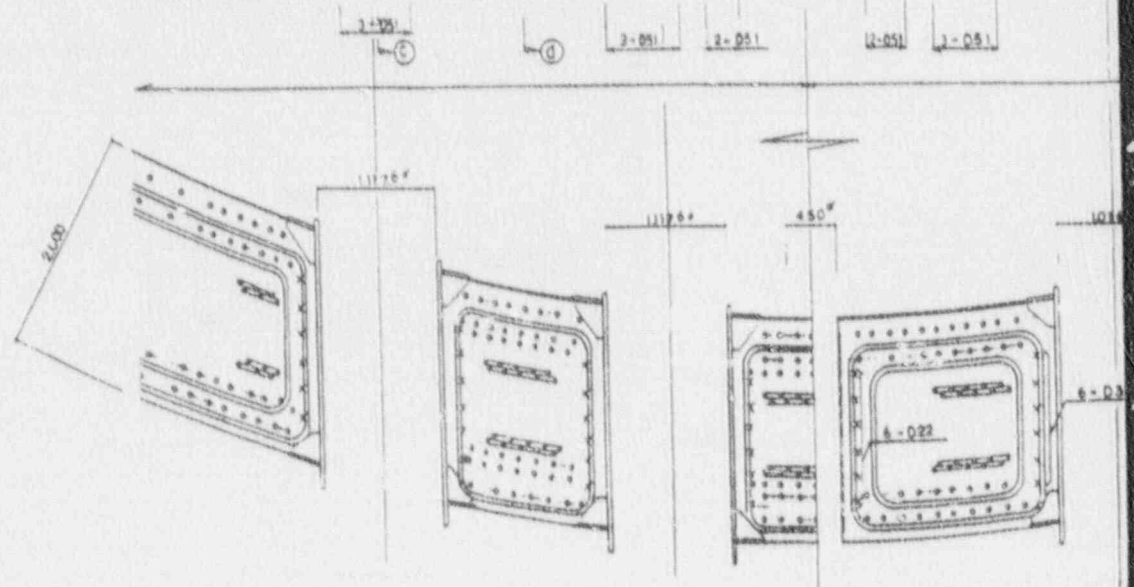
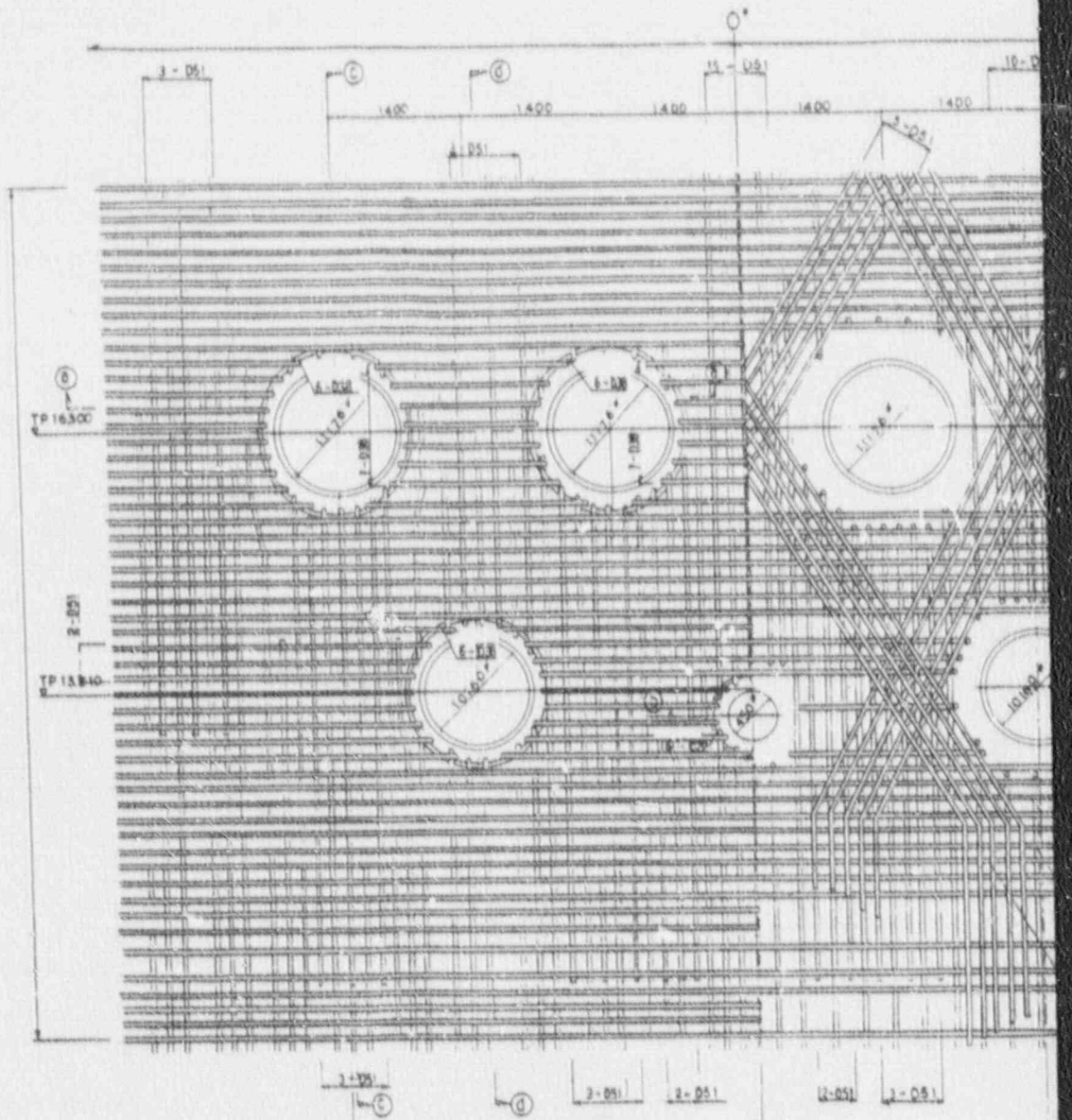

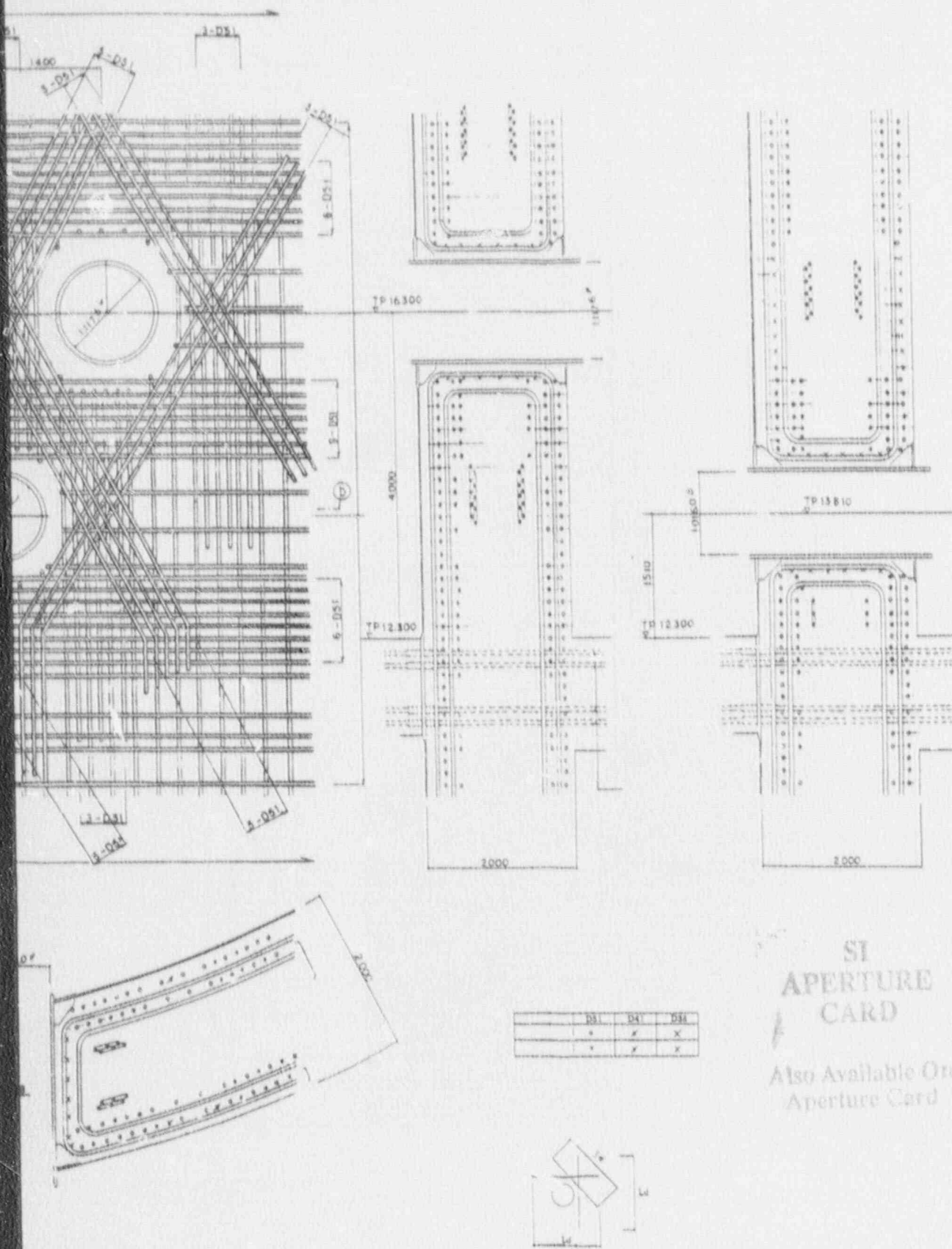

SI
APERTURE
CARD

Also Available On
Aperture Card

D31	D41	D44
*	x	x
*	x	x

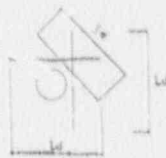

89-140-50

Figure 3H.3-3 CONTAINMENT STRUCTURE OPENING REINFORCEMENT

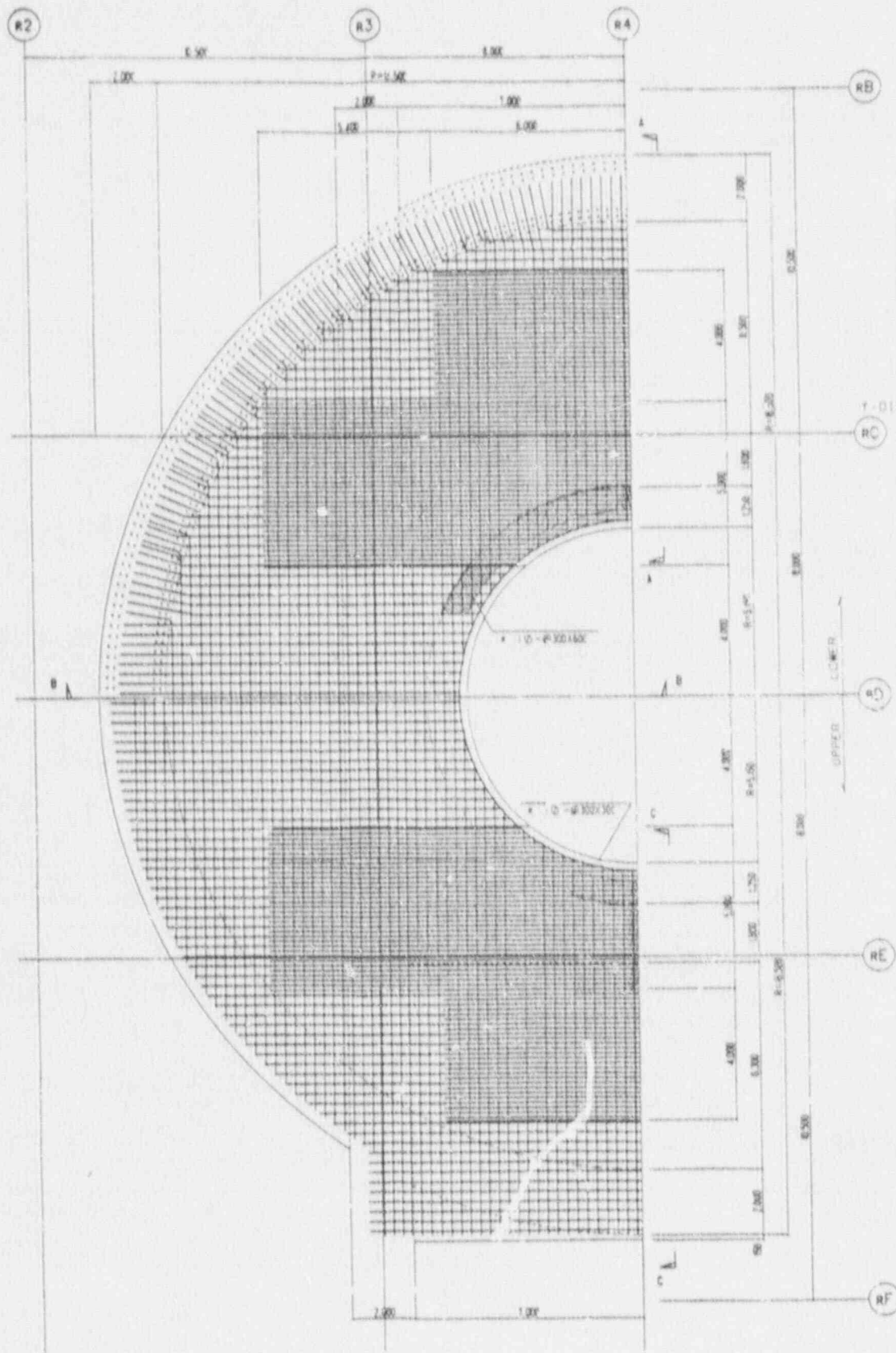

SECTION	Y-DIRECTION
A	
B	
OTHER	

X-DIRECTION

5.00

Y-DIRECTION

B

B

UPPER LOWER

REBAR A

DIRECTION	X-DIRECTION
14x1450	3x14x300
14x1450	
14x1450	
14x1450	

SECTION



KEY PLAN

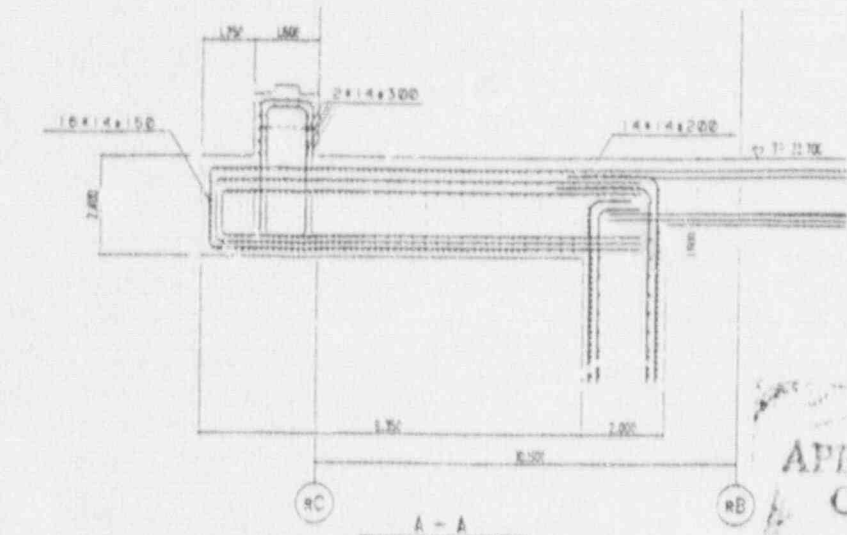

SI
APERTURE
CARD

Also Available On
Aperture Card

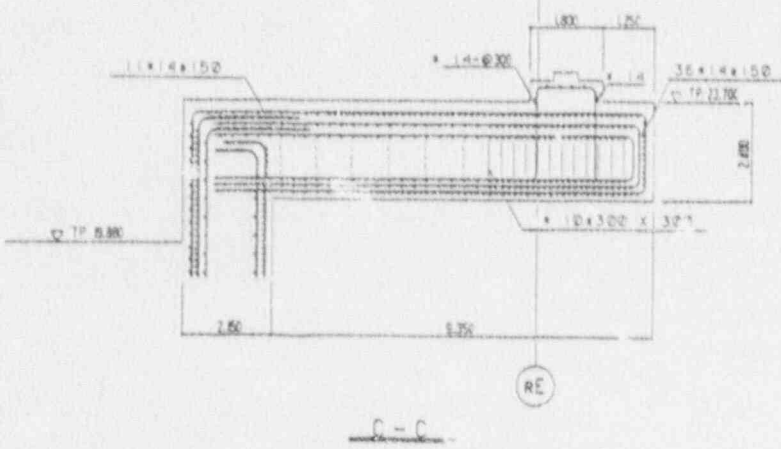
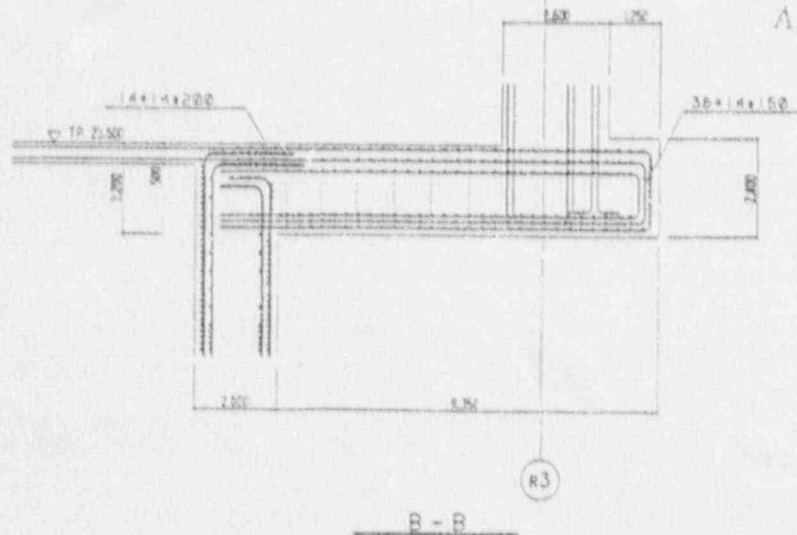

ARRANGEMENT OF RCCV TOP SLAB

B9-140-51

Figure 3H.3-4 CONTAINMENT STRUCTURE TOP SLAB REINFORCEMENT

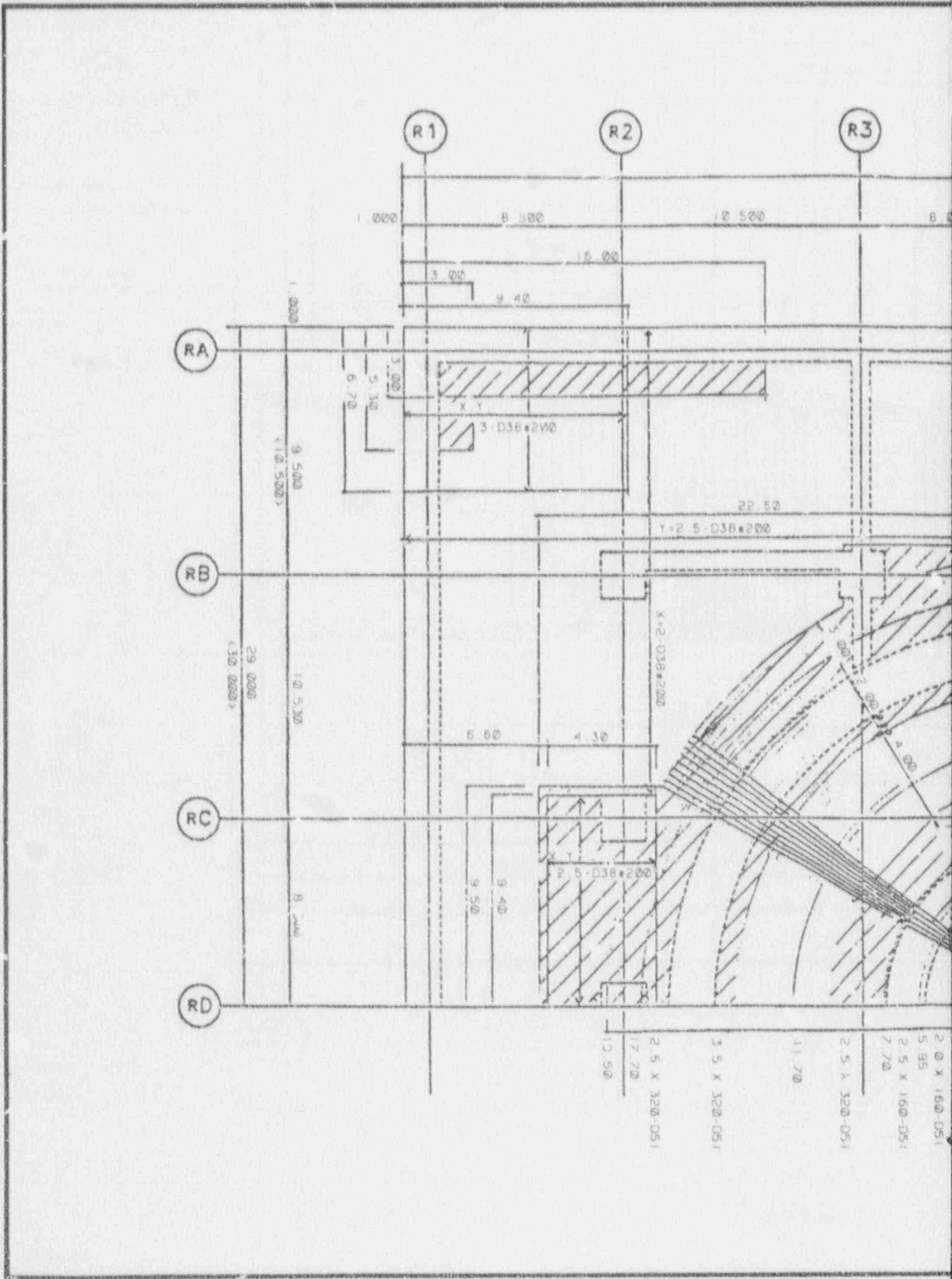

RA

RB

RC

RD

R1

R2

R3

1.000 8.500 12.500 8.000

3.000 15.000

4.40

1.000

3.000

5.300

6.700

9.500

10.500

29.000

30.000

22.50

Y=2-5-D38*200

X=2-D38*200

5.60

4.30

9.40

9.50

2-5-D38*200

1.500

17.70

2.5 X 320-051

3.5 X 320-051

11.70

2.5 X 320-051

7.70

2.5 X 160-051

5.95

2.0 X 160-051

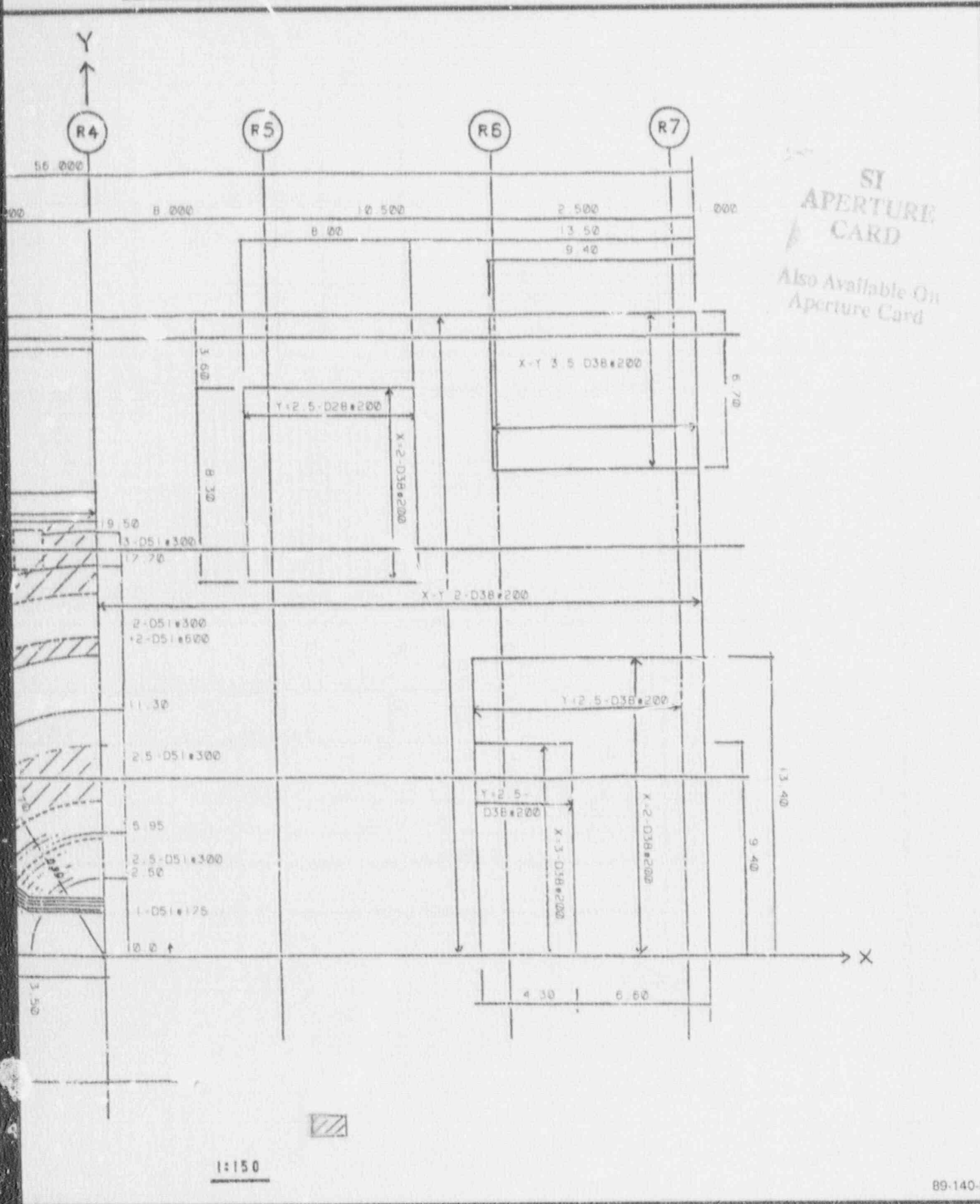

SI
APERTURE
CARD
Also Available On
Aperture Card

Figure 3H.3-5a REACTOR BUILDING FOUNDATION REINFORCEMENT - SHEET 1

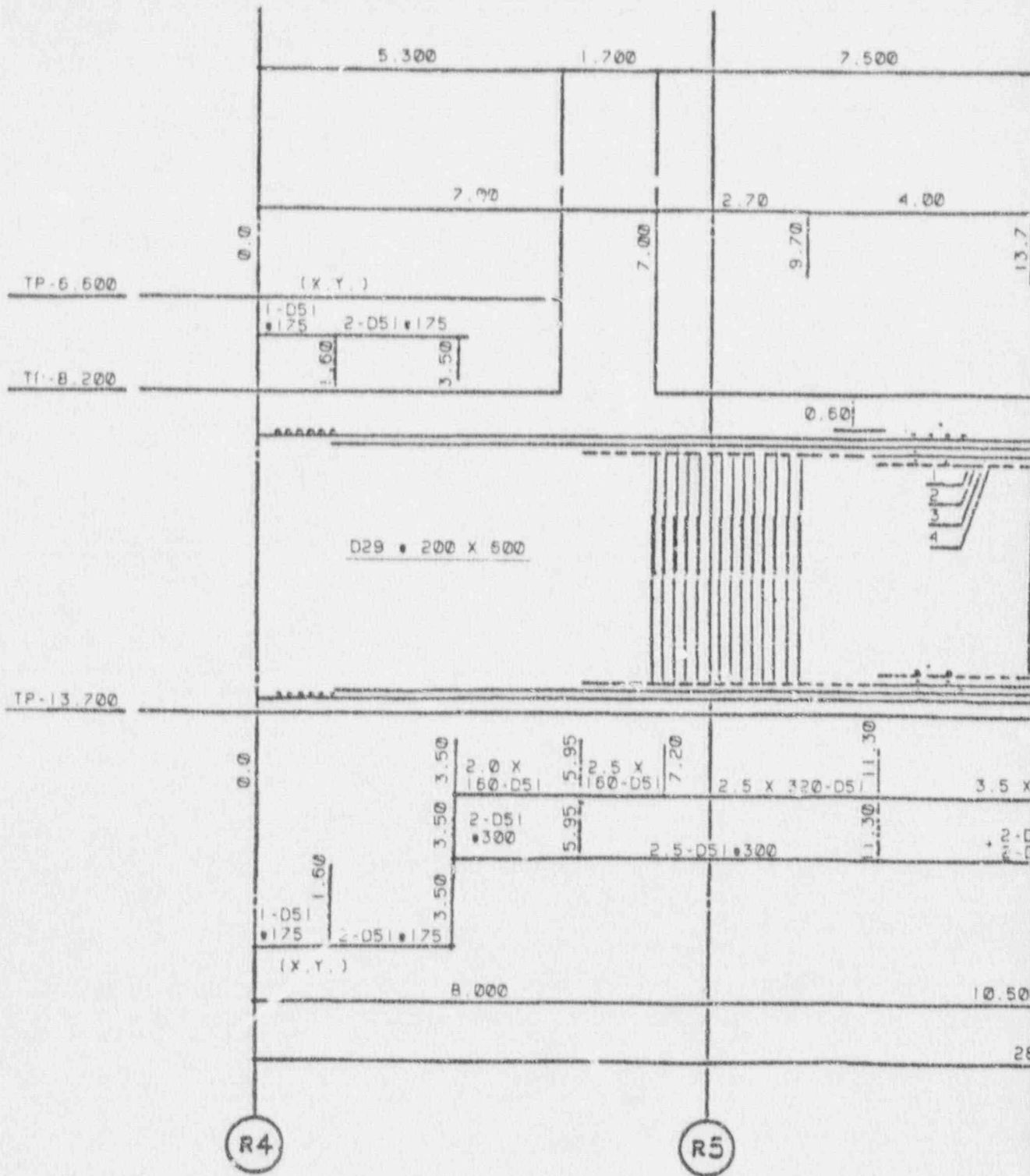

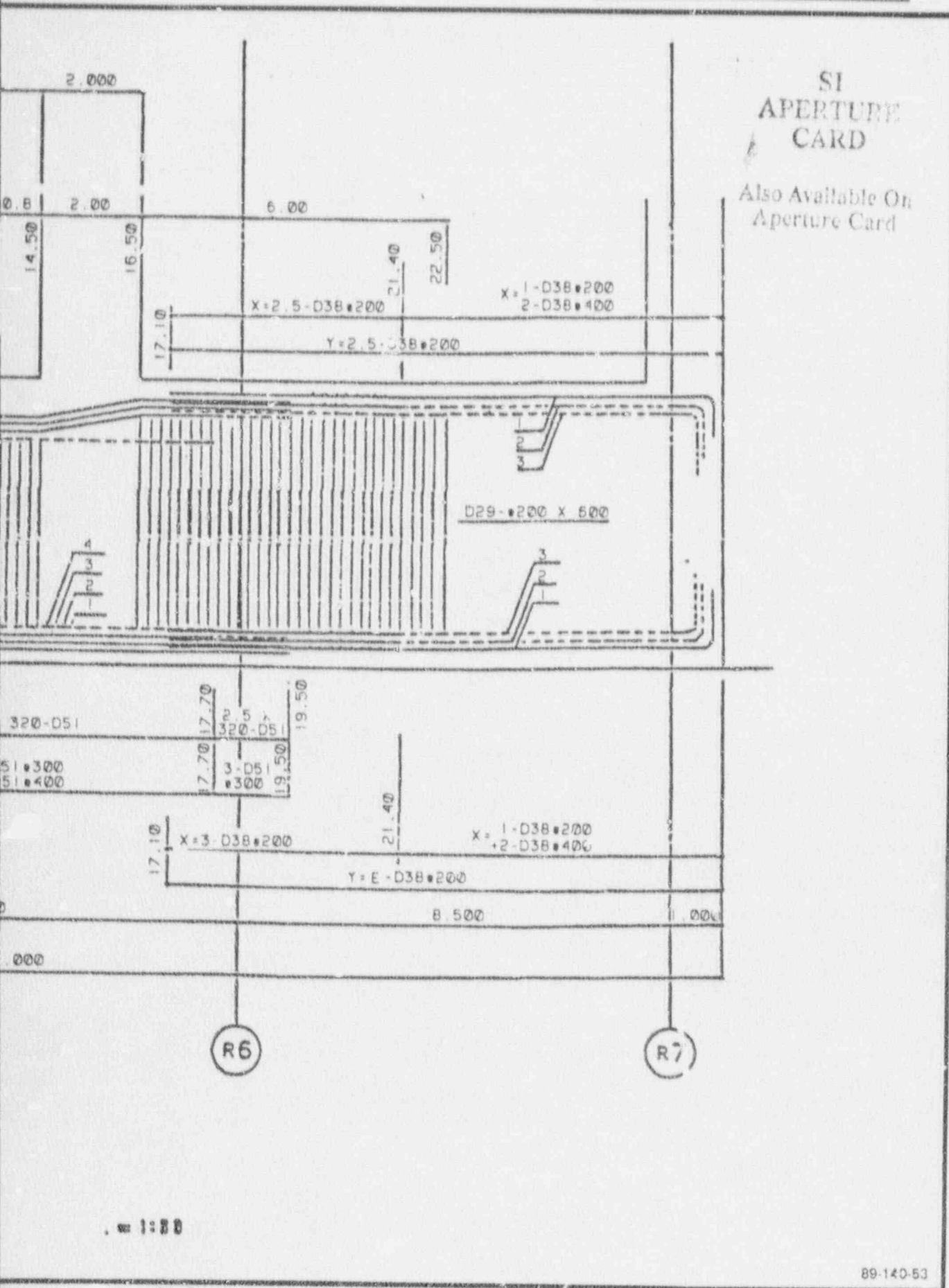
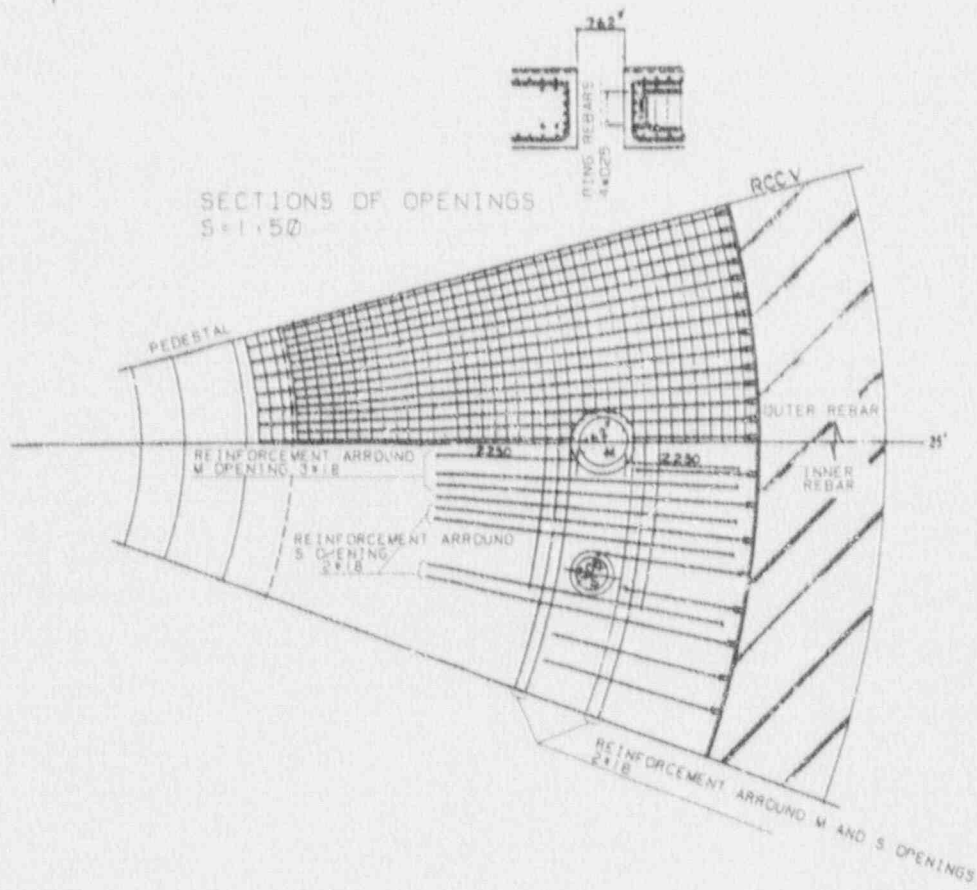
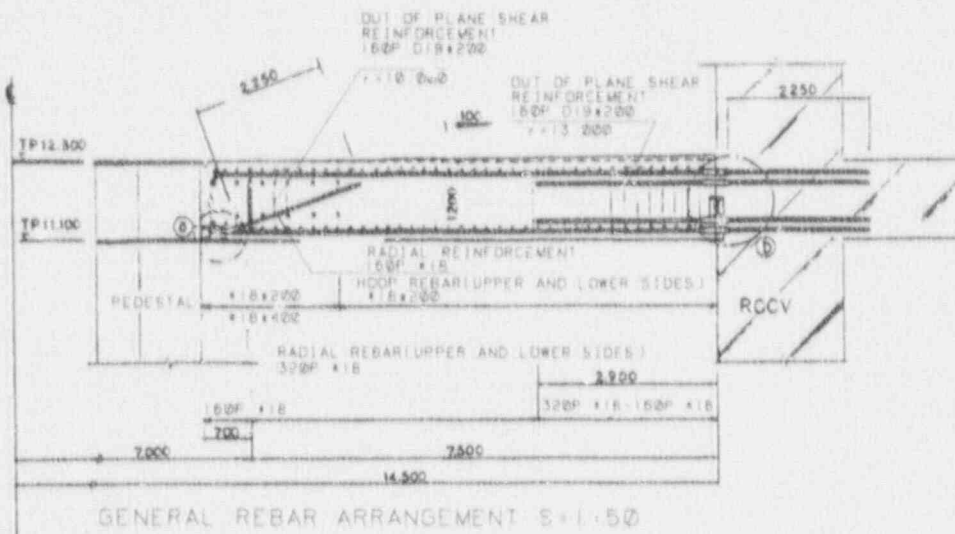
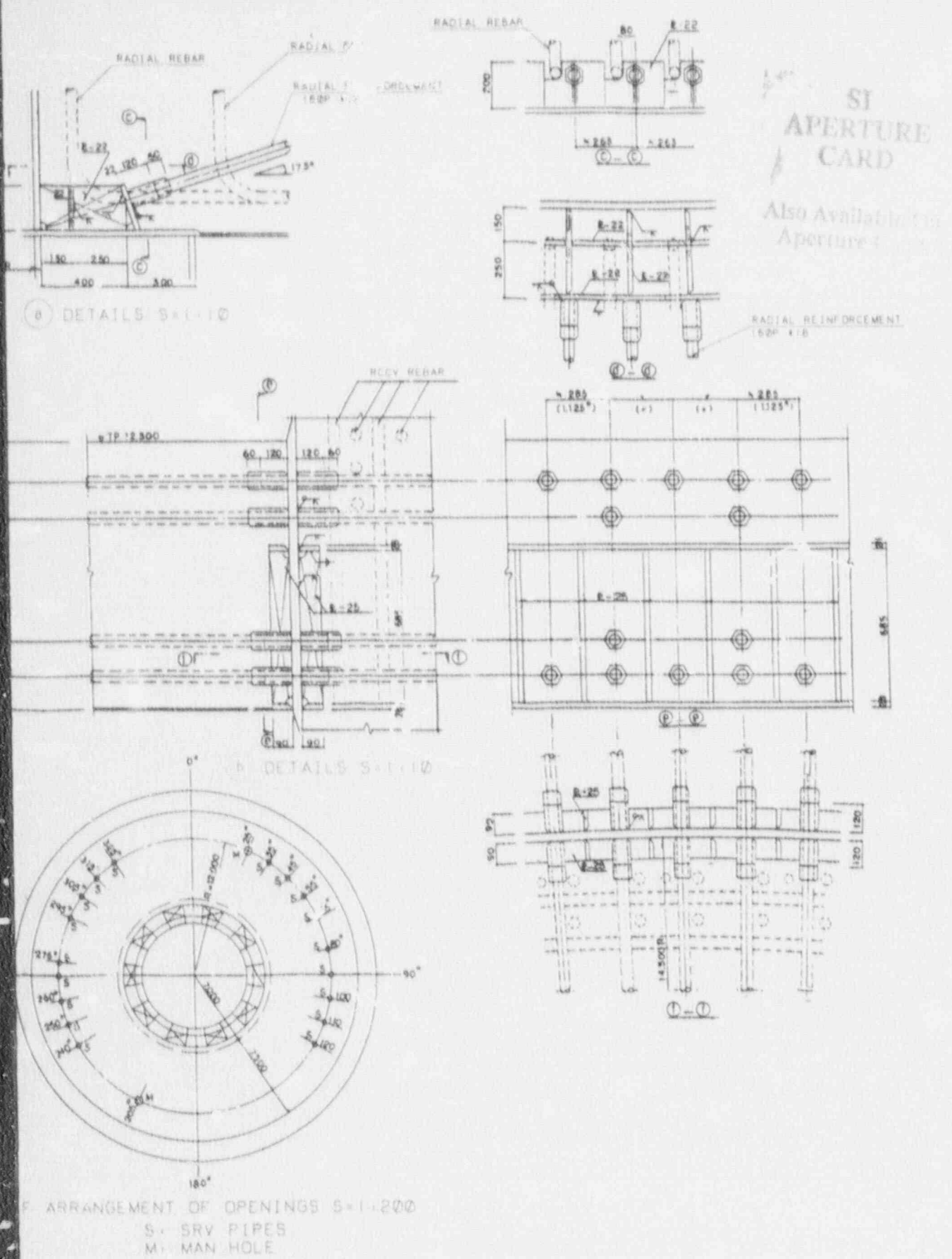

Figure 3H.3-5b REACTOR BUILDING FOUNDATION REINFORCEMENT - SHEET 2



REBAR ARRANGEMENT AROUND OPENINGS S=1.50



89-140-54

Figure 3H.3-7 DIAPHRAGM FLOOR REINFORCEMENT

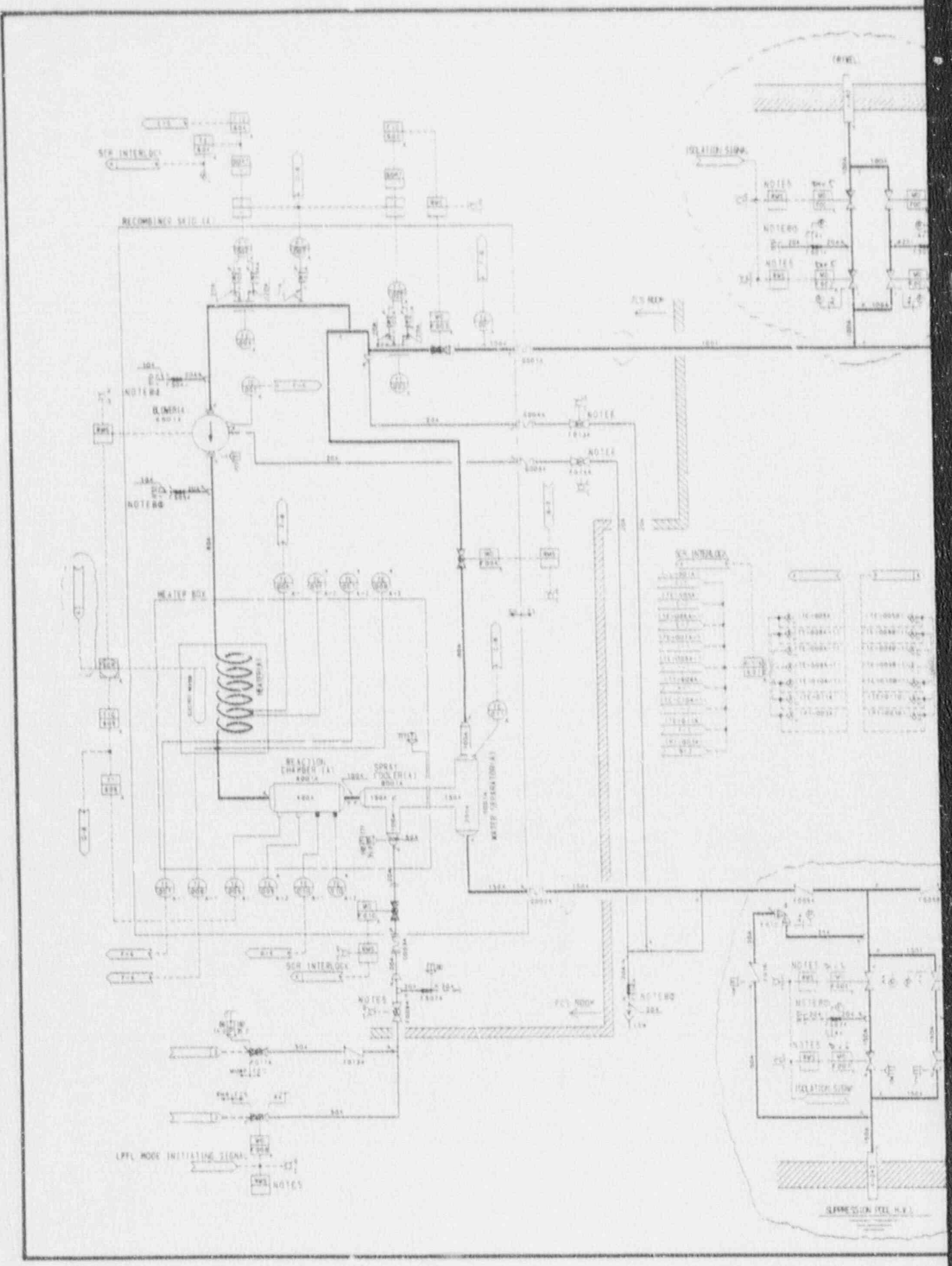

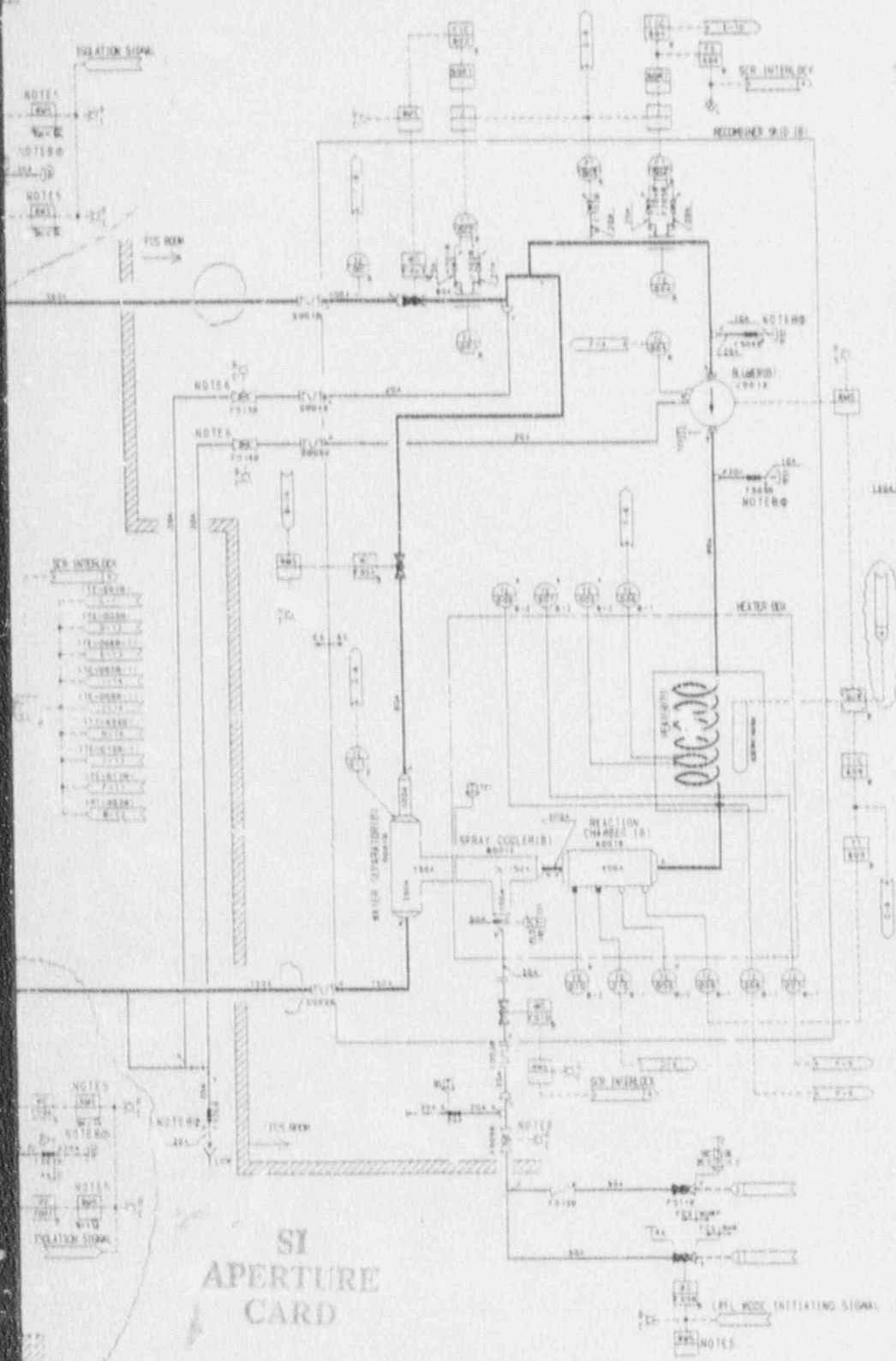

SYSTEM NO. T49
(FCS)

- (NOTES)
1. RECOMBINER SKIDS SHALL BE PORTABLE TYPE AND COMMON TO UNITS NO. 6 AND NO. 7.
 2. PIPING BETWEEN THE RV AND RECOMBINER SKIDS SHALL HAVE THE SLOPE AS FOLLOWS:
 - a. FROM SKIDWELL TO RECOMBINER SKIDS PIPING SHALL HAVE UP-SLOPE MORE THAN 1/100.
 - b. FROM RECOMBINER SKIDS TO SUPPRESSION Pools PIPING SHALL HAVE DOWN-SLOPE MORE THAN 1/100.
 3. TEMPERATURE ELEMENTS SHALL BE INSTALLED AS FOLLOWS:
 - a. INSERTED ON THE SURFACE.
 - b. A SPARE TEMPERATURE ELEMENT.
 4. U-BEND PIPING BY U-SHAPE SEALED SHALL HAVE THE HEIGHT AS FOLLOWS:
 - a. MIN. 7.5'
 - b. MIN. 1.0'

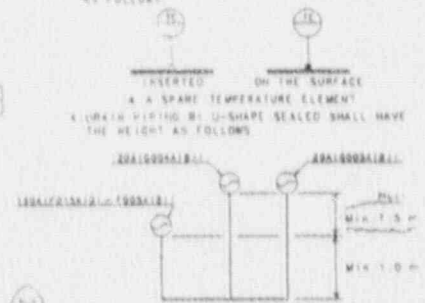

5. CLOSING SIGNAL SHALL BE OVERRIDDEN BY OVERRIDING SWITCHES.
 6. SI SHALL BE CHANGED TO CLOSE POSITION PRIOR TO CARRY OUT RECOMBINER SKIDS.
- THIS DRAWING SHOWS THE CASE WHICH BOTH OF PORTABLE RECOMBINER SKIDS (R) AND (S) ARE SET IN THIS STATION.
- THE DESIGN SPECIFICATIONS AS FOLLOWS SHALL BE APPLIED UNLESS OTHERWISE NOTED.

ITEM	APPLICATION
DESIGN PRESSURE (kg/cm ²)	3.18
DESIGN TEMPERATURE (°C)	121
PIPE MATERIAL	SS STAINLESS STEEL
	CS CARBON STEEL
PIPE WALL THICKNESS	85A AND OVER 5/8" X 40
	50A AND LESS 5/8" X 80
FLUID	H ₂ O/WATER
SEISMIC CATEGORY	A

7. DRAIN, VENT AND TEST:
 - a. WHEN PROCESS PIPING INSIDE THE PCV BOUNDARY.
 - b. WHEN PROCESS PIPING OUTSIDE THE PCV BOUNDARY.

9. REFERENCE DOCUMENTS
- 1. PIPING & INSTRUMENTS SYMBOLS D.A.O.
 - 2. RHP SYSTEM PAID.
 - 3. SUP SYSTEM NOTES.
 - 4. P&ID T-18-01

SI
APERTURE
CARD

Also Available On
Aperture Card

90-151-03

Figure 6.2-40 FLAMMABILITY CONTROL SYSTEM P&ID

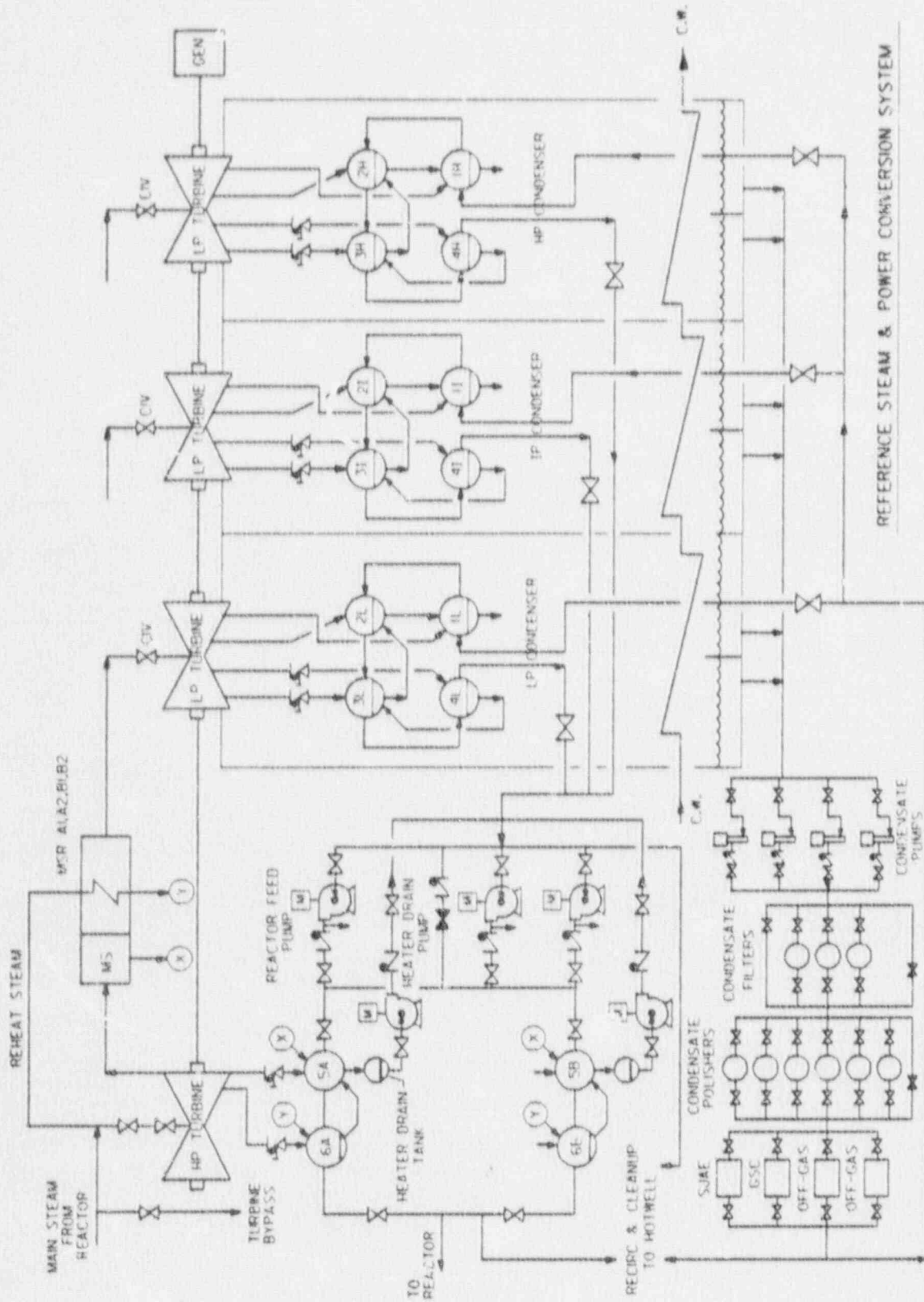
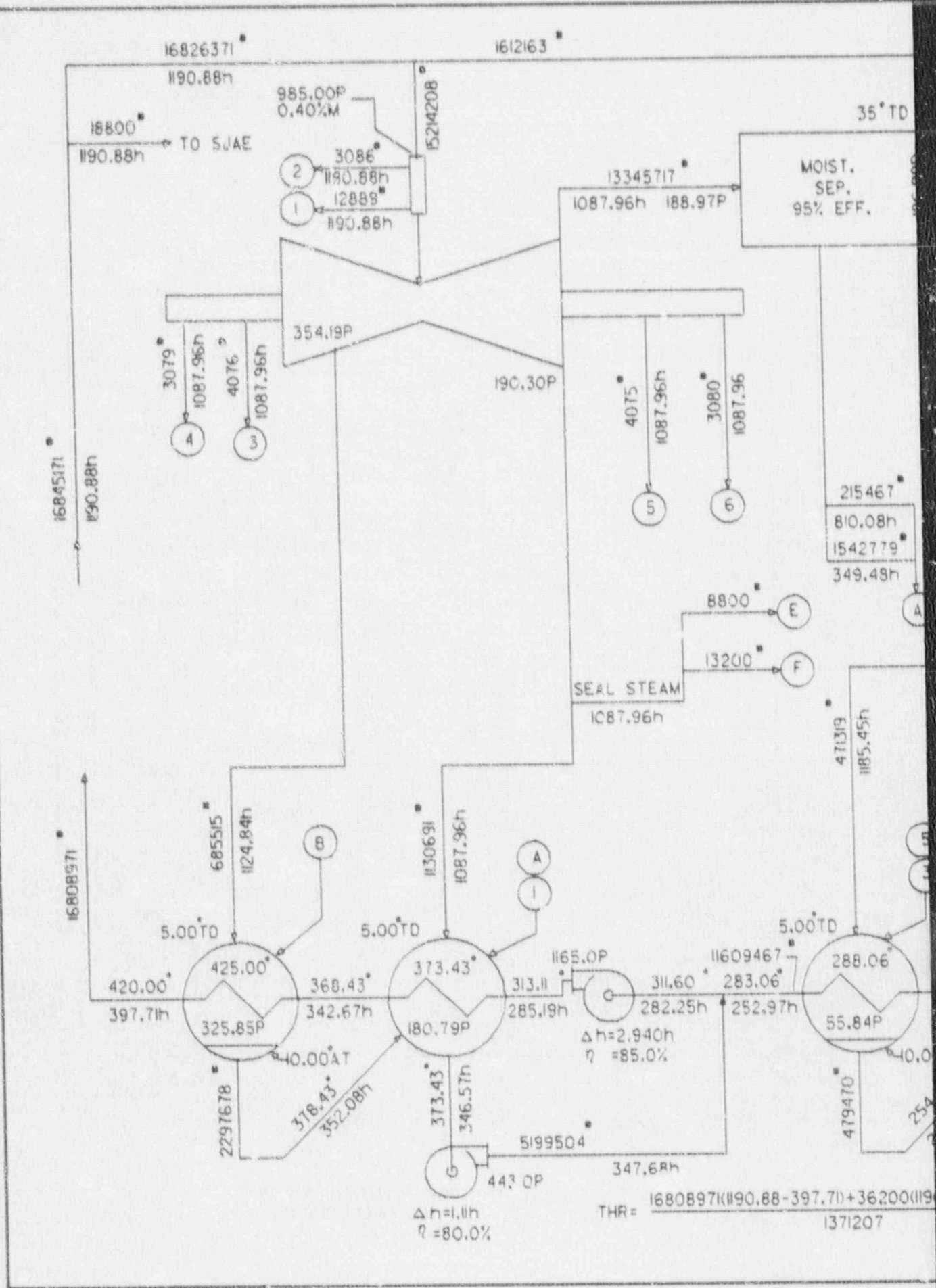

Figure 10.1--1 REFERENCE STEAM & POWER CONVERSION SYSTEM



ABWR
Standard Plant

23A6100AJ
Rev. A

APERTURE
CARD
Also Available On
Aperture Card

TURBINE: TC6F52 LSB
GENERATOR: 1620.2 MVA @ 0.90 pf

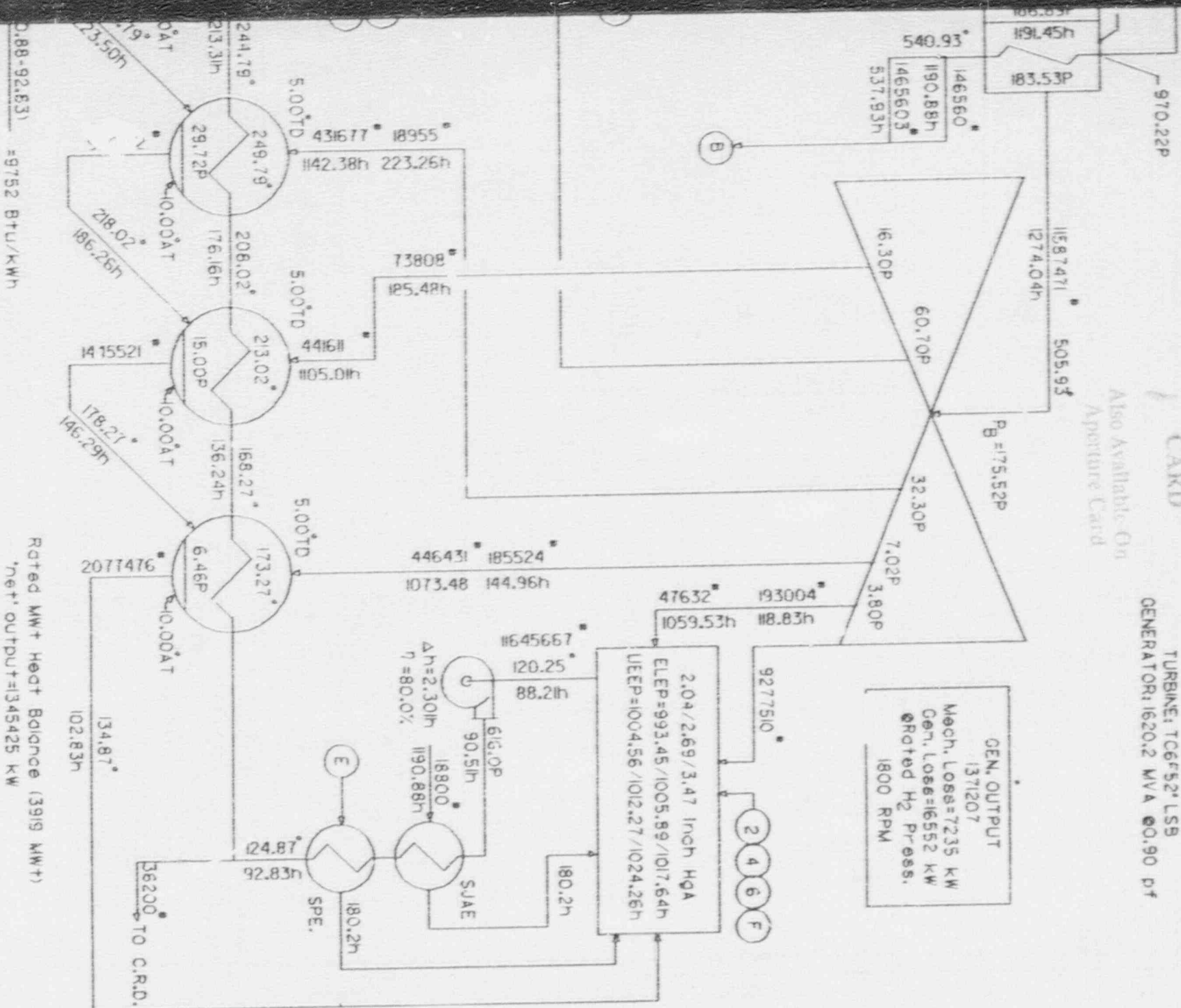

Figure 10.1-2 REFERENCE HEAT BALANCE FOR GUARANTEED REACTOR RATING

910140028-09

Amendment 7

10.1-8

89-242-03

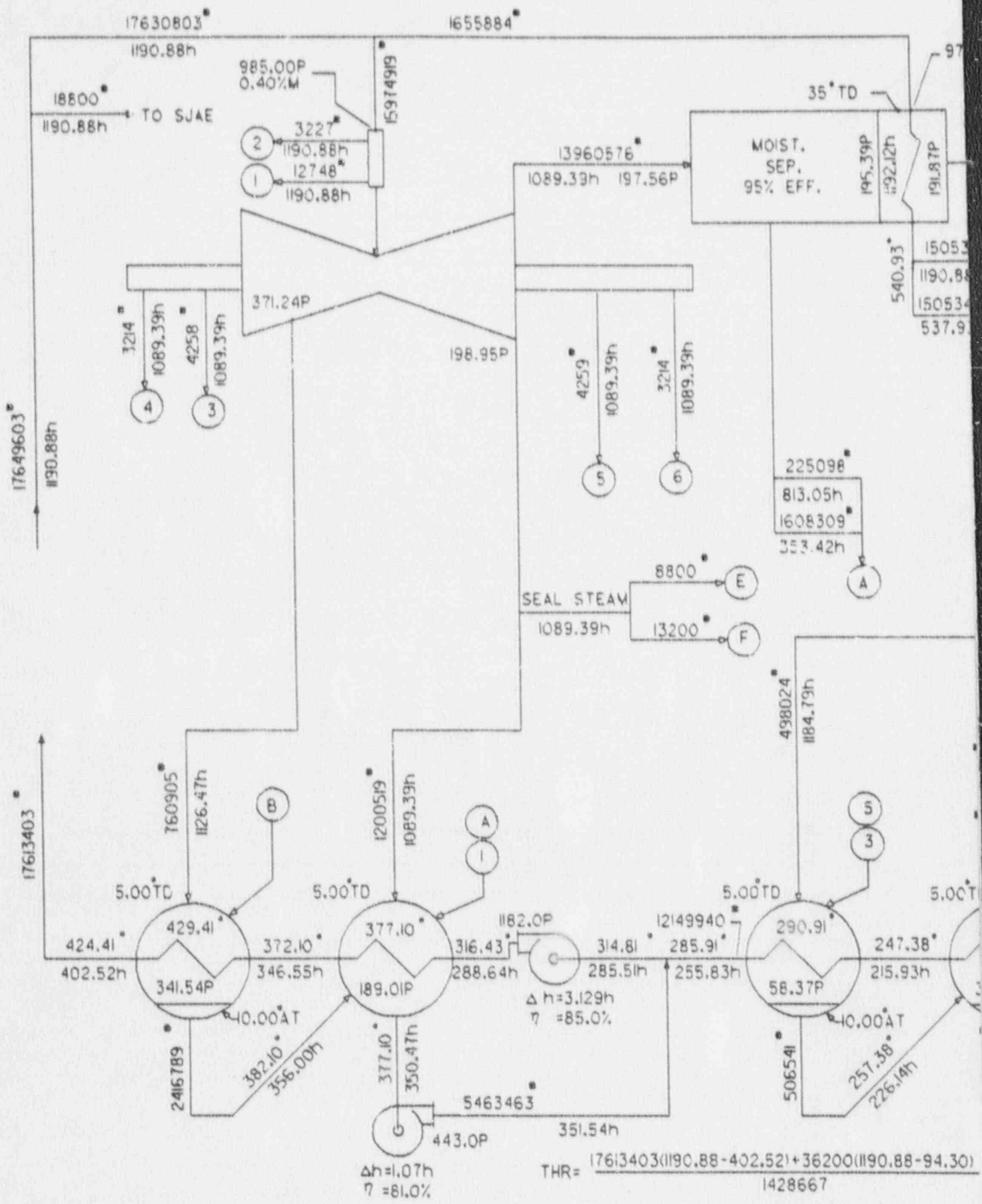

0.22P

TURBINE: TC6F52' LSB
GENERATOR: 1620.2 MVA @0.90 pf

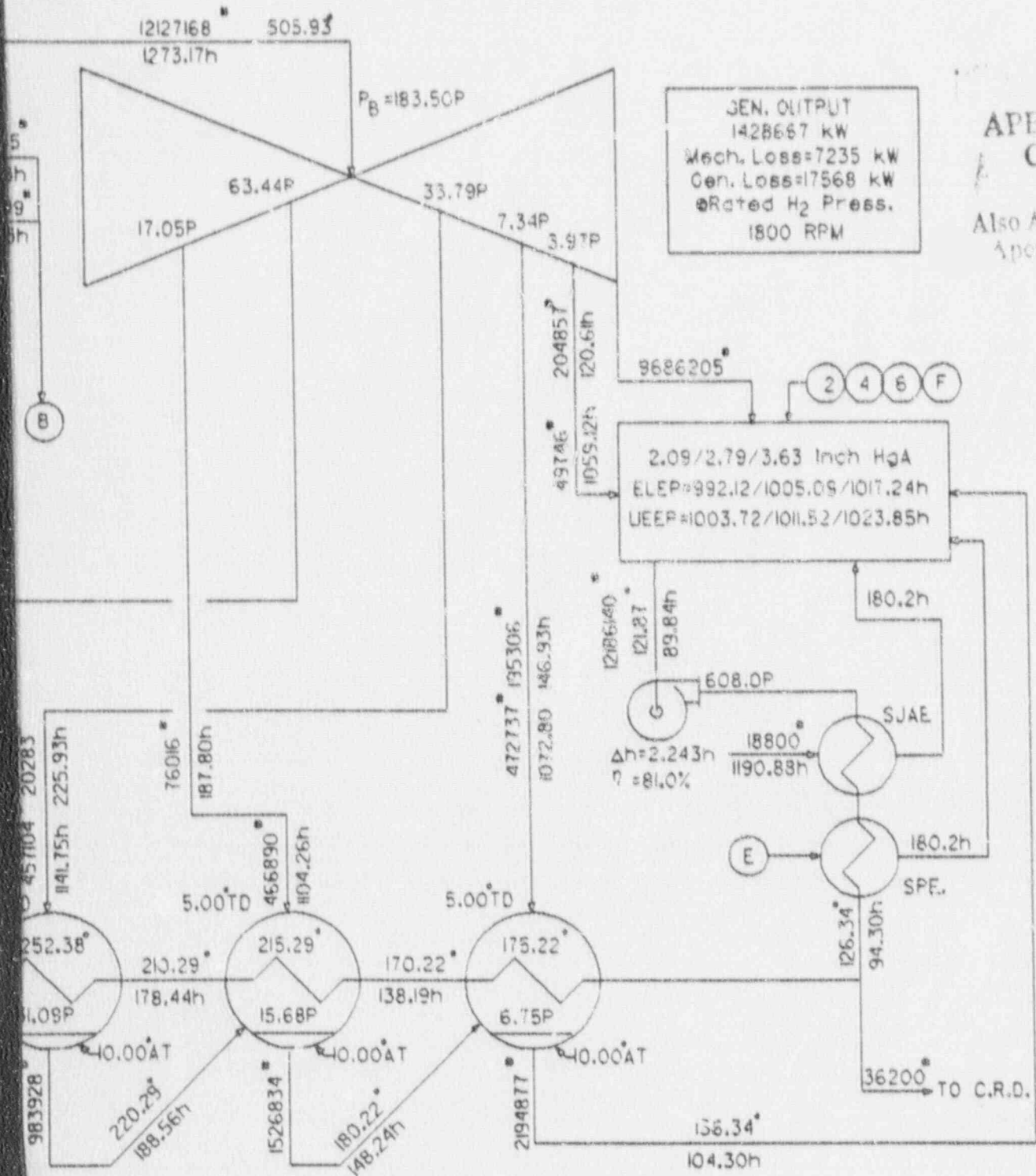

GEN. OUTPUT
1428667 kW
Mech. Loss=7235 kW
Gen. Loss=17568 kW
@Rated H₂ Press.
1800 RPM

SI
APERTURE
CARD
Also Available On
Aperture Card

=9747 Btu/kWh

VWO Heat Balance (4081.1MWt)
'net' output=1400873 kW

89-242-02

Figure 10.1-3 REFERENCE HEAT BALANCE FOR VALVES-WIDE-OPEN (VWO)

Amendment 7

9101140028-10

10.1-9