



Franklin
Medical Center

A Member of Baystate Health Systems

June 9, 1994

U.S. Nuclear Regulatory Commission
Region I
475 Allendale Road
King of Prussia, PA 19406-1415

RE: License No. 20-02399-01

Dear Sirs:

Please amend License No 20-02399-01 as follows:

Add the Cardiopulmonary Stress Lab to our Nuclear License
(room diagram enclosed).

Procedures related to this amendment are as follows:

- Radioisotope doses will be carried individually to the Stress Lab in a protective lead shield.
- The route of travel will be 25 feet from the ground floor Nuclear Medicine door to the elevator, via elevator to the 2nd floor, 25 feet from the elevation to the Stress Lab.
- The Stress Lab will be surveyed every day of use.
- The Stress Lab will be wipe tested weekly (4 areas designated on room diagram).
- Trigger levels for area surveys will be 5Mr/hr. Trigger levels for wipe tests will be 500 cpm.

Harlan J. Smith, President

BM/r=21H

Enclosure: Amendment Fee - \$500.00
Room Diagram

164 HIGH STREET, GREENFIELD, MASSACHUSETTS 01301
TELEPHONE (413) 772-0211

9406200139 940609
PCR ADDOCK 03001846
C PDR



FRANKLIN MEDICAL CENTER

A Member of Baystate Health Systems

June 9, 1994

License #: 20-02399-01

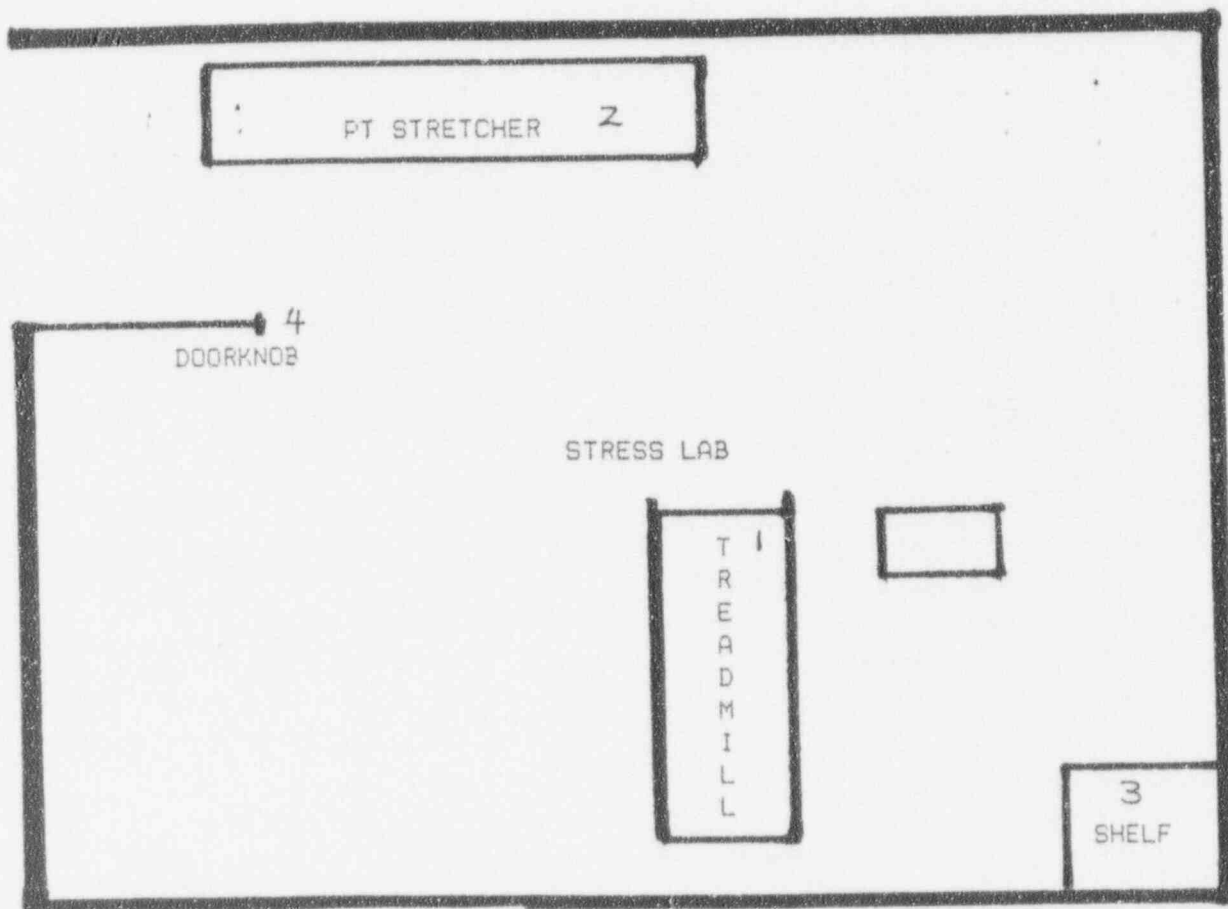

WIPE AREAS:

1. TREADMILL
2. STRETCHER
3. SHELF
4. DOORKNOB