

TWX INCOMING

TWX NR 04

PRIORITY

PRIORITY

U.S. ATOMIC ENERGY COMM.
TWX UNIT

FM ALICE M CORLEY USAEC OAK RIDGE TENN APRIL 58171415Z

TO LYALL JOHNSON USAEC WASH D C

1958 APR 17 PM 2 16

POCKET NO.

70-135
70-133
H. J. ...

CLEVITE RESEARCH CENTER, SNM-183, HAS SUBMITTED FOLLOWING SHIPPING INSTRUCTIONS FOR ORDER OF 8.090 KG. U-235 AS CAST METAL PIECES APPROXIMATELY 90 PER CENT ENRICHED SIMCLN /1/ USE AEC CONTAINERS, /1/ LOT OF 8.090 KG. U-235 SHOULD BE PACKAGED IN ONE CONTAINER, /3/ ONE SHIPMENT OF ONE CONTAINER, AND /4/ SHIP VIA RAILWAY EXPRESS - ARMED SURVEILLANCE. PLEASE ADVISE IF THESE INSTRUCTIONS ACCEPTABLE OR IF NOT, WHAT ARE APPROVED INSTRUCTIONS. PARA NUCLEAR MATERIALS & EQUIPMENT CORPORATION, SNM-145, HAS SUBMITTED FOLLOWING SHIPPING INSTRUCTIONS FOR 5.0 KG. U-235 AS 20 PERCENT ENRICHED UF6. /1/ TWO UF6 CYLINDERS PER SHIPMENT AND /2/ SHIP VIA RAILWAY EXPRESS - ARMED SURVEILLANCE. PLEASE ADVISE IF THESE INSTRUCTIONS ACCEPTABLE OR IF NOT, WHAT ARE APPROVED INSTRUCTIONS. END REF.ORS WEM TWX 04

70-135

END 58 APRIL 171910Z PLS ACK CK
RECD OK TU MM

TWX INCOMING

9402240202 580417
PDR ADOCK 07000133
C PDR

Handwritten signature

FUEL ELEMENT
STORAGE BIN 6"X6"X23"
10 BINS X 5 HIGH

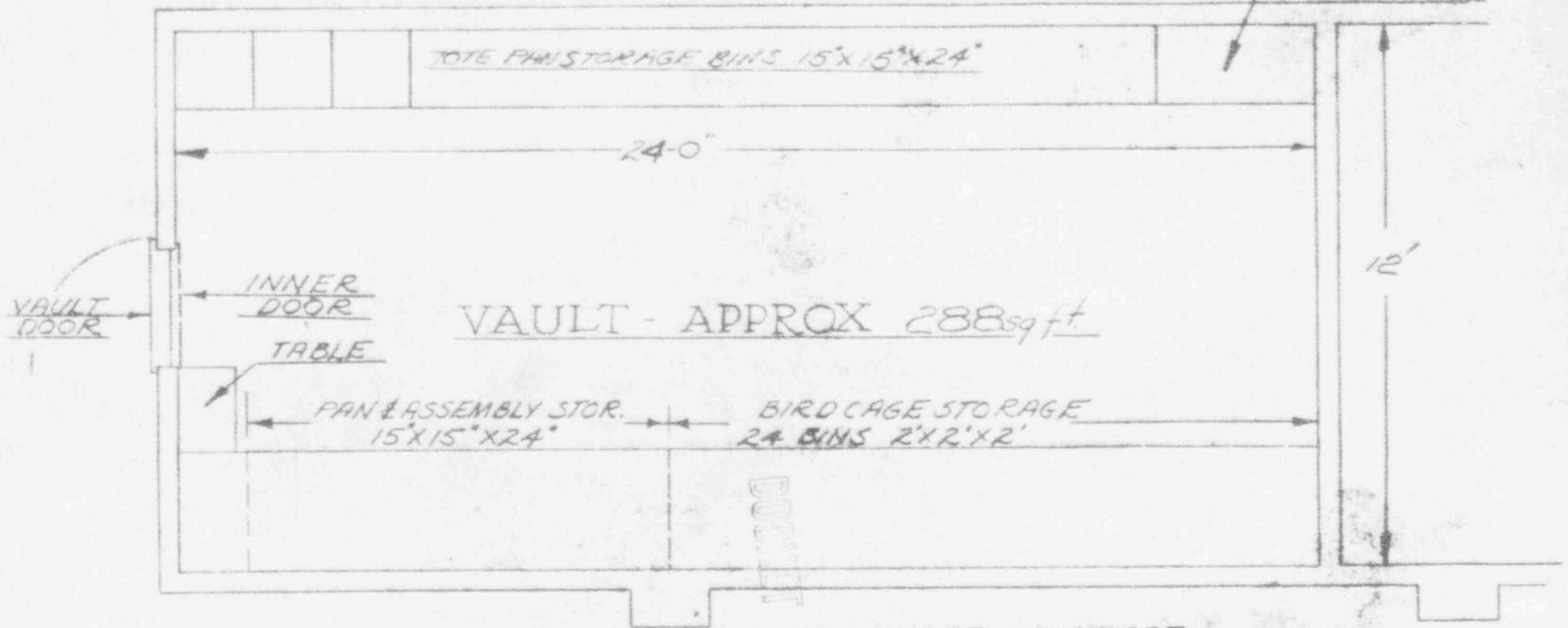

VAULT - APPROX 288sq ft

NOTE: VAULT ADT.
ALARMED

DOCUMENT NO. 70-133



REVISION	UNLESS OTHERWISE INDICATED		DATE 10-4-57	SCALE
	DIMENSIONS:	FRACTIONAL = ± 1/64 .XX = ± .018 .XXX = ± .008	ANGLES: ± 1/2°	DR. R Reeves CH. BY
CLEVITE RESEARCH CENTER DIVISION OF CLEVITE CORPORATION CLEVELAND, OHIO, U. S. A.	NAME VAULT DETAIL	MAT'L. SPEC.	APP. FOR PROD. BY	NO. A 560

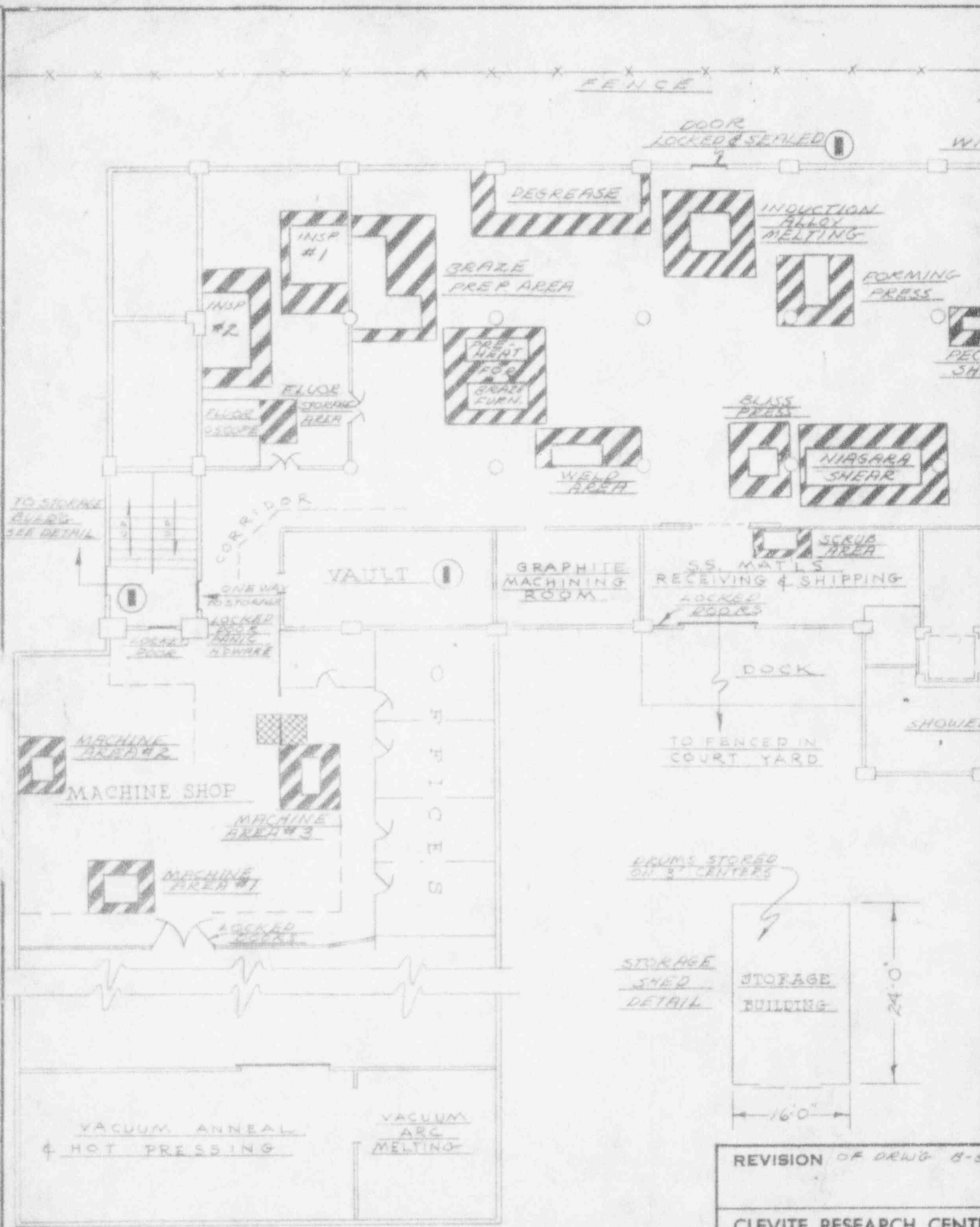



REVISION OF DRAWG B-5

CLEVITE RESEARCH CENTER
 DIVISION OF CLEVITE CORPORATION
 CLEVELAND, OHIO, U. S. A.

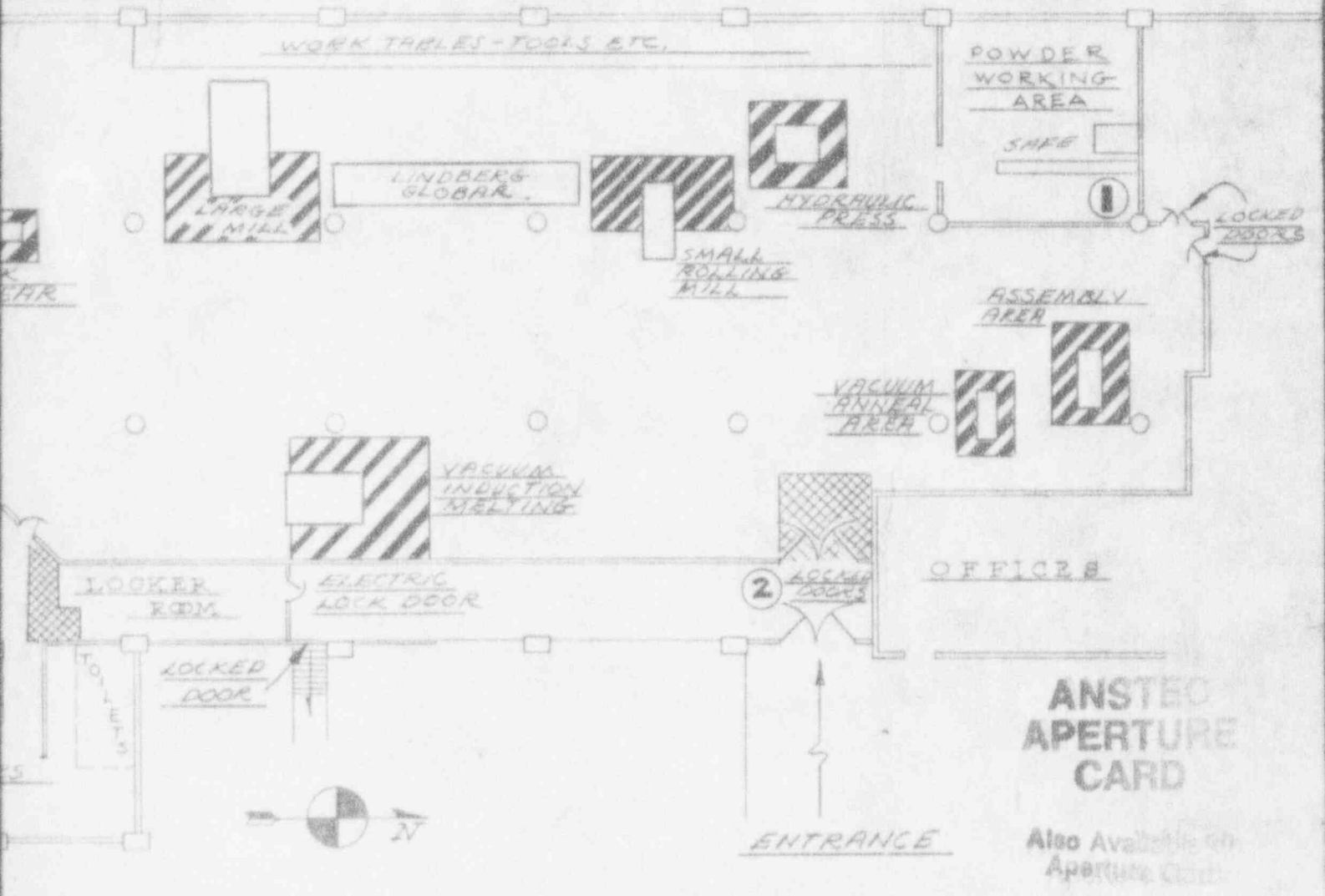
WINDOWS WELDED SHUT



- ① ADT 24 HOUR ALARM SYSTEM
- ② ARMED GUARD ON DUTY

-  OPERATIONAL CRITICALITY AREA
-  SHOE CHANGE AREA

TOTAL AREA ISOLATED & SECURED
ENTIRE BLDG COMPLETELY FENCED
24 HOUR GUARD ON DUTY
ALL DOORS WIRED TO CENTRAL LIGHT & BUZZER SYSTEM AT GUARD STATION

LOCKET NO. 70-133

9402240202-01

UNLESS OTHERWISE INDICATED		DATE 12-17-57	SCALE 1/6" = 1'-0"
DIMENSIONS:	FRACTIONAL = ± 1/64 XX = ± .015 XXX = ± .005	DR. R. Reeves	CH. BY
NAME METAL PRODUCTS PROCESSING AREA		APP. FOR PROD. BY	NO. B 523
MAT'L. SPEC.			

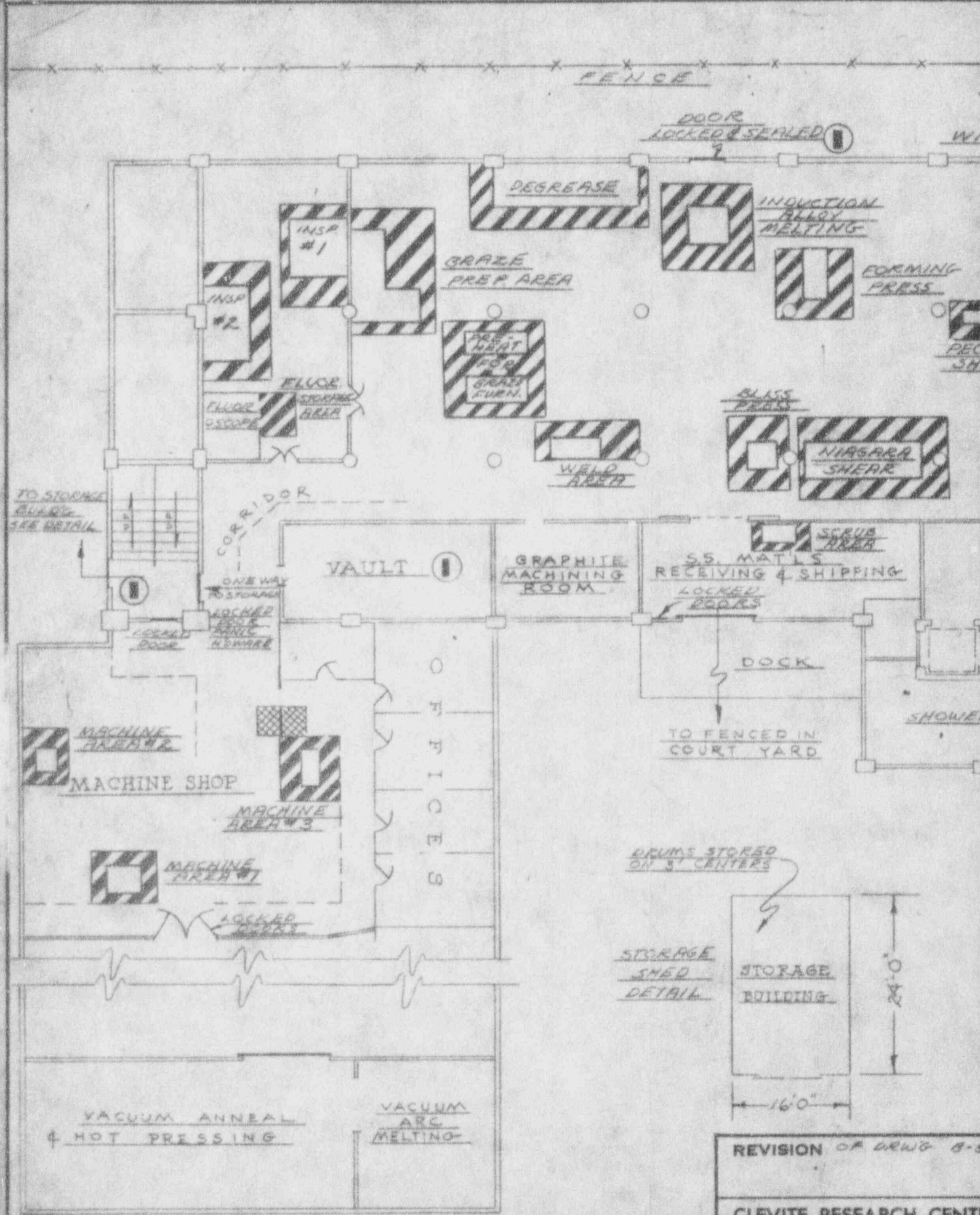

REVISION OF DRAWG B-5

CLEVITE RESEARCH CENTER
DIVISION OF CLEVITE CORPORATION
CLEVELAND, OHIO, U. S. A.

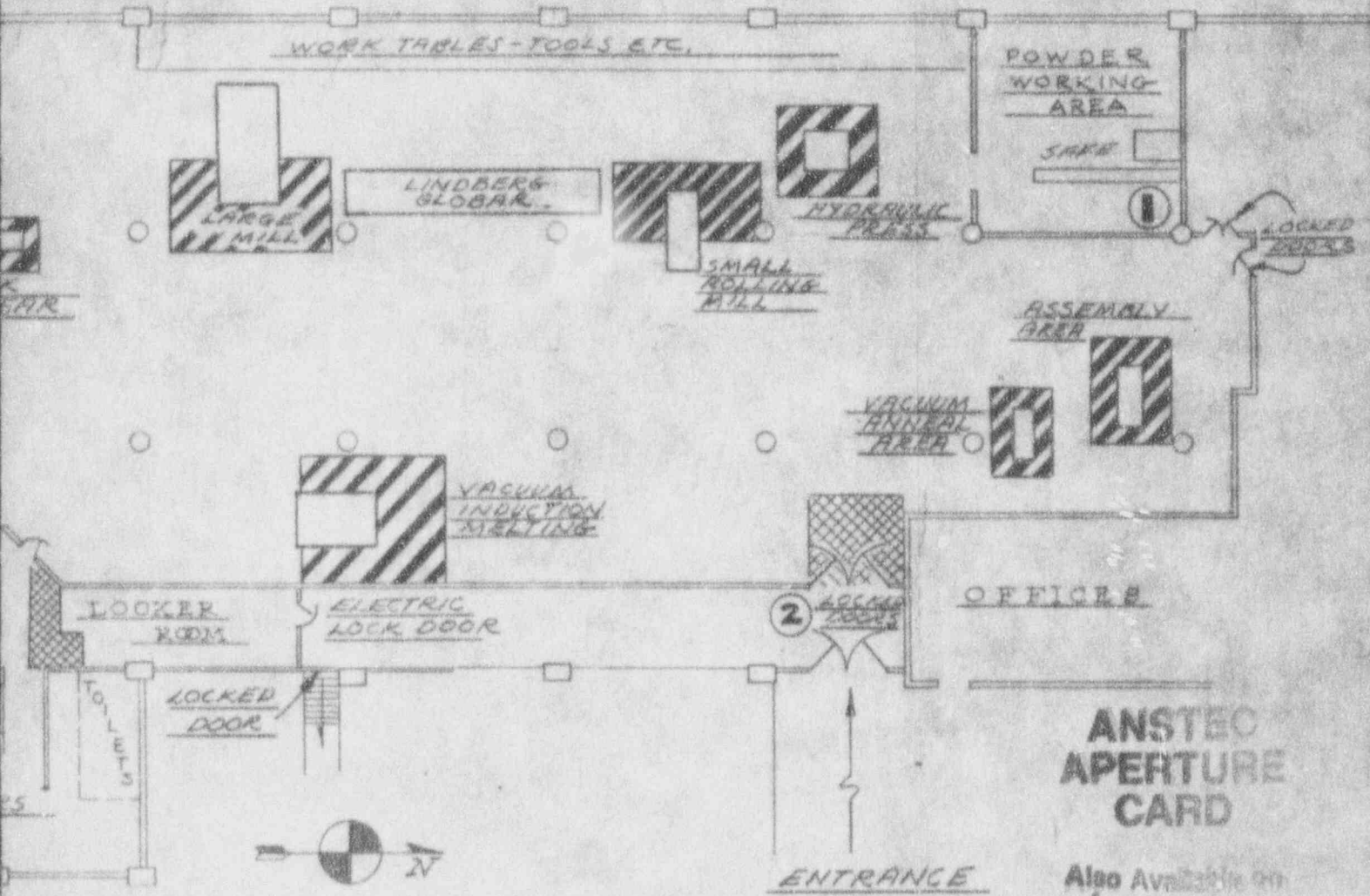

WINDOWS WELDED SHUT



ANSTEC APERTURE CARD

Also Available on Aperture Card

- ① A.D.T. 24 HOUR ALARM SYSTEM
- ② ARMED GUARD ON DUTY

-  OPERATIONAL CRITICALITY AREA
-  SHOE CHANGE AREA

9402240202-01

BUCKET NO. 70-133

TOTAL AREA ISOLATED & SECURED
ENTIRE BLDG COMPLETELY FENCED
24 HOUR GUARD ON DUTY
ALL DOORS WIRED TO CENTRAL LIGHT & BUBBER SYSTEM AT GUARD STATION

DIMENSIONS: UNLESS OTHERWISE INDICATED FRACTIONAL = ± 1/64 .XX = ± .018 .XXX = ± .008	ANGLES: ± 1/2° SURFACE: MAX.	DATE 12-17-57 SCALE 1/16" = 1'-0"
		DR. R. Reeves BY CN. BY
NAME METAL PRODUCTS PROCESSING AREA MAT'L. SPEC.	APP. FOR PROD. BY	NO. B 523

**OVERSIZE
DOCUMENT
PAGE PULLED**

SEE APERTURE CARDS

NUMBER OF OVERSIZE PAGES FILMED ON APERTURE CARDS 1

9402240204

APERTURE CARD/HARD COPY AVAILABLE FROM
RECORDS AND REPORTS MANAGEMENT BRANCH