

# METROPOLITAN EDISON COMPANY

Subsidiary of General Public Utilities Corporation

*IE Inspection*

Subject NRC INSPECTION 80-06 MONTHLY EXIT  
APRIL 3, 1980

Location TMI NUCLEAR STATION

Date APRIL 7, 1980

To DISTRIBUTION

The formal exit for the period March 1, 1980 to March 31, 1980 was conducted on April 3, 1980 in the Unit 1 General Conference Room with the following attendees:

J. G. Herbein - Met-Ed  
G. P. Miller - Met-Ed  
G. J. Troffer - Met-Ed  
N. C. Kazanas - GPU  
J. Fritzen - GPU  
B. Ballard - GPU  
T. Faulkner - Met-Ed

J. Fornicola - GPU  
M. R. Shaffer - Met-Ed  
L. W. Harding - Met-Ed  
D. Haverkamp - NRC  
L. Gage - NRC  
P. Koltai - NRC  
T. Fasano - NRC

The areas of inspection and results are as follows:

1. GAI - Region 4 Inspection

- A. Per GPU QA Audit, GAI is not using GP-1008  
Item Unresolved ACTION: Slear/Kazanas
- B. GAI did not conduct quarterly review on  
structural area for design verification.  
Item Unresolved. ACTION: Slear/Kazanas
- C. GAI has not properly stamped safety related  
drawings as dictated by GPU.  
Item Unresolved. ACTION: Slear
- D. GAI is not using the Restart Book as the design  
basis for ECM's.  
Unresolved Item. ACTION: Slear
- E. GPU has failed to properly identify ECM's as QA  
scope in some safety related areas.  
i.e. - the reviewing engineer is not  
checking QA required block when a pur-  
chase requisition is marked QA specs.  
Item Unresolved. ACTION: Slear/Kazanas

2. GPU - QA Audit of GAI - L. Gage - Inspector  
No unresolved items except as noted in 1.A.

ATTACHED IS INTERNAL  
MET-ED CORRESPONDENCE  
NOT PDR INFO

cc: J. Collins

A. Fasano  
R. Keimig (RI)  
L. Bettenhausen (RI)  
S. Ebnetter (RI)  
L. Gage (RI)

8211180141 800407  
PDR ADOCK 05000289  
Q PDR

INTER-OFFICE MEMORANDUM

*TMI-80-226*

APRIL 7, 1980

3. Fire Protection - P. Koltai Inspector

- A. NM-40 - No QA audit of this task. NRC needs additional backup information on this item for resolution.

Item Unresolved.

ACTION: NRC

4. Fire Drill conducted with local fire companies (March 8, 1980) - P. Koltai Inspector

- Equipment usage was sometimes improper - i.e. the number of men operating fire hose was inadequate.
- Proper equipment not always brought to scene - i.e. no emergency lighting.
- Delays occurred in getting outside fire departments to scene caused by poor TLD issue procedure and inadequate security access measures.
- There was a command post - 9.5-1 appendix should be addressed.
- There was a general lack of HP Training for offsite fire department personnel.
- The fire brigade requires additional training and practice.

Unresolved Item (1 item)

ACTION: O'Conner

5. Mechanical/ISI Inspection - W. Sanders Inspector

- A. RM-14 HPI Crossconnect - weld MU-45 was observed to have paint and tape attached. The tracability of these materials was unclear.

Item Unresolved.

ACTION: J. Wright

- B. NM-17 - IGSCC - Weld #40. The NRC needs additional information on location and sizing analysis.

Item Unresolved.

ACTION: J. Fornicola

- C. ISI area contained 8 items concerning administrative changes to the ISI PORD were previously discussed with QA.

Item Unresolved.

ACTION: J. Fornicola

APRIL 7, 1980

The areas to be inspected the week of April 7, 1980 will be as follows:

Electrical - Paolino  
Fire Protection (NM-40) - Koltai  
Mechanical/ISI - Sanders  
Concrete Pad Pours - Verella

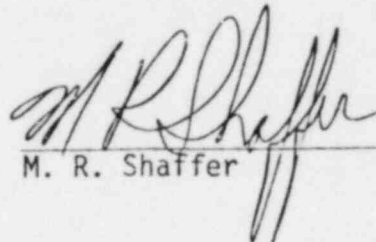

M. R. Shaffer

MRS/jl

cc: Attendees  
Action Parties  
T. M. Hawkins - SU/T  
C. E. Hartman - PORC Chairman for review with PORC as applicable.  
J. J. Colitz  
D. Dyckman  
M. J. Ross  
D. M. Shovlin  
R. S. Harbin  
R. J. Toole

# METROPOLITAN EDISON COMPANY

Subsidiary of General Public Utilities Corporation

*File IFE Inspection Reports*

*MEMO*

Subject NRC INSPECTION 80-06 MONTHLY EXIT  
APRIL 3, 1980

Location TMI NUCLEAR STATION

Date APRIL 7, 1980

To DISTRIBUTION

The formal exit for the period March 1, 1980 to March 31, 1980 was conducted on April 3, 1980 in the Unit 1 General Conference Room with the following attendees:

J. G. Herbein - Met-Ed	J. Fornicola - GPU
G. P. Miller - Met-Ed	M. R. Shaffer - Met-Ed
G. J. Troffer - Met-Ed	L. W. Harding - Met-Ed
N. C. Kazanas - GPU	D. Haverkamp - NRC
J. Fritzen - GPU	L. Gage - NRC
B. Ballard - GPU	P. Koltai - NRC
T. Faulkner - Met-Ed	T. Fasano - NRC

The areas of inspection and results are as follows:

1. GAI - Region 4 Inspection

- A. Per GPU QA Audit, GAI is not using GP-1008  
Item Unresolved ACTION: Slear/Kazanas
- B. GAI did not conduct quarterly review on  
structural area for design verification.  
Item Unresolved. ACTION: Slear/Kazanas
- C. GAI has not properly stamped safety related  
drawings as dictated by GPU.  
Item Unresolved. ACTION: Slear
- D. GAI is not using the Restart Book as the design  
basis for ECM's.  
Unresolved Item. ACTION: Slear
- E. GPU has failed to properly identify ECM's as QA  
scope in some safety related areas.  
i.e. - the reviewing engineer is not  
checking QA required block when a pur-  
chase requisition is marked QA specs.  
Item Unresolved. ACTION: Slear/Kazanas

2. GPU - QA Audit of GAI - L. Gage - Inspector  
No unresolved items except as noted in 1.A.

3. Fire Protection - P. Koltai Inspector

- A. NM-40 - No QA audit of this task. NRC needs additional backup information on this item for resolution.  
Item Unresolved. ACTION: NRC

4. Fire Drill conducted with local fire companies (March 8, 1980) - P. Koltai Inspector

- Equipment usage was sometimes improper - i.e. the number of men operating fire hose was inadequate.
- Proper equipment not always brought to scene - i.e. no emergency lighting.
  - Delays occurred in getting outside fire departments to scene caused by poor TLD issue procedure and inadequate security access measures.
  - There was a command post - 9.5-1 appendix should be addressed.
  - There was a general lack of HP Training for offsite fire department personnel.
  - The fire brigade requires additional training and practice.

Unresolved Item (1 item)

ACTION: O'Conner

5. Mechanical/ISI Inspection - W. Sanders Inspector

- A. RM-14 HPI Crossconnect - weld MU-45 was observed to have paint and tape attached. The tracability of these materials was unclear.  
Item Unresolved. ACTION: J. Wright
- B. NM-17 - IGSCC - Weld #40. The NRC needs additional information on location and sizing analysis.  
Item Unresolved. ACTION: J. Fornicola
- C. ISI area contained 8 items concerning administrative changes to the ISI PORD were previously discussed with QA.  
Item Unresolved. ACTION: J. Fornicola

The areas to be inspected the week of April 7, 1980 will be as follows:

Electrical - Paolino  
Fire Protection (NM-40) - Koltai  
Mechanical/ISI - Sanders  
Concrete Pad Pours - Verella

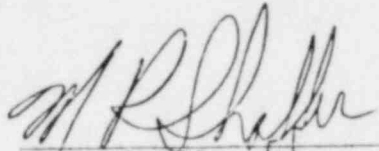
  
M. R. Shaffer

MRS/jl

cc: Attendees  
Action Parties  
T. M. Hawkins - SU/T  
C. E. Hartman - PORC Chairman for review with PORC as applicable.  
J. J. Colitz  
D. Dyckman  
M. J. Ross  
D. M. Shovlin  
R. S. Harbin  
R. J. Toole

*File I&E Inspections*

CHRONOLOGY OF EVENTS

Initial contact 0800a from CR. Dispatched HP/NRC/TMI to CR at 0802. Initial indication was at 0315a.

- 082 {
1. Slight indication am meter reading increase.
  2. RCS pressure now 280 psig.
  3. RCS pressure dropped 50 psi on purpose.
  4. Decreased MU and Letdown Flow.
  5. Considering isolation of MU system.
  6. MU Pump Room B shows highest count  $1.8 \cdot 10^{-7}$  uCi/cc - Local Alarm.
  7. In process of sending Aux Bldg. suited 8:25a .
  8. State notified at 0800 - have not called an emergency.
  9. No one in the Aux Bldg.
  10. Why the 03 am to 08 am delay for notifying NRC?
  11. Seal injection and letdown isolated at 0855.
  12. Geruski contacted at 0855 (*Collins*)
  13. PEMA contacted at 0807.
  14. Dauphin County at 0811.
  15. AM-5 up 10 count as of info at 0830.
  16. DeYoung contacted by Collins 0915.
  17. As of 0800 have not contacted incident center.
  18. Licensee as of 0815 still evaluating.
  19. Region I - Keimig contacted at 0925.
  20. Contacted by Jordans Group (Kirkpatrick for brief on event) 0935.

21. Harold Denton contacted by Collins at 0905.
  22. Bob Arnold contacted at 1005.
  23. Freeboard available 5000 gal 1.8 ft. left.
  24. EPA contacted by Fasano 10:00a.
  25. Sample coordinator contacted.
  26. Team in Aux Bldg at 10:00a.  
Sample
  27. ~~R&S~~ coordinator called 10:10a count 53.22 uCi/cc.
  28. Kr<sup>85</sup> 0.07 uCi/cc. (Primary System)
  29. Contacted by Flack & Kirkpatrick at 1025a for update.
  30. AMS meter reading not rechecked as of 1030a.
  31. No visual leakage in cubicle A, B or C 1040a. (6 persons entered  
Aux. Bldg - 1 HP and 1 Operator)
  32. Taking Grab sample for analysis 1030a.
  33. SPC in auto and holding 275 psig 1030a.
  34. Still have AMS alarms 1055a.
  35. Geruski updated at 1055a.
  36. FHB-AMS alarming due to contamination at 1120.
  37. AMS-B-2 Auxiliary Building need to be reset after filters changed at 1120.
  38. Will be taking additional air grab sample at 1120.
  39. Grab samples Geli read  $10^{-8}$  then  $10^{-9}$  on Cs 137 uCi/cc at 1120.
  40. Licensee are making no release estimate.
- Barley distinguishable from level indication on water level - contacted Ruther at 1145.



File  
I & E Inspection

Cotters  
.0800-1600

Puckett & Thomas

Thomas

0800 Puckett received call from Mat-Ed re high airborne he briefed me on details available at the time (see M. Puckett log). I went to control room then to U-2 Aux Bldg H.P. office. I dressed in anti-c's and made entry with → HP's & operators who were trying to determine cause of high airborne. Suspected areas checked out and no primary coolant leaks found included Makeup pump rooms 1A 1B 1C (281' elevation) Area near HPR-219 checked on 305' elevation. Air samples taken during our entry 1000-1115 showed decreasing levels of airborne. I checked the AMS-3's the one with the highest reading was on the south end of the 305' elevation (~4500 cpm) next highest AMS-3 was (~2500 cpm).

Reviewed radioactive material packaging procedure / R. Nimitz comments of 2/10/80. Discussed same with R. Nimitz will talk to Zahner tomorrow.

1600-2400  
(Carried over to  
Pleumlee 3/20/80  
3/21/80)

Licensee conducted a startup of Makeup System and Seal Injection System at ~ 1943 and 1956, respectively. These systems were secured at ~ 2040.

A local air sampler (B-2, located 305 ft elev., Aux Building) tripped intermittently starting at 1958 and others showed activity later.

The most active <sup>air</sup> sample was taken at 2258 at a pipe penetration into Makeup Pump Room 1B. (See following pages) This was  $1.38 \times 10^{-7}$  pCi/ml. About an hour and a half later the level was  $7 \times 10^{-8}$  (down by a factor of two). Only particulate activity was found. By 0300, 3/21/80 the level was  $< 2 \times 10^{-8}$ .

AM 5 (upstream of the filter banks on the roof) increased about 30 cpm from an initial ~ 60 cpm and came to a broad stable period about 2300, then eased down. Only the particulate monitor changed.

HPR 222 and HPR 221A appeared to respond but later the I & C repairman was quoted as saying the tracking filter paper was stuck, so these instruments were not reliable. After fixing, these readings were much lower than before.

The Aux Building was generally less than  $10^{-8}$  pCi/ml by 0300 and many areas were less than  $10^{-9}$ , indicating gradual approach to normal.

Confirms a minor leak  
probably in the H-1-1B area.

- AI - 1927 filter Chg.  $1.05 \times 10^{-10}$
- 1943 2000 CPM - (MU ON)
- 1956 2000 " - (SE ON)
- 2003 2500 "
- 2016 3000 "
- 2017  $6.22 \times 10^{-10}$
- 2121  $1 \times 10^{-9}$
- 2247  $9.95 \times 10^{-10}$
- 0024  $1.1 \times 10^{-9}$

O. Grab Sample at MU-P-1B Penet.

- 2015  ~~$1.3 \times 10^{-10}$~~   $1 \times 10^{-7}$
- 2258  ~~$1.3 \times 10^{-9}$~~   $1.3 \times 10^{-7}$
- 0035  $7 \times 10^{-8}$

Low Vol outside MU-P-113 ~~door~~ in passage

- 2015  $1.3 \times 10^{-10}$
- 2251  $1.14 \times 10^{-9}$
- 0025  $7.5 \times 10^{-10}$

A-2

- 0021  $1.85 \times 10^{-10}$

See Control Point for full records  
(Xerox machine was tied up when I left)

#2 Grab Samp.

2007  $2.56 \times 10^{-8}$   
 2257  $3.8 \times 10^{-8}$   
 0021  $8.92 \times 10^{-9}$

B-2 2017  $6.7 \times 10^{-10}$

2235-  $1.7 \times 10^{-9}$   
 0017  $2.2 \times 10^{-9}$

1925	4000 CPM
1955	4500 "
2010	5000 "

2135  $1.69 \times 10^{-9}$

---

B-1 2130  $5.56 \times 10^{-10}$   
 2240  $2.33 \times 10^{-10}$   
 0025  $1.28 \times 10^{-9}$

#2 Low Vol.

2035  $1.82 \times 10^{-9}$   
 2245  $6.9 \times 10^{-9}$   
~~0038  $1.3 \times 10^{-9}$~~   
 0021  $8.92 \times 10^{-9}$

II-B

II-B

II-B

II-B

II-B

II-B

GENERAL AREA

EL 281'

N

A-1

George

George  
LOW-VOL

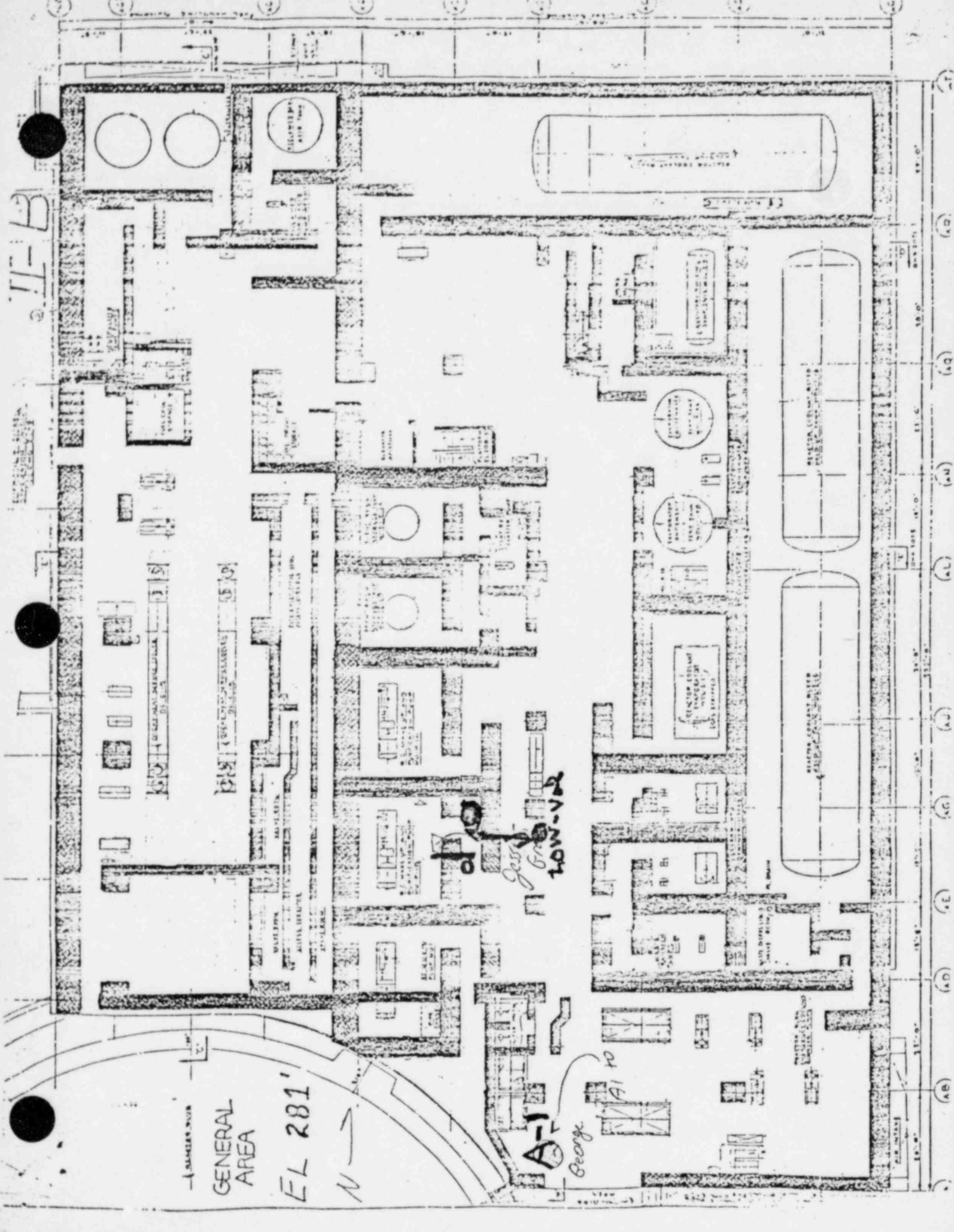

A B C D E F G H I J K L M N O P Q R S T

1 2 3 4 5 6 7 8 9 10 11 12

*II-C*

GENERAL  
AREA.

EL 305'

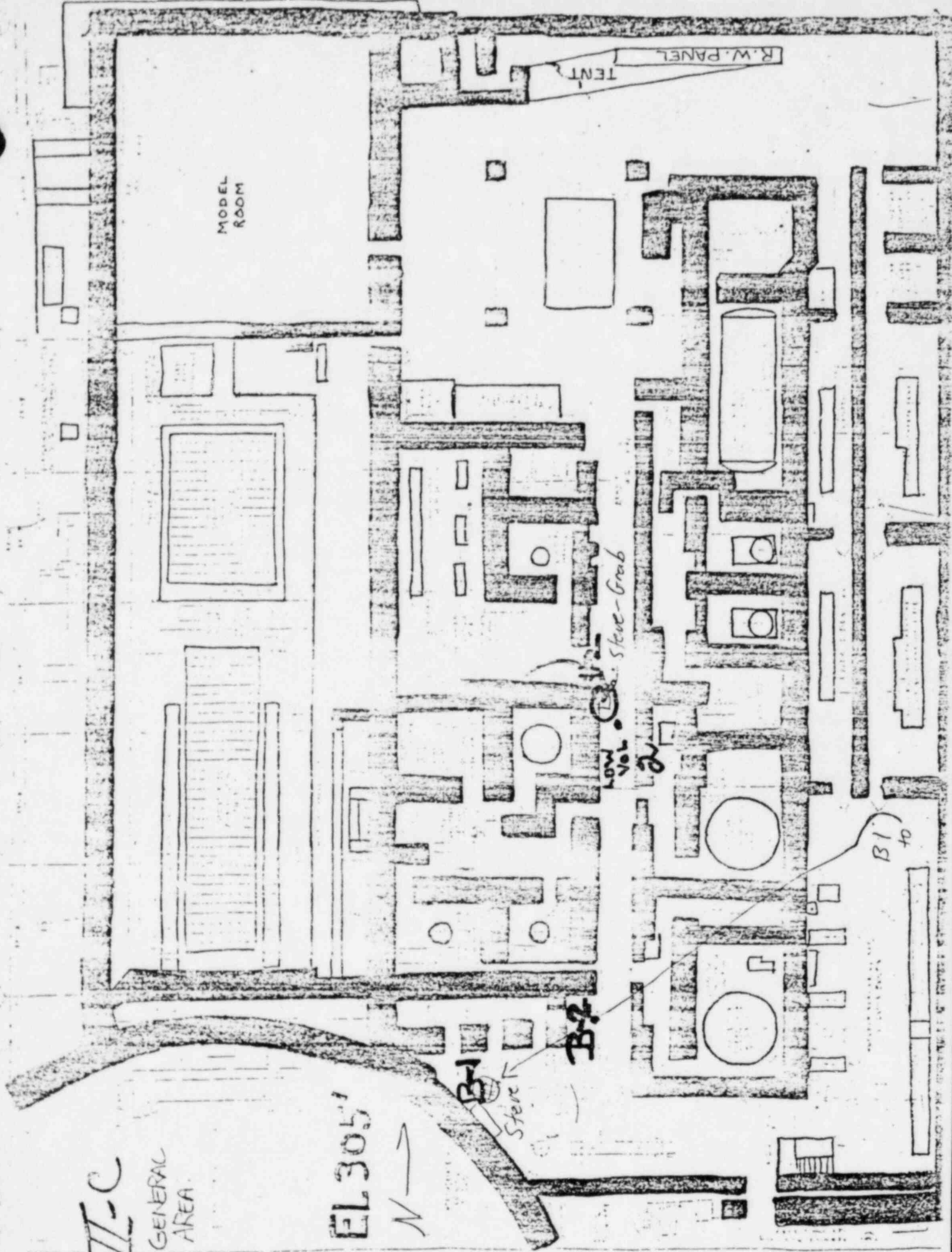

MODEL  
ROOM

R.W. PANEL  
TENT

Steve-Grab

LOW VOL

B1

Store

B1

B1 to

2077 5078

7.1 X 10<sup>-11</sup>  
C4-2027  
1927

5.1 X 10<sup>-11</sup>  
C-3 2017

EL 300'  
GENERAL  
AREA

Ken  
C-3 to  
C-4

C4 - remove  
C4

Glen

1915  
6.52 X 10<sup>-12</sup>  
C1 to C4

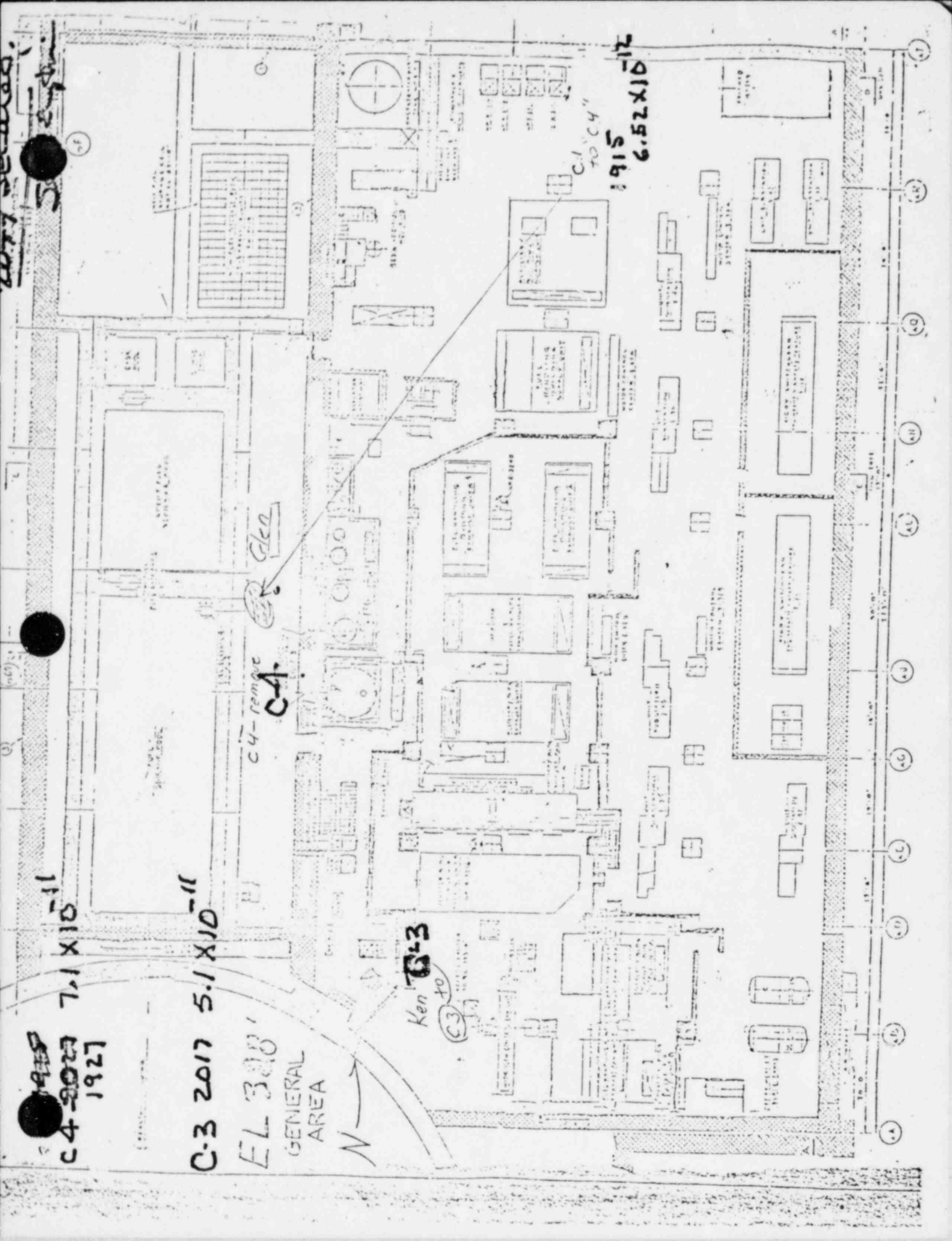

Contacted by Shankar & Conte / 3/20/80

Following:

W. H. Hines  
File IFA  
Inspections

Started seal injection at 756 PM

Within 2 min 758 PM AMS B-2 alarmed

}  $10^{-8}$  uci/cc

MU B cubicle  $1 \times 10^{-7}$  uci/cc

AM-5 spiked and appears to jump in bursts (pulses)  
on particulate, on gas steady no rise

Indication of a slow leak

Planning to grab sample for GeLi analysis

Suspect seal injection line source of leak

Let down line thought to be ok

suspect by pass valve around M op. valve leaking  
Location not known, but suspect in MU pump B  
cubicle

Isolating seal injection at 850

Secured let down & seal injection 850

as of 915 seeing  $10^{-7}$  uci/cc on AMS  
out side MU-P-B cubicle

Aux Bldg Duct A alarmed on ~~the~~ particulate  
up stream of Filters

AM-5 stable

Ann 1



Collected by

Carl - 1130

Apus monticola settled  
grab sample level  
still coming up  
but level low,  
decreased 7

Grab sample at  
MUP-1-B use by  
file of 4 oz of 8<sup>30</sup> re.

Vent monitor

AM-5 was up  
~ 30% (particulate)  
Duct A up 25%  
over the evening  
Local samples  
~ 10-15 in perception

FHB bio shown  
some rise

Leak tracer

General around MUP-1B  
but not specific  
location

~ yellow or 2

au 7.

*File I&E Insp Reports*

TMI TECHNICAL SUPPORT STAFF MEETING WITH  
VICTOR STELLO - FEBRUARY 14, 1980  
9:00 a.m.

STAFF'S GENERAL REACTION

1. TMI clean up is moving to slow and is being bogged down due to politics. Classic example: Air Lock Entry.
2. Licensee and NRC staff is being demoralized by Washington. They are both trying and doing a good job.
3. The Licensee has made positive changes for running a "tight ship". One of these include the reorganization, which has been effective.

Two Problems Areas:

- a. Licensee wants to purge containment building.
- b. General maintenance problems not corrected immediately. Example: caution tag found in U-2 dated February, 1979. As to this date, still unrepaired.

MAINTENANCE AND SURVEILLANCE PROBLEMS

1. The licensee is doing in-service requirements.
2. Preventative Maintenance:
  - a. TMI staff is not sure whether or not licensee is following up on maintenance problems. Licensee has a vendor, Catalytic, doing the majority of maintenance repair. Their maintenance department is quite small.
  - b. TMI staff is not able to follow up on the maintenance problems due to insufficient staffing.

ANTICIPATING PROBLEMS

1. Emergency Drills (7 recent, another one on March 31, 1980) are being utilized for anticipating problems. These drills include use of current procedures.
2. Victor Stello suggested a systematic review of probable problem areas. This would allow anticipation of certain mishaps.

LICENSEE RECORD FOR CONFORMANCE AND NON-CONFORMANCE

1. Health Physics is one of the major problems for the Licensee.
2. In November 1979, TMI staff started issuing non-compliance items to the Licensee.
3. TMI staff currently has no formal inspection program for Unit 2. At the present, inspection is being completed by routine tours, which include reviewing of logs, graphs and various other data.

REACTOR BUILDING SAMPLING EVOLUTION 2/12/80

- 11:00 p.m. Shambaky was contacted by Nimitz concerning a noticed rise in the Sampling Monitor.
- 11:15 p.m. Nimitz called Fasano to inform him of the situation.
- 11:30 p.m. Nimitz called Shambaky to inform him that Fasano had been notified.
- 3:00 a.m. Fasano called Ed Ford and asked him to contact him (Fasano) immediately if there were any appreciable increases in the Sampling Monitor from the 11:00 p.m. reading.
1. Paul Rooter and Dick Wilson (Met-Ed) stated that the reading was 3 curies and that they were operating within the procedure.
  2. Nimitz did not review the procedure at the time that the monitor increase was identified and change from background reading was noted.
- 7:30 a.m. Fasano talked with Collins concerning situation because of sensitivity level.

GENERAL COMMENTS

1. Schedule for all samples taken in the plant are given out at the Daily Staff Meeting.
2. Licensee did not tell the NRC that they were using a TCN for the sample process taken 2/12.
3. Problem with licensee on who is responsible for implementing procedures.
3. New Met-Ed Technical Staff apparently needs to be informed of correct process for implementing procedure changes.

MONDAY EVENT

1. Whose first individual to know the event?

- 12:50 p.m. NRC learned of event.
- 1:20 p.m. NRC in communications with Pennsylvania DER. DER called NRC (upon Collins arrival).

2. Who else had talked to the State?

- 2:00 p.m. Collins talked to Copenhagen (no numbers).
- 3:20 p.m.
- 2:30 p.m. Licensee came up with .28 curies.
- 3:00 p.m. Licensee had ball park number.
- 3:30 p.m. Licensee told PA DER 200-300 mc.
- 4:00 - Licensee wrote it down.
- 4:30 p.m.
- 4:00 - Control Room (Conte) found out about state having
- 4:30 p.m. information about 200-300 micro curies.
- 5:00 - Licensee released 200-300 milli-currie number given
- 5:30 p.m. to Senator Heinz.

TUESDAY EVENT

1. When was the first time that NRC learned of 3 times the normal number was exceeded?

-After Stello's arrival.

-Earlier in the day Wilson told Collins all monitors  $\leq 3$  x normal.

NRC STAFF COMMENTS

1. Fasano - we need permanent staff.

Shambaky - present HP staff is inadequate for Containment entry.

- licensee deviation from procedures is chronic.

- HP practices are improving.

- Response to Monday's event was good.

Fasano - we don't get round the clock support from all Regions for shift coverage.

Stello - What are you doing about it?

2. Shambaky - We are fair in enforcement, but we must be tough.

Stello - Let's do it.

3. Plumlee - Use of contractor personnel.

Stello - Conte is looking into this.

4. Kalman - Communications Problem - during the event on Monday Kalman wrote a memo.

5. Collins - Headquarters bugging the Control Room for information during Monday's event.

6. Conte - When is the NRC Emergency Plan to be issued?

Stello - I signed the plan last week.

J. Collins

REVISED

\*A G E N D A\*

*I & E  
Inspections*

MEETING WITH NRC CONCERNING ITEMS  
OF NONCOMPLIANCE AND CIVIL PENALTIES

DATE: March 6, 1980

TIME: 10:00 A.M.

LOCATION: TMI-2 Trailer #201 (Arnold's)

PURPOSE: Agree on scope of needed response to  
January 23, 1980 letter

- I. INTRODUCTION - E. G. Wallace/C. F. McPhatter
- II. RADIOLOGICAL CONTROLS - R. W. Heward/I. Seybold  
(NONCOMPLIANCE STATEMENTS 2, 4, 10)
- III. ENGINEERING PROCEDURES - J. J. Barton/B. D. Elam/G. A. Kunder  
(NONCOMPLIANCE STATEMENTS 1, 2, 3, 6)
- IV. TRAINING - L. L. Lawyer/D. Smith/R. W. Zechman  
(NONCOMPLIANCE STATEMENTS 4, 5, 8)
- V. OTHER ITEMS - L. W. Harding  
(NONCOMPLIANCE STATEMENTS 2, 4, 7, 9, 11)
- VI. PORV LEAKAGE HISTORY - E. G. Wallace
- VII. NRC REMARKS
- VIII. SUMMARY AND CONCLUSION - E. D. Fuller