



SACRAMENTO MUNICIPAL UTILITY DISTRICT □ 6201 S Street, Box 15830, Sacramento, California 95813; (916) 452-3211

January 5, 1983

R H ENGELKEN REGIONAL ADMINISTRATOR
REGION V OFFICE OF INSPECTION AND ENFORCEMENT
U S NUCLEAR REGULATORY COMMISSION
1450 MARIA LANE SUITE 210
WALNUT CREEK CA 94596

DOCKET NO. 50-312
LICENSE NO. DPR-54
SPECIAL REPORT NO. 82-05

In accordance with Rancho Seco Nuclear Generating Station Technical Specifications Section 6.9.5.B.1 and 10 CFR 50 Appendix K, the Sacramento Municipal Utility District hereby submits a report of the Reactor Building Inspections performed during July of 1982. A summary of discrepancies is listed below. Work Requests have been issued to correct these items.

Inspection on July 14, 1982

1. Ground straps at inside and outside rail joints were broken or missing.
2. Small amount of grease found around several tendons.
3. Small cracks were noted around Containment Building dome and in tendon gallery.
4. Pitting corrosion near several tendons.
5. Minor corrosion of Containment Building liner and peeling paint.

A copy of the test results is attached. The results verify that the structural integrity of the Reactor Building is satisfactory.

If you have any questions regarding this report, please contact Mr. R. W. Colombo at the Rancho Seco Generating Station.

John J. Mattimoe
John J. Mattimoe
General Manager

RECEIVED

61-11-11-2-11-11-83

RECEIVED

8301170342 830105
PDR ADOCK 05000312
S PDR

Performed 7-13-82

ENCLOSURE 6.2 RESULTS OF GENERAL VISUAL INSPECTION OF EXTERIOR SURFACES

.1 WALK AROUND INSPECTION
Observations and Results OK

Inspector: R. Gallagher Date: 7-16-82

.2 REACTOR BUILDING DOME INSPECTION
Observations and Results SEE ATTACHMENT 'A'

Inspector: R. Gallagher Date: 7-14-82

.3 TENDON ACCESS GALLERY INSPECTION
Observations and Results SEE ATTACHMENT 'B'

Inspector: R. Gallagher Date: 7-14-82

Corrective Action if Required: _____

Reviewed by Freeman J. Coleman Technical Support Date: 7-20-82

ENCLOSURE 6.3 RESULTS OF SPECIFIC AREA INSPECTION OF EXTERIOR SURFACES

.1 AREA 1 - GRADE LEVEL - area surrounding the equipment hatch.

Observations and Results OK

Inspector: R. Halligan Date: 7-16-82

.2 AREA 2 - GRADE LEVEL - area surrounding the emergency hatch.

Observations and Results OK

Inspector: R. Halligan Date: 7-16-82

.3 AREA 3 - GRADE LEVEL - area in the vicinity of the A Main Steam Line.

Observations and Results OK

Inspector: R. Halligan Date: 7-16-82

.4 AREA 4 - GRADE LEVEL - area in the vicinity of B Main Steam Line.

Observations and Results OK

Inspector: R. Halligan Date: 7-16-82

.5 AREA 5 - GRADE LEVEL - area in the vicinity of the electrical penetrations.

Observations and Results OK

Inspector: R. Halligan Date: 7-14-82

ENCLOSURE 6.3 (Continued) RESULTS OF SPECIFIC AREA INSPECTION OF EXTERIOR SURFACES-

.6 AREA 6 - +20 FT. LEVEL - area in the vicinity of purge inlet and outlet and electrical penetrations.

Observations and Results OK (SEE ENC. 6.1 pg. 2)

Inspector: R. Hallquist Date: 7-16-82

.7 AREA 7 - +20 FT LEVEL - area in the vicinity of electrical penetrations.

Observations and Results OK (SEE ENC. 6.1 pg 2)

1100 5-2743 PIC 7-20-82

Inspector: R. Hallquist Date: 7-16-82

.8 AREA 8 - +40 FT. LEVEL - area in the vicinity of the personnel hatch.

Observations and Results OK

Inspector: R. Hallquist Date: 7-14-82

.9 AREA 9 - +40 FT. LEVEL - area in vicinity of the plant exhaust.

Observations and Results OK

.10 AREA 10 - -20 FT. LEVEL - mechanical penetration area in West Decay Heat Cooler Room.

Observations and Results OK GREASE RUNNING DOWN WALL FROM CEILING ABOVE PENETRATION # 62. PER AIR 5-1661 SEE PAGE NORMAL PIC 7-20-82

Inspector: R. Hallquist Date: 7-15-82

ENCLOSURE 6.3 (Continued) RESULTS OF SPECIFIC AREA INSPECTION OF EXTERIOR SURFACES

.11 AREA 11 - -20 FT. LEVEL - mechanical penetration area in East Decay Heat Cooler Room.

Observations and Results OK (SEE ENC. 6.1, pg 4)

NCRS-2326 PIC 7-20-82

Inspector: R. Hollingsworth Date: 7-15-82

.12 AREA 12 - -37 FT. LEVEL - area in vicinity of Rx Building Emergency Sump Line to B Decay Heat Pump Suction.

Observations and Results OK

Inspector: R. Hollingsworth Date: 7-16-82

.13 AREA 13 - -37 FT. LEVEL - area in vicinity of Rx Building Emergency Sump Line to A Decay Heat Pump Suction.

Observations and Results UPWARD DIAGONAL CRACK IN WALL ABOVE VALVE. NCR S-2745 PIC 7-20-82

Inspector: R. Hollingsworth Date: 7-16-82

Corrective Action if Required: _____

Reviewed by Freeman J. Coleman Technical Support

Date: 7-20-82

ENCLOSURE 6.4 RESULTS OF GENERAL VISUAL INSPECTION OF INTERIOR SURFACES

.1 WALK AROUND INSPECTION

Observations and Results SEE ENCLOSURE 6.1, pg 1
NCR S-2336 PC 7-20-82

Inspector: Pfallingmaier Date: 7-13-82

.2 PENETRATION AREA INSPECTION

Observations and Results OK

Inspector: Pfallingmaier Date: 7-13-82

.3 REACTOR BUILDING DOME INSPECTION

Observations and Results OK

Inspector: Pfallingmaier Date: 7-13-82

Corrective Action if Required: _____

These results acceptable pending disposition
of attached NCRs.

Reviewed by Conroy Coburn Technical Support Date: 7-20-82

ENCLOSURE 6.5 RESULTS OF SPECIFIC AREA INSPECTION OF INTERIOR SURFACES

- .1 3 ft. above and below the horizontal centerline extending 10 ft. east of the east edge of the personnel lock.

Observations and Results OK

Inspector: R. Hollingsworth Date: 7-13-82

- .2 2 ft. radius around electrical penetration No. 7.

Observations and Results OK

Inspector: R. Hollingsworth Date: 7-13-82

- .3 Upper half of mechanical penetration No. 40 (main steam) extending from edge of penetration to 6 ft. out from edge.

Observations and Results OK

Inspector: R. Hollingsworth Date: 7-13-82

- .4 2 ft. radius about mechanical penetration No. 20 (HP injection)

Observations and Results OK

Inspector: R. Hollingsworth Date: 7-13-82

Corrective Action if Required: _____

Reviewed by Thomas J. Allen Technical Support

Date: 7-20-82

ATTACHMENT 'B'

TENDONS # 48, 44 CAPS LEAKING GREASE.

" # 16, 33 GREASE VALVES LEAKING.

FOR NCR S-1661 Small SEEPAGE Normal. P 7-20-82

PITTING IN OUTSIDE WALL BETWEEN TENDONS # 18-22.

NCR 2746 P 7-20-82

MEANDERING CRACK (CEILING TO FLOOR) IN OUTSIDE WALL

@ TENDONS # 114, 112, 101, 93, 92, 79, 76-77, 65, 60, 58, 54. ALSO

57 ON INSIDE WALL. NCR S-2325 calls for

mapping of cracks for future inspection. P 7-20-82

Chem. Stor. Elev. 9 1/2 Ft.



PAINT COMING OFF STAIRWELL WALL FROM GRADE TO APPROX +90'

GENERALLY DIRTY / RUSTY AROUND EMER. EXIT PERIPHERY

11/2/80
50330

LINER RUSTY

11/2/80
50330

11/2/80
50330

RUST/PEELING PAINT ON TRPG6/67 ADJACENT TO PENETRATION #41

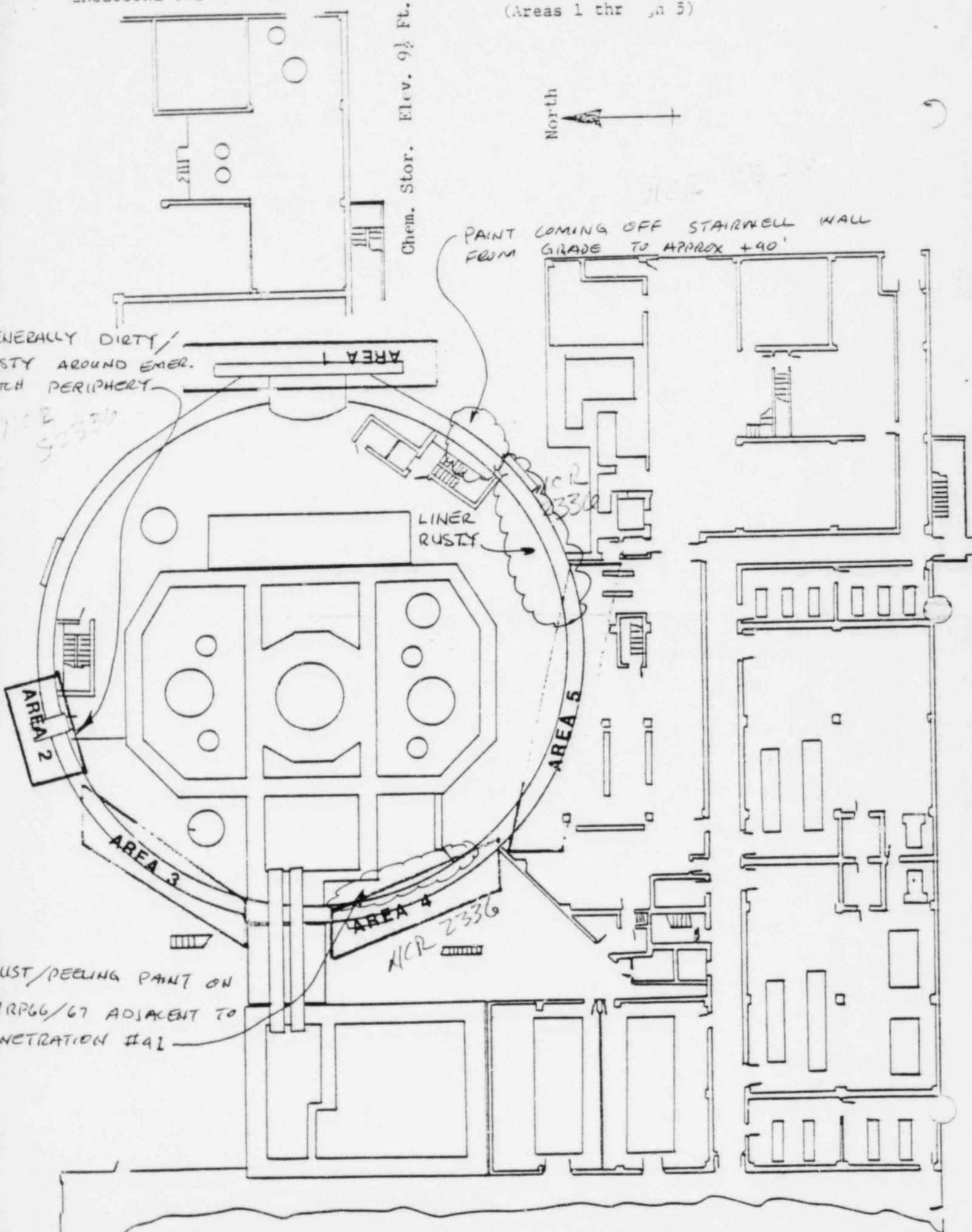

ENCLOSURE 6.1 (Continued)

SPECIFIC AREAS OF EXTERIOR SURFACES TO BE INSPECTED
(Areas 6 and 7)

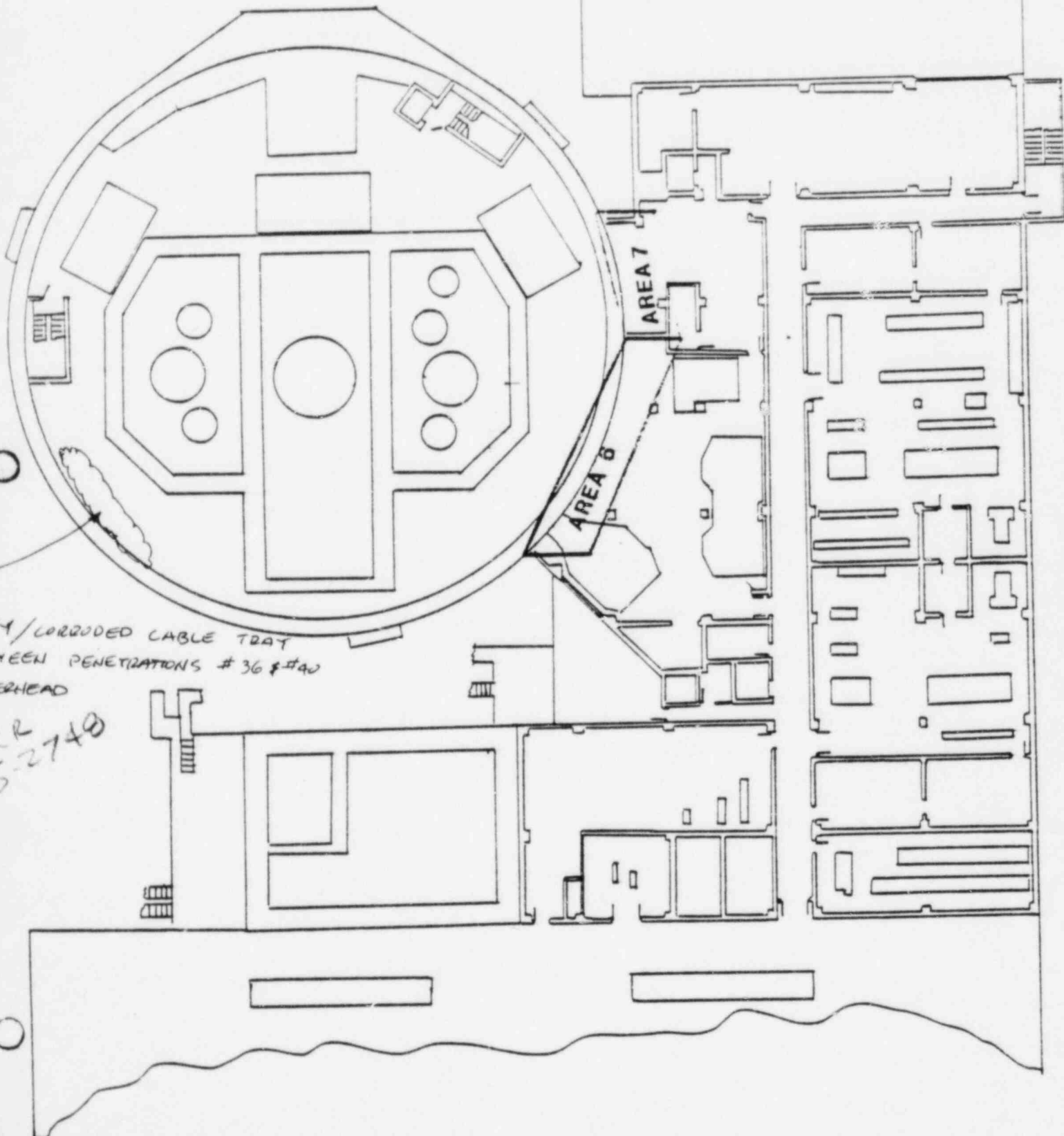

UNSTY/LOADED CABLE TRAY
BETWEEN PENETRATIONS #36 & #40
OVERHEAD

HLR
5-27-80

ELEV. 20 FT.

ENCLOSURE 6.1 (Continued)

SPECIFIC AREAS OF EXTERIOR SURFACES TO BE INSPECTED
(Areas 10 and 11)

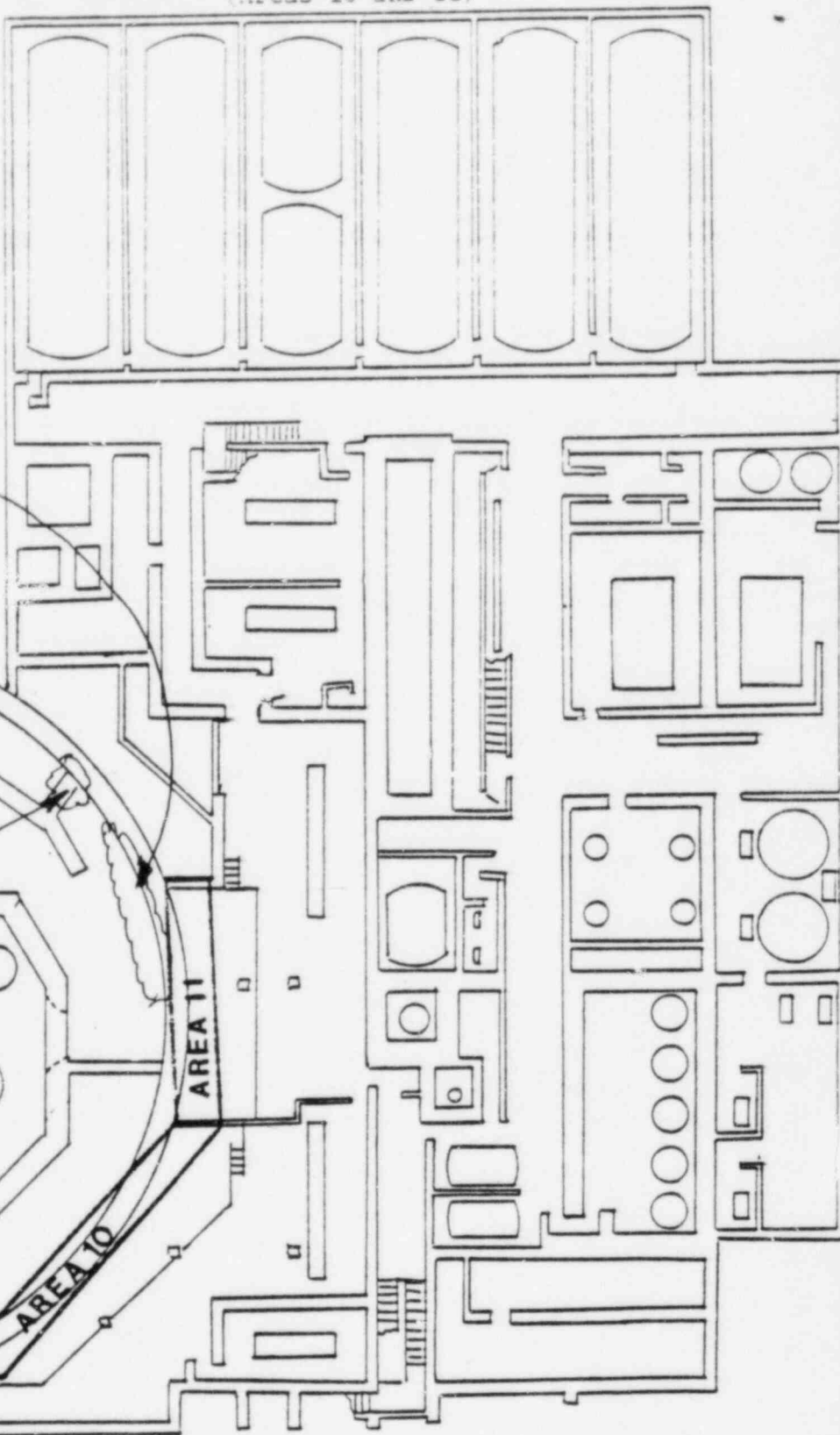

RUSTY/CORRODED FLANGES &
PEELING PAINT ON MUCH NSW
PIPING.

ECN 3298
3299

NCR
S-2326
BADLY RUSTED
BEHIND BULKHEAD

AREA 11

AREA 10